

O.D.O.T. DISTRICT 2 SURVEY OFFICE (USE ONLY)

PERSONNEL

REFERENCE NO. 106

SHEET 21 OF 23

NOTES RHOADES

DATE 3/1/22

ROUTE SR 2

H.C. O'DONNELL

WEATHER CLOUDY

COUNTY OTTAWA

R.C. AUBLE

TEMP. 44°

TOWNSHIP DANBURY

NIESE

SECTION 4-32

DWG BY RHOADES PID 96755

TYPE MONUMENT CMON W/ 1/2" IPIN

~~ON SURFACE~~ - BELOW 5"

OFFSET Q PAVEMENT ON LT : RT

- TO - EDGE PAVEMENT

STATION: 1406+09.66

HORZ. DATUM: NAD83 2011

GEOID: NAVD88 2018

GRID: NORTHING: 670186.482

EASTING: 1873841.769

NOTE:  
THIS MAP IS FOR ODOT PURPOSES ONLY  
TO INDEX REFERENCE TIES, AND DOES NOT  
REPRESENT TRUE LAND SUBDIVISION.

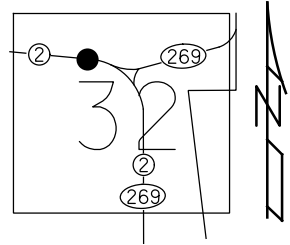

RECORD: S.C.  
STA 15+25.10  
FD CMON  
W/1/2" IPIN  
3/1/73, SCHNEIDER  
FD CMON  
W/ 1/2" IPIN  
5" DOWN  
REF106  
3/1/22, JFO

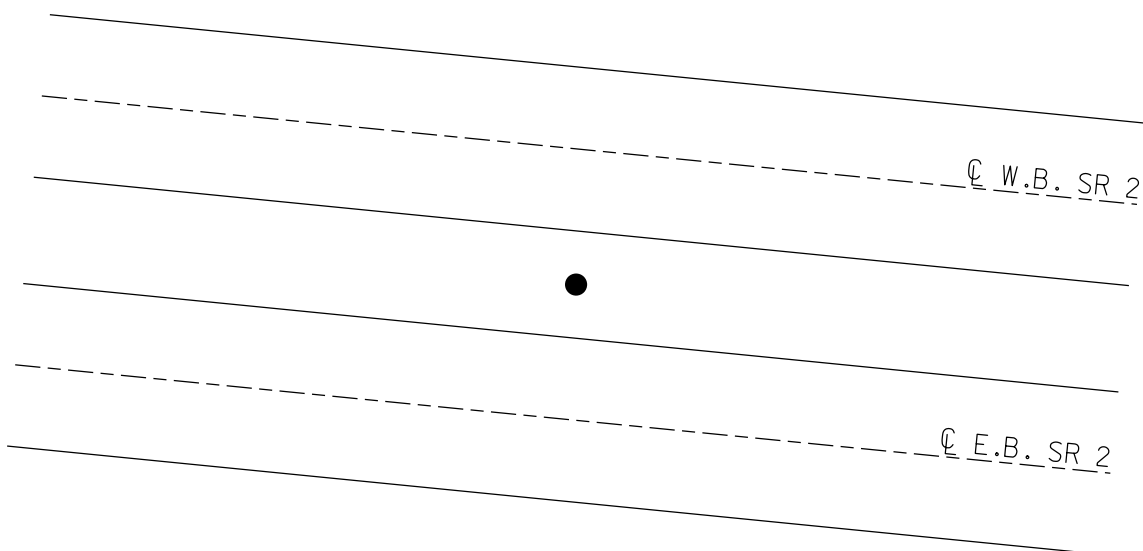

PERSONNEL TITLE PERSONNEL TITLE  
 Schneider \_\_\_\_\_  
 Mosser \_\_\_\_\_  
 Barbour \_\_\_\_\_  
 Geyman \_\_\_\_\_

COUNTY Ottawa DATE 3-6-73  
 S. R. 2 WEATHER Fair  
 SEC. 26.60 TEMP. 65°

DESCRIPTION Sec 17 Danbury Twp. JOB NO. \_\_\_\_\_  
 LEFT CENTER LINE RIGHT

