

O.D.O.T. DISTRICT 2 SURVEY OFFICE (USE ONLY)

PERSONNEL _____

REFERENCE NO. 2 A

SHEET 3 OF 7

NOTES BALBAUGH

DATE 4/15/20

ROUTE SR 51

H.C. LEU

WEATHER CLOUDY

COUNTY OTTAWA

R.C. BALBAUGH

TEMP. 39°

TOWNSHIP HARRIS

SECTION 19

DWG BY NIESE

PID 94324

T 6 N R 14 E

TYPE MONUMENT P.K./WASHER

ON SURFACE - ~~BELOW~~ ON

OFFSET CL PAVEMENT ON LT : RT

- TO - EDGE PAVEMENT

STATION: 26+79

HORZ. DATUM: NAD83 2011

GEOID: NAVD88 2012A

GRID: NORTHING: -

EASTING: -

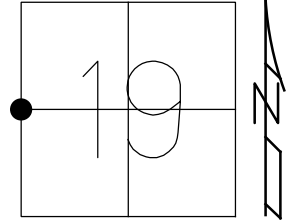

RECORD:
ORIGIN UNKNOWN
FD P.K.NAIL
ATOP P.K.NAIL
9/21/87
D.N.F.
4/15/20, JLL

DIST. 2-2A = 0.77' REC

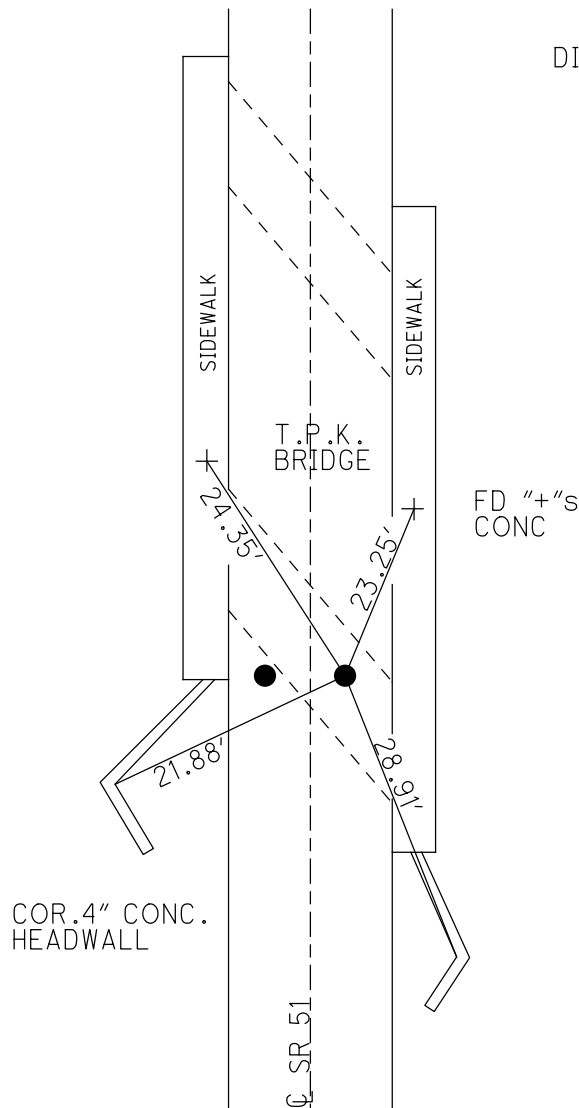

O.D.O.T. DISTRICT 2 SURVEY OFFICE (USE ONLY)

PERSONNEL _____ REFERENCE NO. 2 A SHEET 3 OF 7
 NOTES CRONIN DATE 9-21-87 ROUTE SR 51
 H.C. RIPPLE WEATHER SUNNY COUNTY OTTAWA
 R.C. BARBOUR TEMP. 63°F TOWNSHIP HARRIS
GEYMAN SECTION 19
 T 6 N R 14 E

TYPE MONUMENT PK/WASHER
 ON SURFACE - ~~BELOW~~ ON
 LEFT - ☉ PAV'T - RIGHT ON
- TO - EDGE PAVEMENT
 S.L.M. 26+79

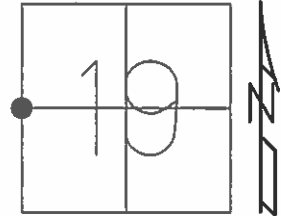

Grid: Northing: _____ Easting: _____

RECORD:
 P.K.S ATOP
 P.K.S ORGIN
 UNKNOWN

RECORD:
 DIST.2-2A = 0.77'

DNF
 STAKED OUT DIST
 AND IF FELL ON
 APPROACH SLAB

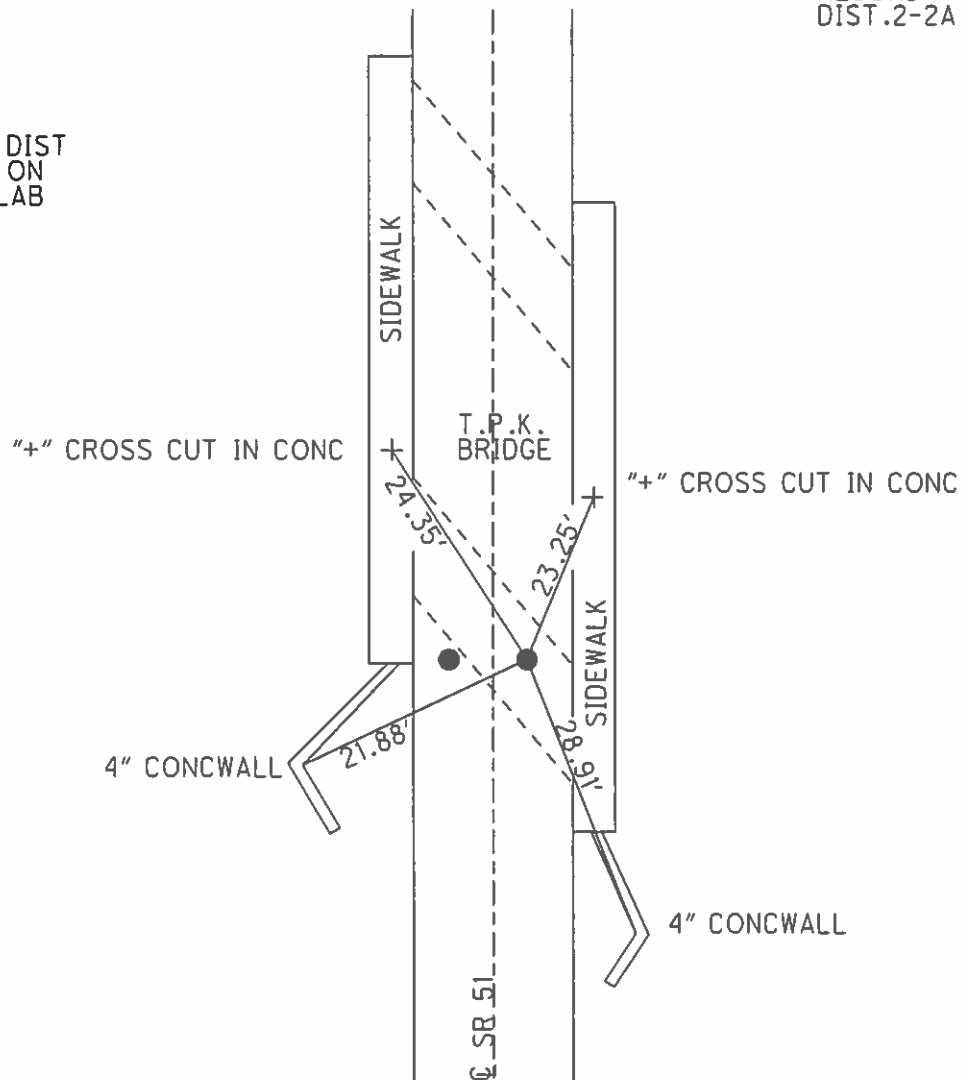

O.D.O.T. DISTRICT 2 SURVEY OFFICE

PERSONNEL

REFERENCE NO. 2

SHEET 2 OF

NOTES Crocin

H.C. Ripple

R.C. Barbour

Geyman

DATE 9/21/87

WEATHER sunny

TEMP. 63°

ROUTE 51

COUNTY Ottawa

TOWNSHIP Harris

SECTION 19

T 6 N R 14 E

TYPE MONUMENT P.K.s & washers

ON SURFACE - BELOW on surface

LEFT - & PAV'T. - RIGHT & Pavt

TO EDGE PAVEMENT

S.L.M. 26+79

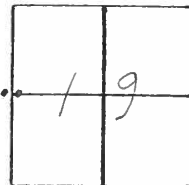

P.K.s atop P.K.s
origin unknown

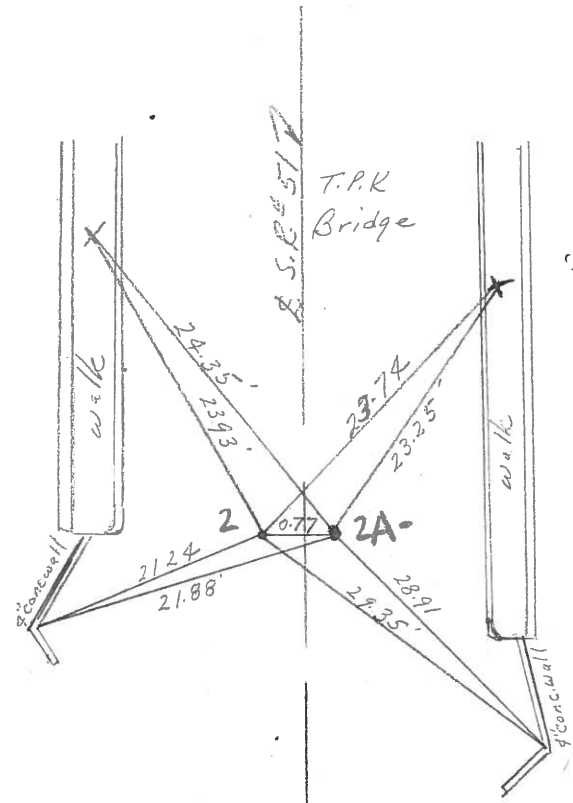

'4' - cross cut in conc.

PERSONNEL	TITLE	PERSONNEL	TITLE	COUNTY	DATE	WEATHER	TEMP.
<u>Schneider</u>				<u>Ottawa</u>	<u>1-3-72</u>	<u>Fair</u>	<u>35°</u>
<u>Mosser</u>				S. R. <u>51</u>			
<u>Barbour</u>				SEC. <u>24 & 19</u>			
<u>Vinson</u>							
DESCRIPTION <u>Clay & Harris Twp's</u>				LEFT	CENTER LINE	RIGHT	JOB NO.

Note!! Red Sta. begins at Wood county line.

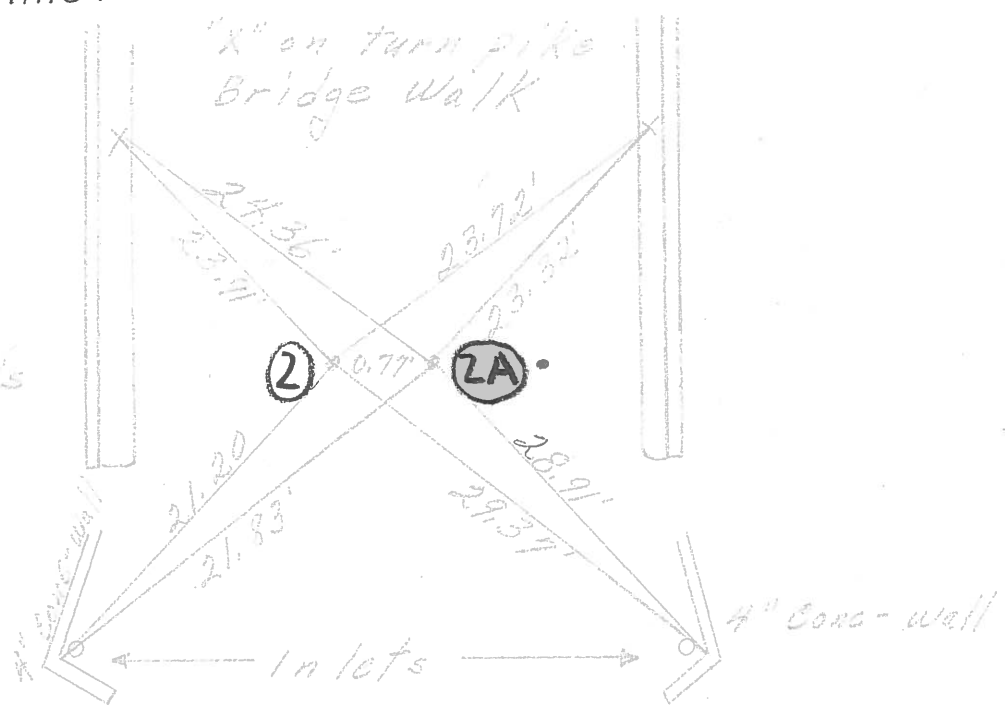

Lat 79.0
Fd. 2 - P.K. Nails



120431 San. Co. =
0+00 Ott. Co.
4" in Conc-Perm't.
R.R. Spk. on top
 $\Delta = 0^{\circ}09' Lt.$
#5 - San. Co. =
#0 - Ott. Co.

