

O.D.O.T. DISTRICT 2 SURVEY OFFICE (USE ONLY)

PERSONNEL

REFERENCE NO. 26 A

SHEET 30 OF 33

NOTES RHOADES

DATE 7/21/21

ROUTE SR 105

H.C. O'DONNELL

WEATHER CLOUDY

COUNTY OTTAWA

R.C. RHOADES

TEMP. 65°

TOWNSHIP HARRIS

SECTION 13

DWG BY RHOADES PID CHIP SEAL

T 6 N R 13 E

TYPE MONUMENT MAG/WASHER

ON SURFACE - ~~BELOW~~ ON

OFFSET Q PAVEMENT 4.1' ~~RT~~ : RT

6.0' TO RT EDGE PAVEMENT

STATION: 128+09.41

HORZ. DATUM: NAD83 2011

GEOID: NAVD88 2018

GRID: NORTHING: 660595.217

EASTING: 1748946.795

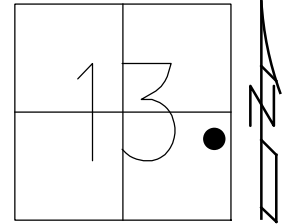

RECORD:
 FD MAG NAIL
 5/7/13, DCH
 SET MAG/WASHER
 FINREFOTTA26
 7/11/13, SDC
 FD MAG/WASHER
 REFA26
 7/21/21, JFO
 10/20/21, JMR

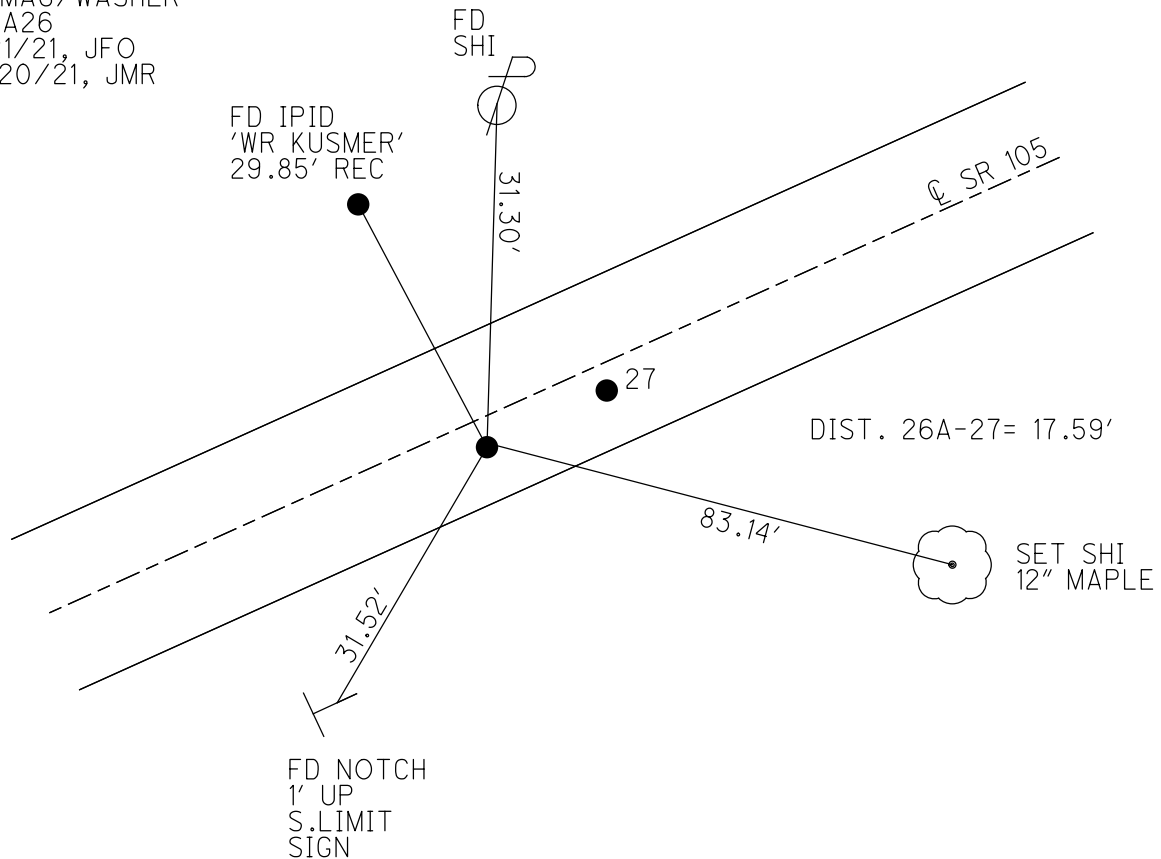

O.D.O.T. DISTRICT 2 SURVEY OFFICE (USE ONLY)

PERSONNEL	REFERENCE NO. <u>26 A</u>	SHEET <u>30</u> OF <u>33</u>
NOTES <u>HOMAN</u>	DATE <u>5/7/13</u>	ROUTE <u>SR 105</u>
H.C. <u>HOMAN</u>	WEATHER <u>CLEAR</u>	COUNTY <u>OTTAWA</u>
R.C. <u>ROUSOS</u>	TEMP. <u>70°</u>	TOWNSHIP <u>HARRIS</u>
		SECTION <u>13</u>
		T <u>6</u> N R <u>13</u> E

TYPE MONUMENT MAG NAIL
 ON SURFACE - ~~BELOW~~ ON
~~LEFT~~ - Q PAV'T - RIGHT 4.1'
6' TO RT EDGE PAVEMENT
 S.L.M. 128+09.41

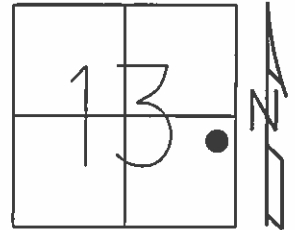

Grid: Northing: 660595.259 Easting: 1748946.721

FD MAG

SET MAG/WASHER
 7/10/13, SDC
 GPS, FINREFOTTA26
 7/11/13, SDC

