

O.D.O.T. DISTRICT 2 SURVEY OFFICE (USE ONLY)

PERSONNEL

REFERENCE NO. 28 A

SHEET 33 OF 33

NOTES BALBAUGH

DATE 4/15/20

ROUTE SR 105

H.C. LEU

WEATHER CLOUDY

COUNTY OTTAWA

R.C. BALBAUGH

TEMP. 39°

TOWNSHIP HARRIS

SECTION 18

DWG BY RHOADES PID CHIP SEAL

T 6 N R 14 E

TYPE MONUMENT MAG NAIL

ON SURFACE - ~~BELOW~~ ON

OFFSET ℄ PAVEMENT 4' LT : ~~RT~~

- TO - EDGE PAVEMENT

STATION: 142+71.85

HORZ. DATUM: NAD83 2011

GEOID: NAVD88 2012A

GRID: NORTHING: 661233.235

EASTING: 1750275.579

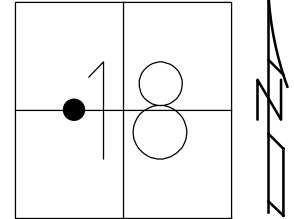

RECORD: P.I.
 $\Delta = 12^{\circ} 34' LT$
 SET P.K./WASHER
 6/21/94, KPM
 FD P.K./WASHER
 4/3/00, MC
 SET P.K./WASHER
 6/21/00, KPM
 FD P.K./WASHER
 OTTREF31
 5/7/13, DCH
 FD MAG NAIL
 REF6
 4/29/15, JLL
 FD MAG NAIL
 REFA28
 4/5/18, JFO

NOTE: REF 6 SR 51

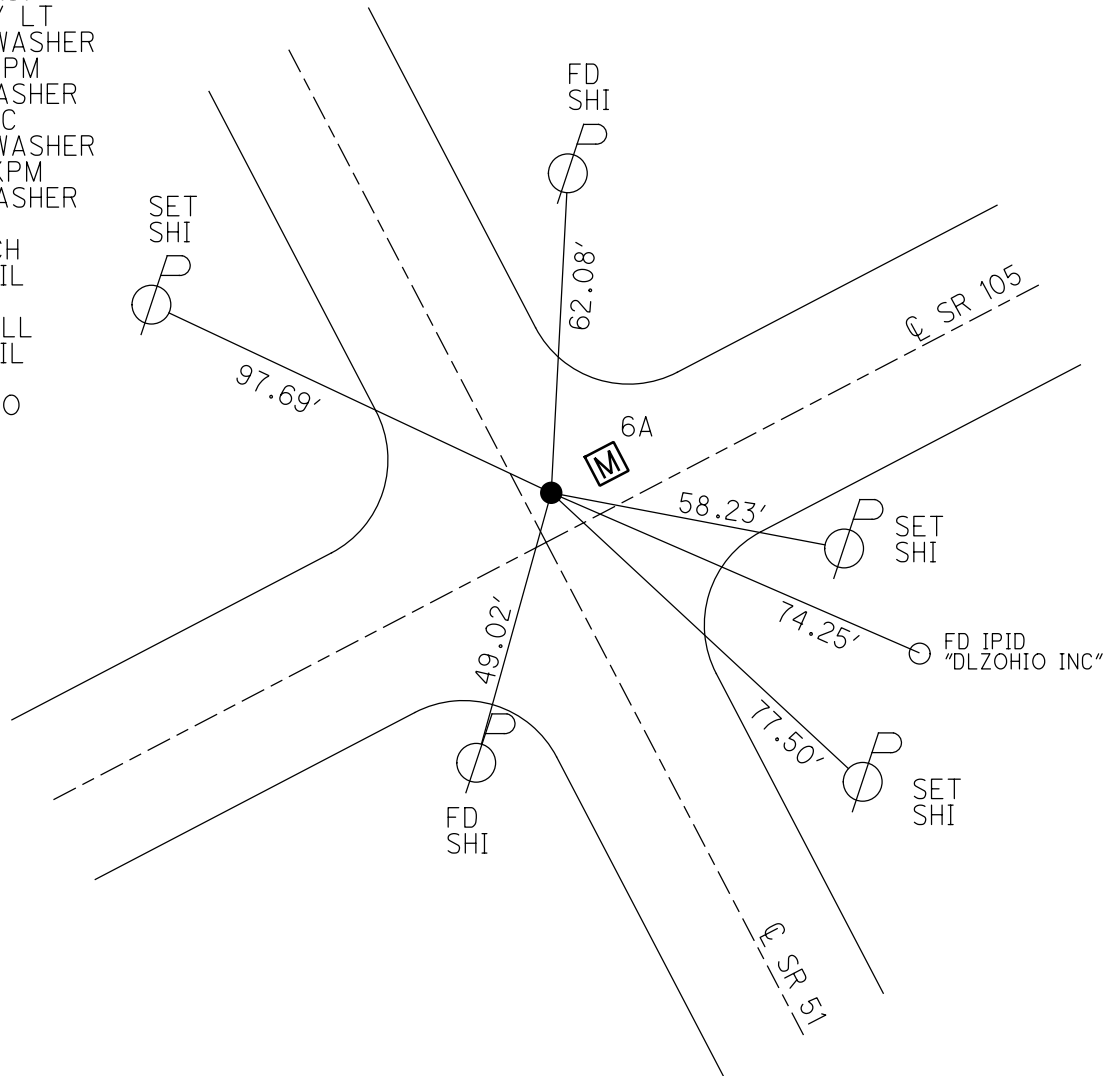

O.D.O.T. DISTRICT 2 SURVEY OFFICE (USE ONLY)

PERSONNEL _____ REFERENCE NO. 28 A SHEET 33 OF 33
 NOTES MOSER DATE 4/3/00 ROUTE SR 105
 H.C. CANTERBURY WEATHER SUNNY COUNTY OTTAWA
 R.C. LUCE TEMP. 50° TOWNSHIP HARRIS
 _____ SECTION 18
 _____ T 6 N R 14 E

TYPE MONUMENT P.K./WASHER

ON SURFACE - ~~BELOW~~ ON _____

LEFT - ℄ PAV'T - ~~RIGHT~~ 4', 2.5' RT. OF ℄ SR51
 - TO - EDGE PAVEMENT

S.L.M. 142+71.85

GRID: NORTHING: 661233.171 EASTING: 1750275.571

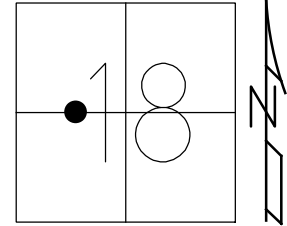

NOTE: REF 6 SR 51

RECORD: P.I.
 $\Delta = 12^\circ 34' \text{ LT}$
 SET P.K./WASHER
 6/21/94, KPM
 FD P.K./WASHER
 4/3/00, MC
 SET P.K./WASHER
 6/21/00, KPM
 FD P.K./WASHER
 OTTREF31
 5/7/13, DCH
 FD MAG NAIL
 REF6
 4/29/15, JLL
 FD MAG NAIL
 REFA28
 4/5/18, JFO

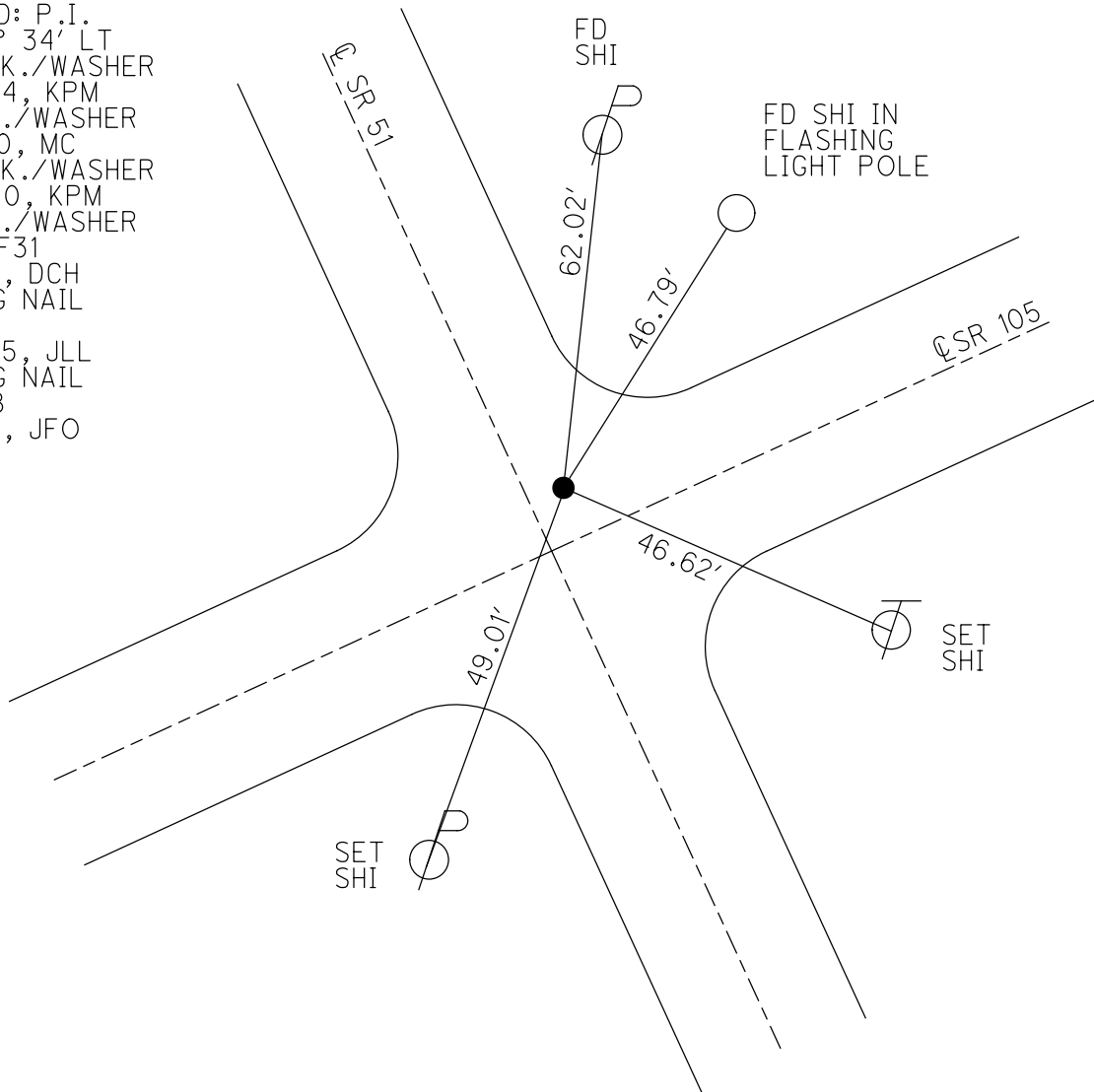

O.D.O.T. DISTRICT 2 SURVEY OFFICE (USE ONLY)

PERSONNEL _____ REFERENCE NO. 28 A SHEET 33 OF 33
 NOTES MOSER DATE 4/3/00 ROUTE SR 105
 H.C. CANTERBURY WEATHER SUNNY COUNTY OTTAWA
 R.C. LUCE TEMP. 50° TOWNSHIP HARRIS
 _____ SECTION 18
 _____ T 6 N R 14 E

TYPE MONUMENT P.K./WASHER

ON SURFACE - ~~BELOW~~ ON _____

LEFT - ☉ PAV'T - ~~RIGHT~~ 4', 2.5' RT. OF ☉ SR51
 - TO - EDGE PAVEMENT

S.L.M. 143+08.8

GRID: NORTHING: 661233.174 EASTING: 1750275.489

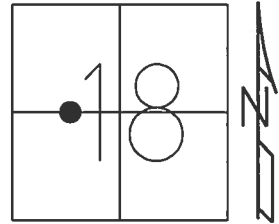

NOTE: REF 28A SR 105

RECORD: P.I.
 $\Delta = 12^\circ 34' \text{ LT}$
 SET P.K./WASHER
 6/21/94, KPM
 FD P.K./WASHER
 4/3/00, MC
 SET P.K./WASHER
 6/21/00, KPM
 FD P.K./WASHER
 OTTREF31
 5/7/13, DCH
 FD MAG NAIL
 REF6
 4/29/15, JLL

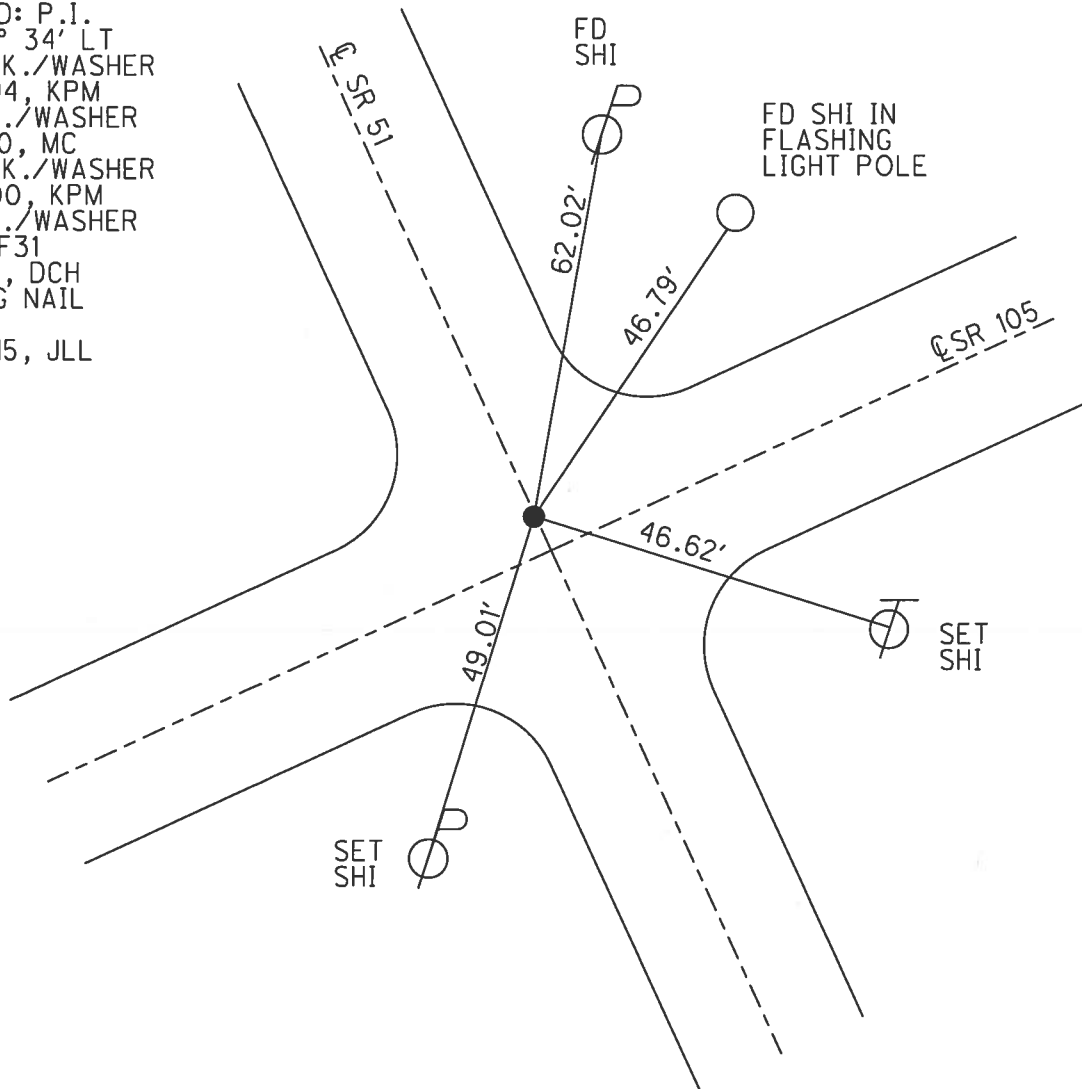

O.D.O.T. DISTRICT 2 SURVEY OFFICE (USE ONLY)

PERSONNEL	REFERENCE NO. <u>28 A</u>	SHEET <u>33</u> OF <u>33</u>
NOTES <u> MOSER</u>	DATE <u>4/3/00</u>	ROUTE <u>SR 105</u>
H.C. <u> CANTERBURY</u>	WEATHER <u> SUNNY</u>	COUNTY <u> OTTAWA</u>
R.C. <u> LUCE</u>	TEMP. <u> 50°</u>	TOWNSHIP <u> HARRIS</u>
		SECTION <u> 18</u>
		T <u>6</u> N R <u>14</u> E

TYPE MONUMENT P.K./WASHER
 ON SURFACE - ~~BELOW~~ ON
 LEFT - C PAV'T - ~~RIGHT~~ 4', 2.5' RT. OF C SR51
 - TO - EDGE PAVEMENT
 S.L.M. 143+08.8, 83+75 SR 51
 Grid: Northing: 661233.174 Easting: 1750275.489

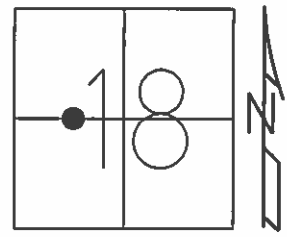

RECORD: P.I.
 $\Delta = 12^\circ 34' \text{ LT}$

RESET P.K./WASHER
 6/21/94, KPM

FD P.K./WASHER
 GPS, OTTREF31
 5/7/13, DH

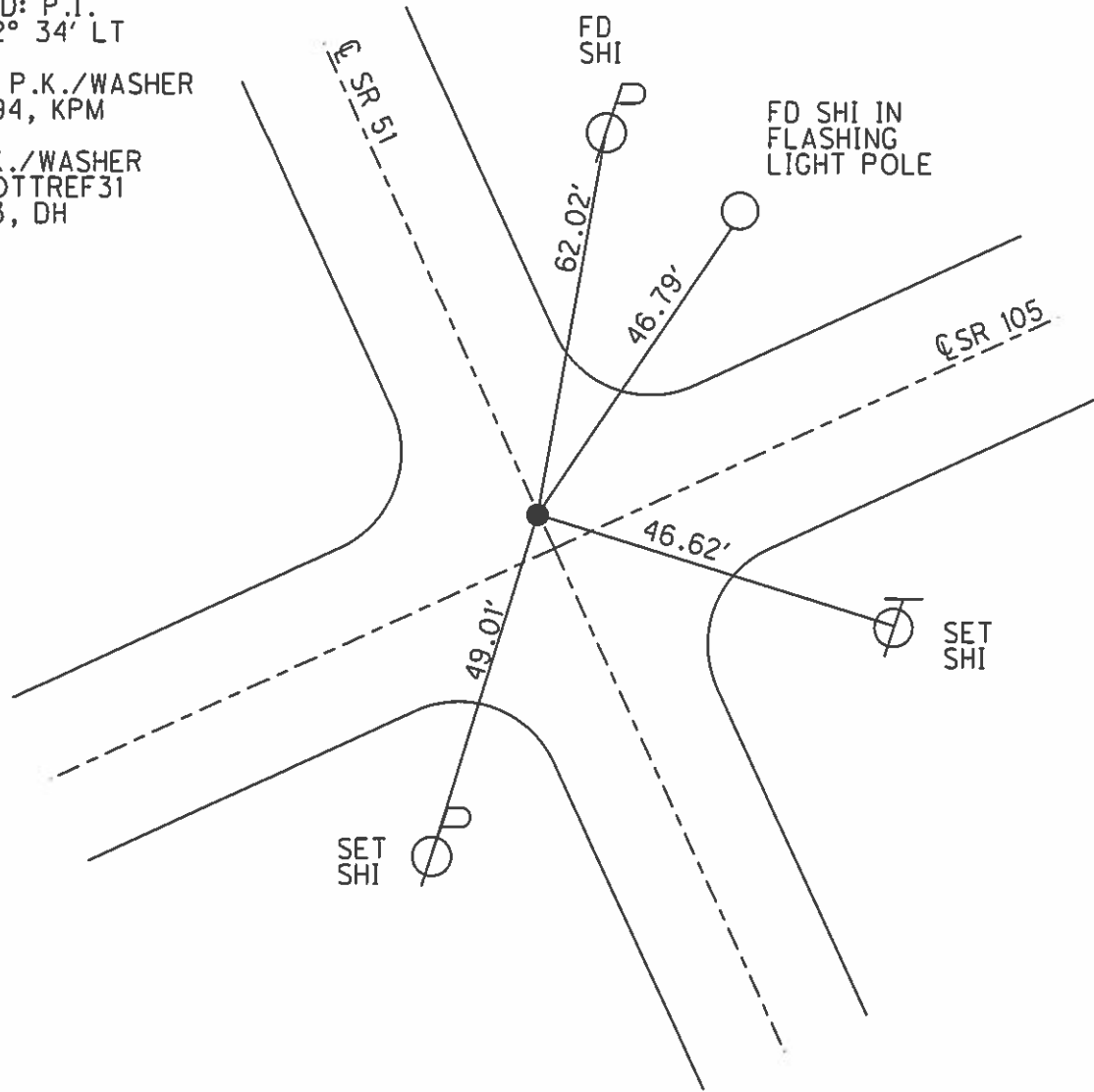

O.D.O.T. DISTRICT 2 SURVEY OFFICE

PERSONNEL

REFERENCE NO. 0 SR51 SHEET 1 OF 96
28-A SR105

NOTES K. MOSER

H.C. M. CANTERBURY

DATE 4-3-00

ROUTE S.R. 51 & 105

R.C. B. LUCE

WEATHER Sunny

COUNTY OTTAWA

TEMP. +50°F

TOWNSHIP HARRIS

SECTION 18

T6 N R 14 E

TYPE MONUMENT PK / WASHER

ON SURFACE - ~~BELOW~~ SURFACE

LEFT - & PAV'T. - RIGHT 4.0' LT. SR 105 + 2.5' RT. SR. 51

- TO - EDGE PAVEMENT

S.L.M. 83 + 75 S.R. 51 ~ 143 + 08.8 S.R. 105

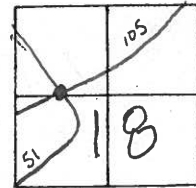

RECORD: P.I.
 $\Delta = 120.34' \text{ LT}$

RESET PK/WASHER
6-21-00
KPM

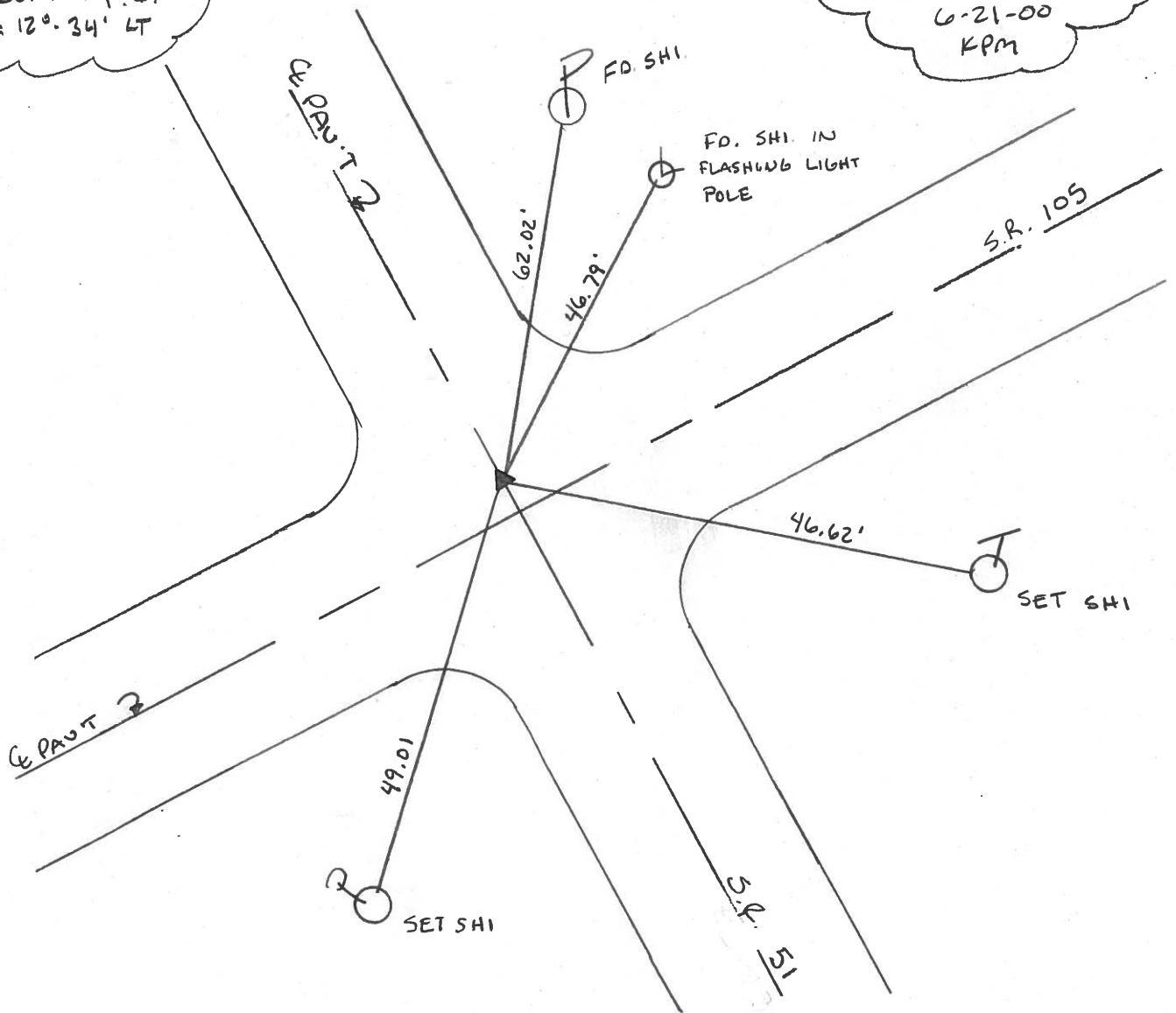

O.D.O.T. DISTRICT 2 SURVEY OFFICE

PERSONNEL

REFERENCE NO. 6

SHEET 5 OF

NOTES Cronin

H.C. Ripple

R.C. Carbour

German

DATE 9/21/87

WEATHER cloudy

TEMP. 65°

ROUTE 51

COUNTY Ottawa

TOWNSHIP Harris

SECTION 18

T G N R I E

TYPE MONUMENT P.K. Washer

ON SURFACE - ~~BELOW~~ on surface

LEFT - ℄ PAV'T. - RIGHT 2.5 Rt. & Pav't

TO EDGE PAVEMENT

S.L.M. 83+40.50 83+75 SE 51

4.0' LT SR 105
2.4' LT SR 51

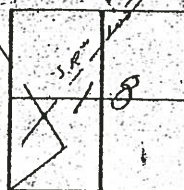

MARK HC
BILL G. RC
KEVIN NOTES
+50°F 4-3-00
Sunny

Reset P.K. WASHER
6-21-00
K.M.

P.I. ℄ S.R. #105
A = 12° 34' Lt.
P.K. at top R.R. spike
below surface

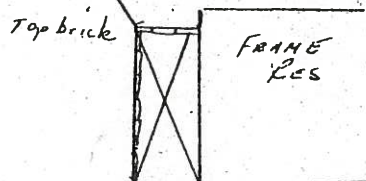
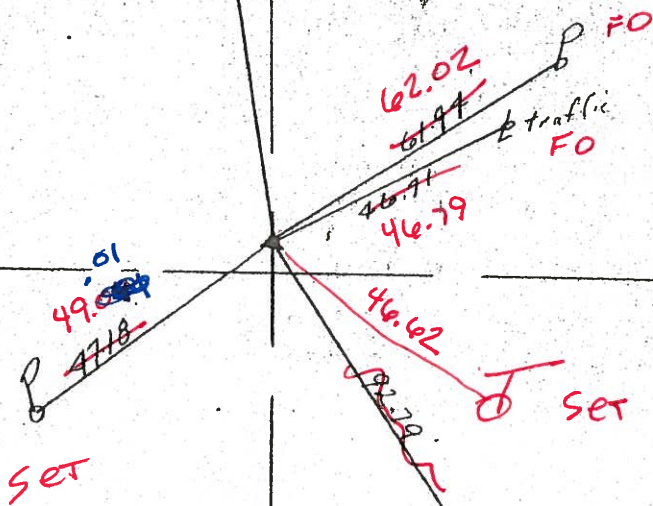

Resurched 2000

O.D.O.T. DISTRICT 2 SURVEY OFFICE

PERSONNEL

REFERENCE NO. 6

SHEET 5 OF

NOTES Cronin

H.C. Ripple

R.C. Garbour

Geeman

DATE 9/21/87

WEATHER cloudy

TEMP. 65°

ROUTE 51

COUNTY Ottawa

TOWNSHIP Harris

SECTION 18

T 6 N R 18 E

TYPE MONUMENT P.K. Washer

ON SURFACE - BELOW on surface

LEFT - & PAV'T. - RIGHT 2.5' Rt. & Pav't.

TO EDGE PAVEMENT

S.L.M. 83+40.50

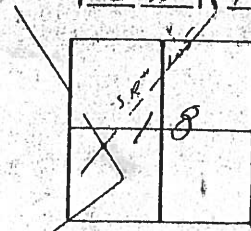

P.I. ± S.R. #105

A = 12° 37' Lt.

P.K. at top R.R. spike

below surface

P 47.18

± S.R. #51

± S.E. #51

61.94
46.71
± traffic

92.79

