

O.D.O.T. DISTRICT 2 SURVEY OFFICE (USE ONLY)

PERSONNEL

REFERENCE NO. 32 A

SHEET 4 OF 63

NOTES RHOADES DATE 7/29/19  
 H.C. O'DONNELL WEATHER SUNNY  
 R.C. MILLER TEMP. 83°  
AUBLE

ROUTE SR 105  
 COUNTY OTTAWA  
 TOWNSHIP HARRIS  
 SECTION 18

DWG BY BALBAUGH PID 92131

T 6 N R 14 E

TYPE MONUMENT P.K./WASHER

ON SURFACE - ~~BELOW~~ ON

OFFSET  $\text{C}$  PAVEMENT 0.7' LT : ~~RT~~

9.7' TO LT EDGE PAVEMENT

STATION: 173+95.90

HORIZ.DATUM: NAD83 2011

GEOID: 2012A

GRID: NORTHING: 662978.939

EASTING: 1752856.905

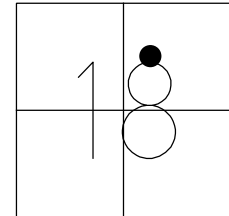

RECORD:  
 FD P.K./WASHER  
 4/3/00, MC  
 SET P.K./WASHER  
 6/21/00, KPM  
 FD P.K./WASHER  
 REFA32  
 4/5/18, JFO  
 FD P.K./WASHER  
 7/29/19, JFO  
 SET MAG/WASHER  
 11/15/19, JFO

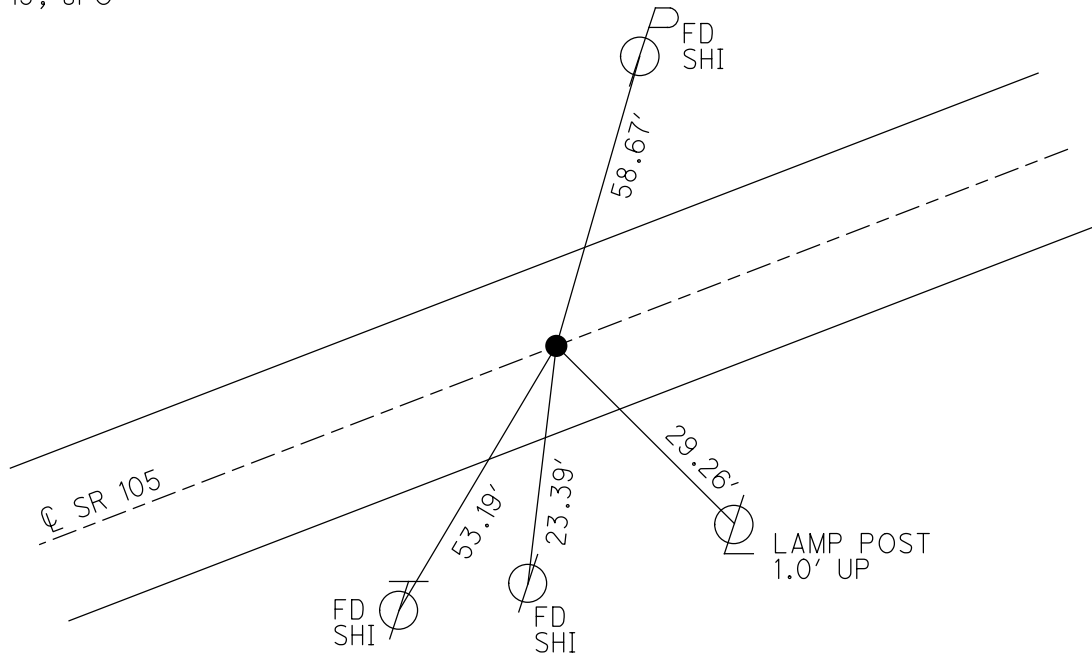

# O.D.O.T. DISTRICT 2 SURVEY OFFICE

PERSONNEL

REFERENCE NO. 32A

SHEET 5 OF 9c

NOTES K. MOSER

H.C. M. CANTERBURY

DATE 4-3-00

ROUTE S.R. 105

R.C. M. BARNHISEL

WEATHER Sunny

COUNTY OTTAWA

TEMP. +50°F

TOWNSHIP HARRIS

SECTION 18

T6 N R 14 E

TYPE MONUMENT PK/WASHER

ON SURFACE - ~~BELOW~~ ON SURFACE

LEFT - ~~C PAV'T~~ RIGHT 0.7 LT

9.7 TO LT. EDGE PAVEMENT

S.L.M. 174 + 44

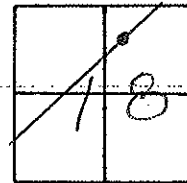

Reset PK/WASHER  
6:21:00  
KPM

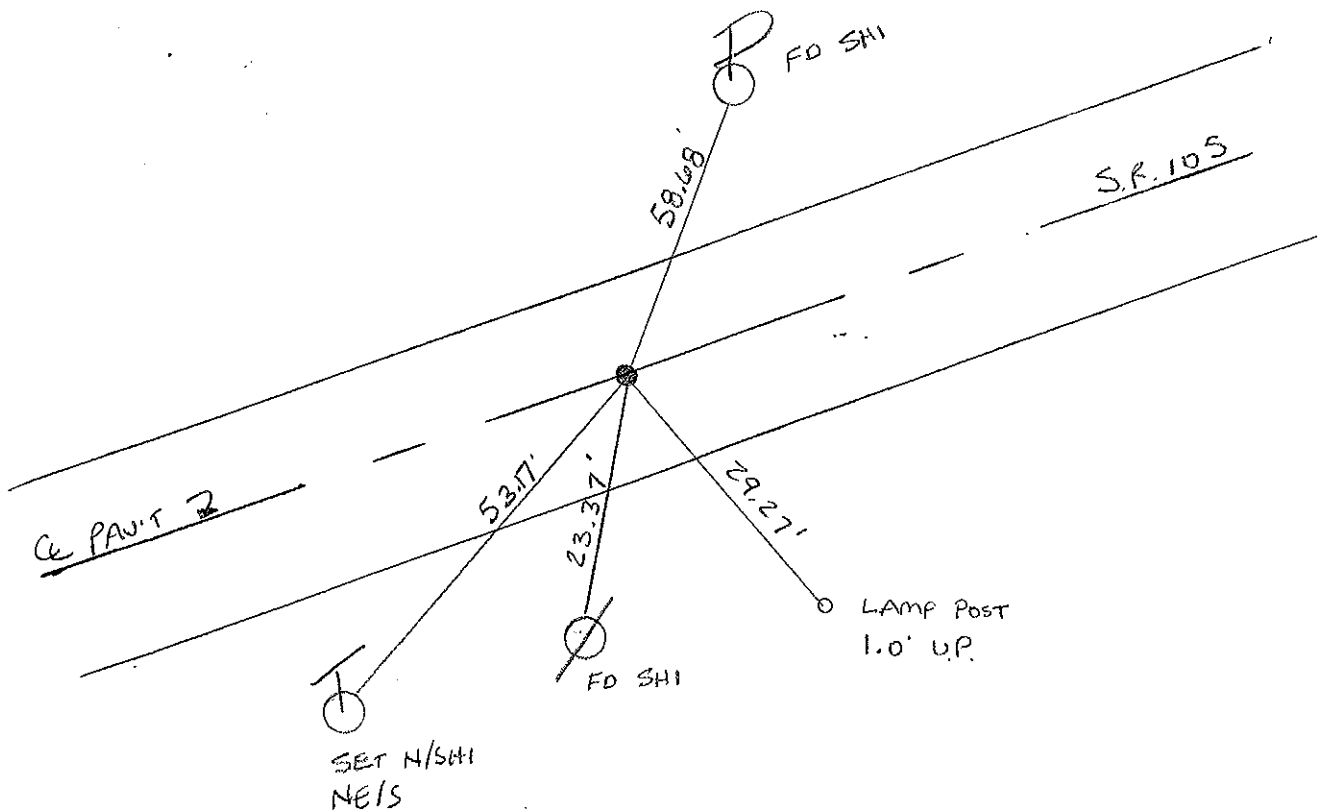

# O.D.O.T. DISTRICT 2 SURVEY OFFICE

## PERSONNEL

NOTES Cronin  
 H.C. Ripple  
 R.G. Barbour  
Geyman

## REFERENCE NO. \_\_\_\_\_

DRAW 9/23/87  
 DATE 5/26/87  
 WEATHER sunny  
 TEMP. 67°

## SHEET \_\_\_\_\_ OF \_\_\_\_\_

ROUTE 105  
 COUNTY Ottawa  
 TOWNSHIP Harris  
 SECTION 18  
 T. 6 N. R. 14 E.

TYPE MONUMENT P.K. & washer  
 ON SURFACE - BELOW on surface  
 LEFT - ~~C~~ PAV'T. - RIGHT & Pav't 0.7  
9.7 TO LT. EDGE PAVEMENT  
 S.L.M. 174+21 174+44

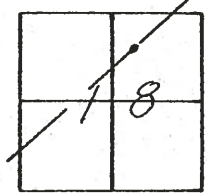

P.K. & washer a top  
P.K. a top small P.K. spike  
below surface

### Reset PK/WASHER

6-21-90

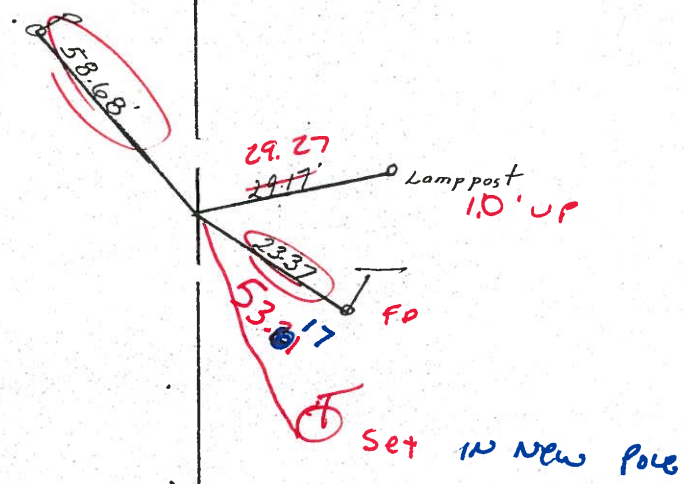

S.R. #105

# O.D.O.T. DISTRICT 2 SURVEY OFFICE

PERSONNEL \_\_\_\_\_

REFERENCE NO. \_\_\_\_\_

SHEET \_\_\_\_\_ OF \_\_\_\_\_

NOTES Cronin

DRAW 9/23/87

H.C. Ripple

DATE 5/26/87

R.C. Barbour

WEATHER sunny

Geyman

TEMP. 67°

ROUTE 105

COUNTY Ottawa

TOWNSHIP Harris

SECTION 18

T 6 N R 14 E

TYPE MONUMENT P.K. & washer

ON SURFACE - BELOW on surface

LEFT - ☉ PAV'T. - RIGHT & Pavt

TO \_\_\_\_\_ EDGE PAVEMENT

S.L.M. 174+21

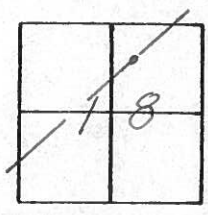

P.K. & washer a top  
P.K. a top small P.K. spike  
below surface

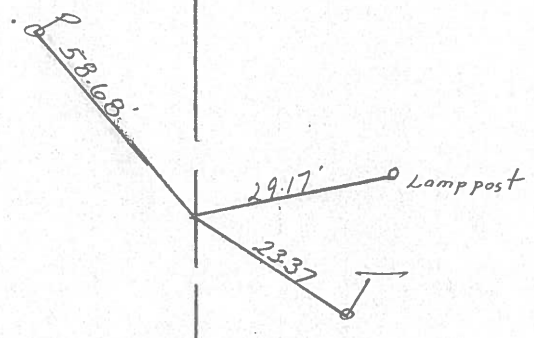

S.R. #105

