

O.D.O.T. DISTRICT 2 SURVEY OFFICE (USE ONLY)

PERSONNEL \_\_\_\_\_ REFERENCE NO. 50 B SHEET 24 OF 63  
 NOTES RHOADES DATE 7/30/19 ROUTE SR 105  
 H.C. O'DONNELL WEATHER PARTLY CLOUDY COUNTY OTTAWA  
 R.C. MILLER TEMP. 75° TOWNSHIP HARRIS  
 \_\_\_\_\_ SECTION 8  
 DWG BY BALBAUGH PID 92131 T 6 N R 14 E

TYPE MONUMENT P.K./WASHER  
 ON SURFACE - ~~BELOW~~ ON  
 OFFSET CL PAVEMENT ON ~~LT~~ : ~~RT~~  
10.0' TO RT EDGE PAVEMENT  
 STATION: 238+846.75

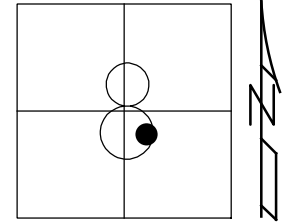

HORIZ.DATUM: NAD83 2011 GEOID: 2012A  
 GRID: NORTHING: 666118.752 EASTING: 1758264.576

RECORD:  
 ORIGIN UNKNOWN  
 POSSIBLE PROP. LINE  
 FD P.K.NAIL  
 4/14/00, MC  
 SET P.K./WASHER  
 6/22/00, KPM  
 FD P.K./WASHER  
 REFB50  
 4/18/18, JFO  
 FD P.K./WASHER  
 7/30/19, JFO  
 SET MAG/WASHER  
 11/18/19, JFO

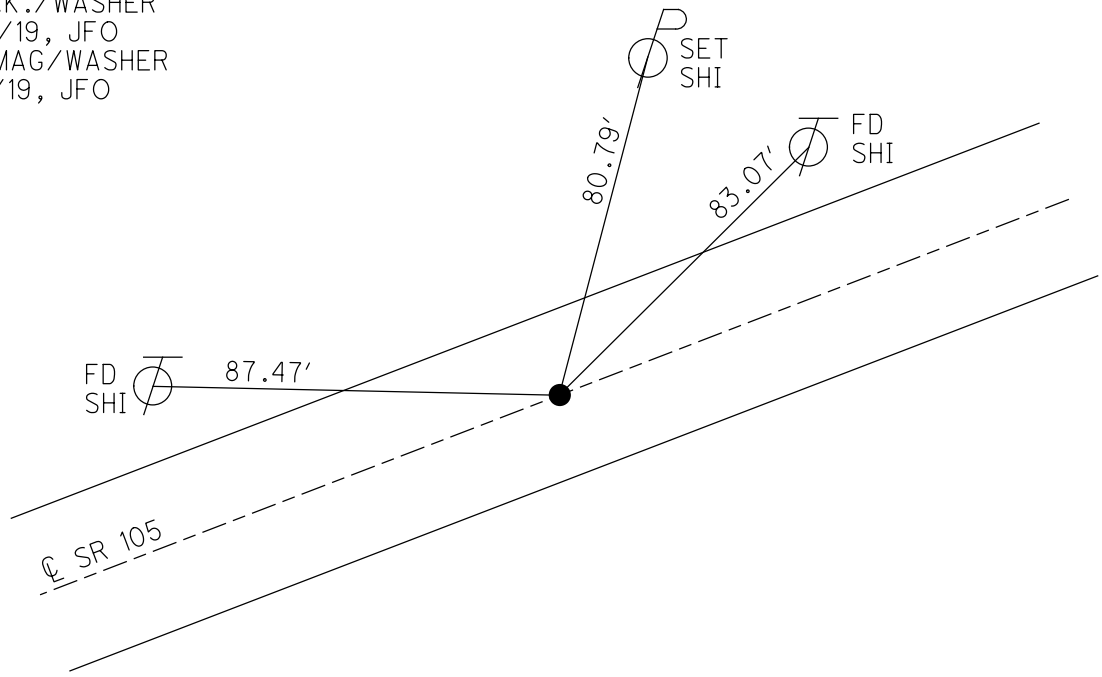

# O.D.O.T. DISTRICT 2 SURVEY OFFICE

PERSONNEL

REFERENCE NO. 50-B

SHEET 20 OF 96

NOTES K. MOSER

H.C. M. CANTERBURY

R.C. M. BARNHISEL

DATE 4-14-00

WEATHER SUNNY

TEMP. +60°F

ROUTE S.R. 105

COUNTY OTTAWA

TOWNSHIP HARRIS

SECTION 8

T6 N R 14 E

TYPE MONUMENT PK NAIL  
 ON SURFACE - ~~BELOW~~ SURFACE  
~~LEFT - & PAV'T. - RIGHT~~ & PAV'T  
10.1 TO RT. EDGE PAVEMENT  
 S.L.M. 239 + 06

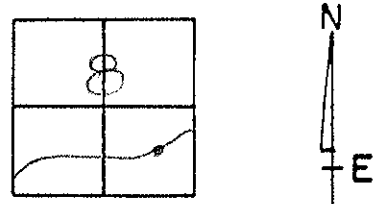

ORIGON UNKNOWN  
 POSSIBLE PROP. LINE

RESET PK/WASHER  
 6-22-00  
 KPM

