

# O.D.O.T. DISTRICT 2 SURVEY OFFICE

PERSONNEL

REFERENCE NO. 65-A

SHEET      OF     

NOTES Hoffman

H.C. Loehrk

R.C. Barthel

DATE 5-9-85

WEATHER Clear

TEMP. +65°

ROUTE SR 105

COUNTY OTTAWA

TOWNSHIP HARRIS

SECTION 9

T      R     

TYPE MONUMENT Set, P.K./Washer

ON SURFACE - BELOW yes

LEFT- & PAV'T. - RIGHT 1.75

8.3' TO LT. EDGE PAVEMENT

S.L.M. 298 + 66.0

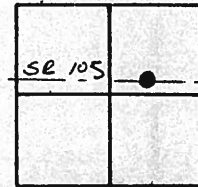

Est. P.I. BY INTERSECTING TANGENT LINES

$\Delta RT. = 3^{\circ} - 15' - 00''$

$E = 1.75'$

$L = 246.82$

$D = 1,3167^{\circ}$

$T = 123.45$  117.37

$R = 1764.11$

43.5

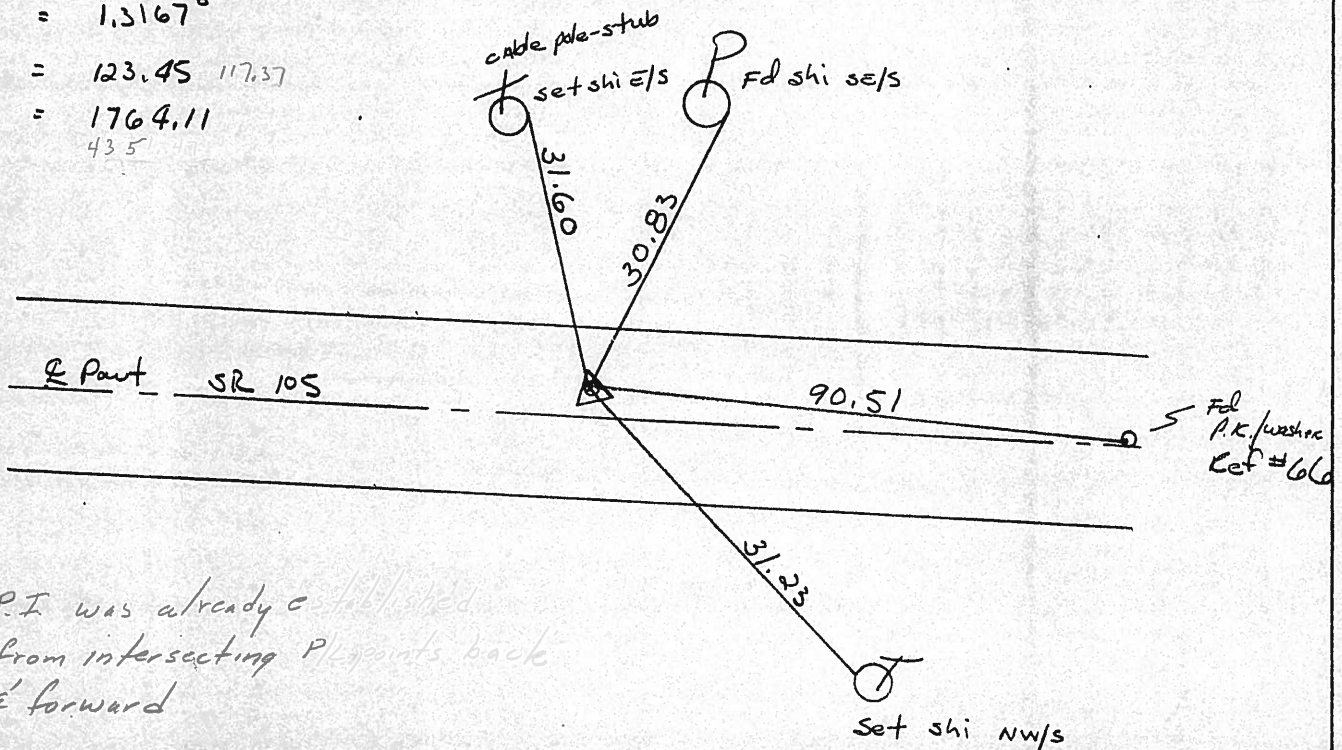

\* P.I. was already established from intersecting P.I. points back & forward

# O.D.O.T. DISTRICT 2 SURVEY OFFICE

PERSONNEL \_\_\_\_\_

REFERENCE NO. 65-A

SHEET \_\_\_\_\_ OF \_\_\_\_\_

NOTES Hoffman

H.C. LOSHRKE

DATE 5-9-85

ROUTE SR 105

R.C. BARNHILL

WEATHER Clear

COUNTY OTTAWA

TEMP. +65°

TOWNSHIP HARRIS

SECTION 9

T \_\_\_\_\_ R \_\_\_\_\_

TYPE MONUMENT Set P.K./Washer

ON SURFACE - BELOW yes

LEFT-~~☉~~ PAV'T. - RIGHT 1.75

8.3' TO Lt. EDGE PAVEMENT

S.L.M. 298 + 66.0

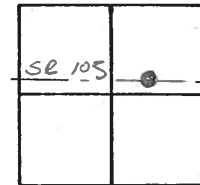

Est. P.I. BY INTERSECTING TANGENT LINES

$\Delta RT. = 3^{\circ} - 15' - 00''$

$E = 1.75'$

$L = 246.82$

$D = 1,3167^{\circ}$

$T = 123.45$

$R = 1764.11$

