

O.D.O.T. DISTRICT 2 SURVEY OFFICE (USE ONLY)

PERSONNEL \_\_\_\_\_ REFERENCE NO. 92 SHEET 3 OF 42  
 NOTES RHOADES DATE 8-1-2019 ROUTE SR 105  
 H.C. O'DONNELL WEATHER SUNNY COUNTY OTTAWA  
 R.C. MILLER TEMP. 74°F TOWNSHIP HARRIS  
 SECTION 11  
 DWG BY AUBLE PID 92131 T 6 N R 14 E

TYPE MONUMENT P.K./WASHER  
 ON SURFACE - ~~BELOW~~ ON  
 OFFSET 0.7' ± : RT  
9.9' TO RT EDGE PAVEMENT  
 STATION: 396+85.99

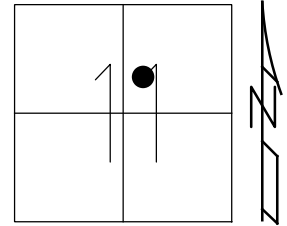

HORZ.DATUM: NAD83 (2011) GEOID: 2012A  
 GRID: NORTHING: 667174.743 EASTING: 1773712.236

RECORD:  
 FD P.K./WASHER  
 4/24/00, MB  
 SET P.K./WASHER  
 6-14-00, MDB  
 FD P.K./WASHER  
 REF92  
 4-30-18, JFO  
 SET MAG/WASHER  
 4-3-20, JFO

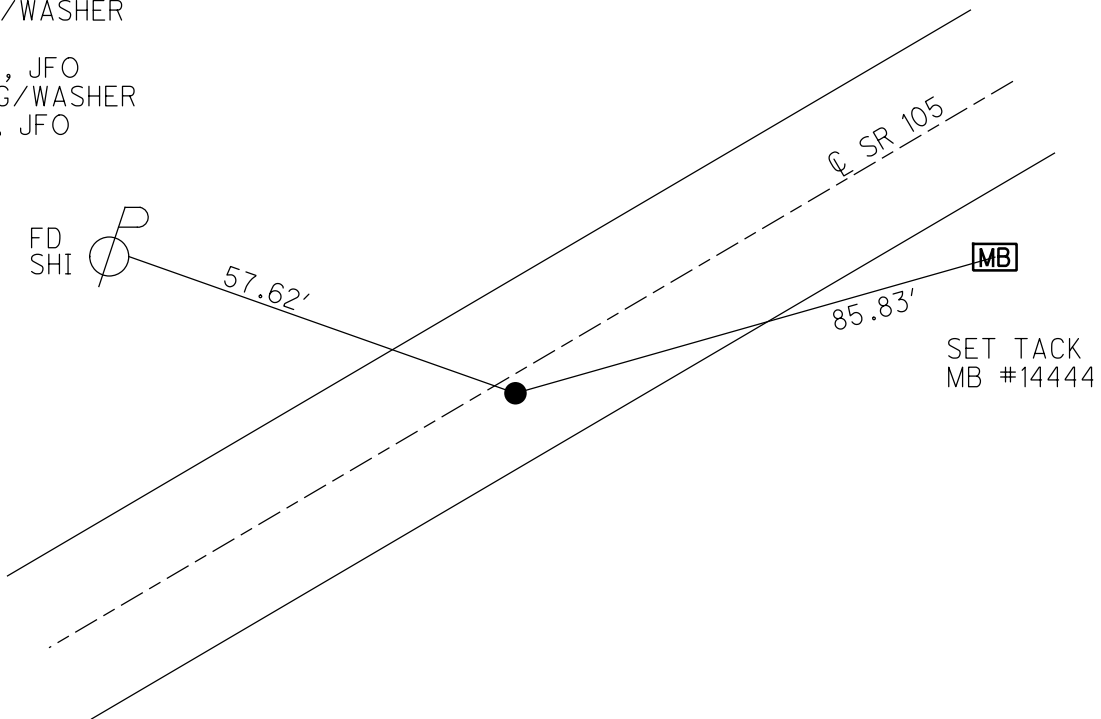

O.D.O.T. DISTRICT 2 SURVEY OFFICE

PERSONNEL

REFERENCE NO. 92

SHEET 59 OF 96

NOTES M. BARNHISEL

H.C. M. CANTERBURY

R.C. M. BARNHISEL

DATE 4-24-00

WEATHER Sunny

TEMP. 76.0°F

Drawn By: K. MOSER

ROUTE S.R. 105

COUNTY OTTAWA

TOWNSHIP HARRIS

SECTION 11

T 14 N R 14 E

TYPE MONUMENT PK / WASHER

ON SURFACE - ~~BELOW~~ SURFACE

LEFT - C PAV'T. - RIGHT 0.7' RT

9.9 TO RT. EDGE PAVEMENT

S.L.M. 397 +92

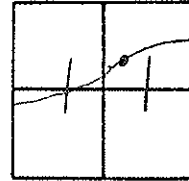

RESEST PK / WASHER  
6-14-00  
M.B.S.

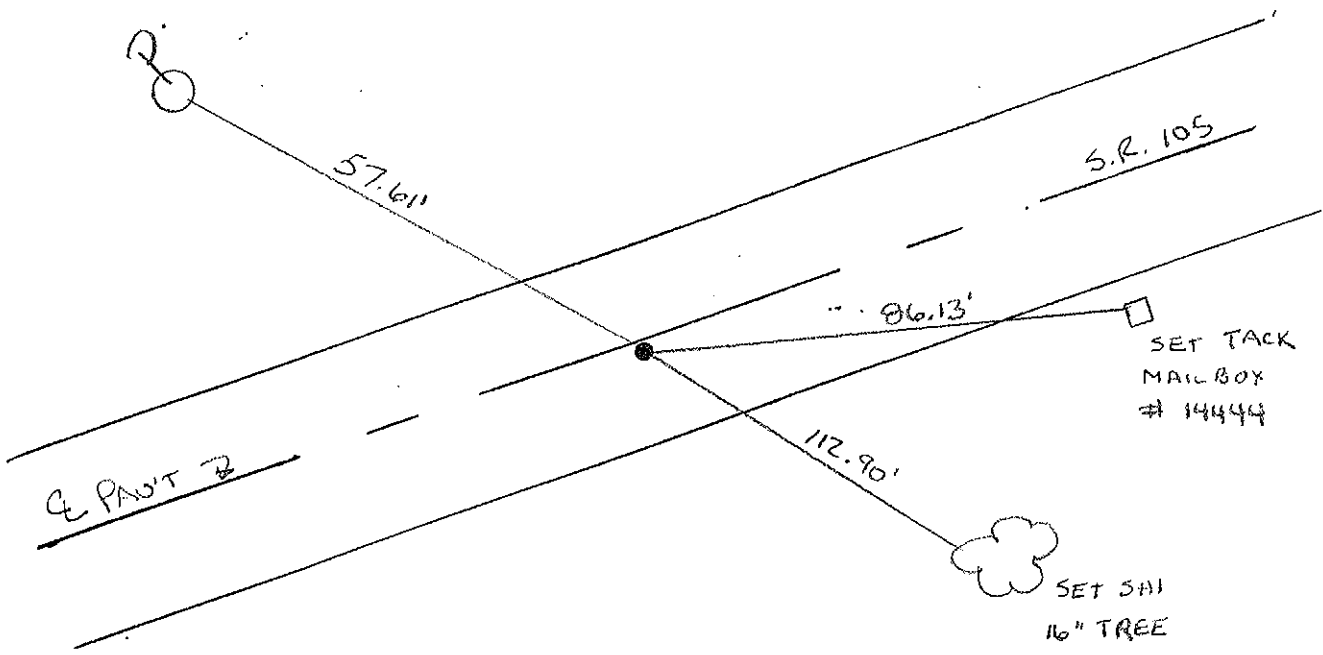

# O.D.O.T. DISTRICT 2 SURVEY OFFICE

PERSONNEL

REFERENCE NO. 92

SHEET      OF     

NOTES Cronin

DRAWN 6/02/88

H.C. Ripple

DATE 8/20/87

ROUTE #105

R.G. Barboun

WEATHER sunny

COUNTY Ottawa

Geyman

TEMP. 72°

TOWNSHIP Harris

SECTION 11

T. 6 N. 14 E.

TYPE MONUMENT P.K. & Washer

ON SURFACE - BELOW     

LEFT -      PAV'T. - RIGHT     

     TO      EDGE PAVEMENT

S.L.M. 397+10

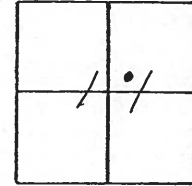

P.K. a top P.K. below  
P.K. & washer

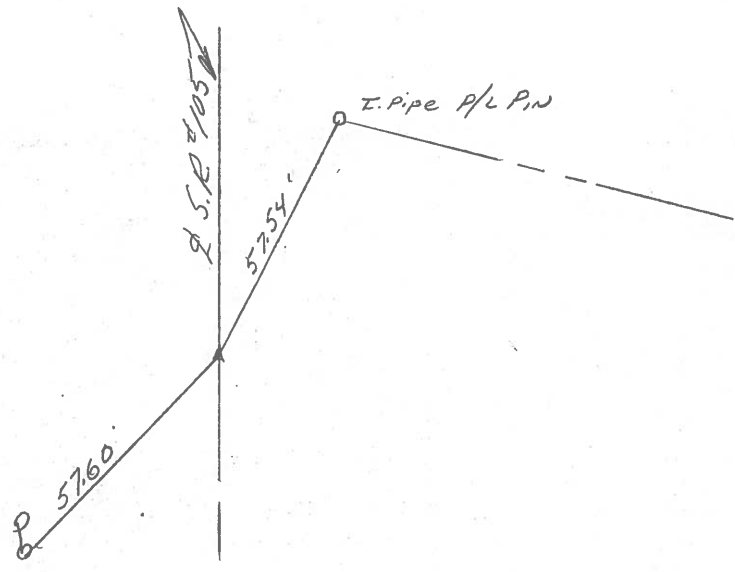

<u>Schneider</u>	<u>          </u>	<u>          </u>	<u>          </u>	COUNTY <u>Ottawa</u>	DATE <u>5-2-74</u>
<u>Mosser</u>	<u>          </u>	<u>Cranin</u>	<u>          </u>	S. R. <u>105</u>	WEATHER <u>Fair</u>
<u>Barbour</u>	<u>          </u>	<u>Ripple</u>	<u>          </u>	SEC. <u>11</u>	TEMP. <u>55°</u>
		<u>Geyman</u>			

DESCRIPTION Harris Top      LEFT      CENTER LINE      RIGHT      JOB NO.           

