

O.D.O.T. DISTRICT 2 SURVEY OFFICE (USE ONLY)

PERSONNEL

REFERENCE NO. 114

SHEET 25 OF 42

NOTES RHOADES

DATE 5-16-18

ROUTE SR 105

H.C. O'DONNELL

WEATHER FAIR

COUNTY OTTAWA

R.C. TRENKA

TEMP. 66°F

TOWNSHIP SALEM

DWG BY MAHLER PID 92131

SECTION 7

T 6 N R 14 E

TYPE MONUMENT LG.R.R.SPIKE

~~ON SURFACE~~ - BELOW 6"

OFFSET Q PAVEMENT 0.4' ~~ET~~ : RT

9.8' TO RT EDGE PAVEMENT

STATION: 481+28.26

HORZ.DATUM: NAD83 (2011)

GEOID: 2012A

GRID: NORTHING: 668943.236

EASTING: 1781947.907

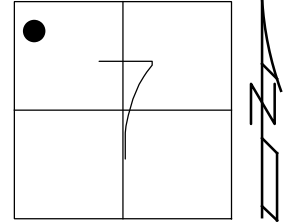

RECORD:
 FD P.K.NAIL
 6/6/88, CRONIN
 FD LG.R.R.SPIKE
 4/26/00, MB
 SET P.K./WASHER
 6-13-00, KPM
 FD R.R.SPIKE
 6" DOWN
 REF114
 5-16-18, JFO
 SET MAG/WASHER
 4-13-20, JFO

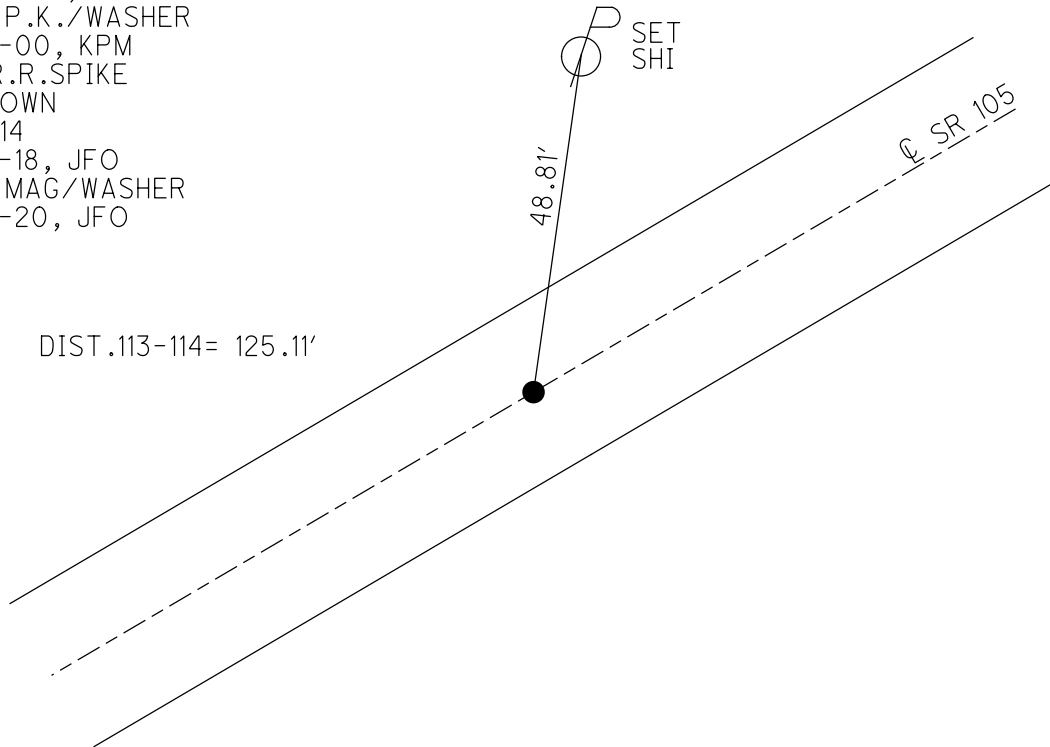

O.D.O.T. DISTRICT 2 SURVEY OFFICE

PERSONNEL

REFERENCE NO. 114

SHEET 81 OF 96

NOTES K. MOSER

H.C. M. CAUTELBURY

R.C. M. BALNISEL

DATE 4-26-00

WEATHER SUNNY

TEMP. +60°F

ROUTE S.R. 105

COUNTY OTTAWA

TOWNSHIP SALEM

SECTION 7

T6 N R 14 E

TYPE MONUMENT L6. RR. SPIKE

ON SURFACE - BELOW SURFACE

~~LEFT - C. PAV'T.~~ - RIGHT 0.4 RT.

9.8 TO RT. EDGE PAVEMENT

S.L.M. 482 +49

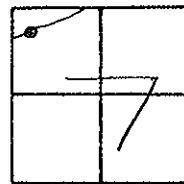

RESET PK/WASHER
6-13-00
K.P.M

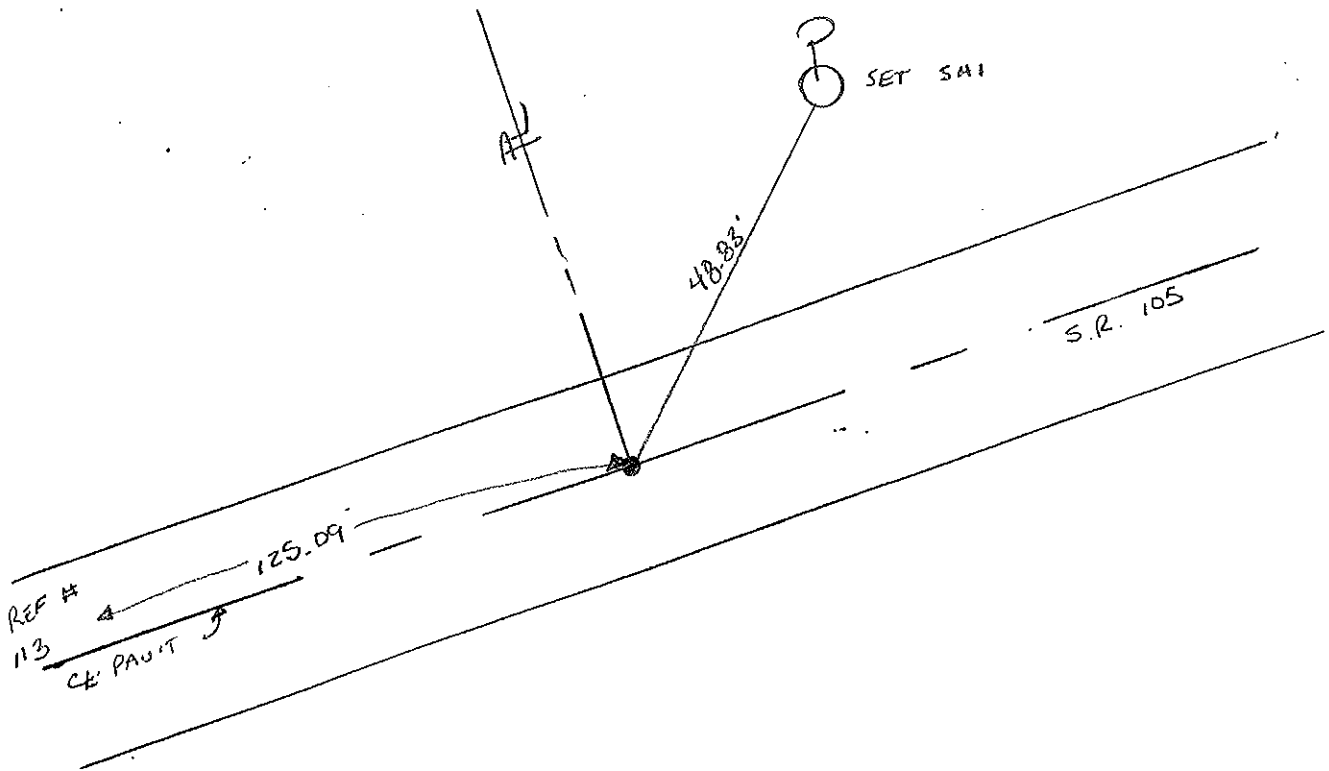

O.D.O.T. DISTRICT 2 SURVEY OFFICE

PERSONNEL

REFERENCE NO. 114

SHEET OF

NOTES Cronin

DRAW 6/06/88

H.C. Ripple

DATE 8/20/87

ROUTE #105

R.C. Barbour

WEATHER sunny

COUNTY Ottawa

Geyman

TEMP. 83°

TOWNSHIP Salem

SECTION 7

T 6 N R 14 E

TYPE MONUMENT P.K. ~~marker~~

ON SURFACE - BELOW

LEFT - PAV'T. - RIGHT 1.0'

 TO EDGE PAVEMENT

S.L.M. 487+33

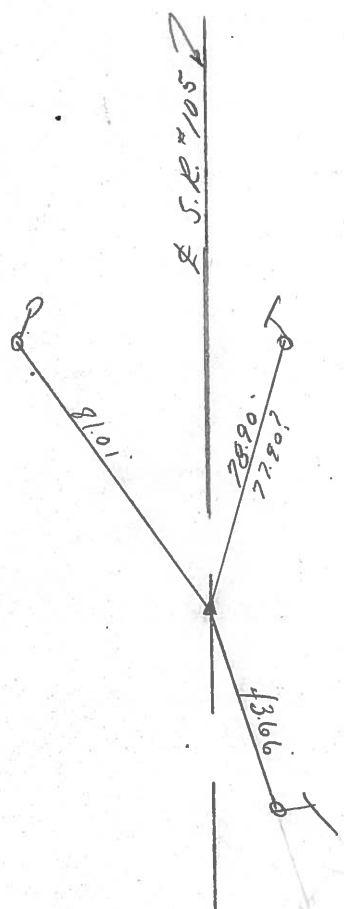
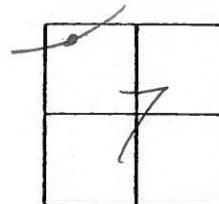

P.K. below P.K.
d.g. when needed

PERSONNEL	TITLE	PERSONNEL	TITLE	COUNTY	DATE	WEATHER	TEMP.
<u>SCHNEIDER</u>		<u>ASH</u>		<u>OTTAWA</u>	<u>5-21-74</u>		
<u>MOSSE</u>		<u>CRONIN</u>		S. R. <u>105</u>			
<u>BARBOUR</u>		<u>RIPPLE</u>		SEC. <u>12</u>			
		<u>GEYMAN</u>					

DESCRIPTION _____ LEFT _____ CENTER LINE _____ RIGHT _____ JOB NO. _____

