

O.D.O.T. DISTRICT 2 SURVEY OFFICE (USE ONLY)

PERSONNEL _____ REFERENCE NO. 125 SHEET 37 OF 42
 NOTES RHOADES DATE 8-5-2019 ROUTE SR 105
 H.C. O'DONNELL WEATHER SUNNY COUNTY OTTAWA
 R.C. MILLER TEMP. 78°F TOWNSHIP SALEM
 DWG BY MAHLER PID 92131 SECTION 5
 T 6 N R 14 E

TYPE MONUMENT P.K./WASHER
 ON SURFACE - ~~BELOW~~ ON
 OFFSET Q PAVEMENT ON LT : RT
10.3' TO LT EDGE PAVEMENT
 STATION: 539+36.9

HORZ.DATUM: NAD83 (2011) GEOID: 2012A
 GRID: NORTHING: 670879.430 EASTING: 1787388.194

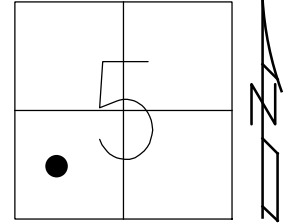

RECORD:
 FD P.K.NAIL
 4/25/00, MB
 SET P.K./WASHER
 6-13-00, KPM
 FD P.K./WASHER
 REF125
 5-9-18, JFO
 SET MAG/WASHER
 4-13-20, JFO

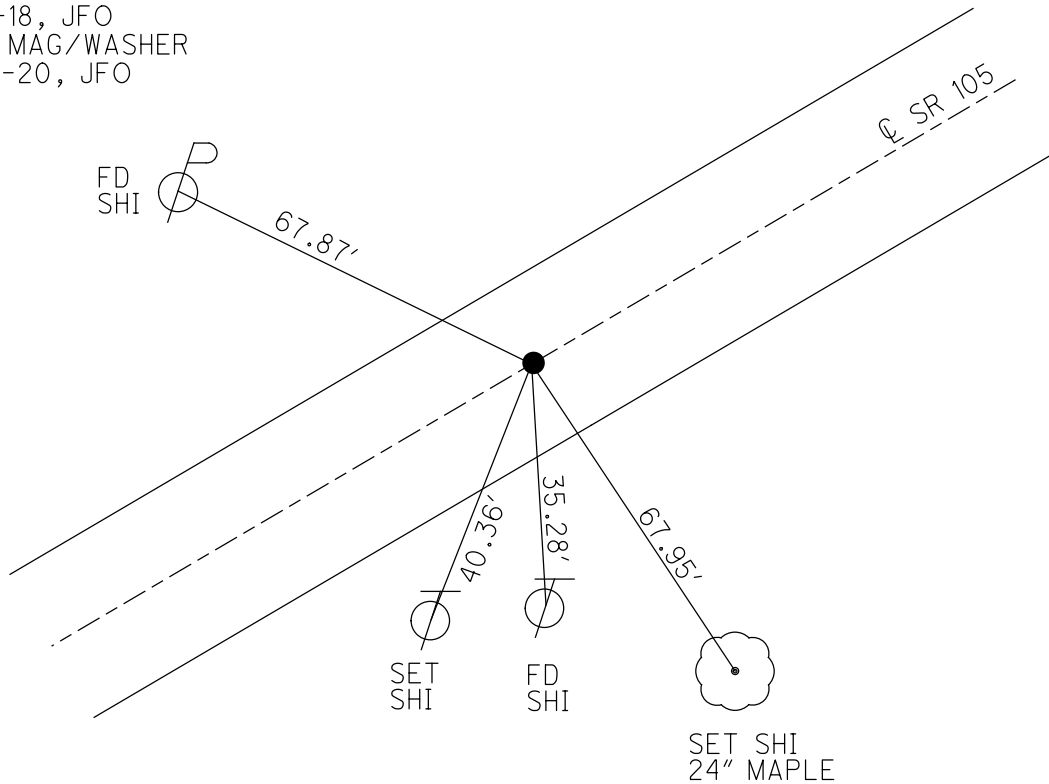

O.D.O.T. DISTRICT 2 SURVEY OFFICE

PERSONNEL

REFERENCE NO. 125

SHEET 92 OF 96

NOTES K. MOSER

H.C. M. CARTERBURY

DATE 4-25-00

ROUTE S.R. 105

R.C. M. BARNHISEL

WEATHER Sunny / BREEZY

COUNTY OTTAWA

TEMP. +60°F

TOWNSHIP SALEM

SECTION 5

T6 N R 14 E

TYPE MONUMENT PK NAIL
 ON SURFACE - BELOW SURFACE
 LEFT - CE PAVT. - RIGHT CE PAVT
10.3 TO LT. EDGE PAVEMENT
 S.L.M. 540 + 72

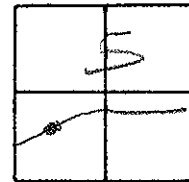

RESET PK/WASHER
 6-13-00
 12 P.M.

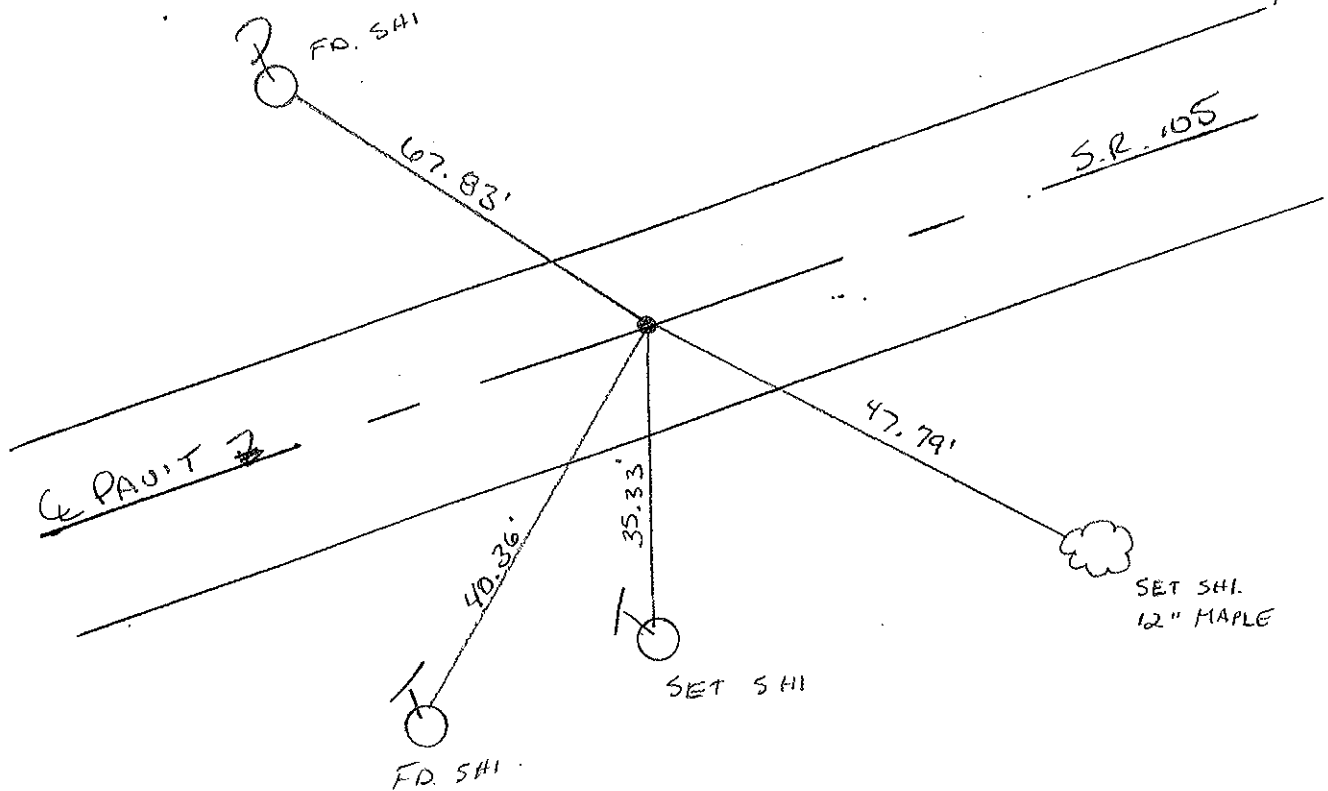

PERSONNEL	TITLE	PERSONNEL	TITLE	COUNTY	DATE	WEATHER	TEMP.
<u>Schneider</u>		<u>Cronin</u>		<u>Ottawa</u>	<u>6-17-74</u>	<u>Cloudy</u>	<u>60°</u>
<u>Mosser</u>		<u>Ripple</u>		<u>S. R. 105</u>			
<u>Barbour</u>		<u>Geyman</u>		<u>SEC. 655</u>			

DESCRIPTION Salem Twp. JOB NO. _____

