

O.D.O.T. DISTRICT 2 SURVEY OFFICE (USE ONLY)

PERSONNEL

REFERENCE NO. 60 A

SHEET 26 OF 74

NOTES CORDES

DATE 8-2-00

ROUTE SR 163

H.C. ROUSOS

WEATHER CLOUDY

COUNTY OTTAWA

R.C. KARGER

TEMP. 82°

TOWNSHIP SALEM

SECTION 4

DWG BY JAMES

PID 95757

T 6 N R 15 E

TYPE MONUMENT IPIN - CNPT

ON SURFACE - BELOW -

OFFSET \odot PAVEMENT - LT : RT

- TO - EDGE PAVEMENT

STATION: 787+76

HORZ. DATUM: -

GEOID: -

GRID: NORTHING: -

EASTING: -

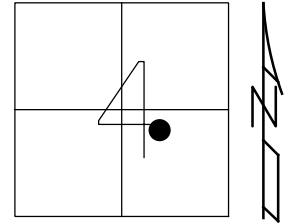

RECORD: P.I.
 $\Delta = 33^\circ 13'30''$ LT
 STA 61+95.30
 6-1-47 R/W PLANS
 D= 12°00'
 R= 477.46'
 T= 142.45'
 L= 276.88'
 E= 20.80'
 FD REBAR
 8-2-00, BC
 DNF
 5-4-16, DCH

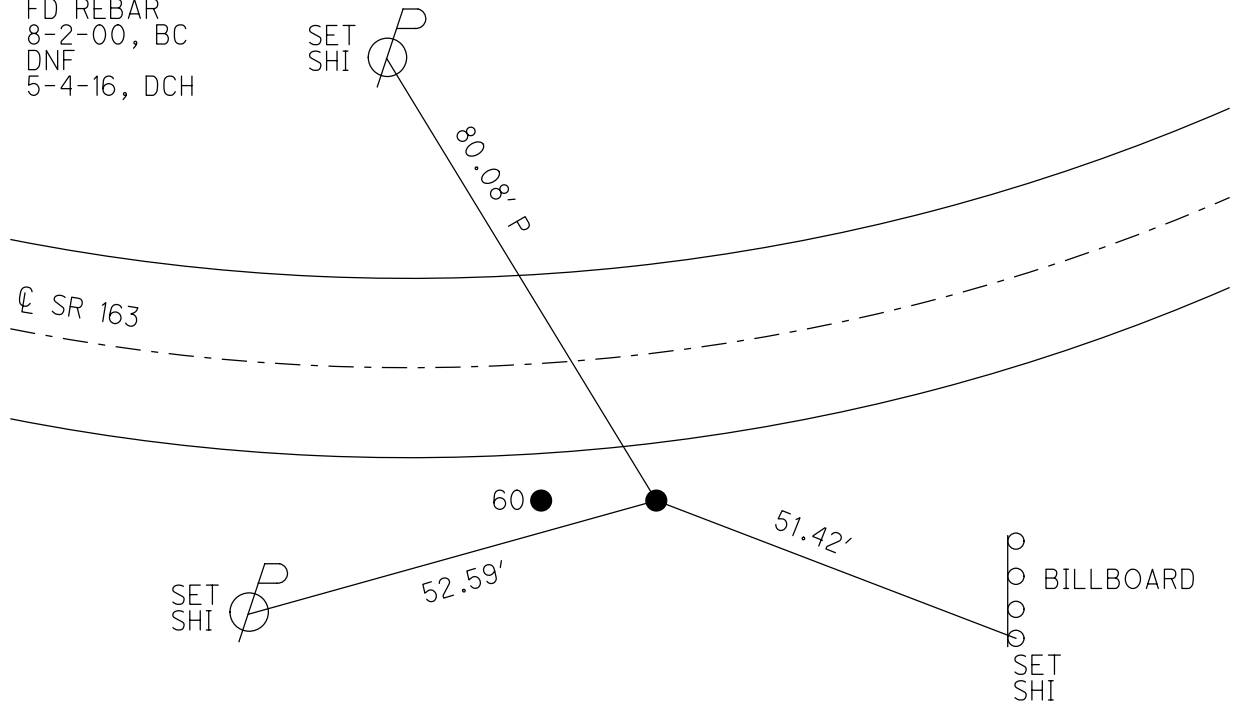

DIST. 60-60A = 8.91' REC

O.D.O.T. DISTRICT 2 SURVEY OFFICE

PERSONNEL

REFERENCE NO. 60

SHEET 16 OF 63

NOTES Cordis

H.C. Rousos

R.C. Karger

DATE 8-2-00

WEATHER Cldy

TEMP. 82°

ROUTE S.R. 163

COUNTY OTTAWA

TOWNSHIP SALEN

SECTION 4

T. 6 N R. 15 E

TYPE MONUMENT ^(A) 5/8" Re-BAR - 40" Long
 ON SURFACE - ~~BELOW~~ Surface
~~LEFT OF PAV'T.~~ - (RIGHT) off pavement
22' TO R+ EDGE PAVEMENT
 S.L.M. (A) = 787+67 (B) = 787+76

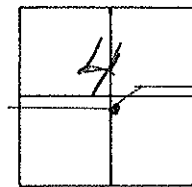

Record: ^(B)
 P.I. Sta 61+95.30 & Survey
 (6-1-1947 R/W PLANS)

Record A
 PI - Δ 33° 34' Lt,
 I Pin
 Plan Sta. = 61+87.28
 Const.

