

O.D.O.T. DISTRICT 2 SURVEY OFFICE (USE ONLY)

PERSONNEL

REFERENCE NO. 62 A

SHEET 30 OF 74

NOTES RHOADES

DATE 1-4-19

ROUTE SR 163

H.C. LEU

WEATHER SUNNY

COUNTY OTTAWA

R.C. MILLER

TEMP. 35°

TOWNSHIP SALEM

SECTION 4

DWG BY JAMES

PID 95757

T 6 N R 15 E

TYPE MONUMENT MAG/WASHER

ON SURFACE - ~~BELOW~~ ON

OFFSET Q PAVEMENT 3.5' LT : RT

8.6' TO RT EDGE PAVEMENT

STATION: 791+90

HORIZ.DATUM: NAD83 2011

GEOID: NAVD88 2012A

GRID: NORTHING: 671619.799

EASTING: 1795691.808

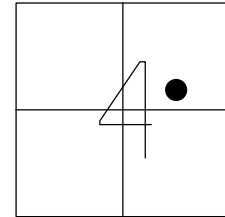

RECORD: P.C.  
 STA 66+18.19  
 FD P.K./WASHER  
 8-2-00, TMR  
 SET P.K./WASHER  
 12-5-00, SAH  
 SET MAG/WASHER  
 REFA62  
 5-5-16, DCH  
 FD MAG/WASHER  
 7-10-17, JLL  
 SET MAG/WASHER  
 1-4-19, JLL

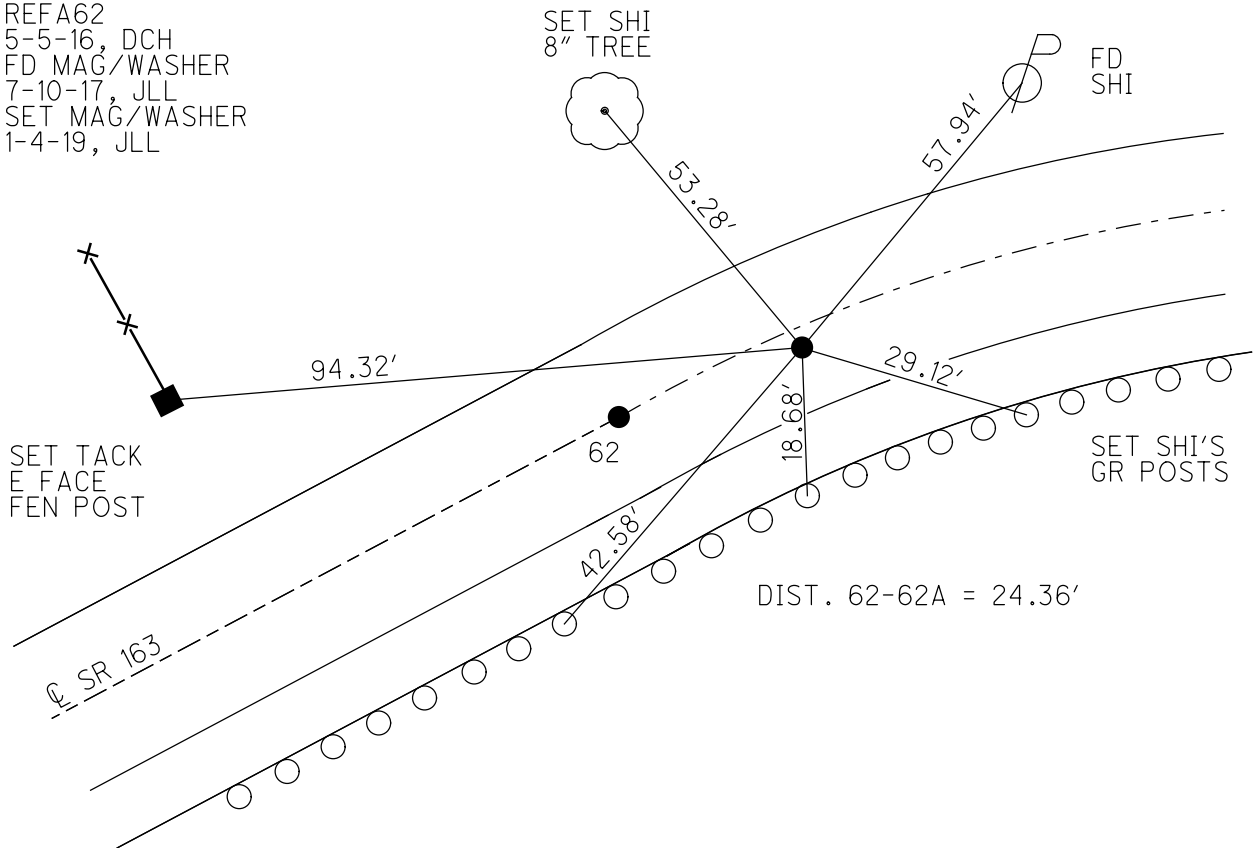

# O.D.O.T. DISTRICT 2 SURVEY OFFICE

PERSONNEL \_\_\_\_\_

REFERENCE NO. 62-A

SHEET 20 OF 63

NOTES Cordes

H.C. Roucos

R.C. Karger

DATE 8-2-60

WEATHER Sun

TEMP. 85°

ROUTE S.R. 163

COUNTY OTTAWA

TOWNSHIP SALEM

SECTION 4

T 6 N R 15 E

TYPE MONUMENT PK/W

~~ON SURFACE~~ ~~BELOW~~ Surface

~~RIGHT~~ RIGHT 3.5'

8.6' TO RT. EDGE PAVEMENT

S.L.M. 791+90

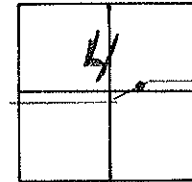

RECORD PC.  
Sta 66+18.19 & Survey  
(6-1-1947) R.W. PLANS

Set PK/W  
12-5-00  
SAH

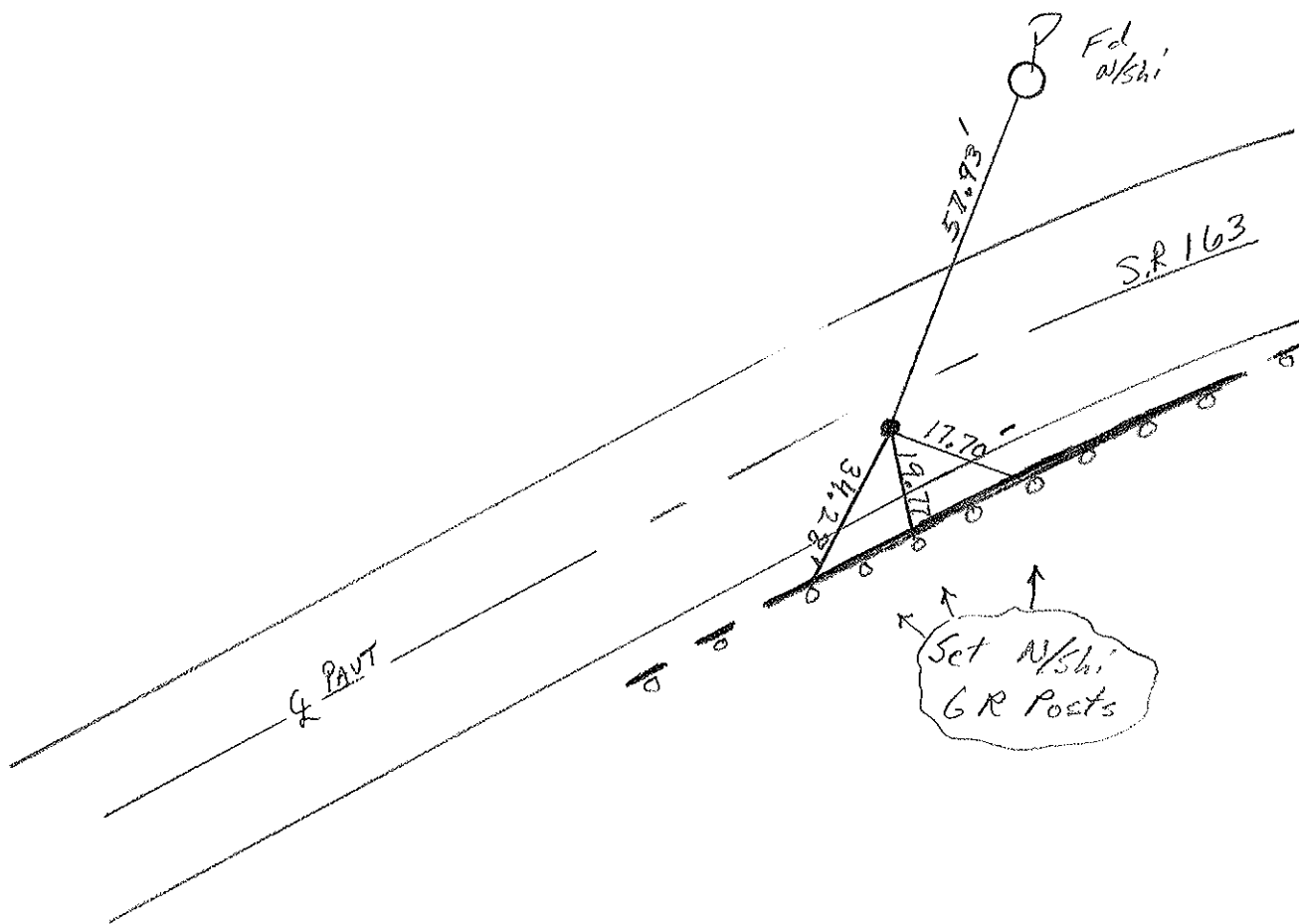

# O.D.O.T. DISTRICT 2 SURVEY OFFICE

PERSONNEL \_\_\_\_\_

REFERENCE NO. \_\_\_\_\_

SHEET 4 OF 5

NOTES CHEWY

H.C. RIPPLE

R.C. BARBOUR

GEYMAN

DATE 11-23-1992

WEATHER CLOUDY

TEMP. 40°

ROUTE 163

COUNTY OTAWA

TOWNSHIP SALEM

SECTION 4

T. & R. 15 E

TYPE MONUMENT PK/WASHER

ON SURFACE - ~~BELOW~~ \_\_\_\_\_

~~LEFT~~ & PAV'T. - RIGHT 3.5'

8.6' RT. TO RT. EDGE PAVEMENT

S.L.M. \_\_\_\_\_

62A

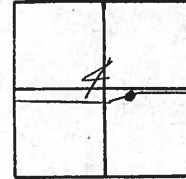

P.C. STA. 66+18.19 E. SURVEY (6-1-1947 R/W. PLAN)

