

O.D.O.T. DISTRICT 2 SURVEY OFFICE (USE ONLY)

PERSONNEL	REFERENCE NO. <u>64</u>	SHEET <u>33</u> OF <u>74</u>
NOTES <u>NUHFER</u>	DATE <u>7-11-17</u>	ROUTE <u>SR 163</u>
H.C. <u>LEU</u>	WEATHER <u>FAIR</u>	COUNTY <u>OTTAWA</u>
R.C. <u>CARSON</u>	TEMP. <u>80°</u>	TOWNSHIP <u>SALEM</u>
DWG BY <u>JAMES</u>	PID <u>95757</u>	SECTION <u>4</u>
		T <u>6</u> N R <u>15</u> E

TYPE MONUMENT P.K./WASHER  
 ON SURFACE - ~~BELOW~~ ON  
 OFFSET  $\text{C}$  PAVEMENT 0.5' LT : RT  
- TO - EDGE PAVEMENT  
 STATION: 794+46

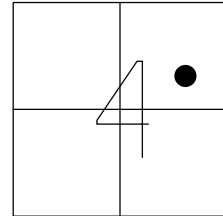

HORZ. DATUM: NAD83 2011 GEOID: NAVD88 2012A  
 GRID: NORTHING: 671730.582 EASTING: 1795923.760

RECORD: PCC  
 STA 68+73.60  
 FD P.K./WASHER  
 8-2-00, TMR  
 SET P.K./WASHER  
 12-5-00, SAH  
 FD P.K./WASHER  
 REF64  
 5-5-16, DCH  
 7-11-17, JLL  
 SET MAG/WASHER  
 1-4-19, JLL

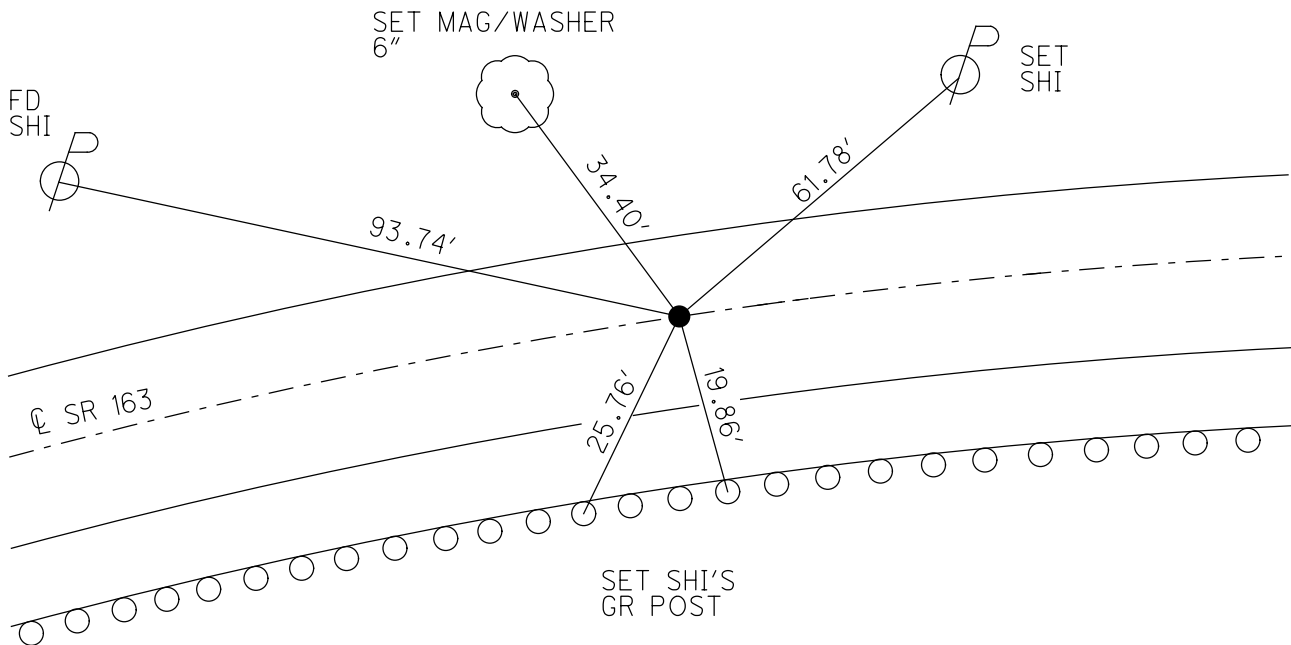

# O.D.O.T. DISTRICT 2 SURVEY OFFICE

PERSONNEL \_\_\_\_\_

REFERENCE NO. 64

SHEET 23 OF 63

NOTES Cordes

H.C. Rousos

R.C. Kanger

DATE 8-2-06

WEATHER Fair

TEMP. +85°F

ROUTE 163

COUNTY Ottawa

TOWNSHIP Salem

SECTION 4

T. 6 N. R. 15 E.

TYPE MONUMENT PK/W

~~ON SURFACE~~ - ~~BELOW~~ Surf.

~~LEFT - (C. PAV'T) - RIGHT~~

TO EDGE PAVEMENT

S.L.M. 794+46

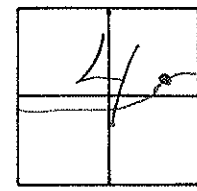

Record: PCC  
Rec. Sta. - 68+73.60  
Coast.

Set PK/W  
12-5-00  
SAH

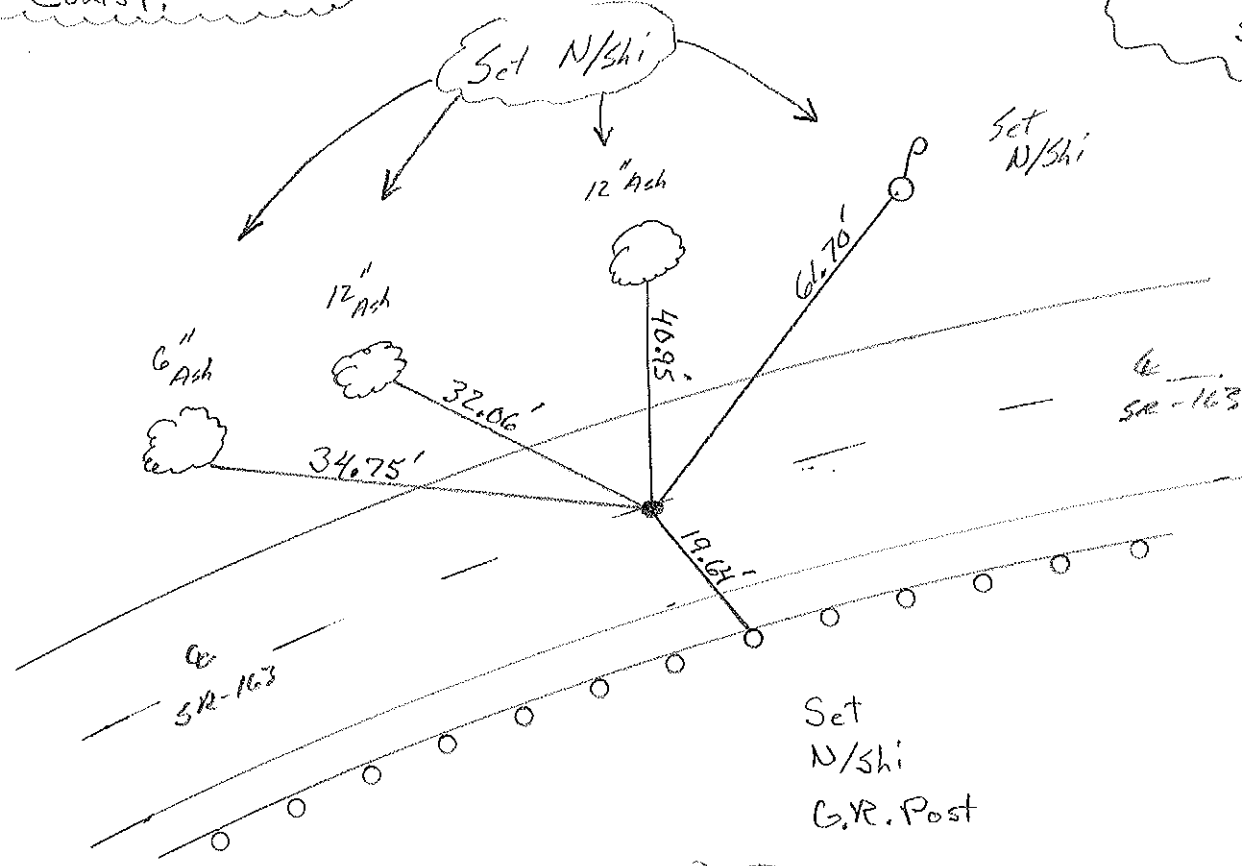

Just East of  
Easterly Prop Line  
Res. 520

# O.D.O.T. DISTRICT 2 SURVEY OFFICE

PERSONNEL \_\_\_\_\_

REFERENCE NO. 64

SHEET 15 OF \_\_\_\_\_

NOTES Ripple

H.C. BARBOUR

R.C. FEYMAN

DATE 5-24-90

WEATHER Cloudy

TEMP. 72°

ROUTE 163

COUNTY OTTAWA

TOWNSHIP Salem

SECTION 4

T 6 N R 15 E

TYPE MONUMENT set P.K. + Washer

ON SURFACE - BELOW \_\_\_\_\_

LEFT - ☉ PAV'T. - RIGHT ☉

TO \_\_\_\_\_ EDGE PAVEMENT

S.L.M. 68 + 73.60

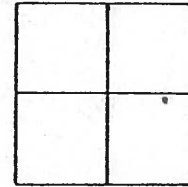

P.C.C. \_\_\_\_\_

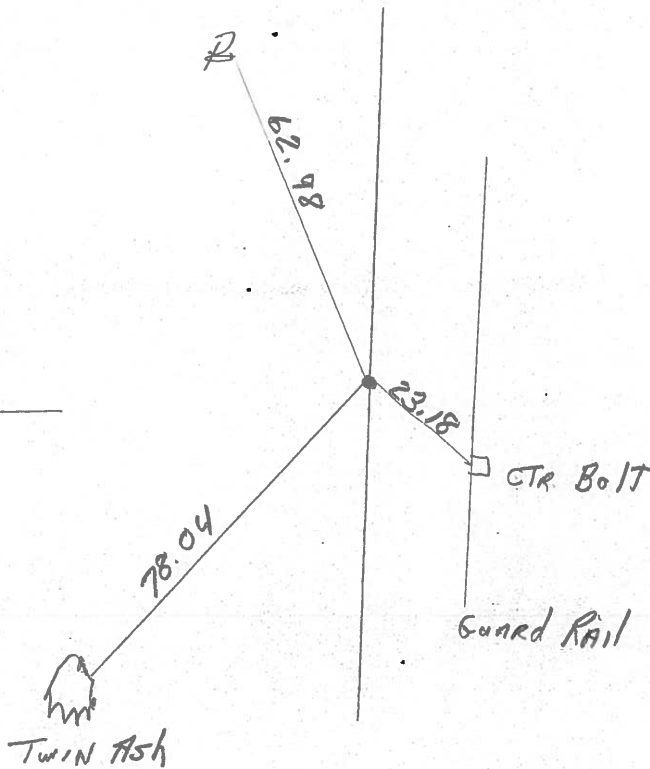

PERSONNEL	TITLE	PERSONNEL	TITLE
		COUNTY <u>Ottawa</u>	DATE <u>March 1970</u>
		S. R. <u>163</u>	WEATHER
		SEC. <u>Oak Harbor-East</u>	TEMP.
DESCRIPTION	<u>Sec-A Salem Twp.</u>		JOB NO.
	LEFT	CENTER LINE	RIGHT

P.C.C.  
68+73.60  
P.K. Nail

64

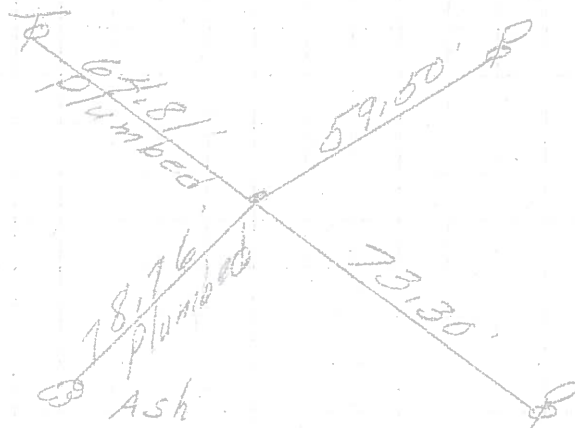

P.I.  
67+33.82  
 $\Delta = 22^\circ 40' \text{RT.}$   
Iron Pin

63

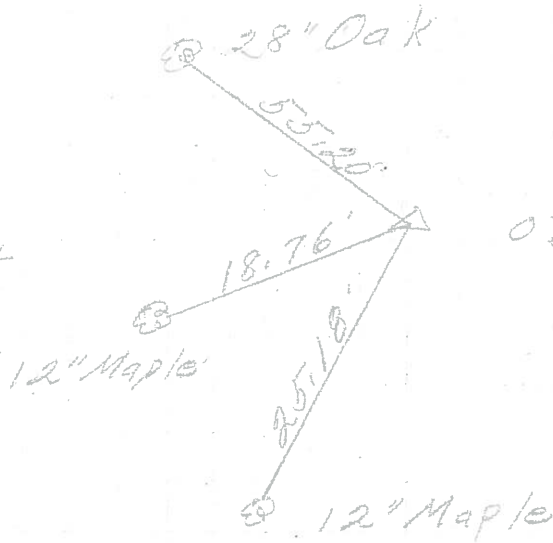

P.I.  
65+90.27  
P.K. Nail

62

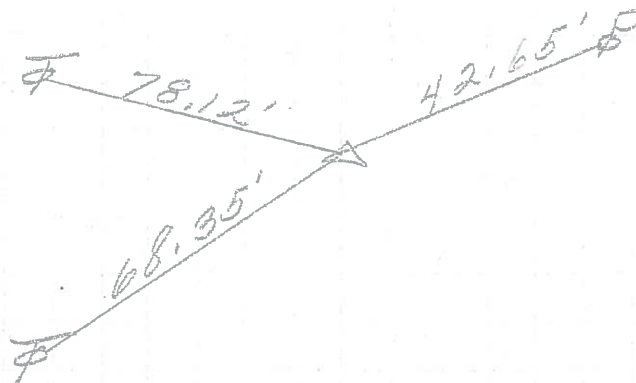

PERSONNEL	TITLE	PERSONNEL	TITLE	COUNTY	DATE
<u>Schneider</u>		<u>Potts</u>		<u>Ottawa</u>	<u>Aug, 1960</u>
<u>Messer</u>				S. R. <u>163</u>	WEATHER
<u>Barbour</u>				SEC. <u>Oak Harbor-East</u>	TEMP.
<u>Redding</u>				DESCRIPTION <u>Ties for Control Points</u>	JOB NO.

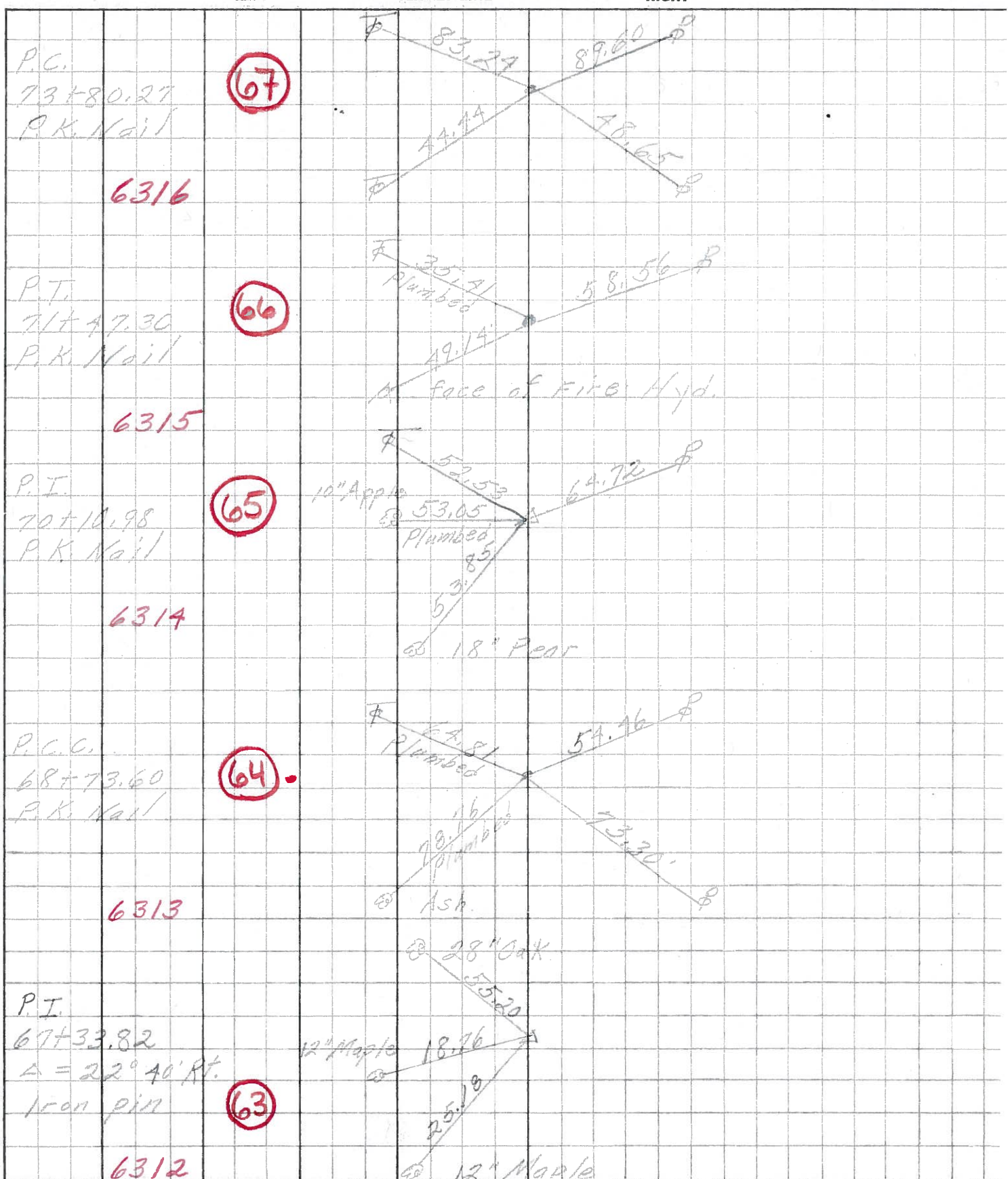

PERSONNEL	TITLE	PERSONNEL	TITLE	COUNTY	DATE	WEATHER	TEMP.
Krabill				Ottawa	Feb. 19, 1964		
Xowaleski				S. R. #163			
Geyman				SEC. E-2 (pt)			
Bruggeman							

DESCRIPTION Oak Harbor Man. Locations East JOB NO. \_\_\_\_\_

LEFT CENTER LINE RIGHT

63+90.85  
P.T.  
P.K. Nail

61A

#8

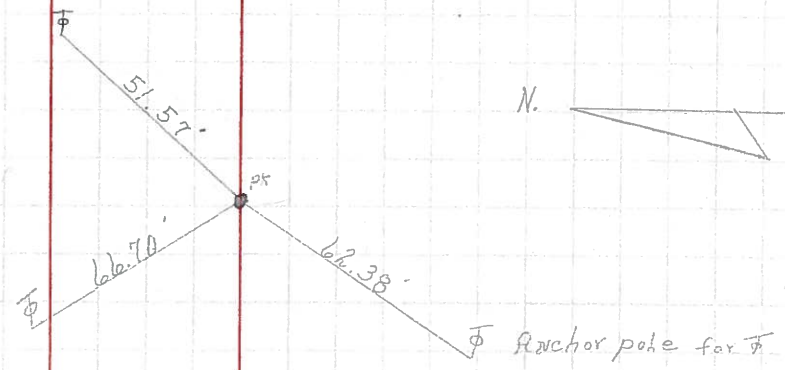

65+90.27  
P.C.  
P.K. Nail

62

#9

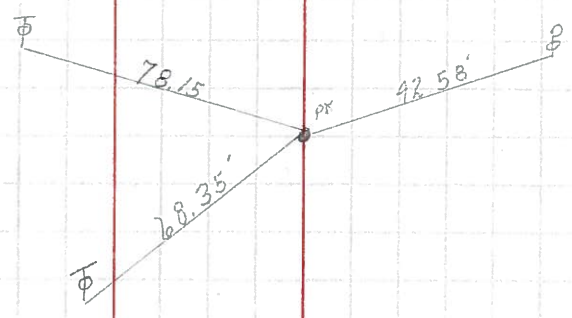

67+33.82  
P.I. Δ=22° 40' Rt.  
P.K. Nail OVER I.P.M.

63

#10

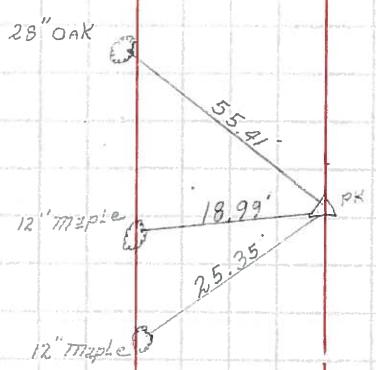

68+73.20  
P.C.C  
P.K. Nail

64

#11

