

O.D.O.T. DISTRICT 2 SURVEY OFFICE (USE ONLY)

PERSONNEL _____ REFERENCE NO. 114 SHEET 7 OF 14
 NOTES CANTERBURY DATE 6/16/09 ROUTE SR 163
 H.C. HUSS WEATHER FAIR COUNTY OTTAWA
 R.C. CANTERBURY TEMP. 78° TOWNSHIP ERIE
 _____ SECTION 34
 _____ T 7 N R 16 E

TYPE MONUMENT MON BOX
 ON SURFACE - ~~BELOW~~ ON
 LEFT - ☉ PAV'T - ~~RIGHT~~ 3.2'
7.7' TO LT EDGE PAVEMENT
 S.L.M. 1161+56

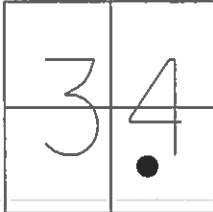

GRID: NORTHING: 675132.821 EASTING: 1831939.541

RECORD:
 STA. 170+59 PLAN
 MON.BOX RAISED
 7/8/96

FD MON.BOX
 GPS, SV124
 6/16/09, SAH

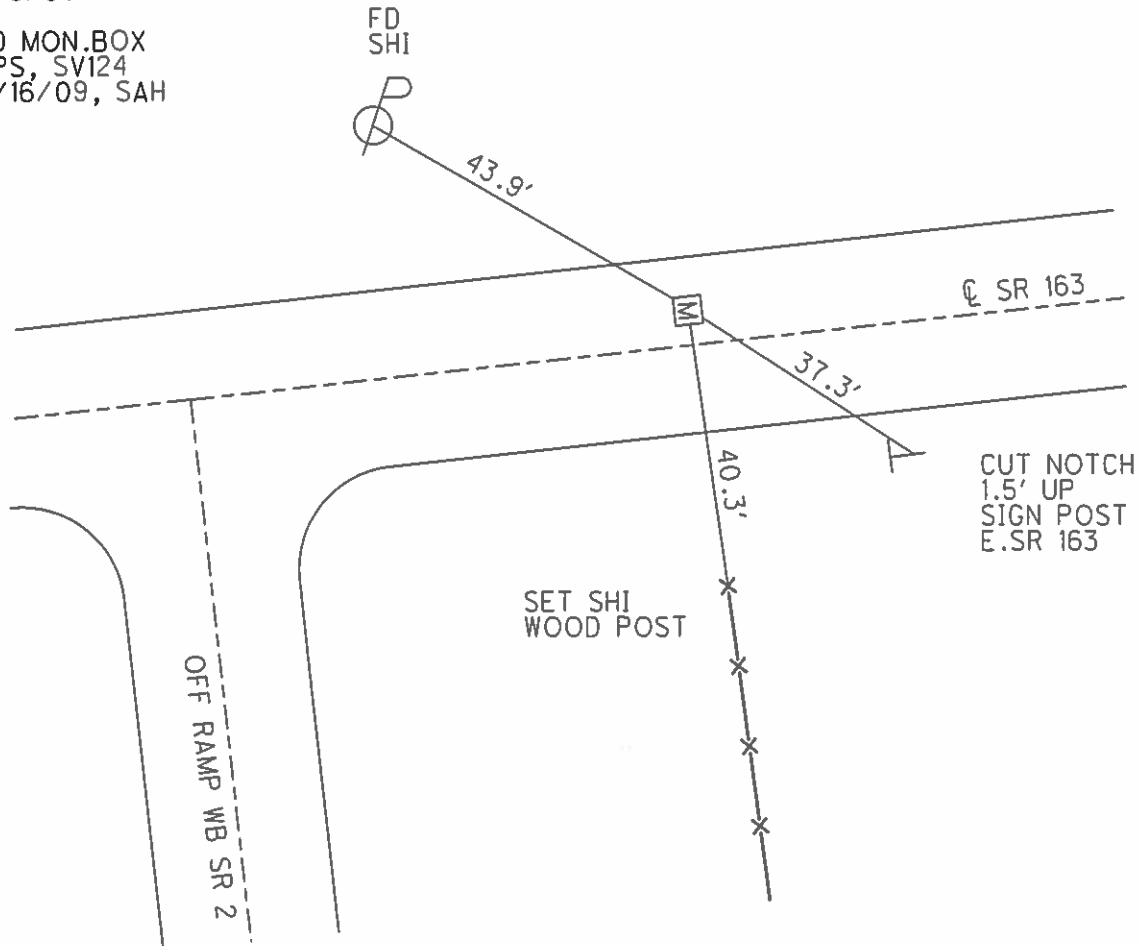

O.D.O.T. DISTRICT 2 SURVEY OFFICE (USE ONLY)

PERSONNEL _____ REFERENCE NO. 114 SHEET 7 OF 14
 NOTES CANTERBURY DATE 6/16/09 ROUTE SR 163
 H.C. HUSS WEATHER FAIR COUNTY OTTAWA
 R.C. CANTERBURY TEMP. 78° TOWNSHIP ERIE
 _____ SECTION 34
 _____ T 7 N R 16 E

TYPE MONUMENT MON.BOX
 ON SURFACE - ~~BELOW~~ ON _____
 LEFT - ☉ PAV'T - ~~RIGHT~~ 3.2'
7.7' TO LT EDGE PAVEMENT
 S.L.M. 1161+56, (170+59 PLAN)

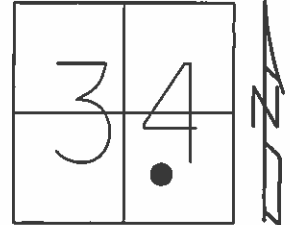

Grid: Northing: 675132.821 Easting: 1831939.541

RECORD:
 MON.BOX RAISED
 7/8/96

FD MON.BOX
 GPS, SV124
 6/16/09, SAH

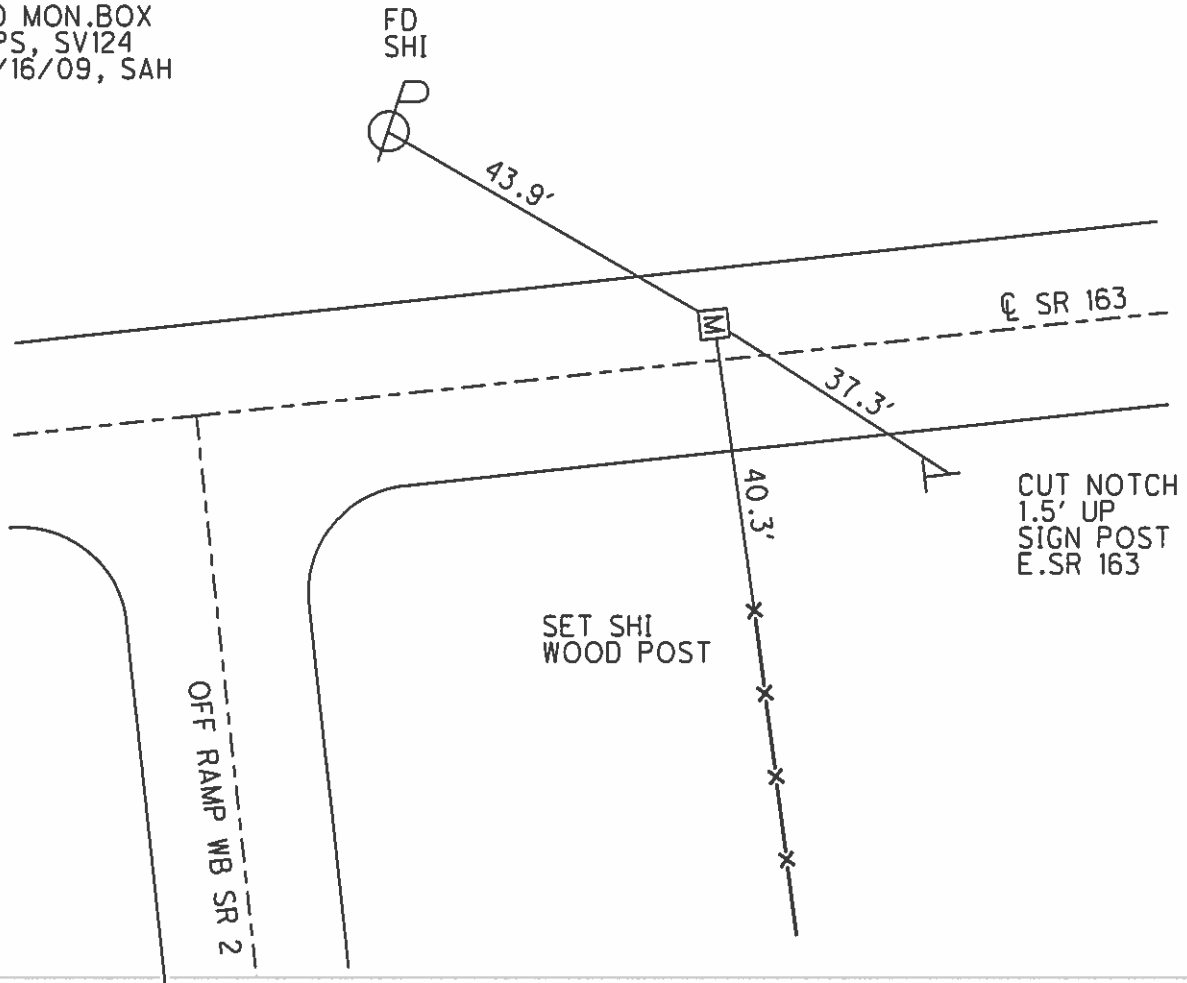

O.D.O.T. DISTRICT 2 SURVEY OFFICE

PERSONNEL

REFERENCE NO. 114

SHEET 6 OF 16

NOTES LOEHRKE

H.C. ROUSOS

R.C. CANTERBURY

DATE 9-2-95

WEATHER FAIR

TEMP. +86

ROUTE S.R. 163

COUNTY OTTAWA

TOWNSHIP ERIE

SECTION 34

T 7 N R 16 E

RAISED 7-8-96

TYPE MONUMENT Mon Box

ON SURFACE - BELOW 3"

LEFT - CL PAV'T. - RIGHT 2.7 Lt

7.6 TO Lt EDGE PAVEMENT

S.L.M. 1161 + 56

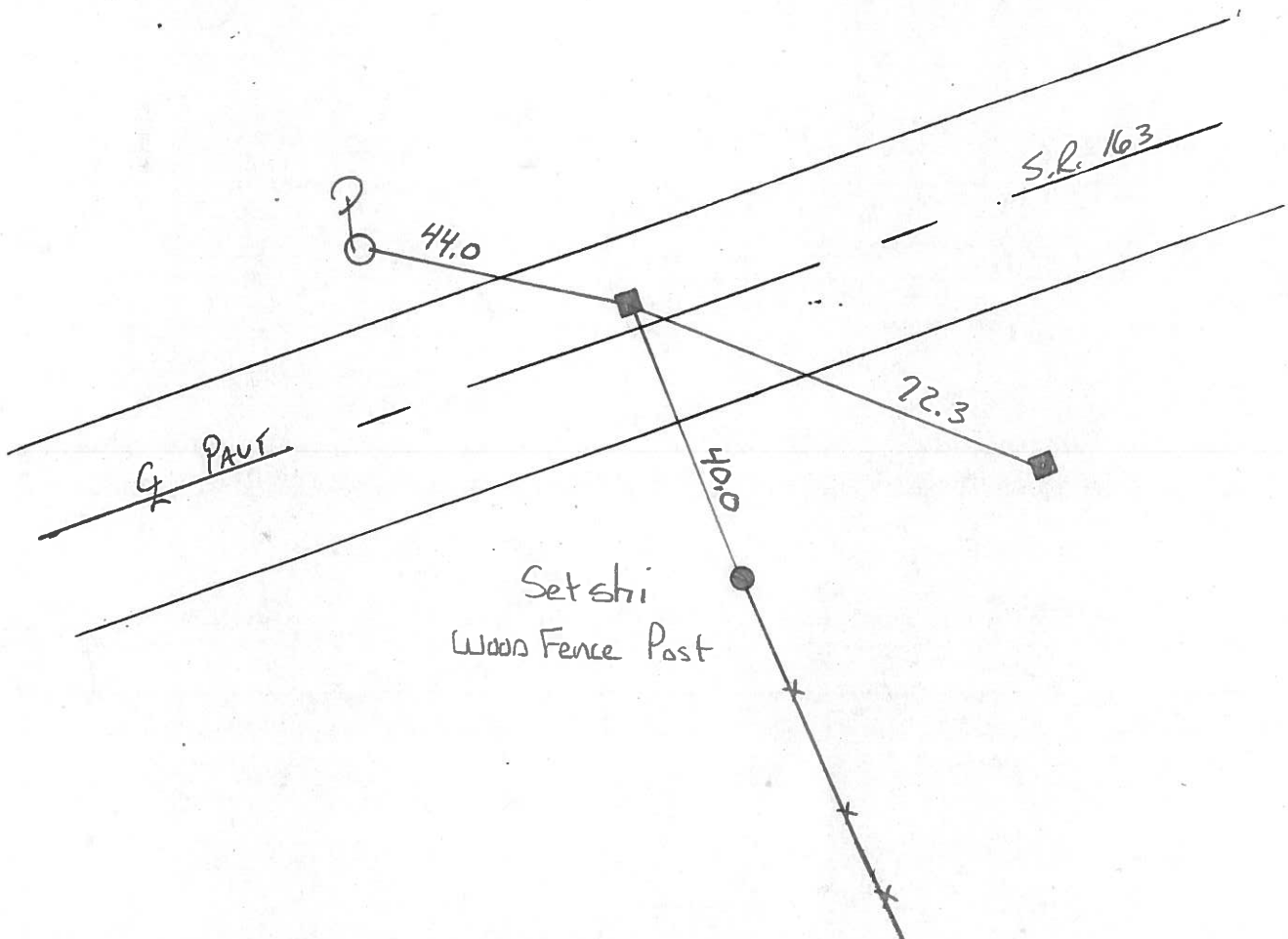
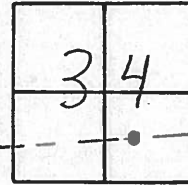

O.D.O.T. DISTRICT 2 SURVEY OFFICE

10

PERSONNEL

REFERENCE NO. 114

SHEET _____ OF _____

NOTES CRONIN

H.C. RIPPLE

R.C. BARBOUR

GEYMAN

DATE 9/11/85

WEATHER SUNNY-WINDY

TEMP. 63°

ROUTE #163

COUNTY OTTAWA

TOWNSHIP ERIE

SECTION 34

T 7 N R 16 E

TYPE MONUMENT Mon. Box

ON SURFACE - BELOW BELOW SURFACE

LEFT - & PAV'T. - RIGHT 3'lt. of R.V.T.

TO _____ EDGE PAVEMENT

S.L.M. _____

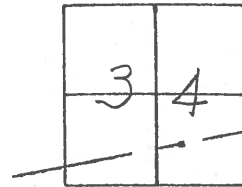

1161+77?
ctr. of Mon. Box

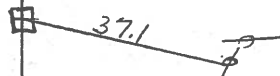

PERSONNEL	TITLE	PERSONNEL	TITLE	COUNTY	DATE	WEATHER	TEMP.
				<u>Ottawa</u>	<u>5-8-69</u>	<u>Cloudy-Wind</u>	<u>60°</u>
				<u>S. R. 163</u>			
				<u>SEC. 34</u>			

DESCRIPTION Erie Twp. JOB NO. _____

