

O.D.O.T. DISTRICT 2 SURVEY OFFICE (USE ONLY)

PERSONNEL

REFERENCE NO. 176

SHEET 25 OF 25

NOTES RHOADES

DATE 9/20/18

ROUTE SR 163

H.C. MILLER

WEATHER CLOUDY

COUNTY OTTAWA

R.C. O'DONNELL

TEMP. 70°

TOWNSHIP DANBURY

SECTION 10

DWG BY NIESE PID PVTRAIN

T 6 N R 18 E

TYPE MONUMENT R.R./SPIKE

~~ON SURFACE~~ - BELOW 4"

OFFSET Q PAVEMENT ON LT : RT

- TO - EDGE PAVEMENT

STATION: 2188+70

HORIZ.DATUM: NAD83 2011

GEOID: NAVD88 2012A

GRID: NORTHING: 673696.091

EASTING: 1896799.540

NOTE:  
THIS MAP IS FOR CDDT PURPOSES ONLY  
TO INDICATE REFERENCE TIES, AND DOES NOT  
REPRESENT TRUE LAND SUBDIVISION.

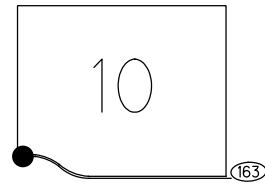

RECORD:  
FD 1" IPIN  
3" DOWN  
8/14/00  
4/3/01, BVD  
FD R.R.SPIKE  
4" DOWN  
REF176  
9/20/18, JFO  
2/8/19, JFO  
2/7/22, JFO

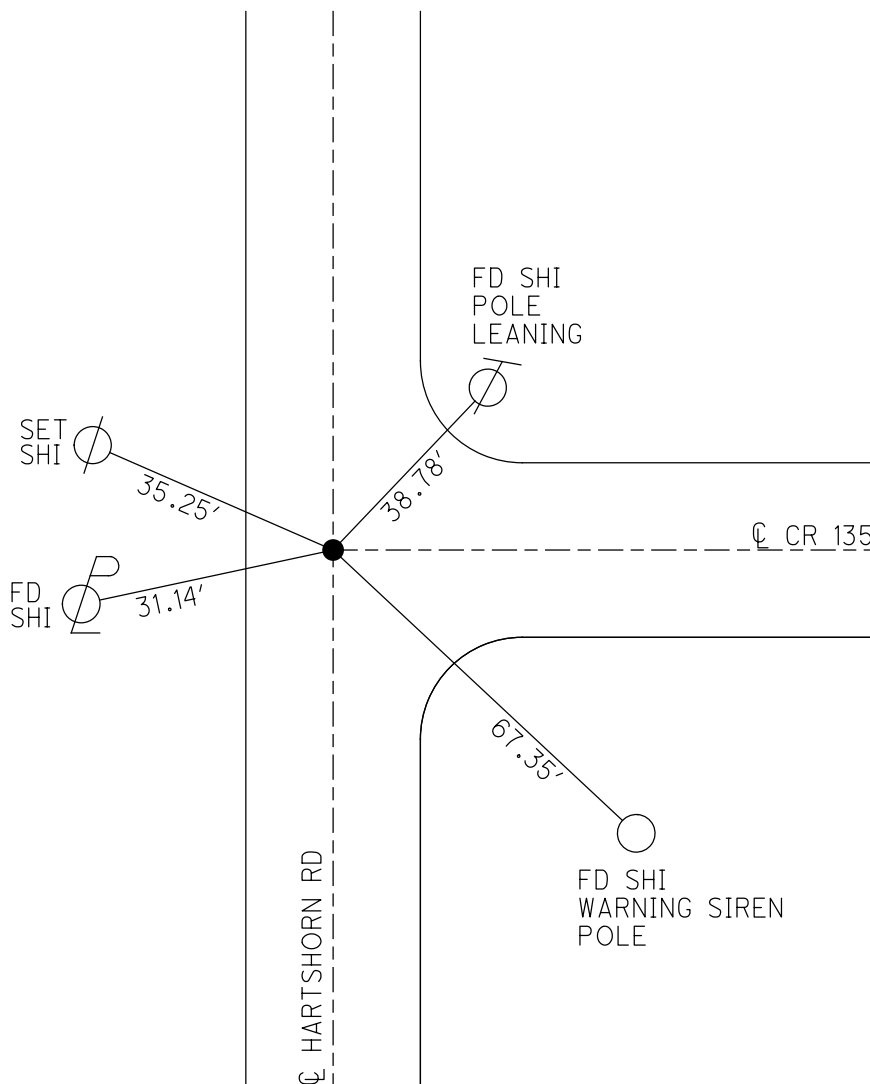

O.D.O.T. DISTRICT 2 SURVEY OFFICE (USE ONLY)

PERSONNEL \_\_\_\_\_ REFERENCE NO. 176 SHEET 25 OF 25  
 NOTES RHOADES DATE 9/20/18 ROUTE SR 163  
 H.C. MILLER WEATHER CLOUDY COUNTY OTTAWA  
 R.C. O'DONNELL TEMP. 70° TOWNSHIP DANBURY  
 DWG BY MILLER PID NO PID SECTION 10  
 T 6 N R 18 E

TYPE MONUMENT R.R./SPIKE  
~~ON SURFACE~~ - BELOW 4"  
 OFFSET  $\odot$  PAVEMENT ON LT : RT  
- TO - EDGE PAVEMENT  
 STATION: 2188+70

NOTE:  
THIS MAP IS FOR ODOT PURPOSES ONLY  
TO INDEX REFERENCE TIES, AND DOES NOT  
REPRESENT TRUE LAND SUBDIVISION.

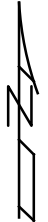
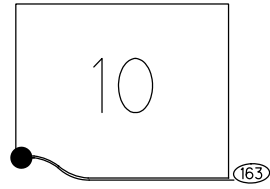

HORIZ.DATUM: NAD83 2011 GEOID: NAVD88 2012A  
 GRID: NORTHING: 673696.091 EASTING: 1896799.540

RECORD:  
 FD 1" IPIN  
 3" DOWN  
 8/14/00  
 4/3/01, BVD  
 FD R.R./SPIKE  
 4" DOWN  
 REF 176  
 9/20/18  
 2/8/19, JFO

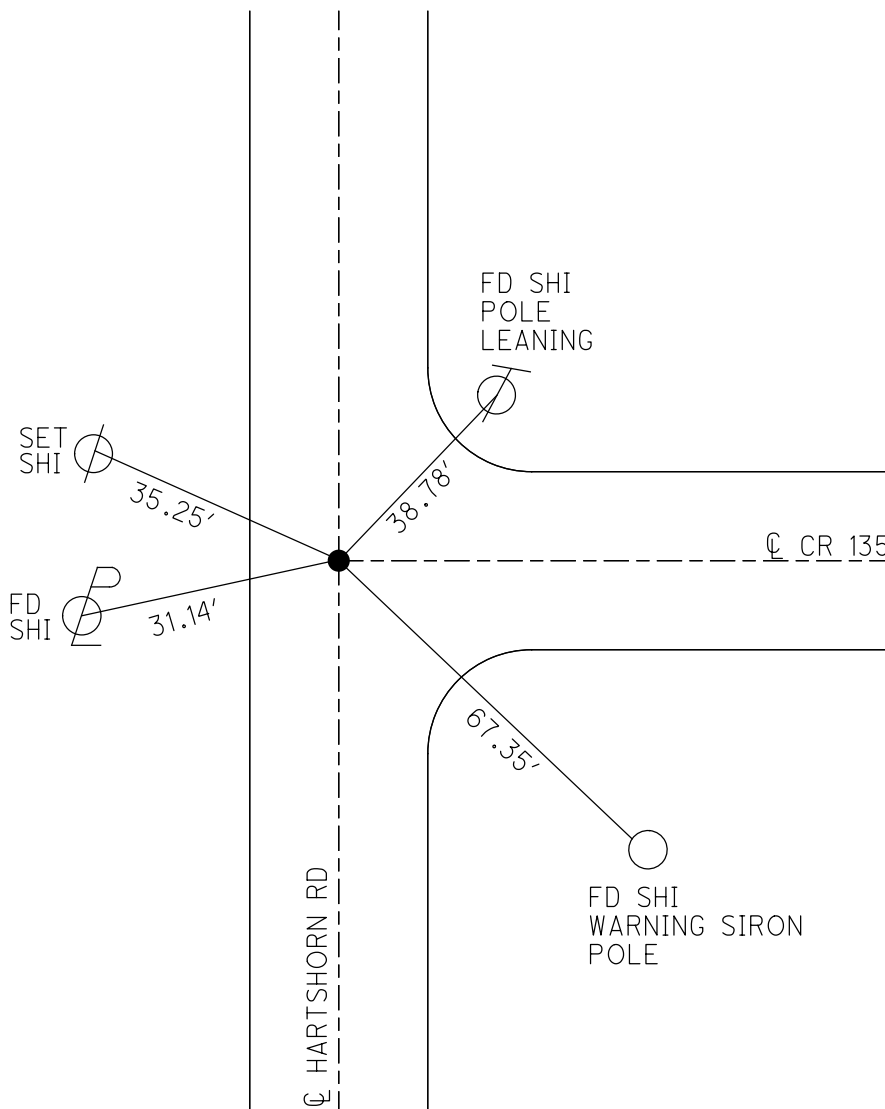

O.D.O.T. DISTRICT 2 SURVEY OFFICE

PERSONNEL

REFERENCE NO. 176

SHEET 22 OF 22

NOTES VAN DUSEN

H.C. Rousos

R.C. ADAM B.

DATE 8-14-00

WEATHER CLOUDY

TEMP. + 75°F

S.R. 163

ROUTE PROJECT

COUNTY OTTAWA

TOWNSHIP DANBURY

SECTION 1

T6 N R 18 E

TYPE MONUMENT 1" IRON PIN

ON SURFACE - BELOW 3"

LEFT- & PAV'T. - RIGHT YES

TO EDGE PAVEMENT ON & BOTH ROADS

S.L.M. 2188+70

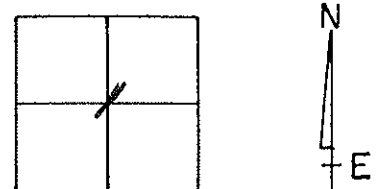

POINT NOT COVERED  
4-3-01  
BVD

