

O.D.O.T. DISTRICT 2 SURVEY OFFICE (USE ONLY)

PERSONNEL \_\_\_\_\_ REFERENCE NO. 12 SHEET 20 OF 27  
 NOTES HOMAN DATE 11/25/12 ROUTE SR 357  
 H.C. HOMAN WEATHER PTLY CLOUDY COUNTY OTTAWA  
 R.C. ROUSOS TEMP. 53° SOUTH BASS ISLAND  
 DWG BY RHOADES PID 25525

TYPE MONUMENT R.R.SPIKE  
~~ON SURFACE~~ - BELOW 0.1'  
 OFFSET  $\text{C}$  PAVEMENT 0.6'  $\text{RT}$  :  $\text{RT}$   
6.9' TO  $\text{RT}$  EDGE PAVEMENT  
 STATION: 116+13.53

HORZ.DATUM: NAD 1983 GEOID: 2003  
 GRID: NORTHING: 727747.939 EASTING: 1886983.134



RECORD:  
 FD R.R.SPIKE  
 0.1' DOWN  
 RSV108  
 9/21/07, RGN  
 POINT RECOVERED  
 RSV108  
 9/25/12  
 SET MAG/WASHER  
 11/25/12, DCH

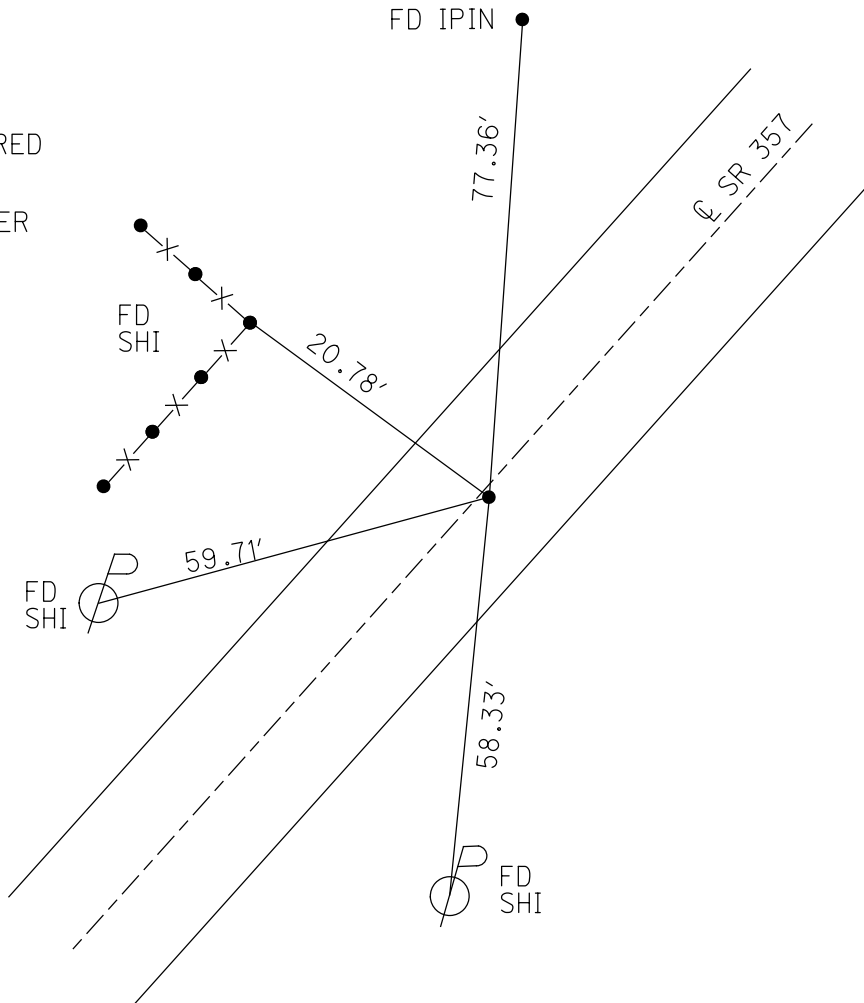

# O.D.O.T. DISTRICT 2 SURVEY OFFICE

PERSONNEL \_\_\_\_\_

REFERENCE NO. \_\_\_\_\_

SHEET \_\_\_\_\_ OF \_\_\_\_\_

NOTES Huss

H.C. Ryan

R.C. Huss

DATE 9-21-07

WEATHER Clear-Fair

TEMP. +80°F

ROUTE 357

COUNTY OH

TOWNSHIP \_\_\_\_\_

SECTION \_\_\_\_\_

T. \_\_\_\_\_ R. \_\_\_\_\_

TYPE MONUMENT RRSPK  
 ON SURFACE - BELOW 0.1' below  
 LEFT - PAV'T. - RIGHT 0.6'  
6.9' TO RT EDGE PAVEMENT  
 S.L.M. \_\_\_\_\_

