

STATE HIGHWAY DEPARTMENT OF OHIO

BUREAU OF CONSTRUCTION

SEC. D-1, FREMONT - BOWLING GREEN ROAD

I.C.H. No. 278. P.E.T. No. 4199.

SANDUSKY COUNTY

WASHINGTON & JACKSON TWP. JANUARY 1921.

CONVENTIONAL SIGNS

Township line	-----
Section line	-----
Property line not fenced	-----
Center line	-----
City or village line	-----
Wire fence	-x-x-x-
Rail fence	~~~~~
Telephone or telegraph	TTTTTT
Steam railroad	=====

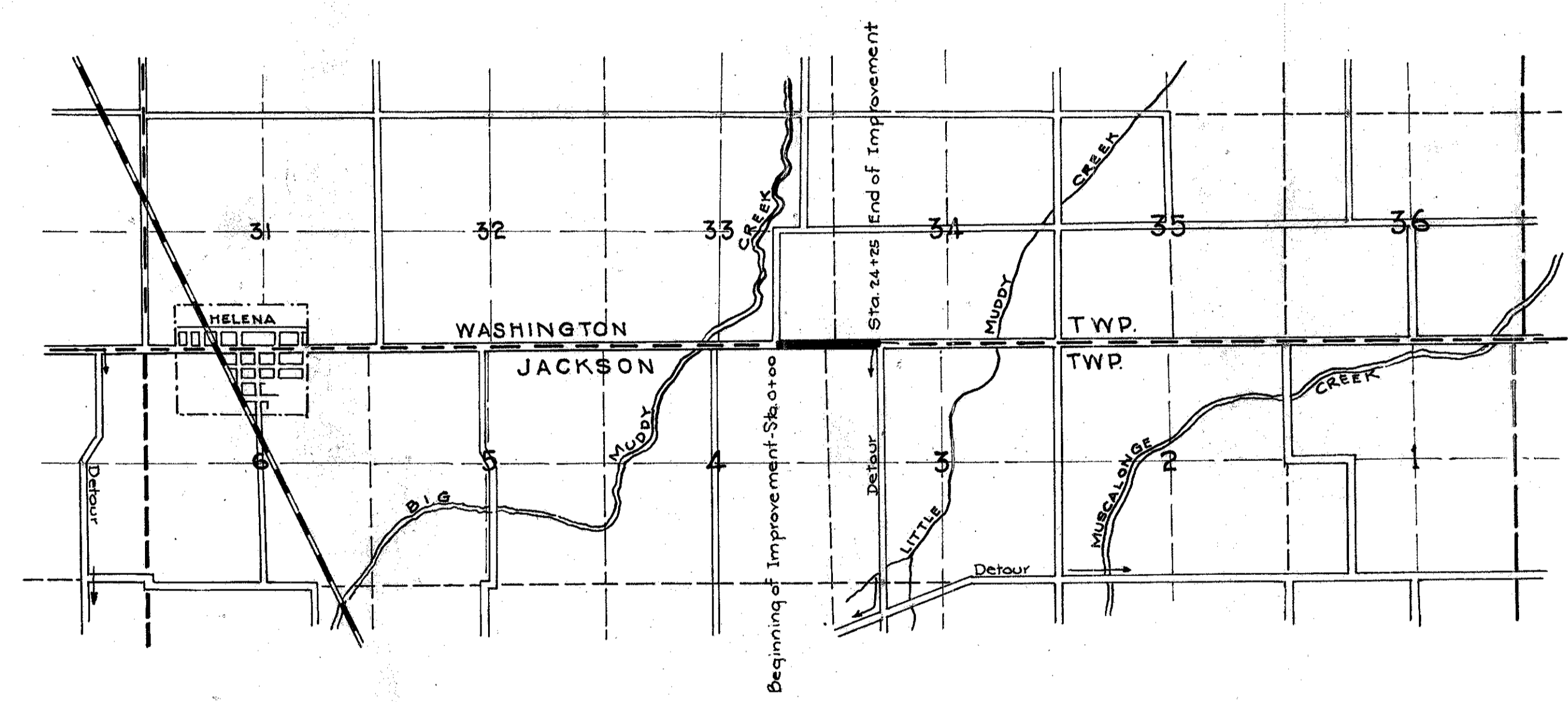

LOCATION PLAN
SCALE - 2" = 1 mile.

Portion to be improved
Detours

SCALES

Plan	1" = 100'
Profile (Vertical)	1" = 10'
Profile (Horizontal)	1" = 100'
Cross Sections	1" = 5'

The Standard Specifications of the State Highway Department of Ohio in force on date of contract will govern this improvement.

I hereby approve these plans and declare that the making of this improvement will require the closing of the highway to traffic and that detour will be indicated as shown on plan.

We, the Commissioners of Sandusky County, hereby approve these plans and certify that the right-of-way is available for the construction of the above highway.

L. J. Robinson
B. S. Rogers
J. S. Blake
County Commissioners.

Date, 5-21, 1921.

Approved: L. H. Wisman
Date, 5-21, 1921. Resident Engineer.

Approved: Edmer Hilty
Date, 7-23, 1921. Division Engineer.

Approved: _____
Date, 6-20, 1921. Chief Highway Engineer.

Approved: Levin C. Henrich
Date, 6-10, 1921. State Highway Commissioner.



TYPICAL SECTIONS

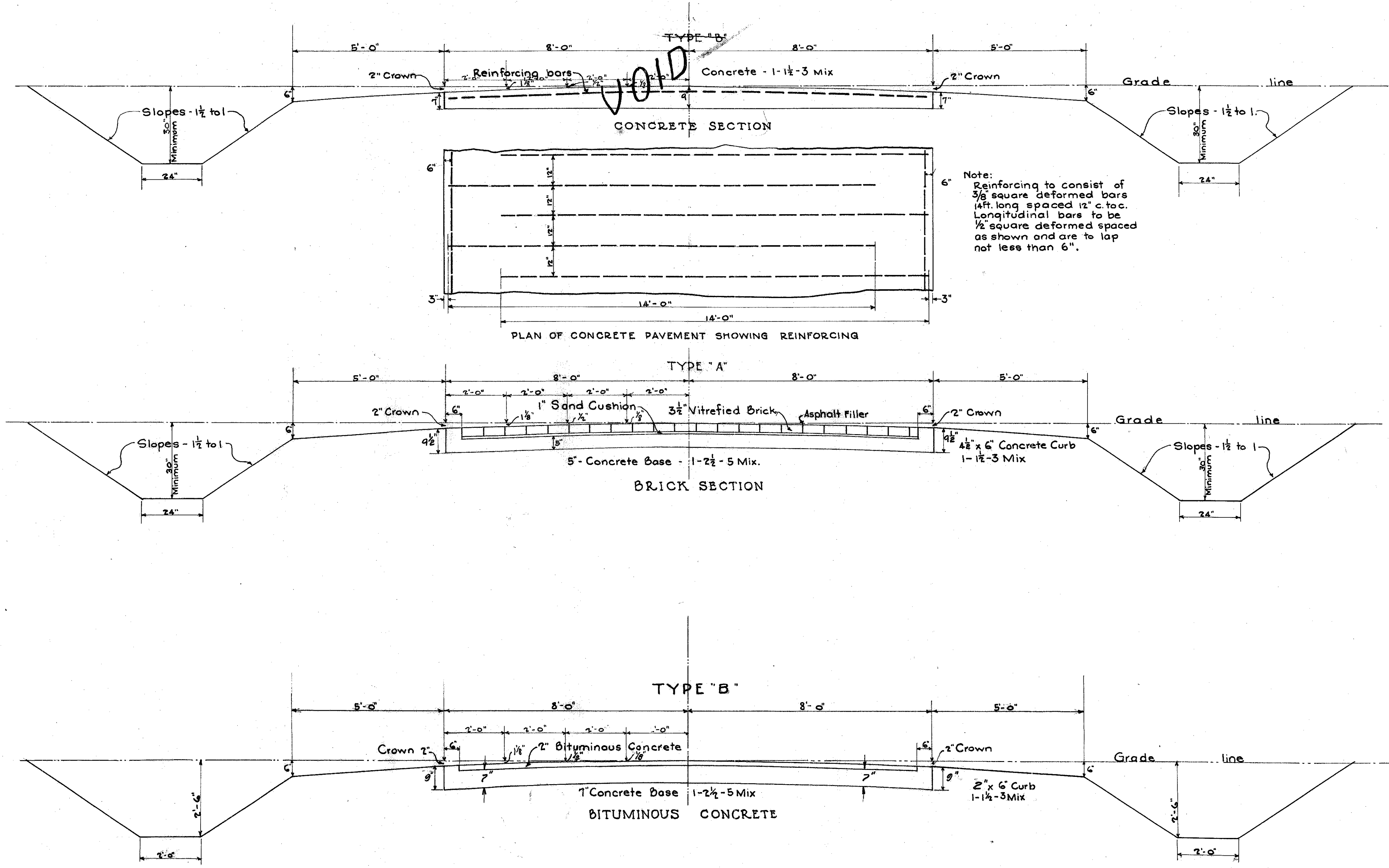

I.C.H. No. 278, Sec. D-1
Sandusky County

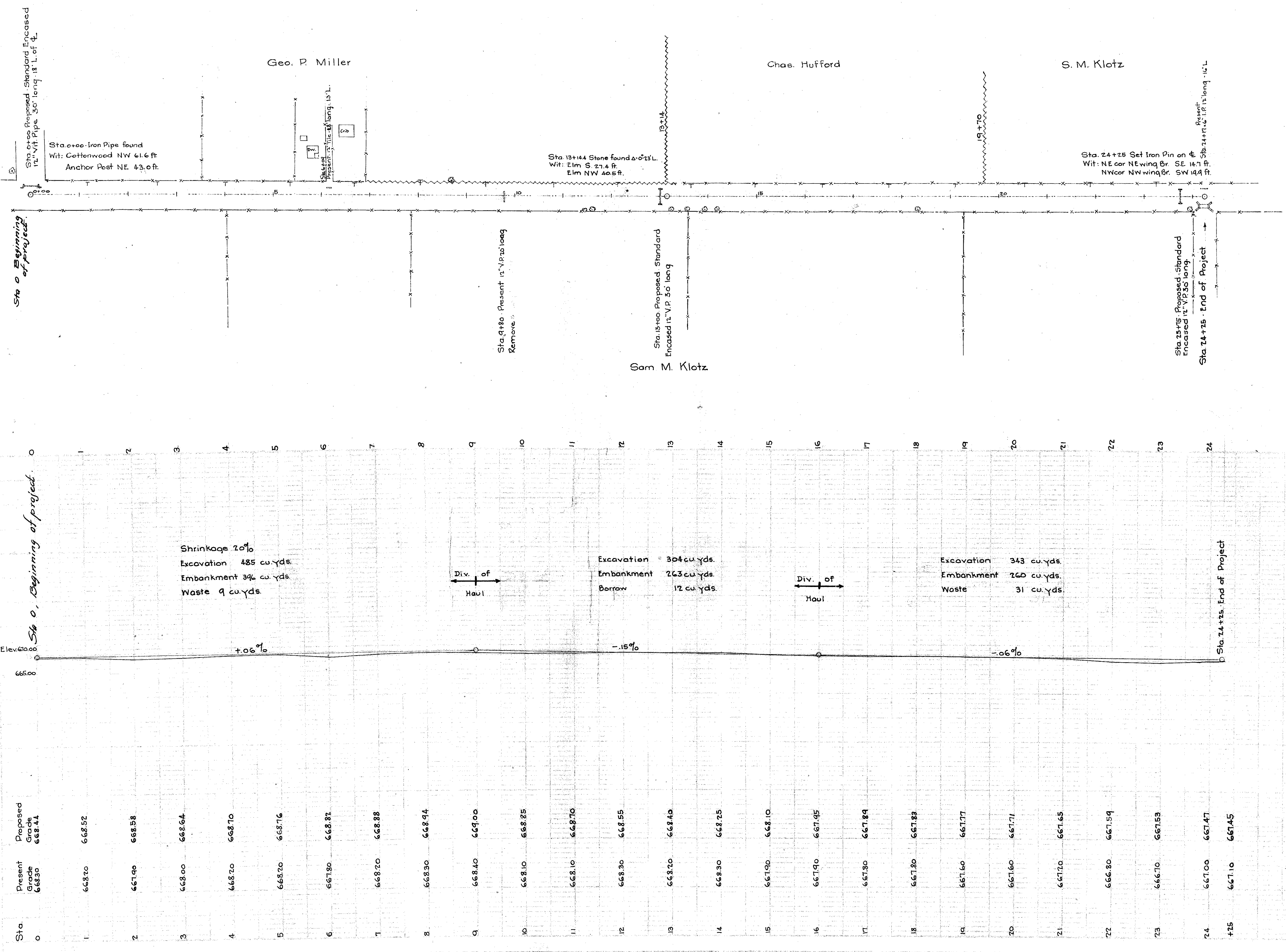

Sta 0 Beginning of project

Sta 24+25 End of Project

Shrinkage 20%
Excavation 485 cu yds.
Embankment 346 cu yds.
Waste 9 cu yds.

Div. of
Haul

Excavation 304 cu yds.
Embankment 263 cu yds.
Borrow 12 cu yds.

Div. of
Haul

Excavation 343 cu yds.
Embankment 260 cu yds.
Waste 31 cu yds.

Sta	Present Grade	Proposed Grade
0	668.30	668.41
1	668.20	668.52
2	667.90	668.58
3	668.00	668.64
4	668.20	668.70
5	668.20	668.76
6	667.80	668.82
7	668.20	668.88
8	668.30	668.94
9	668.40	669.00
10	668.10	668.85
11	668.10	668.70
12	668.30	668.55
13	668.20	668.40
14	668.30	668.25
15	667.90	668.10
16	667.90	667.95
17	667.80	667.84
18	667.80	667.83
19	667.60	667.77
20	667.60	667.71
21	667.20	667.65
22	666.80	667.59
23	666.70	667.53
24	667.00	667.47
25	667.10	667.45

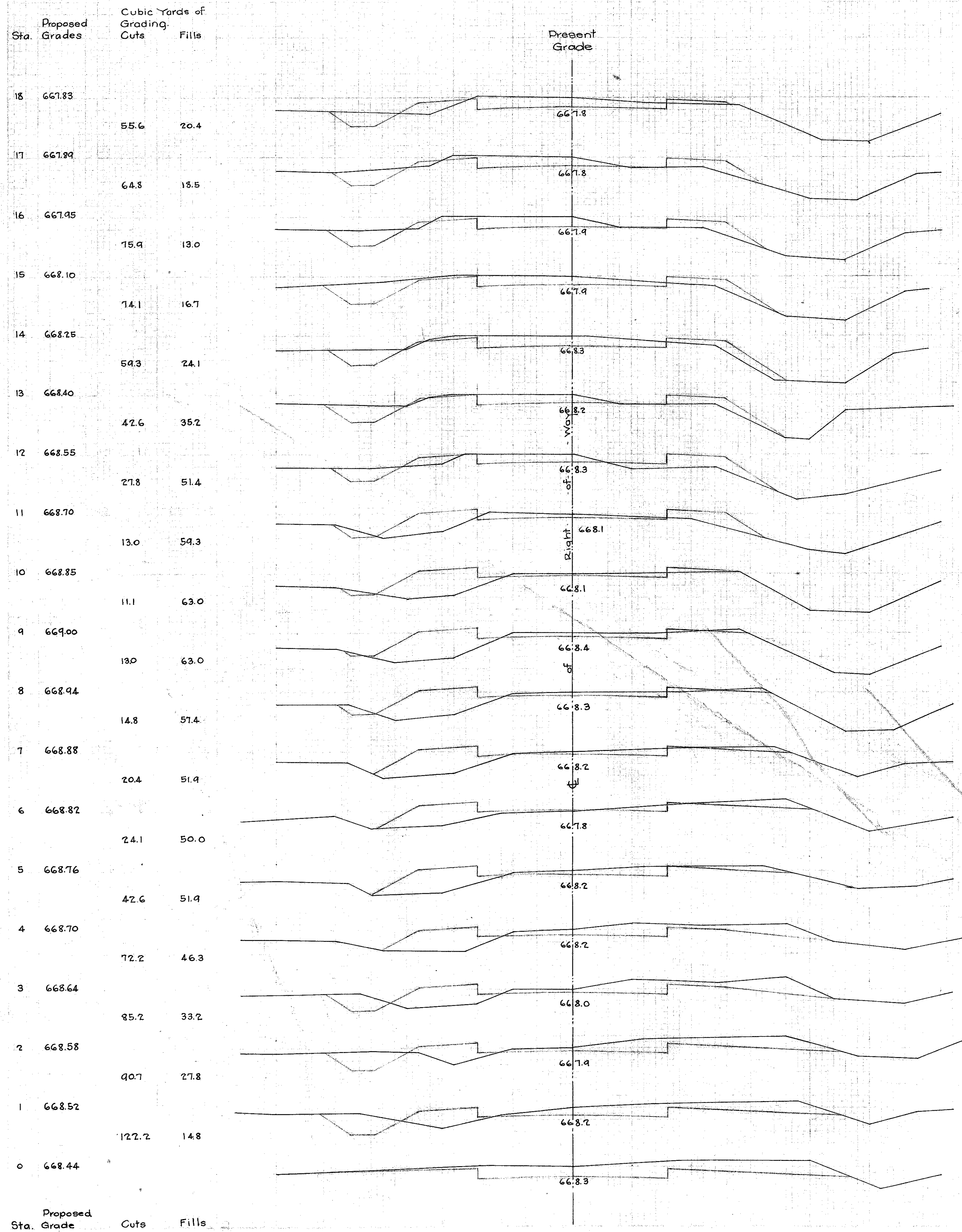

SUMMARY OF QUANTITIES.
STRUCTURES UNDER 20 FT. SPAN.

STA.	TYPE	SIZE	LENGTH	EXCAVATION CU. YDS.	CONCRETE		REINF. STEEL LBS.	VIT. S. PIPE LIN. FT.
					1-2-4	1-3-6		
0+00	V.P. Encased	12"	30 FT.	9.0	2.6	3.1	45	12" 30
13+00	V.P. Encased	12"	30 FT.	9.0	2.0	3.1	45	30
23+75	V.P. Encased	12"	30 FT.	9.0	2.0	3.1	45	30
TOTALS.				27.0	6.6	9.3	135	90

