

O.D.O.T. DISTRICT 2 SURVEY OFFICE (USE ONLY)

PERSONNEL \_\_\_\_\_ REFERENCE NO. 18 AA SHEET 4 OF 25  
 NOTES \_\_\_\_\_ DATE 07/06/04 ROUTE SR 6  
 H.C. HOMAN WEATHER CLOUDY COUNTY SANDUSKY  
 R.C. NUHFER TEMP. +70° TOWNSHIP WASHINGTON  
CANTERBURY SECTION 33  
ADKINS T 5 N R 14 E

TYPE MONUMENT MON BOX W/ IRON PIN  
 ON SURFACE - ~~BELOW~~ ON  
~~LEFT~~ - CL PAV'T - ~~RIGHT~~ ON  
11.6' TO RT EDGE PAVEMENT  
 S.L.M. 425+28

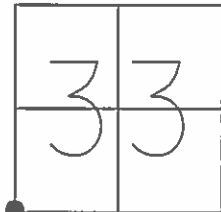

GRID: NORTHING: 611030.776 EASTING: 1759136.346

RECORD: 425+28.06

REFA18  
 FD MON BOX  
 W/ 1" IPIN  
 06-22-16  
 DCH, JLL

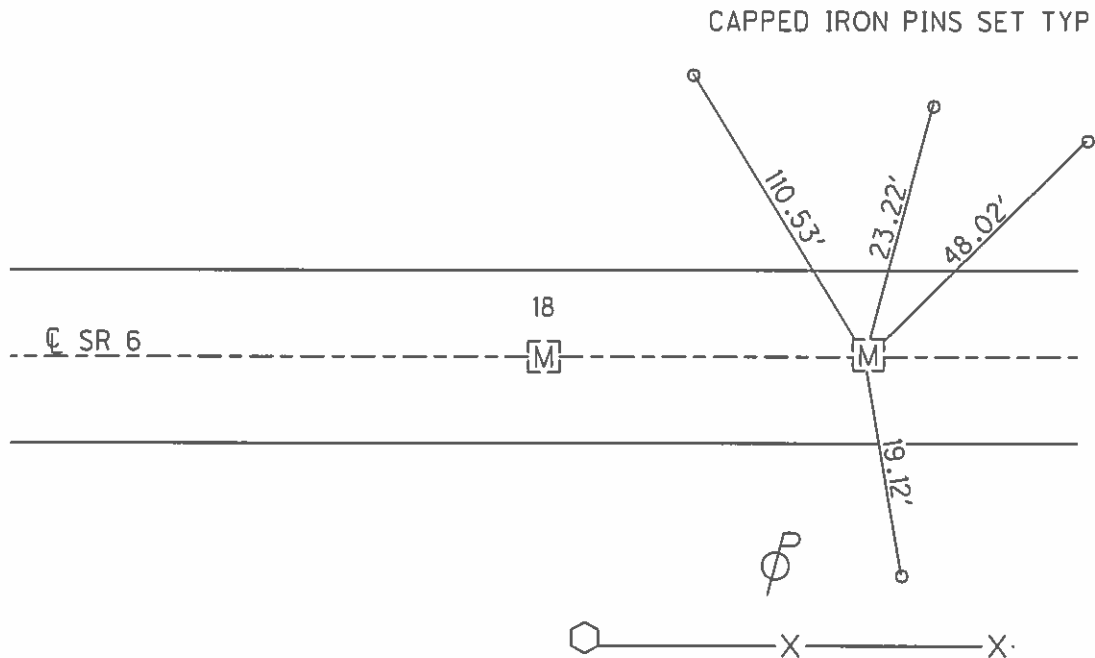

O.D.O.T. DISTRICT 2 SURVEY OFFICE (USE ONLY)

PERSONNEL \_\_\_\_\_ REFERENCE NO. 18 AA SHEET 4 OF 25

NOTES HOMAN DATE 7-6-04 ROUTE SR 6

H.C. NUHFER WEATHER CLOUDY COUNTY SANDUSKY

R.C. CANTERBURY TEMP. +70° TOWNSHIP WASHINGTON

ADKINS SECTION 33

T 5 N R 14 E

TYPE MONUMENT MON BOX W/ IRON PIN

ON SURFACE - ~~BELOW~~ ON \_\_\_\_\_

LEFT - ☉ PAV'T - RIGHT ON \_\_\_\_\_

11.6' TO RT EDGE PAVEMENT

S.L.M. 425+28

GRID: NORTHING: \_\_\_\_\_ EASTING: \_\_\_\_\_

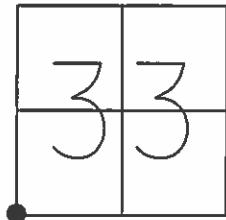

RECORD: 425+28.06

CAPPED IRON PINS SET TYP

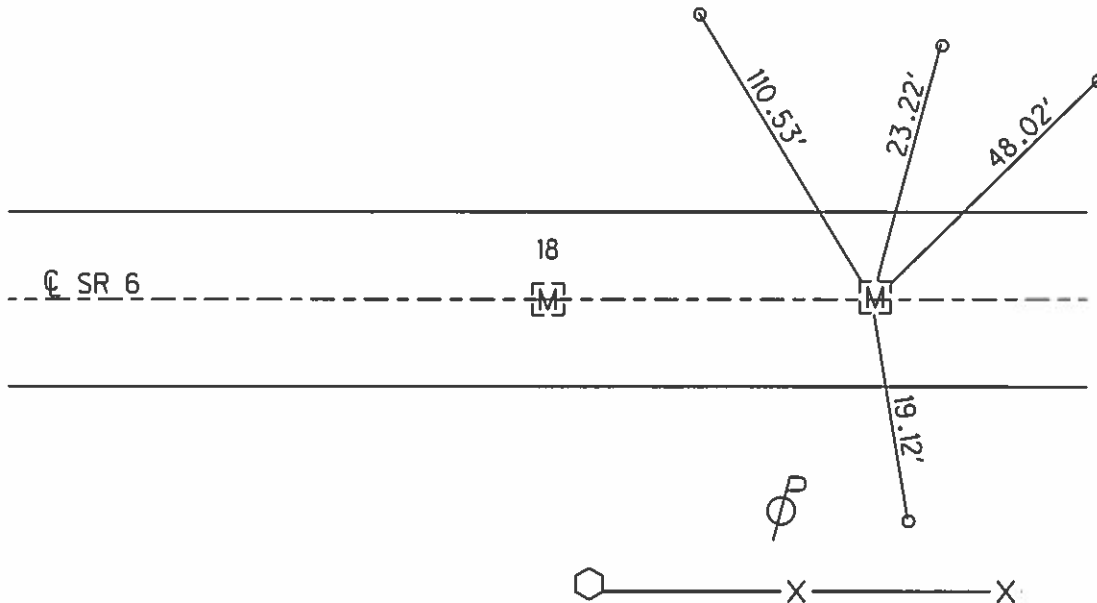

Copy

PERSONNEL	TITLE	PERSONNEL	TITLE	COUNTY	DATE	WEATHER	TEMP.
Arnot		Gerber		Sandusky	9/12/60		
Hawk		Swartz		S. R. 6			
Schneider		Pfefferle		San 6 (6.78-9.28)			
Mosser				SEC. San 590 (6.56)			
DESCRIPTION	SE 32-SW33	TSN R14E	Washington Twp	JOB NO.			
	LEFT	CENTER LINE	RIGHT				

MATERIAL ENCOUNTERED 671.4 STA 425+28 @ 4 Survey  
 0" = GROUND LEVEL ~~671.4~~

- 0"-3" Black top
- 3"-6 1/2" Brick
- 6 1/2"-7" Sand
- 7"-12" Concrete (no reinforcing)

Fd. Man. Box  
Buried

Dug to 30" deep. No Stone  
or other survey mark encountered.