

O.D.O.T. DISTRICT 2 SURVEY OFFICE (USE ONLY)

PERSONNEL _____ REFERENCE NO. 22 B SHEET 15 OF 25
 NOTES HOMAN DATE 07/07/04 ROUTE SR 6
 H.C. NUHFER WEATHER CLOUDY COUNTY SANDUSKY
 R.C. CANTERBURY TEMP. +75° TOWNSHIP JACKSON
ADKINS SECTION 2
HUSS BARNHISEL T 4 N R 14 E

TYPE MONUMENT MON BOX W/ IRON PIN
 ON SURFACE - ~~BELOW~~ ON
~~LEFT - C PAV'T - RIGHT~~ ON
12.6' TO RT EDGE PAVEMENT
 S.L.M. 531+00
 GRID: NORTHING: 611020.556 EASTING: 1769705.033

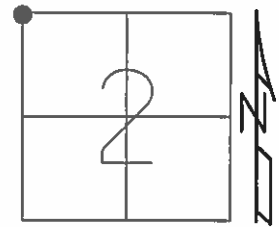

RECORD: 530+00.39

REFB22
 FD MON BOX
 W/ 1" IPIN
 06-23-16
 DCH, JLL

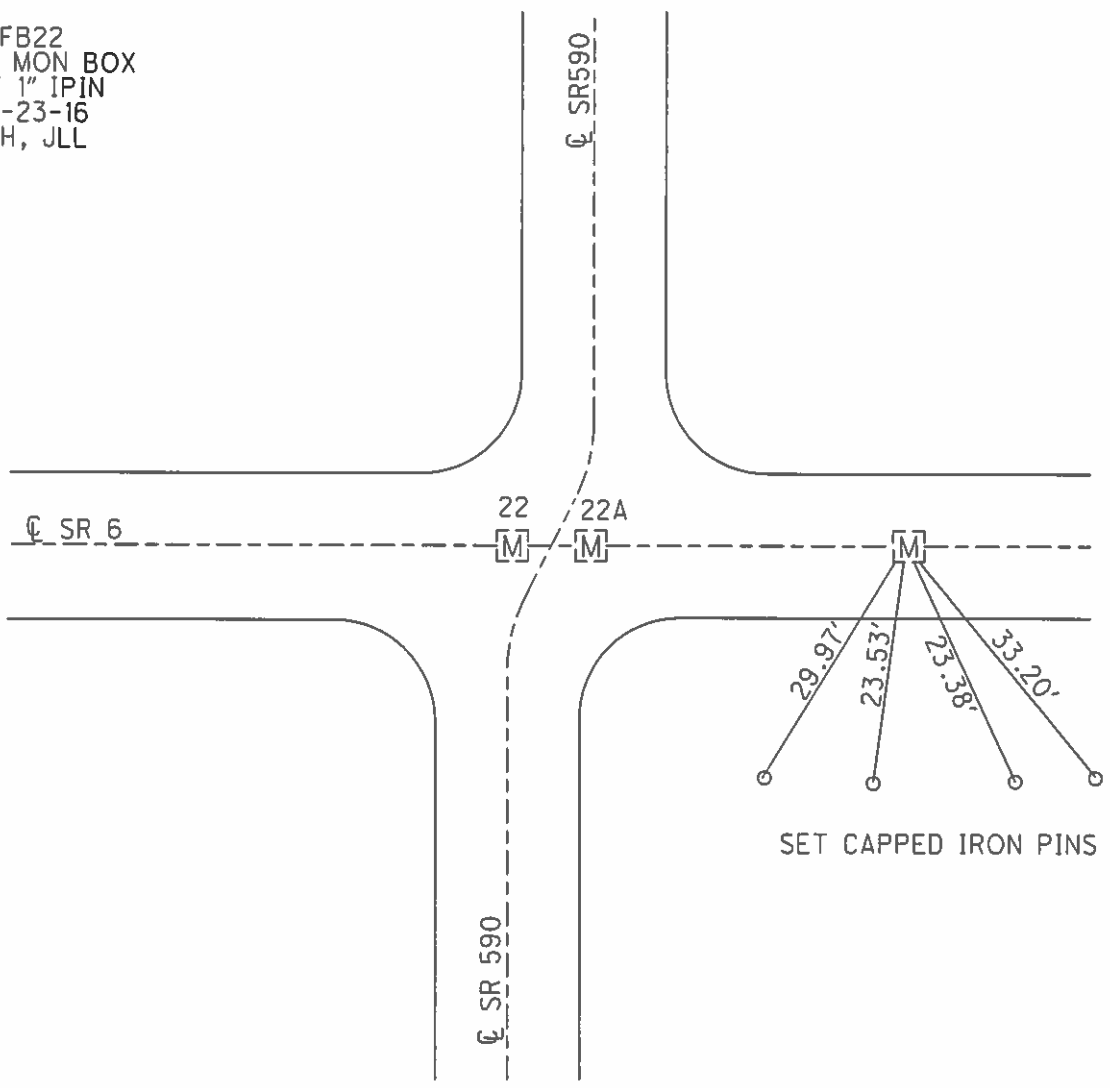

SET CAPPED IRON PINS

O.D.O.T. DISTRICT 2 SURVEY OFFICE (USE ONLY)

PERSONNEL _____ REFERENCE NO. 22 B SHEET 15 OF 25
 NOTES HOMAN DATE 7-7-04 ROUTE SR 6
 H.C. NUHFER WEATHER CLOUDY COUNTY SANDUSKY
 R.C. CANTERBURY TEMP. +75° TOWNSHIP JACKSON
ADKINS SECTION 2
HUSS BARNHISEL T 4 N R 14 E

TYPE MONUMENT MON BOX W/ IRON PIN
 ON SURFACE - ~~BELOW~~ ON
 LEFT - ☉ PAV'T - RIGHT ON
12.6' TO RT EDGE PAVEMENT
 S.L.M. 531+00
 GRID: NORTHING: _____ EASTING: _____

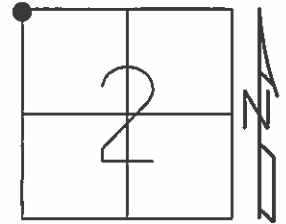

RECORD: 530+00.39

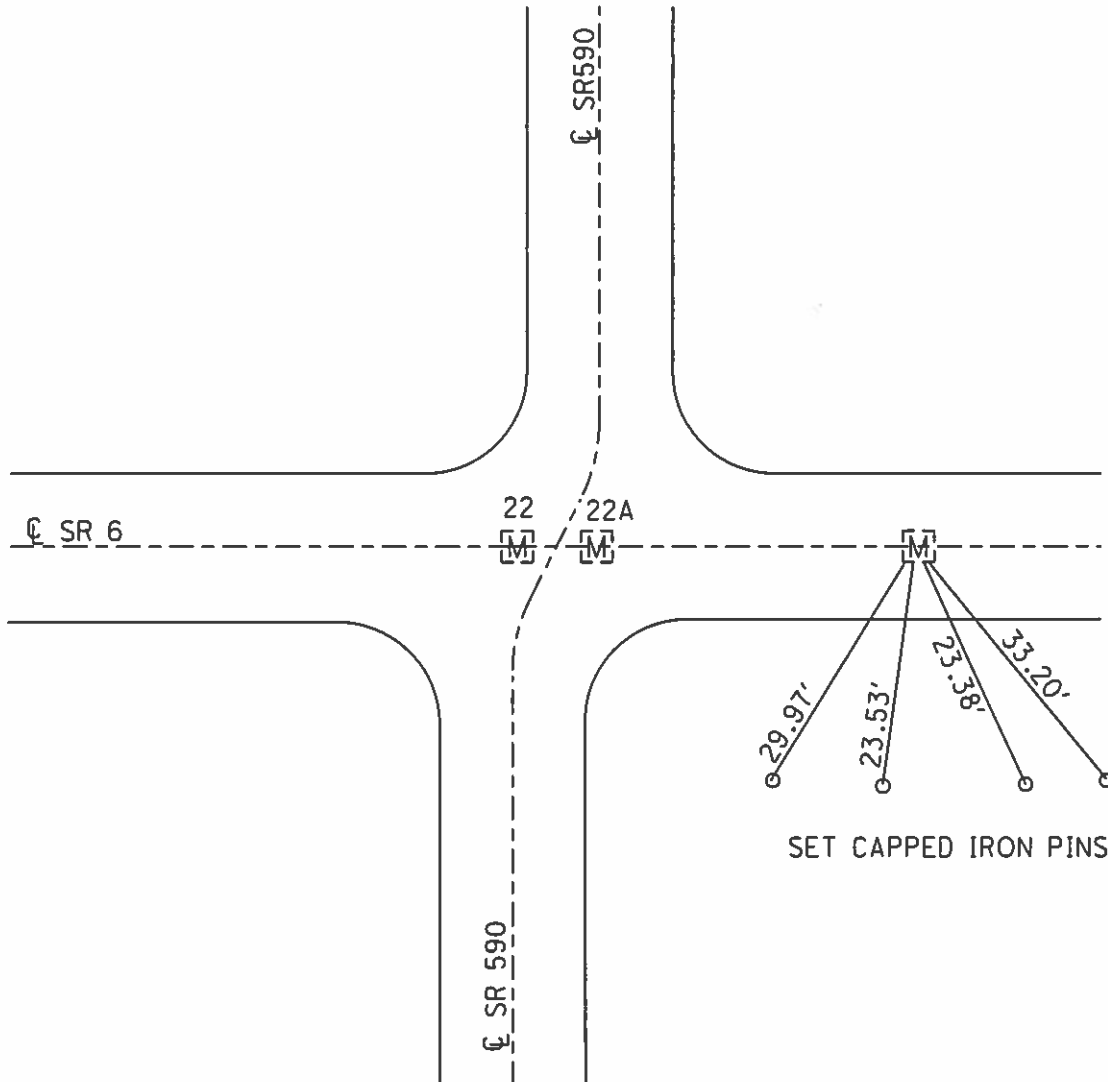

PERSONNEL	TITLE	PERSONNEL	TITLE	COUNTY	DATE
<u>Schneider</u>				<u>Sandusky</u>	<u>Dec-1967</u>
<u>Barocur</u>				S. R.	WEATHER
<u>Redding</u>				<u>U.S.#6</u>	
<u>...</u>				SEC. <u>Helena East</u>	TEMP.
DESCRIPTION	<u>Ties for center line</u>				JOB NO.

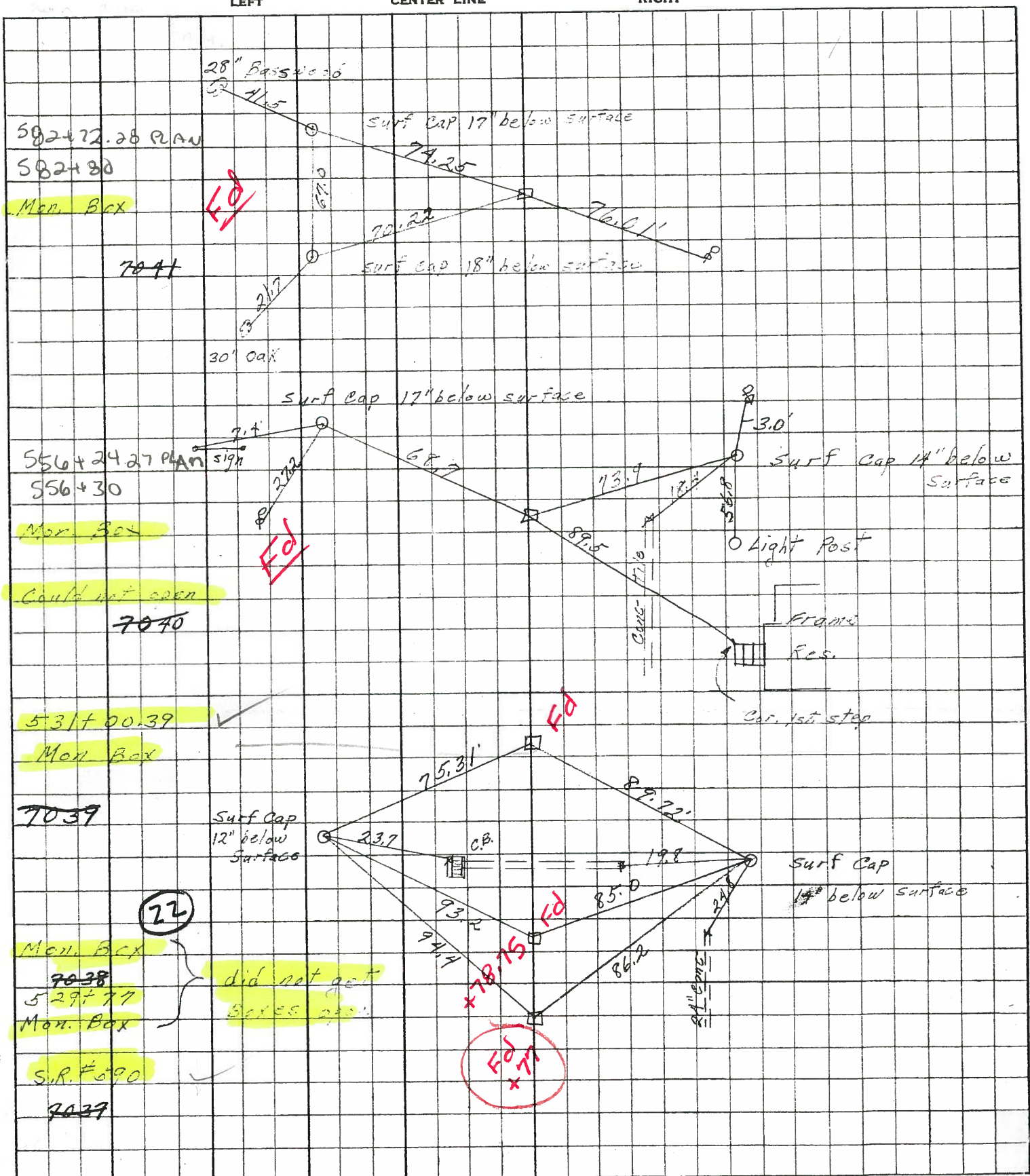

582+72.28 PLAN
582+80
Mon. Box

556+24.27 PLAN
556+30
Mon. Box
Could not open

531+00.39
Mon. Box
7039

Mon. Box
7038
529+77
Mon. Box

S.R.#590
7037

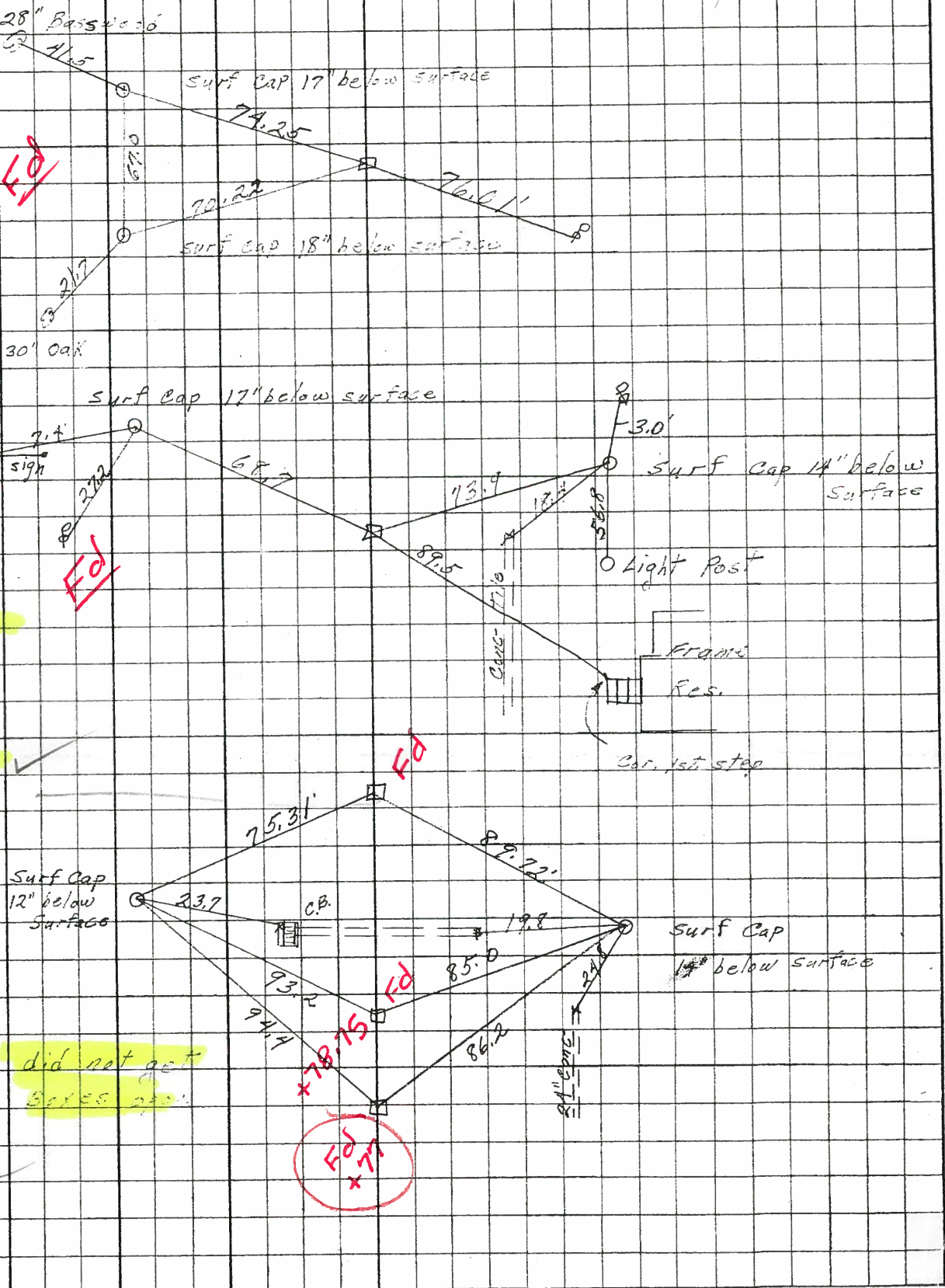

22

FD x 77