

**O.D.O.T. DISTRICT 2 SURVEY OFFICE (USE ONLY)**

PERSONNEL \_\_\_\_\_ REFERENCE NO. 25 B SHEET 23 OF 25  
 NOTES HOMAN DATE 07/07/04 ROUTE SR 6  
 H.C. NUHFER WEATHER CLOUDY COUNTY SANDUSKY  
 R.C. CANTERBURY TEMP. +80° TOWNSHIP BALLVILLE  
BARNHEISEL SECTION 6  
HUSS/ADKINS T 4 N R 15 E

TYPE MONUMENT \_\_\_\_\_ MON BOX \_\_\_\_\_  
 ON SURFACE - ~~BELOW~~ \_\_\_\_\_ ON \_\_\_\_\_  
~~LEFT - C PAV'T~~ - RIGHT \_\_\_\_\_ 2' \_\_\_\_\_  
 \_\_\_\_\_ 10' TO RT EDGE PAVEMENT  
 S.L.M. \_\_\_\_\_ 647+71 \_\_\_\_\_

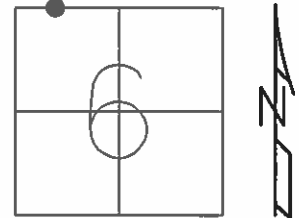

GRID: NORTHING: 611159.709 EASTING: 1781352.838

RECORD: 647+55.38

REFC25  
 FD MON BOX  
 W/ 1" IPIN  
 06-23-16  
 DCH, JLL

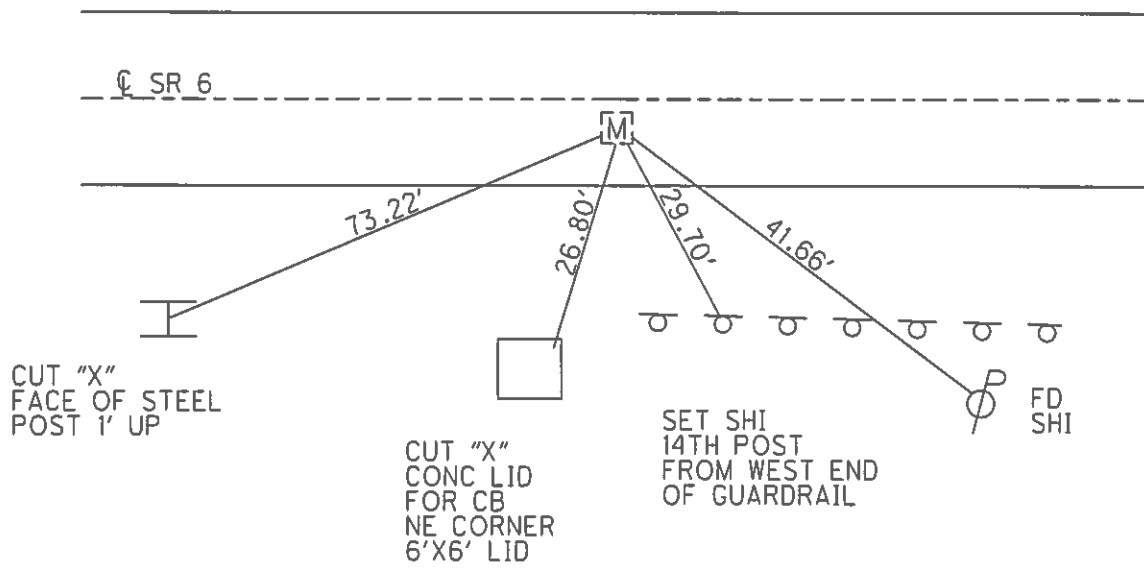

O.D.O.T. DISTRICT 2 SURVEY OFFICE (USE ONLY)

PERSONNEL \_\_\_\_\_ REFERENCE NO. 25 B SHEET 23 OF 25  
 NOTES HOMAN DATE 7-7-04 ROUTE SR 6  
 H.C. NUHFER WEATHER CLOUDY COUNTY SANDUSKY  
 R.C. CANTERBURY TEMP. +80° TOWNSHIP BALLVILLE  
BARNHISEL SECTION 6  
HUSS/ADKINS T 4 N R 15 E

TYPE MONUMENT MON BOX  
 ON SURFACE - ~~BELOW~~ ON \_\_\_\_\_  
~~LEFT~~ - Q PAV'T - RIGHT 2'  
10' TO RT EDGE PAVEMENT  
 S.L.M. 647+71  
 GRID: NORTHING: \_\_\_\_\_ EASTING: \_\_\_\_\_

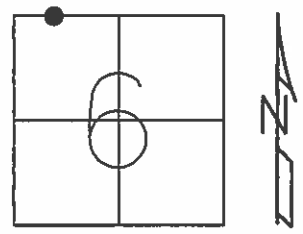

RECORD: 647+55.38

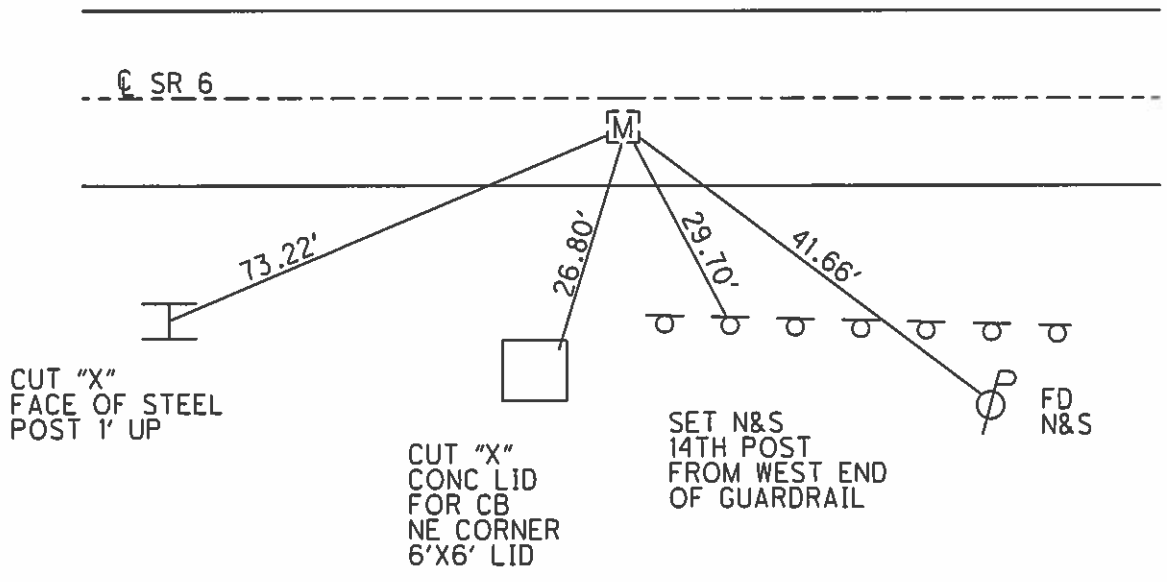

PERSONNEL TITLE PERSONNEL TITLE

COUNTY Madison

DATE Dec-8, 1960

Shannon

Barbour

Reid

Boots

S. R. U.S. # 6

WEATHER Cloudy

SEC. Holers East

TEMP. \_\_\_\_\_

DESCRIPTION

Ties for Control Points

JOB NO. \_\_\_\_\_

LEFT

CENTER LINE

RIGHT

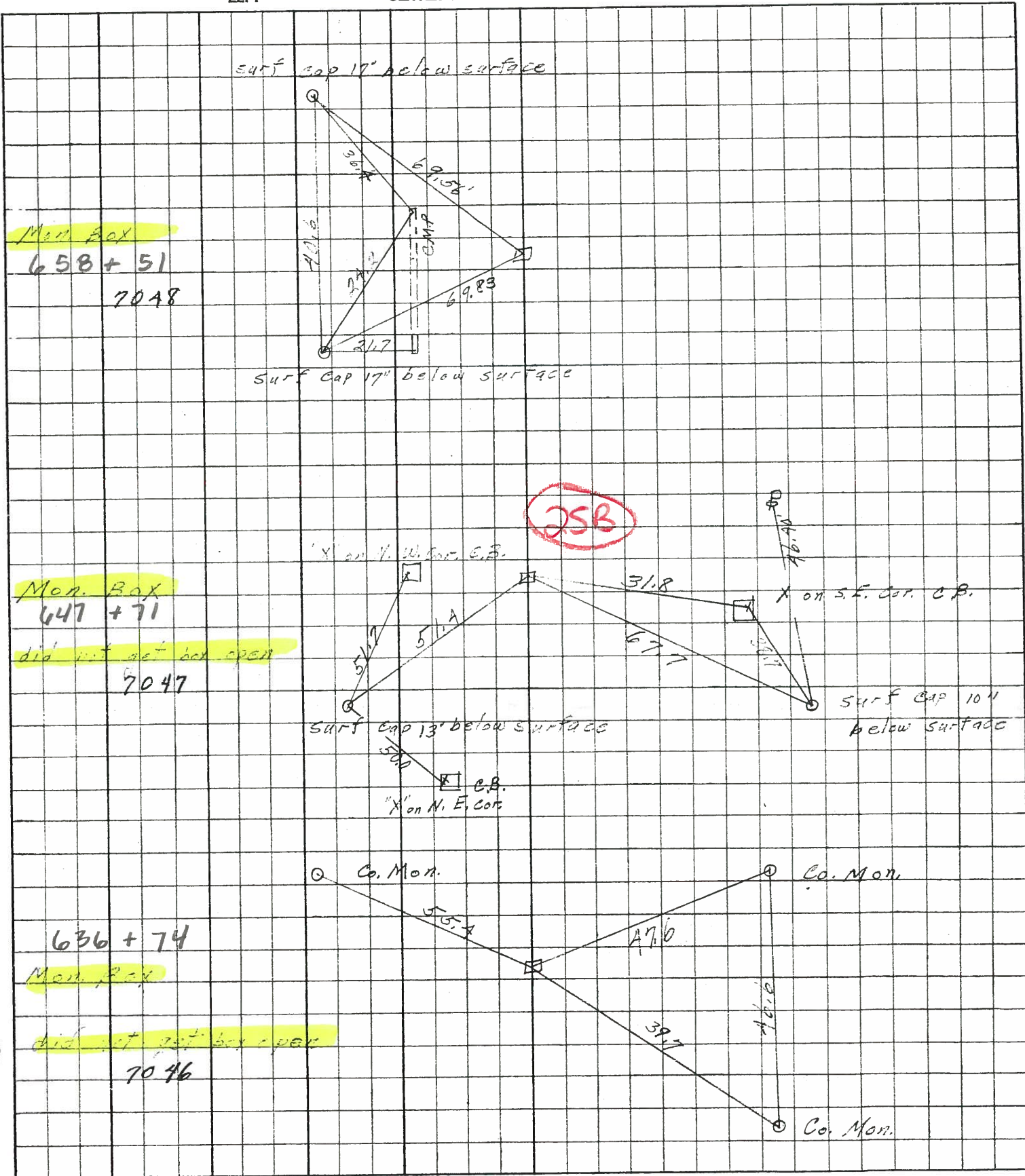

PERSONNEL	TITLE	PERSONNEL	TITLE
ARNOT		Gerber	
HAWK		Schwartz	
SCHNEIDER		PFEFFERLE	
MOSER			

COUNTY Sandusky DATE 9/8/60  
 S. R. 6 WEATHER \_\_\_\_\_  
 SEC. 5A 590 (6.56) TEMP. \_\_\_\_\_  
San 6 (6.78-9.28)

DESCRIPTION (N) W/16 Sec 6 TAN RISE JOB NO. \_\_\_\_\_  
 LEFT CENTER LINE RIGHT

Material Encountered:

0" = Ground Level = 647.6

0"-2" Black top

2"-12" Base

0' 11 1/2" Found 9" Diameter Granite Boulder

Set 1" Iron Pipe Over Stone.  
Top of Pipe 2"± Below Top of Pavement

