

**O.D.O.T. DISTRICT 2 SURVEY OFFICE (USE ONLY)**

PERSONNEL \_\_\_\_\_ REFERENCE NO. 27 SHEET 25 OF 25  
 NOTES HOMAN DATE 07/08/04 ROUTE SR 6  
 H.C. NUHFER WEATHER CLOUDY COUNTY SANDUSKY  
 R.C. CANTERBURY TEMP. +65° TOWNSHIP SANDUSKY  
BARNHISEL SECTION 31  
HUSS/ADKINS T 5 N R 15 E

TYPE MONUMENT MON BOX W/ IRON PIN  
 ON SURFACE - ~~BELOW~~ ON \_\_\_\_\_  
~~LEFT~~ - CL PAV'T - ~~RIGHT~~ ON, 5' W OF CL CR 130  
12.2' TO RT EDGE PAVEMENT  
 S.L.M. 671+01

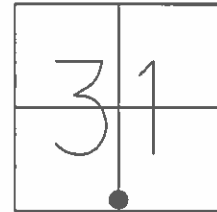

GRID: NORTHING: 61118.007 EASTING: 1783670.557

REF27  
 FD MON BOX  
 W/ 1" IPIN  
 06-23-16  
 DCH, JLL

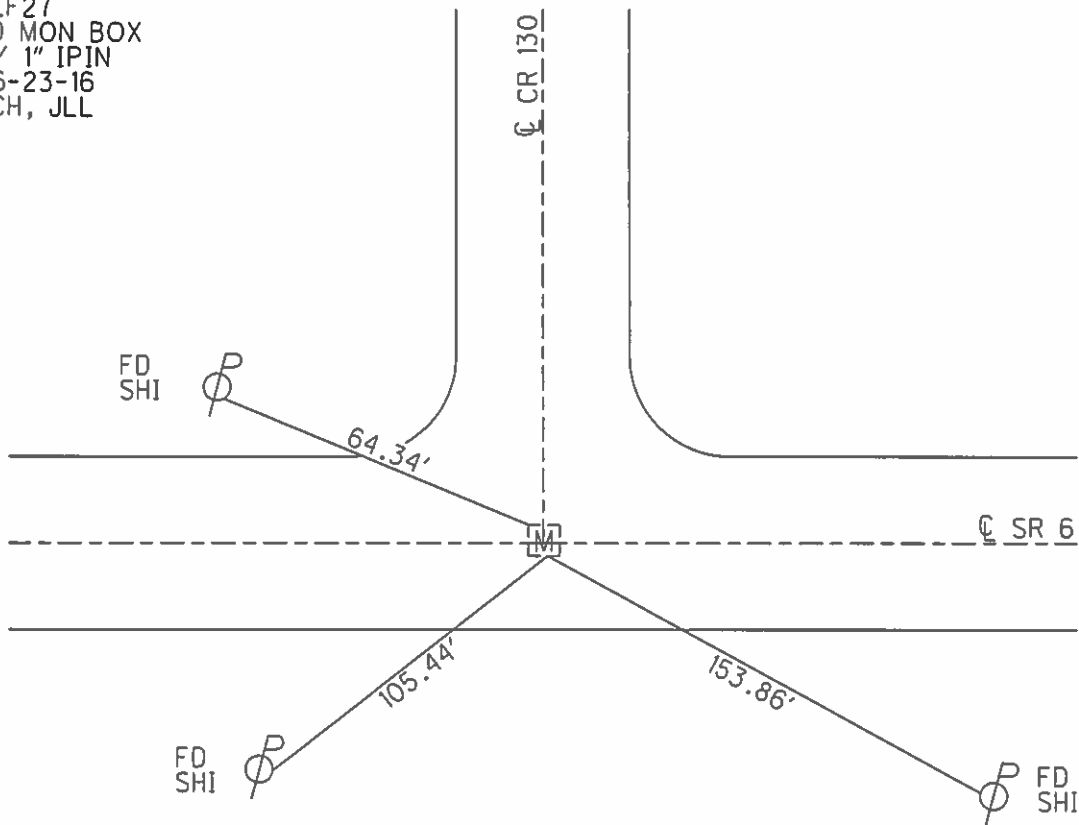

O.D.O.T. DISTRICT 2 SURVEY OFFICE (USE ONLY)

PERSONNEL \_\_\_\_\_ REFERENCE NO. 27 SHEET 25 OF 25  
 NOTES HOMAN DATE 7-8-04 ROUTE SR 6  
 H.C. NUHFER WEATHER CLOUDY COUNTY SANDUSKY  
 R.C. CANTERBURY TEMP. +65° TOWNSHIP SANDUSKY  
BARNHISEL SECTION 31  
HUSS/ADKINS T 5 N R 15 E

TYPE MONUMENT MON BOX W/ IRON PIN  
 ON SURFACE - ~~BELOW~~ ON \_\_\_\_\_  
 LEFT - ☉ PAV'T - RIGHT ON, 5' W. OF ☉ CR 130  
12.2' TO RT EDGE PAVEMENT  
 S.L.M. 671+01

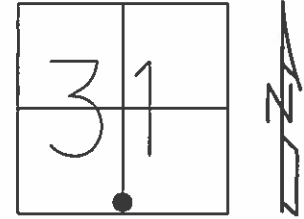

GRID: NORTHING: \_\_\_\_\_ EASTING: \_\_\_\_\_

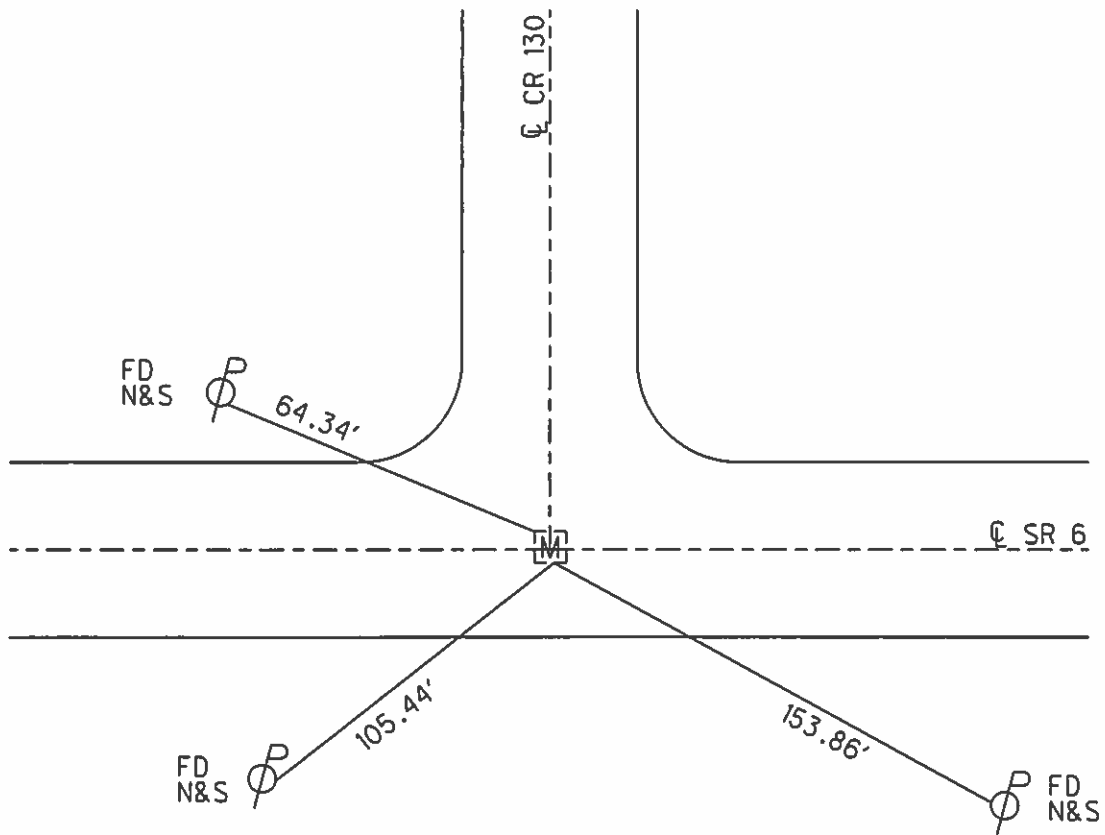

PERSONNEL TITLE PERSONNEL TITLE

COUNTY Sandwich DATE Dec. 8, 1927

S. R. 1.3 = 6 WEATHER

SEC. Helena East TEMP.

DESCRIPTION Ties for Control Points JOB NO.

