

O.D.O.T. DISTRICT 2 SURVEY OFFICE (USE ONLY)

PERSONNEL

REFERENCE NO. 27 A

SHEET 1 OF 18

NOTES LEU

DATE 6/17/19

ROUTE US 6

H.C. LEU

WEATHER CLOUDY

COUNTY SANDUSKY

R.C. AUBLE

TEMP. 63°

TOWNSHIP SANDUSKY

SECTION 25

DWG BY GARRETT PID 77825

T 5 N R 15 E

TYPE MONUMENT MONBOX W/ 1" IPIN

ON SURFACE - ~~BELOW~~ ON

OFFSET  $\odot$  PAVEMENT ON LT : RT

- TO - EDGE PAVEMENT

STATION: 983+26.5

HORZ.DATUM: NAD83 (2011)

GEOID: 2012A

GRID: NORTHING: 618098.707

EASTING: 1807119.409

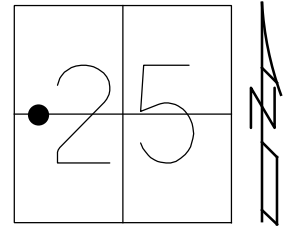

RECORD:  
FD MONBOX  
6/10/08, DH  
FD MONBOX  
REF 27  
11/15/19, JLL

DIST, 27A-28= 5.18'

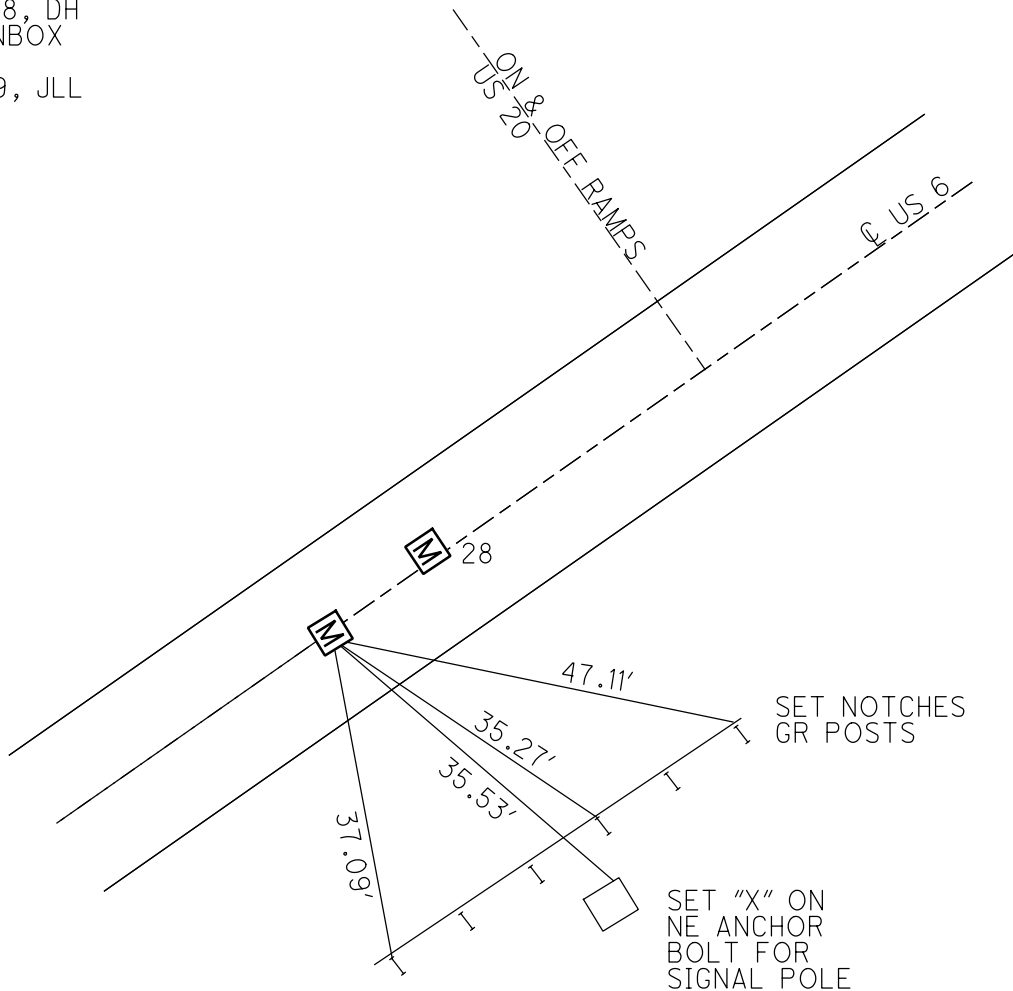

O.D.O.T. DISTRICT 2 SURVEY OFFICE

PERSONNEL

NOTES HOMAN  
H.C. HOMAN  
R.C. ROUSOS

REFERENCE NO. 27 A  
DATE 8/06/09  
WEATHER SUNNY  
TEMP. 70°

SHEET 1 OF 17  
ROUTE US 6  
COUNTY SANDUSKY  
TOWNSHIP SANDUSKY  
SECTION 25  
T 5 N R 15 E

TYPE MONUMENT MON.BOX  
ON SURFACE - ~~BELOW~~ ON  
LEFT - Q PAV'T - RIGHT  
Q TO Q EDGE PAVEMENT  
S.L.M. 983+26.5  
GPS Northing: 618093.646 Easting: 1807117.324

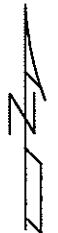
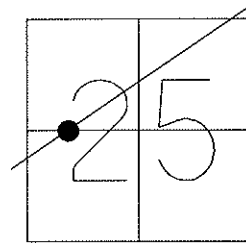

FD MON BOX  
6/10/08 DH

