

O.D.O.T. DISTRICT 2 SURVEY OFFICE (USE ONLY)

PERSONNEL \_\_\_\_\_ REFERENCE NO. 37 SHEET 19 OF 19  
 NOTES AUBLE DATE 7/26/21 ROUTE US 6  
 H.C. NIESE WEATHER CALM COUNTY SANDUSKY  
 R.C. AUBLE TEMP. 77° TOWNSHIP RILEY  
 DWG BY NIESE PID 108868 SECTION 16  
 T 5 N R 16 E

TYPE MONUMENT MAG NAIL  
 ON SURFACE - ~~BELOW~~ ON  
 OFFSET ☉ PAVEMENT ON LT : RT  
- TO - EDGE PAVEMENT  
 STATION: 1233+58

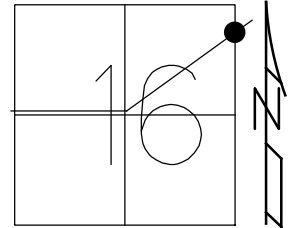

HORIZ.DATUM: NAD83 (2011) GEOID: 2012A  
 GRID: NORTHING: 630774.469 EASTING: 1828088.743

RECORD:  
 FD MAG NAIL  
 REFA37  
 N: 630774.469  
 E: 1828088.743  
 11/22/17, DCH  
 FD MAG NAIL  
 7/26/21, TDN  
 2/10/22, JFO

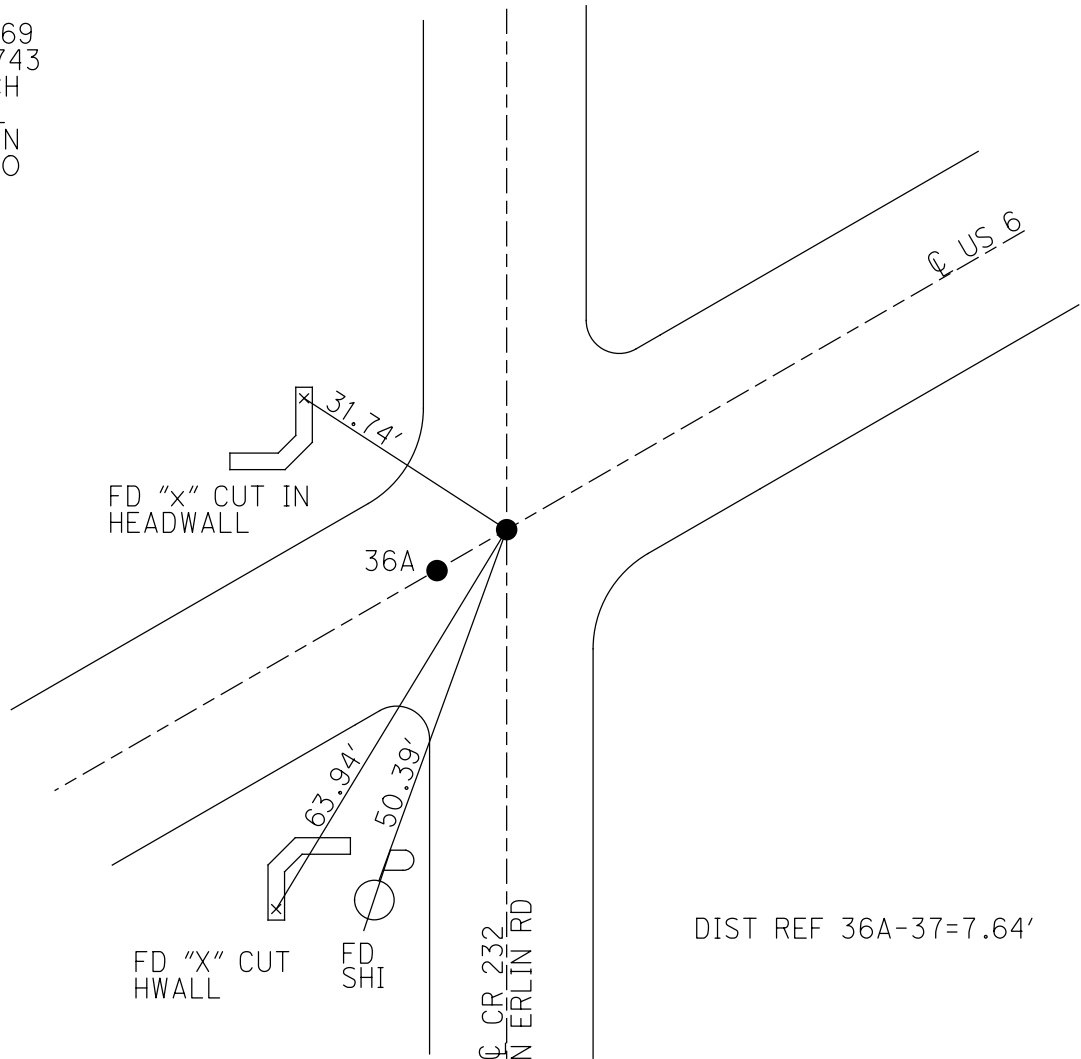

O.D.O.T. DISTRICT 2 SURVEY OFFICE (USE ONLY)

PERSONNEL \_\_\_\_\_ REFERENCE NO. 37 SHEET 19 OF 19  
 NOTES AUBLE DATE 7/26/21 ROUTE US 6  
 H.C. NIESE WEATHER CALM COUNTY SANDUSKY  
 R.C. AUBLE TEMP. 77° TOWNSHIP RILEY  
 DWG BY NIESE PID 108868 SECTION 16  
 T 5 N R 16 E

TYPE MONUMENT MAG NAIL  
 ON SURFACE - ~~BELOW~~ ON  
 OFFSET ☉ PAVEMENT ON LT : RT  
- TO - EDGE PAVEMENT  
 STATION: 1233+58

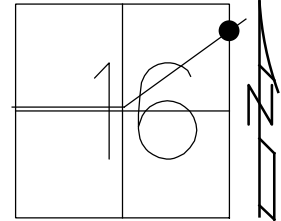

HORIZ.DATUM: NAD83 (2011) GEOID: 2012A  
 GRID: NORTHING: 630774.469 EASTING: 1828088.743

RECORD:  
 FD MAG NAIL  
 REFA37  
 N: 630774.469  
 E: 1828088.743  
 11/22/17, DCH  
 FD MAG NAIL  
 7/26/21, TDN

