

O.D.O.T. DISTRICT 2 SURVEY OFFICE (USE ONLY)

PERSONNEL _____ REFERENCE NO. 1 C SHEET 3 OF 24
 NOTES O'DONNELL DATE 5-27-15 ROUTE SR 12
 H.C. LEU WEATHER SUNNY COUNTY SANDUSKY
 R.C. RHOADES TEMP. 75°F TOWNSHIP JACKSON
 SECTION 35
 T 4 N R 14 E

TYPE MONUMENT PK/WASHER
 ON SURFACE - ~~BELOW~~ ON
~~LEFT~~ - Q PAV'T - RIGHT 0.2'
11.4 TO RT EDGE PAVEMENT
 S.L.M. 33+87.10

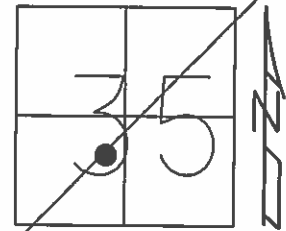

Grid: Northing: 581128.8479 Easting: 1771674.509

RECORD: P.C.
 STA 33+87.14
 COULD NOT FIND POINT.
 RESTABLISHED ALONG TAN
 LINE BETWEEN P.I. USING
 RECORD DISTANCE

CHECK OLD TIES
 FOR ADDITIONAL DATA
 NEW GUARD RAIL DID
 NOT LOCATE POINT
 11-13-94, RICHENEY

PREVENTIVE MAINTENACE
 MICROSURFACED 2000
 EXISTING POINT UNCOVERED
 DATE 9-12-00, MC

FD PK/WASHER
 GPS, REFC1
 2-26-13

FD PK/WASHER
 GPS, REFC1
 5-27-15

SET MAG/WASHER
 GPS, NEWREFC1
 9-29-16, DCH

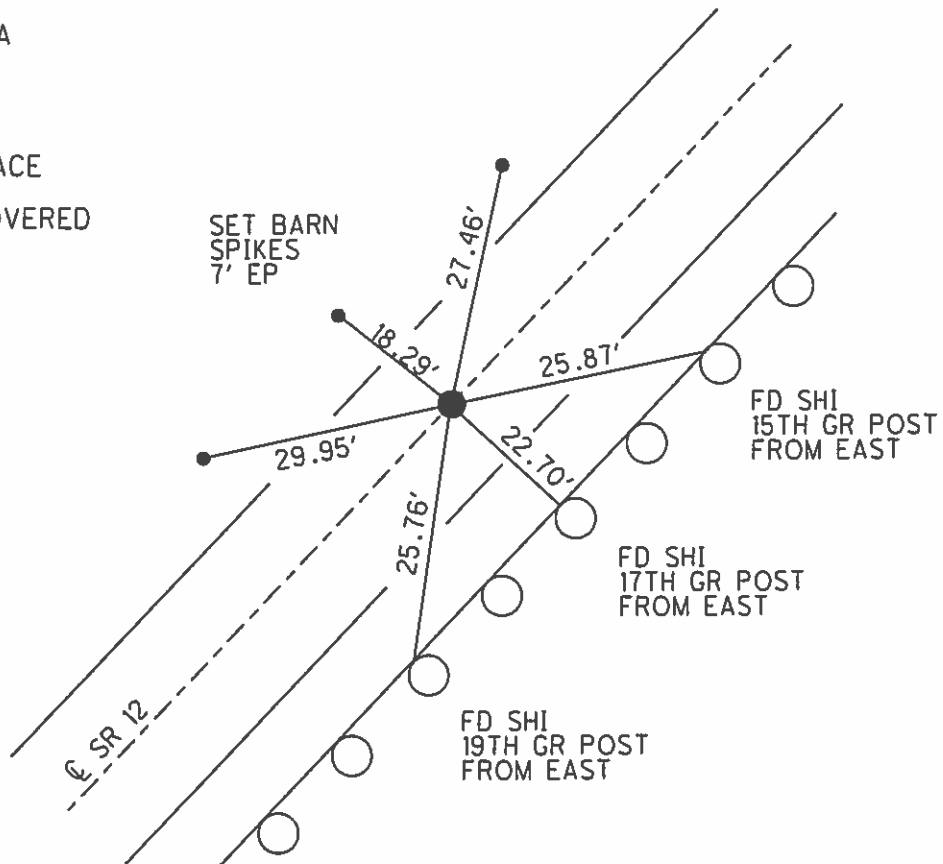

O.D.O.T. DISTRICT 2 SURVEY OFFICE

PERSONNEL

REFERENCE NO. 1c

SHEET 4 OF

NOTES LOGHRKE

H.C. CANTERBURY

R.C. VOGEL

DATE 11-7-94

WEATHER Fair

TEMP. +56

ROUTE S.R. 12

COUNTY SANDUSKY

TOWNSHIP Jackson

SECTION 35

T 4 N R 14 E

TYPE MONUMENT Set P.K. WASHER

ON SURFACE - BELOW Yes

LEFT - 0 PAV'T. - RIGHT 0.2' Rt

11.4 TO RT EDGE PAVEMENT

S.L.M. 33+93

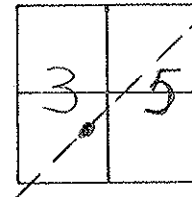

PC. Record Sta 33+87.14

Note: Could not find Point. Re-established Along TAN LINE Between P.I.'s. using RECORD DISTANCE.

NOTE:
Check OLD TIES
For additional data.
New GUARD Rail - did not
Locate point
7-13-99 R. Cheney

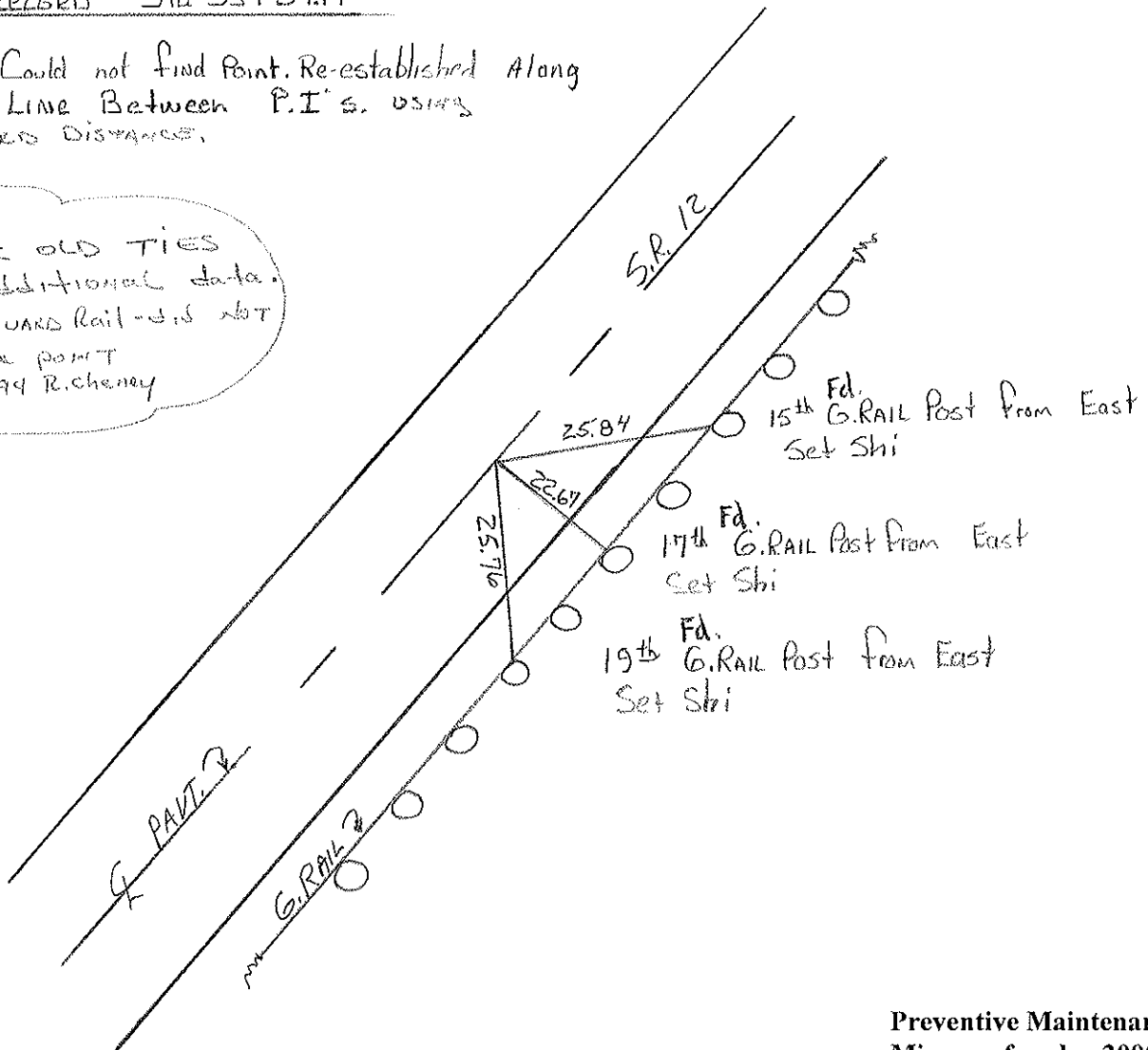

Preventive Maintenance
Microsurfaced 2000
Existing Point Uncovered
Date 9/12/2000 M.C.

County Sandusky S.R. #12

Township Jackson

Section 35

T4N, R14E

Personnel Cronin

Ripple

Geyman

Barbour

Date 8/24/84 Drawn 9/14/84

Weather sunny

Temp. 70°

1 C

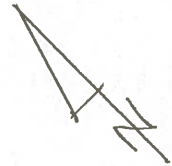
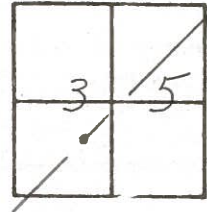

S.S.R. #127

P.C.
33+87.14
 set P.K. & washer - R.R. spike
 may or may not be below

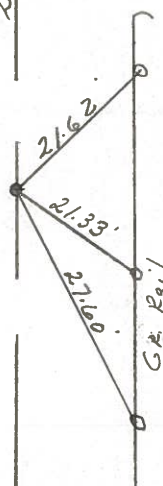

QD.O.T. DISTRICT 2 SURVEY OFFICE

Sht. 4 of 17

State Route #12

County Sandusky

Township Jackson

Section 35

T4N, R4E

Personnel Cronin

Ripple

Geyman

Date 6/11/79

Weather sunny - Windy

Temp. 70°

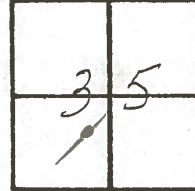

BE

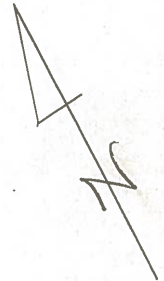

P.C.

33+87.14
Fd. R.R. spike at surface

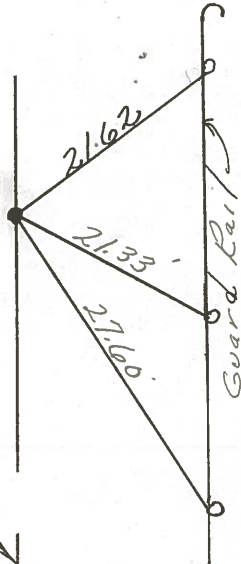

E.S.P. # 12

PERSONNEL	TITLE	PERSONNEL	TITLE
Schneider			
Mosser			
Redding			
Potts			

COUNTY Sandusky DATE Jan. 1968
 S. R. 12 WEATHER _____
 SEC. 0.00 TEMP. _____

DESCRIPTION Ties for Control P's JOB NO. _____

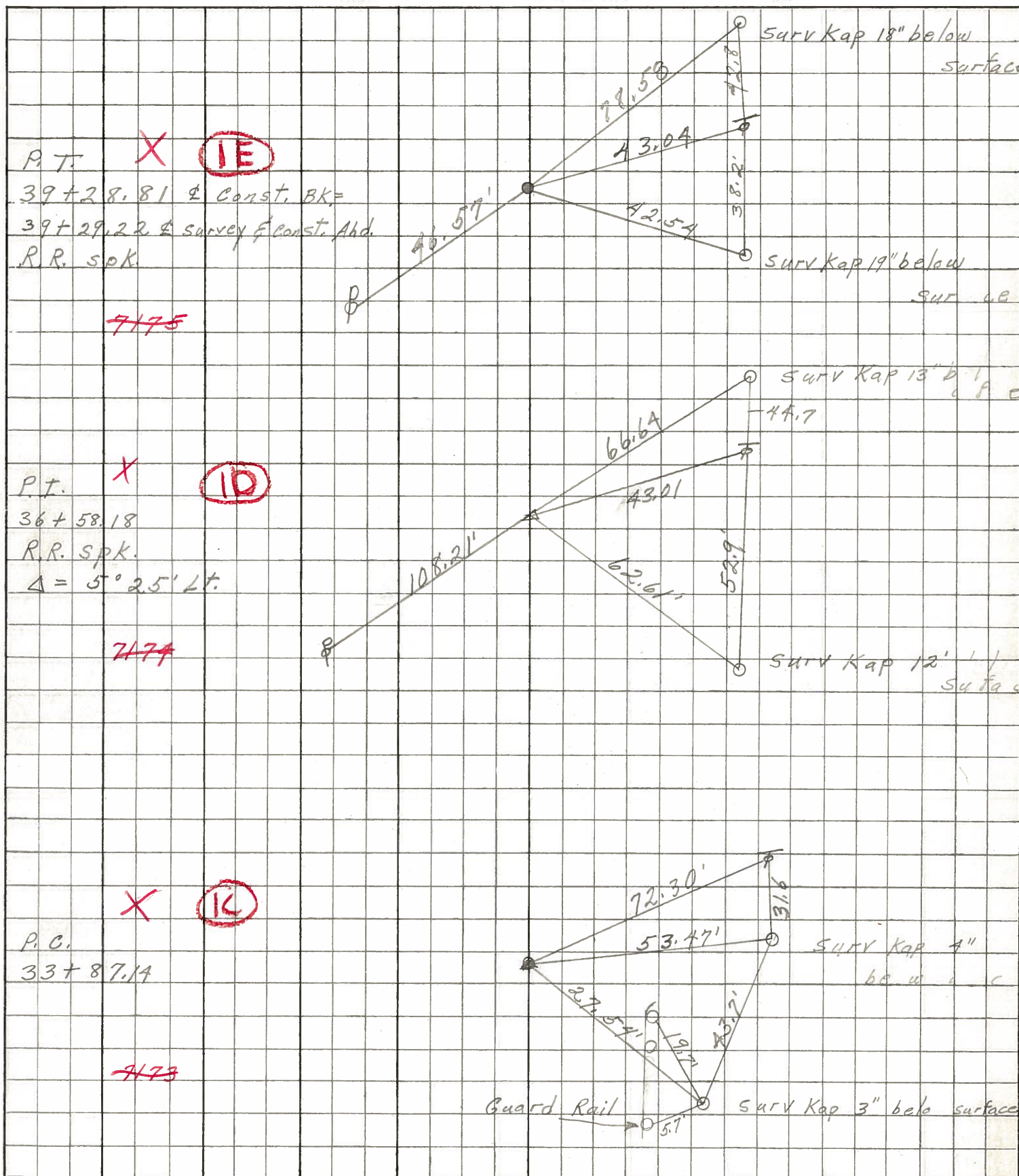

PERSONNEL	TITLE	PERSONNEL	TITLE
Schneider			
Crew			

COUNTY Sandusky DATE 5-10-65
 S. R. #12 WEATHER cloudy
 SEC. 500 6.00 TEMP.

DESCRIPTION Ties for Central Points LEFT CENTER LINE RIGHT JOB NO.

