

O.D.O.T. DISTRICT 2 SURVEY OFFICE (USE ONLY)

PERSONNEL _____ REFERENCE NO. 6 A SHEET 20 OF 25
 NOTES LOEHRKE DATE 7-15-94 ROUTE SR 12
 H.C. CANTERBURY WEATHER NICE COUNTY SANDUSKY
 R.C. MOSER TEMP. 60°F TOWNSHIP BALLVILLE
 SECTION 19
 T 4 N R 14 E

TYPE MONUMENT PK/WASHER
 ON SURFACE - ~~BELOW~~ ON
 LEFT - C PAV'T - RIGHT ON
13.8' TO RT EDGE PAVEMENT
 S.L.M. 178+95.55

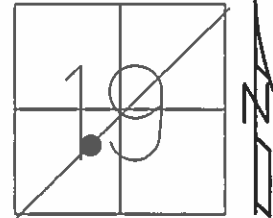

Grid: Northing: 591368.296 Easting: 1781861.848

RECORD: P.O.T.
 STA. 178+00±
 THIS POINT WAS
 SHOWN ON OLD NOTES
 SET- PK/WASHER
 8-27-84, J.C.

SET P.K./WASHER
 11-7-94, CL

PREVENTIVE MAINTENANCE
 MICROSURFACED 2000
 EXISTING POINT UNCOVERED
 DATE 9-12-00, MC

FD P.K./WASHER
 REFA6
 03-26-13

SET MAG/WASHER
 GPS, NEWREFA6
 9-29-16, DCH

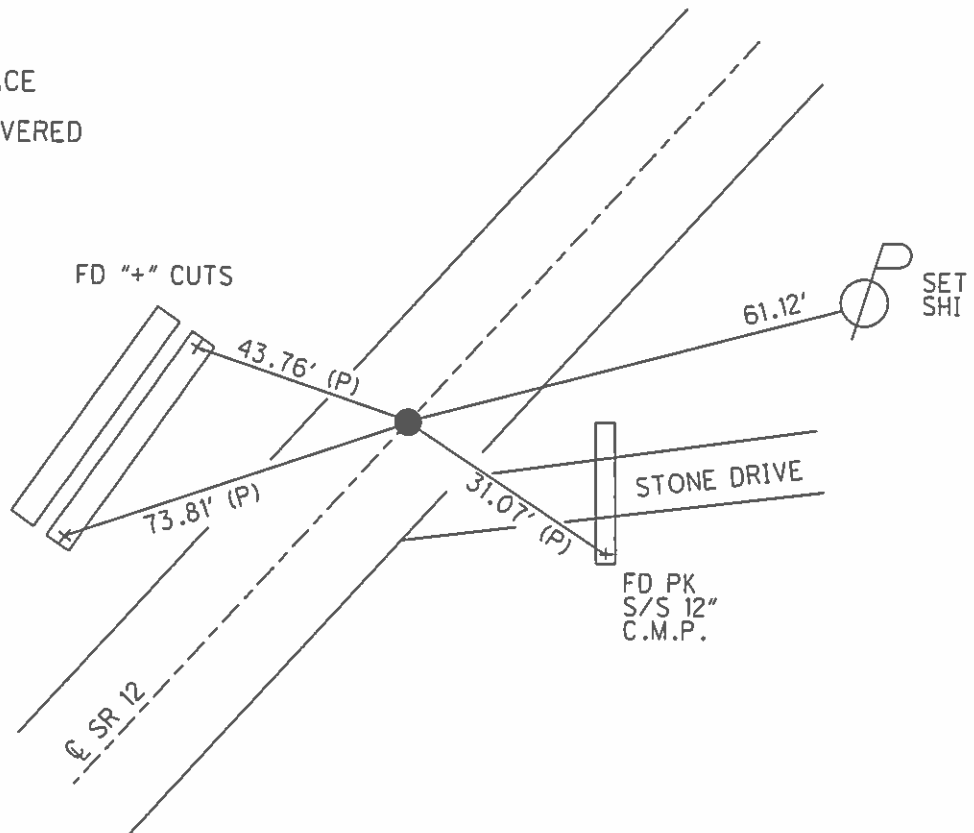

O.D.O.T. DISTRICT 2 SURVEY OFFICE

PERSONNEL _____

REFERENCE NO. _____

SHEET 17 OF _____

NOTES LOEHRLE

H.C. CANTERBURY

R.C. MOEL

DATE 7-15-94

WEATHER NICE

TEMP. +60° F

ROUTE S.R. 12

COUNTY SANDUSKY

TOWNSHIP BAUVILLE

SECTION 19

T 4 N R 15 E

TYPE MONUMENT P.K. / WASHER Reset 11-7-94
C.I.

ON SURFACE - BELOW Yes

~~LEFT~~ - ~~C~~ PAV'T. - ~~RIGHT~~ Yes

13.8 TO R+ EDGE PAVEMENT

S.L.M. 179 + 14

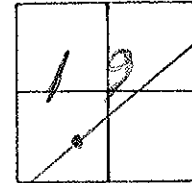

RECORD: POT ??
178 + ??
This point was shown
on old notes -
Set PK/washer
8-27-84
J.C. [unclear]

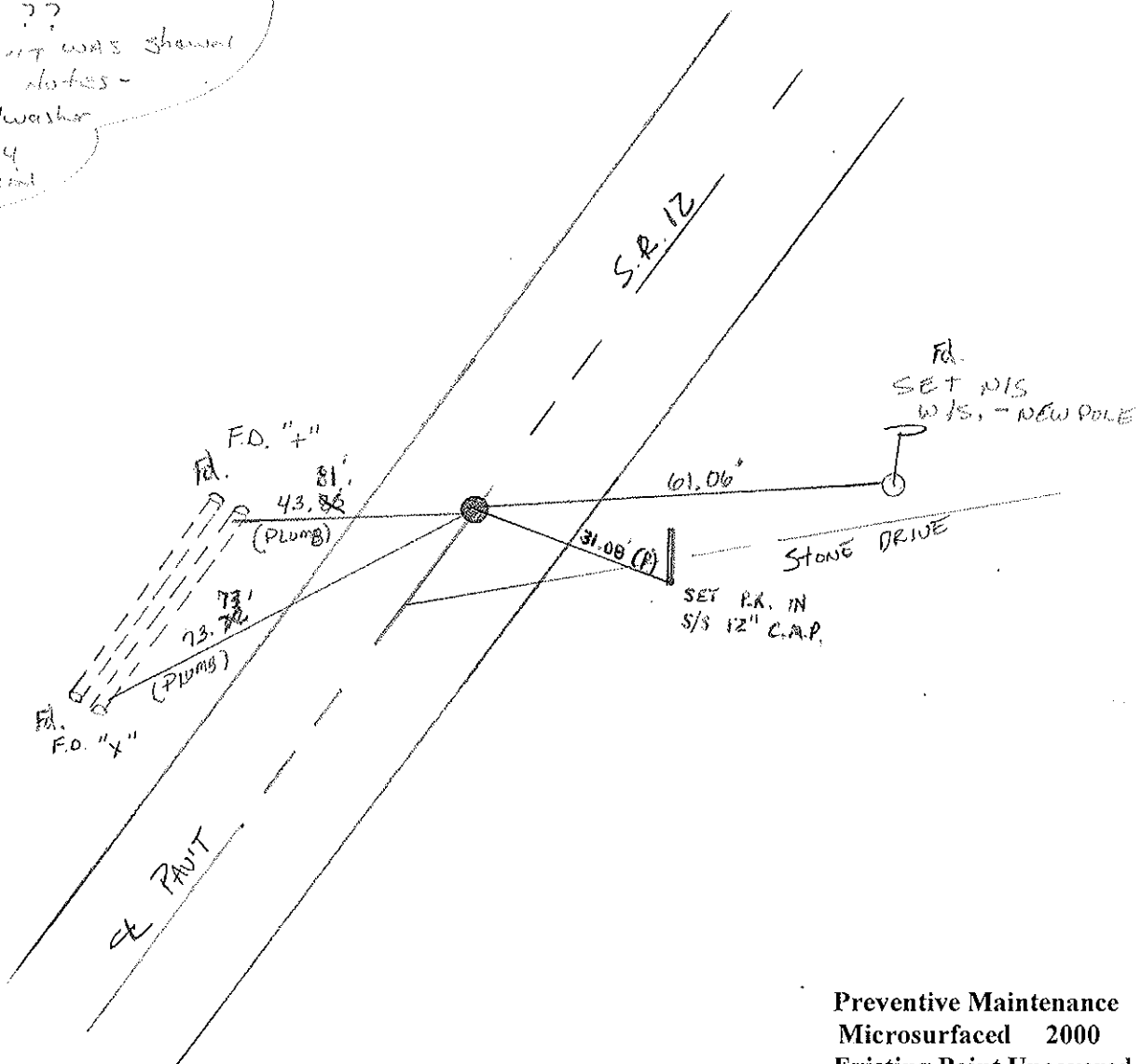

Preventive Maintenance
Microsurfaced 2000
Existing Point Uncovered
Date 9/12/2000 M.C.

County Sandusky S.R. #12

Date 8/27/84 - Drawn 9/17/84

Township Ballville

Weather sunny

Section 19

Temp. 82°

T&N, R15E

Personnel Cronin

Ripple

Geyman

Barbour

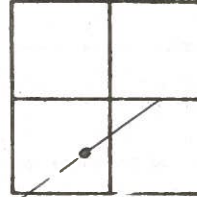

6A



S.S.R. #12

P.O.T. ??

178 + ??

This point was shown on
old notes - Set P.K. & washer

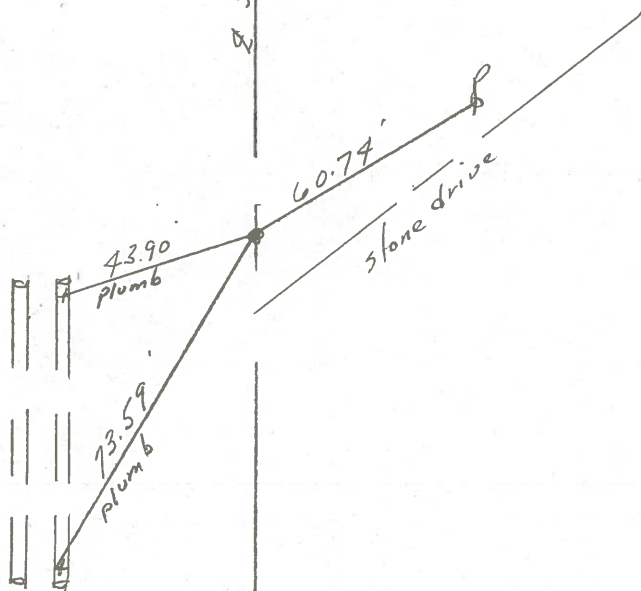

PERSONNEL	TITLE	PERSONNEL	TITLE	COUNTY	DATE
Schneider				Sandusky	Jan. 1968
Mosser				S. R. 12	WEATHER
Barbour				SEC. 1.02 - West-Fremont	TEMP.
Potts					

DESCRIPTION Ties for Control Points JOB NO. _____

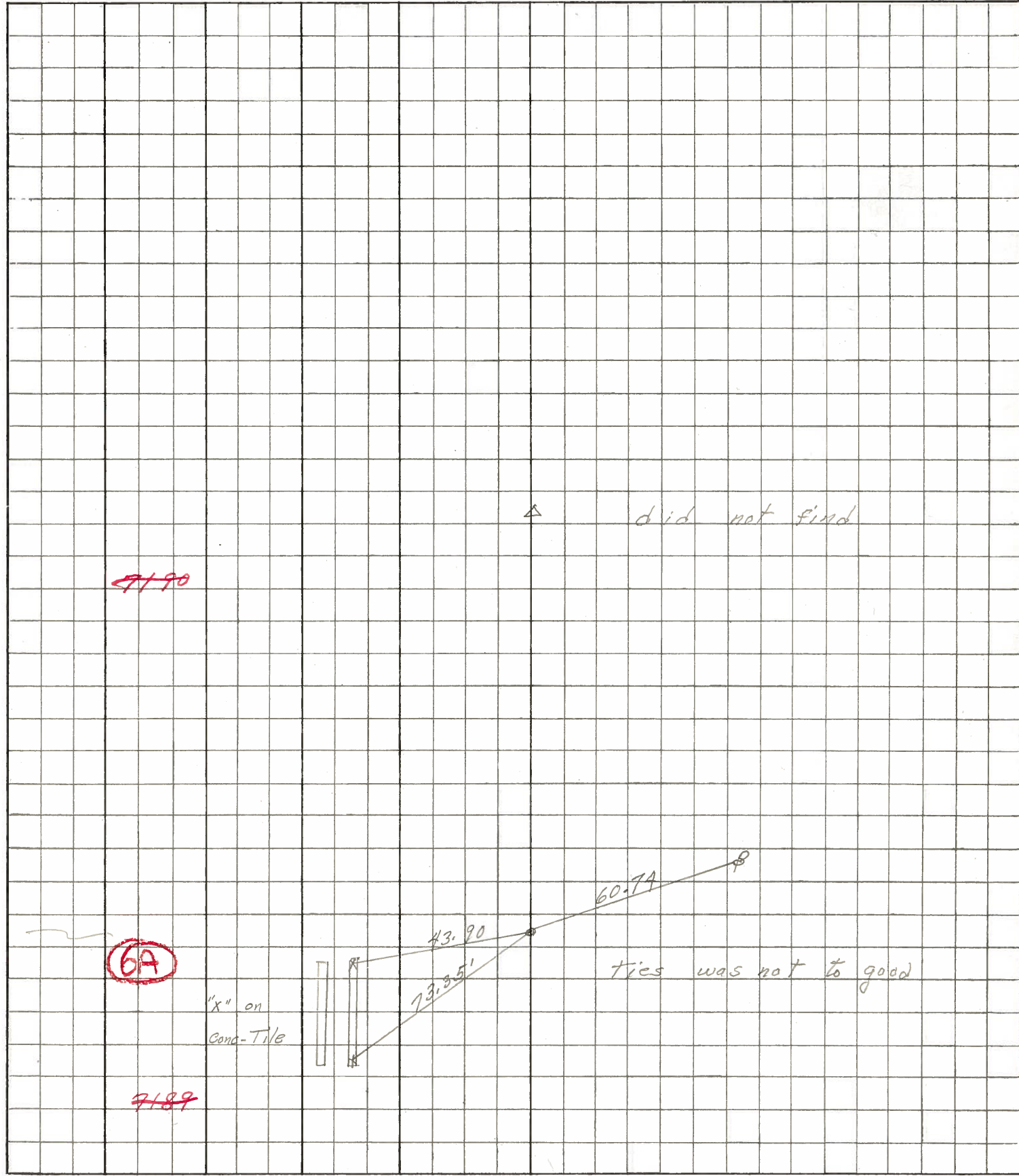

PERSONNEL TITLE PERSONNEL TITLE

COUNTY Sandusky DATE 7-25-57

S. R. #12 WEATHER

SEC. TEMP.

DESCRIPTION Relocation P.O.T. ties JOB NO.

LEFT CENTER LINE RIGHT

