

O.D.O.T. DISTRICT 2 SURVEY OFFICE (USE ONLY)

PERSONNEL

REFERENCE NO. 13 A

SHEET 1 OF 22

NOTES AUBLE

DATE 7/21/21

ROUTE SR 19

H.C. AUBLE

WEATHER FAIR

COUNTY SANDUSKY

R.C. NIESE

TEMP. 71°

TOWNSHIP SANDUSKY

DWG BY NIESE PID 94329

SECTION 28

T 5 N R 15 E

TYPE MONUMENT MONBOX W/ 1" IPIN

ON SURFACE - ~~BELOW~~ ON

OFFSET  $\varnothing$  PAVEMENT ON LT : RT

- TO - EDGE PAVEMENT

STATION: 571+84

HORZ.DATUM: NAD83 (2011)

GEOID: 18

GRID: NORTHING: 620769.818

EASTING: 1794303.949

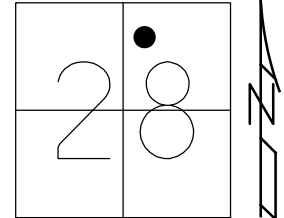

RECORD: P.O.T.  
 STA 102+00  
 FD MONBOX  
 8/26/71  
 FD MONBOX  
 W/1" IPIN  
 IN CONC MEDIAN  
 REFA13  
 7/21/21, DSA

BOLT ON  
 G.R. POSTS  
 8 POSTS  
 BETWEEN

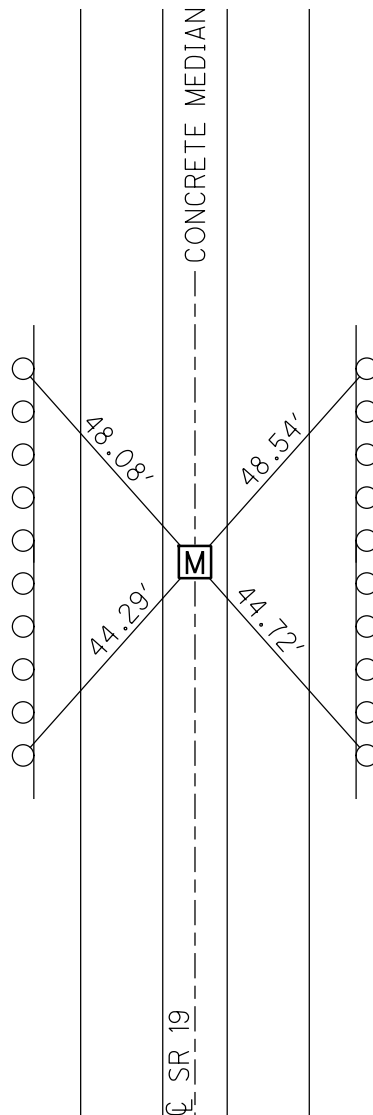

RECORD TIES  
 8/26/71

PERSONNEL \_\_\_\_\_ TITLE \_\_\_\_\_ PERSONNEL \_\_\_\_\_ TITLE \_\_\_\_\_  
 COUNTY Sandusky DATE 8-26-71  
 S. R. 19 WEATHER Partly Cloudy  
 SEC. 21 TEMP. 75°  
 DESCRIPTION U.S. # 20 to Ottawa Co. line JOB NO. \_\_\_\_\_

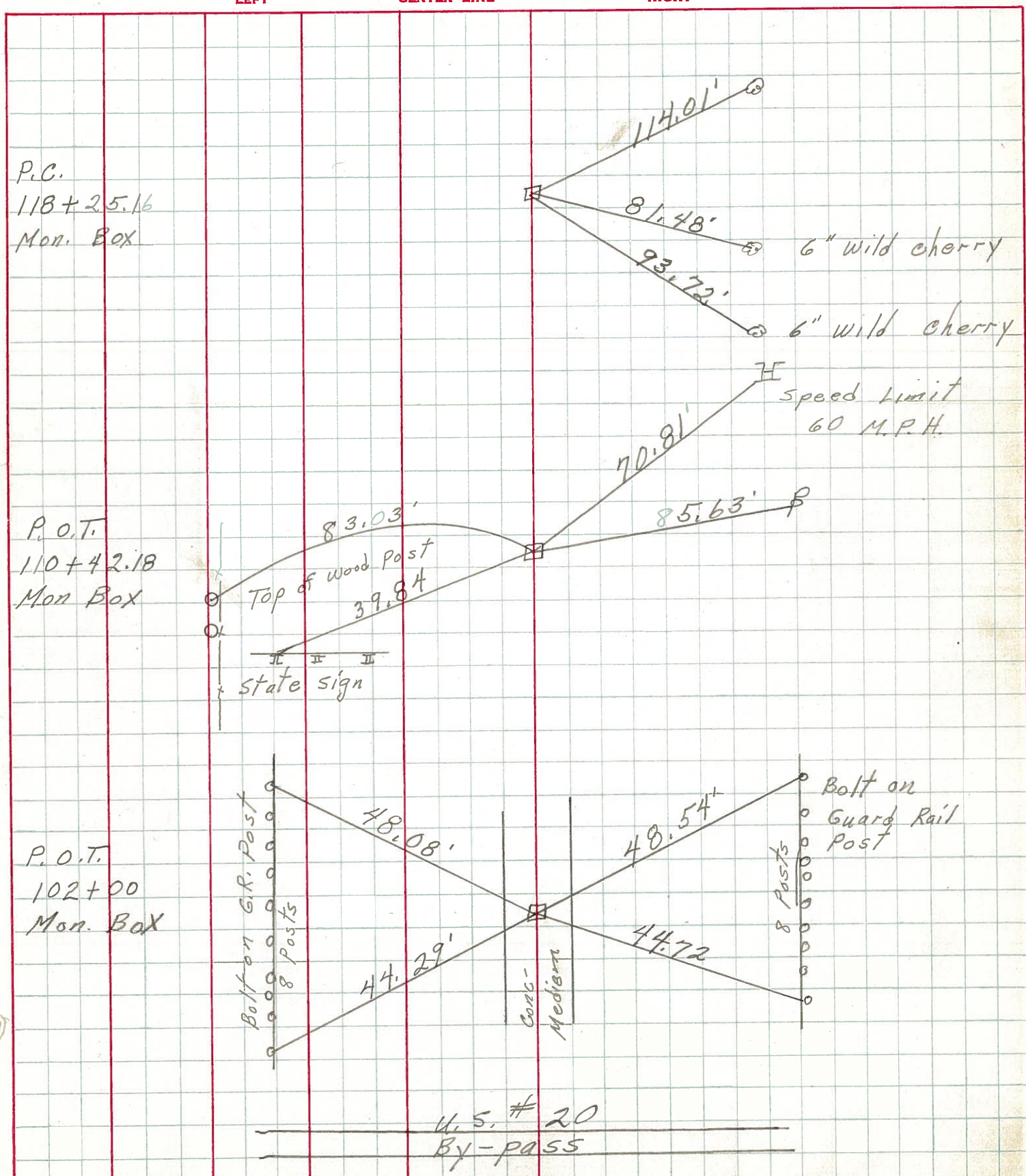

P.C.  
 118+25.16  
 Mon. Box

P.O.T.  
 110+42.18  
 Mon. Box

P.O.T.  
 102+00  
 Mon. Box

U.S. # 20  
 By-pass