

O.D.O.T. DISTRICT 2 SURVEY OFFICE (USE ONLY)

PERSONNEL

REFERENCE NO. 14 G

SHEET 12 OF 22

NOTES AUBLE

DATE 5/19/21

ROUTE SR 19

H.C. O'DONNELL

WEATHER FAIR

COUNTY SANDUSKY

R.C. NIESE

TEMP. 65°

TOWNSHIP SANDUSKY

SECTION 21

DWG BY NIESE PID 94329

T 5 N R 15 E

TYPE MONUMENT MONBOX

ON SURFACE - ~~BELOW~~ ON

OFFSET  $\varnothing$  PAVEMENT ON LT : RT

- TO - EDGE PAVEMENT

STATION: 614+18.88

HORIZ.DATUM: NAD83 (2011)

GEOID: NAVD88 2018

GRID: NORTHING: 624856.528

EASTING: 1794154.890

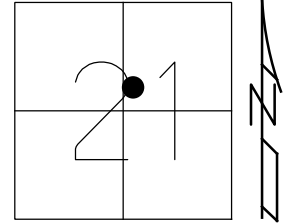

RECORD:  
P.C.C. OF R/W  
STA 143+02.71  
FD MONBOX  
8/26/71  
FD MONBOX  
SHOT LID  
REFG14  
5/19/21, DSA  
1/5/23, TDN

RECORD TIES  
8/26/71

SHI IN  
G.R. POSTS

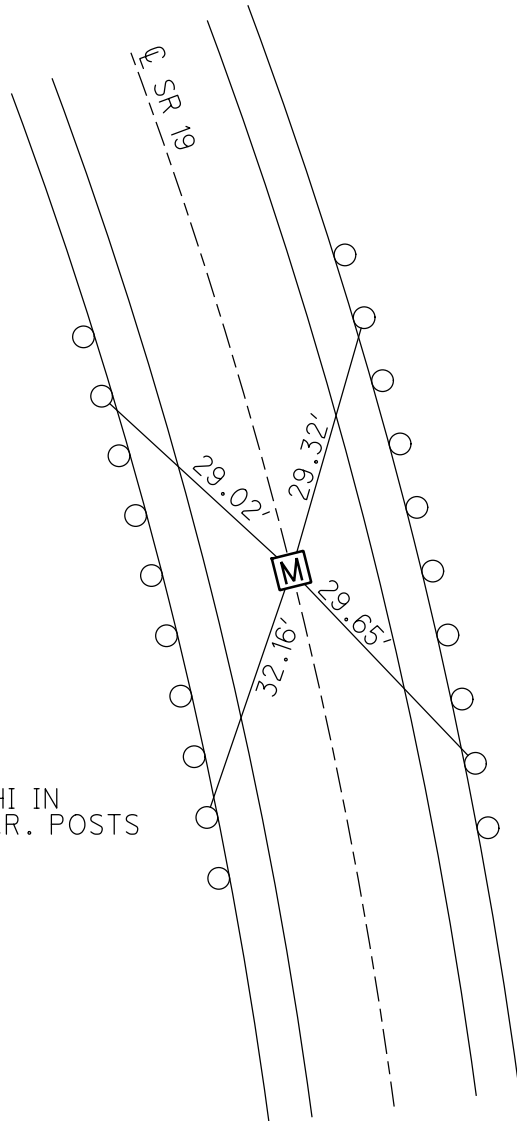

O.D.O.T. DISTRICT 2 SURVEY OFFICE (USE ONLY)

PERSONNEL

REFERENCE NO. 14 G

SHEET 12 OF 22

NOTES AUBLE

DATE 5/19/21

ROUTE SR 19

H.C. O'DONNELL

WEATHER FAIR

COUNTY SANDUSKY

R.C. NIESE

TEMP. 65°

TOWNSHIP SANDUSKY

DWG BY NIESE

PID 94329

SECTION 21

T 5 N R 15 E

TYPE MONUMENT MONBOX

ON SURFACE - ~~BELOW~~ ON

OFFSET Q PAVEMENT ON LT : RT

- TO - EDGE PAVEMENT

STATION: 614+18.88

HORZ.DATUM: NAD83 (2011)

GEOID: 18

GRID: NORTHING: 624856.528

EASTING: 1794154.890

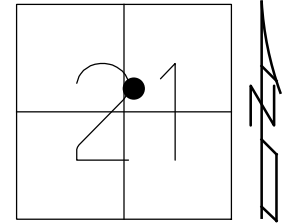

RECORD:  
P.C.C. OF R/W  
STA 143+02.71  
FD MONBOX  
8/26/71  
FD MONBOX  
SHOT LID  
REFG14  
5/19/21, DSA

RECORD TIES  
8/26/71

SHI IN  
G.R. POSTS

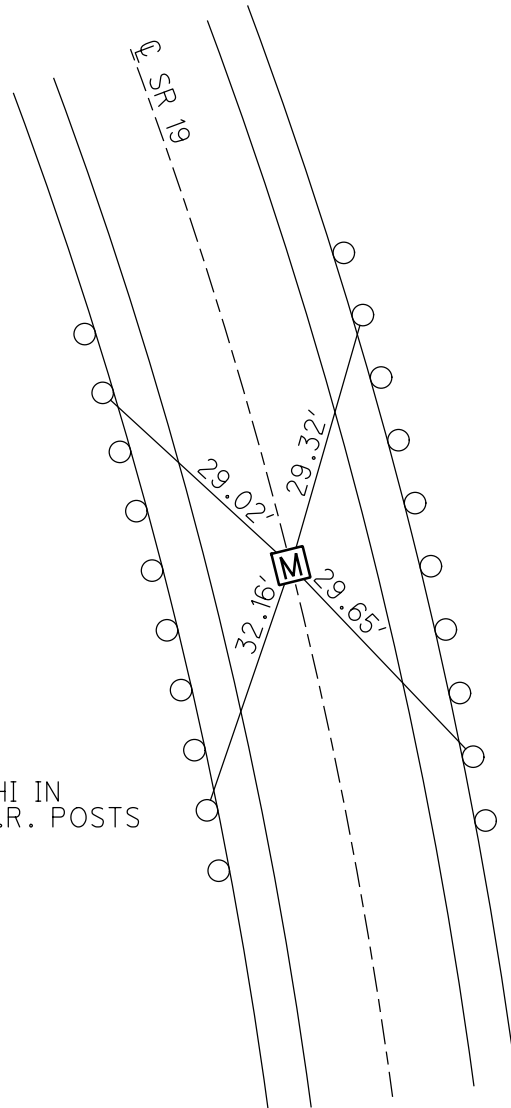

PERSONNEL \_\_\_\_\_ TITLE \_\_\_\_\_ PERSONNEL \_\_\_\_\_ TITLE \_\_\_\_\_  
 COUNTY Sandusky DATE 8-26-71  
 S. R. 19 WEATHER Fair  
 SEC. 21 TEMP. 80°  
 DESCRIPTION U.S. # 20 to Ottawa, Co. Line JOB NO. \_\_\_\_\_

