

O.D.O.T. DISTRICT 2 SURVEY OFFICE (USE ONLY)

PERSONNEL

REFERENCE NO. 14 J

SHEET 15 OF 22

NOTES AUBLE DATE 5/19/21

ROUTE SR 19

H.C. O'DONNELL WEATHER FAIR

COUNTY SANDUSKY

R.C. NIESE TEMP. 65&

TOWNSHIP SANDUSKY

DWG BY NIESE PID 94329

SECTION 21

T 5 N R 15 E

TYPE MONUMENT MONBOX

ON SURFACE - ~~BELOW~~ ON

OFFSET ☉ PAVEMENT ON LT : RT

- TO - EDGE PAVEMENT

STATION: 617+88

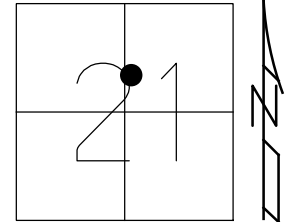

HORZ. DATUM: NAD83 (2011)

GEOID: NAVD88 2018

GRID: NORTHING: 625298.856

EASTING: 1793922.964

RECORD:  
P.C.C. OF R/W  
STA 148+02.71  
FD MONBOX  
8/30/71  
FD MONBOX  
SHOT LID  
REF J14  
5/19/21, DSA  
1/5/23, TDN

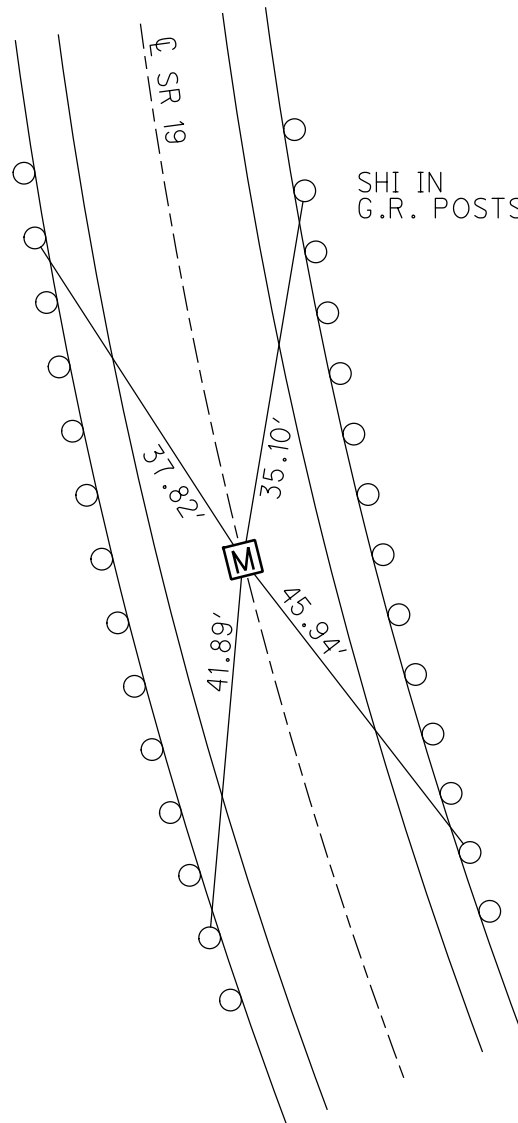

RECORD TIES  
8/26/71

O.D.O.T. DISTRICT 2 SURVEY OFFICE (USE ONLY)

PERSONNEL \_\_\_\_\_ REFERENCE NO. 14 J SHEET 15 OF 22  
 NOTES AUBLE DATE 5/19/21 ROUTE SR 19  
 H.C. O'DONNELL WEATHER FAIR COUNTY SANDUSKY  
 R.C. NIESE TEMP. 65& TOWNSHIP SANDUSKY  
 DWG BY NIESE PID 94329 SECTION 21  
 T 5 N R 15 E

TYPE MONUMENT MONBOX  
 ON SURFACE - ~~BELOW~~ ON  
 OFFSET ☉ PAVEMENT ON LT : RT  
- TO - EDGE PAVEMENT  
 STATION: 617+88

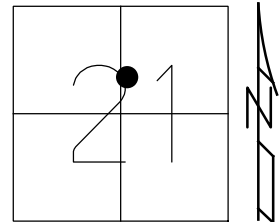

HORZ. DATUM: NAD83 (2011) GEOID: 18  
 GRID: NORTHING: 625298.856 EASTING: 1793922.964

RECORD:  
 P.C.C. OF R/W  
 STA 148+02.71  
 FD MONBOX  
 8/30/71  
 FD MONBOX  
 SHOT LID  
 REF J14  
 5/19/21, DSA

RECORD TIES  
 8/26/71

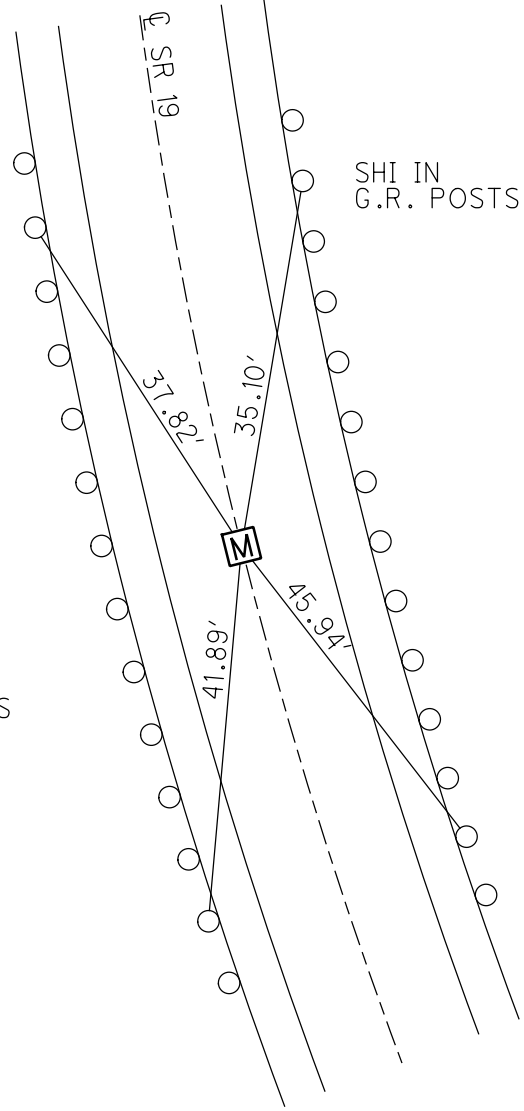

PERSONNEL TITLE PERSONNEL TITLE

COUNTY Sandusky DATE 8-30-71

S. R. 19 WEATHER Hot

SEC. 21 TEMP. 85°

DESCRIPTION U.S. #20 to Ottawa, Co. Line LEFT CENTER LINE RIGHT JOB NO.

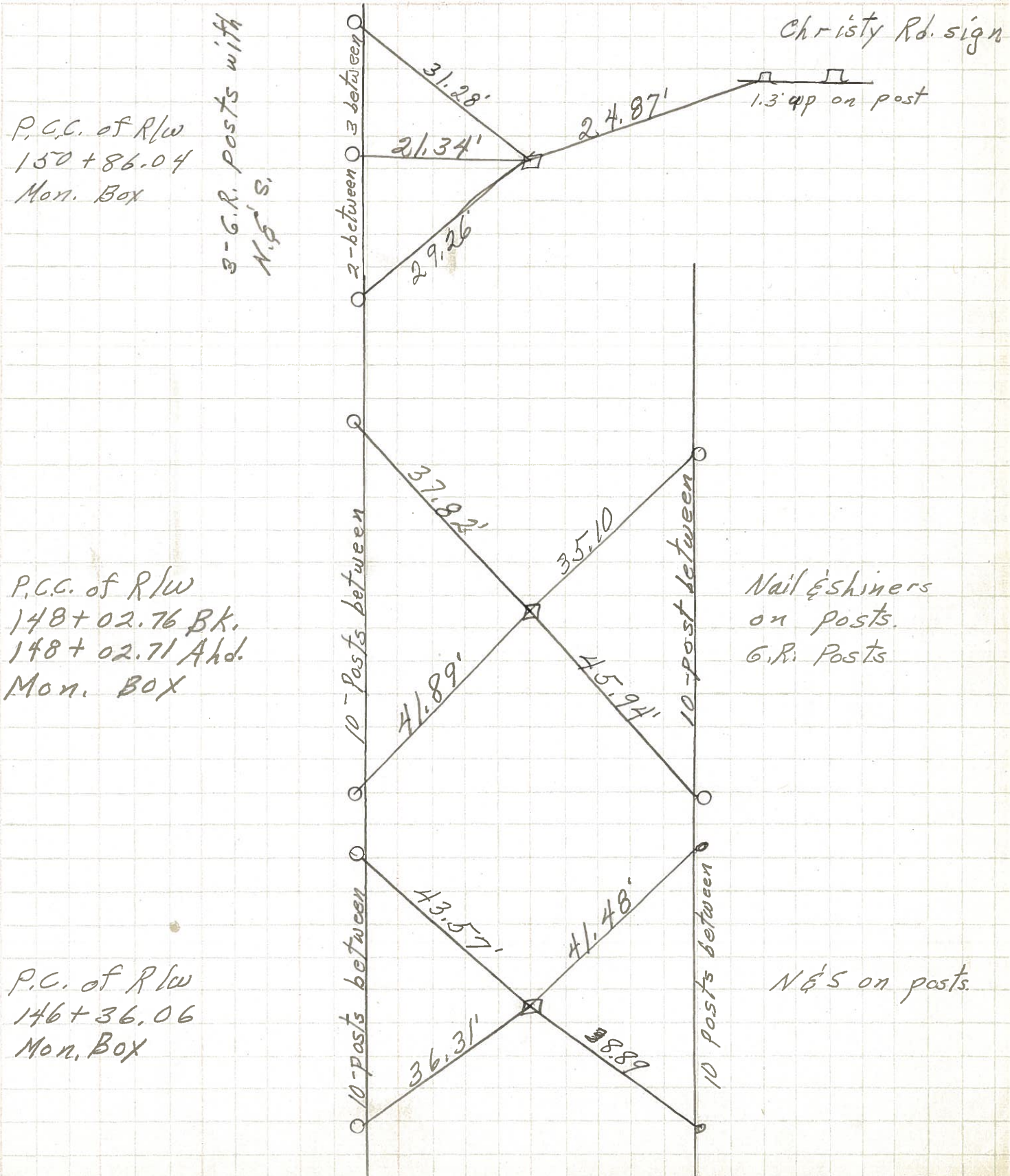

P.C.C. of R/W  
150+86.04  
Mon. Box

3-G.R. posts with  
N.G.'s.

Christy Rd. sign

1.3' up on post

P.C.C. of R/W  
148+02.76 BK.  
148+02.71 Ahd.  
Mon. BOX

Nail & shiners  
on posts.  
G.R. Posts

P.C. of R/W  
146+36.06  
Mon. Box

N.G.'s on posts.