

#5035

FOR ANY QUESTIONS PLEASE CONTACT ODOT DISTRICT 2 REAL ESTATE AT 419-353-8131

FED. RD. DIVISION	STATE	PROJECT	FISCAL YEAR
2	OHIO		1949

1
3

STATE OF OHIO
DEPARTMENT OF HIGHWAYS

SANDUSKY COUNTY
SAN-20-(3.39-3.70)

397

SAN-20-(3.39-3.70)

SANDUSKY COUNTY

VILLAGE OF WOODVILLE & WOODVILLE TOWNSHIP

CONVENTIONAL
COUNTY LINE
TOWNSHIP LINE
SECTION LINE
CORPORATION LINE
FENCE LINE
CENTER LINE
POLE LINE
RAILROAD
GUARD RAIL

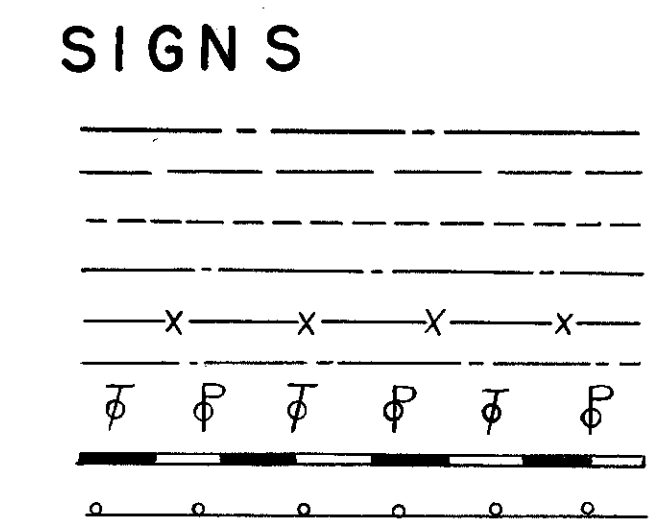

BEGIN PROJECT
STA. 179+07.48

END PROJECT
STA. 360+27

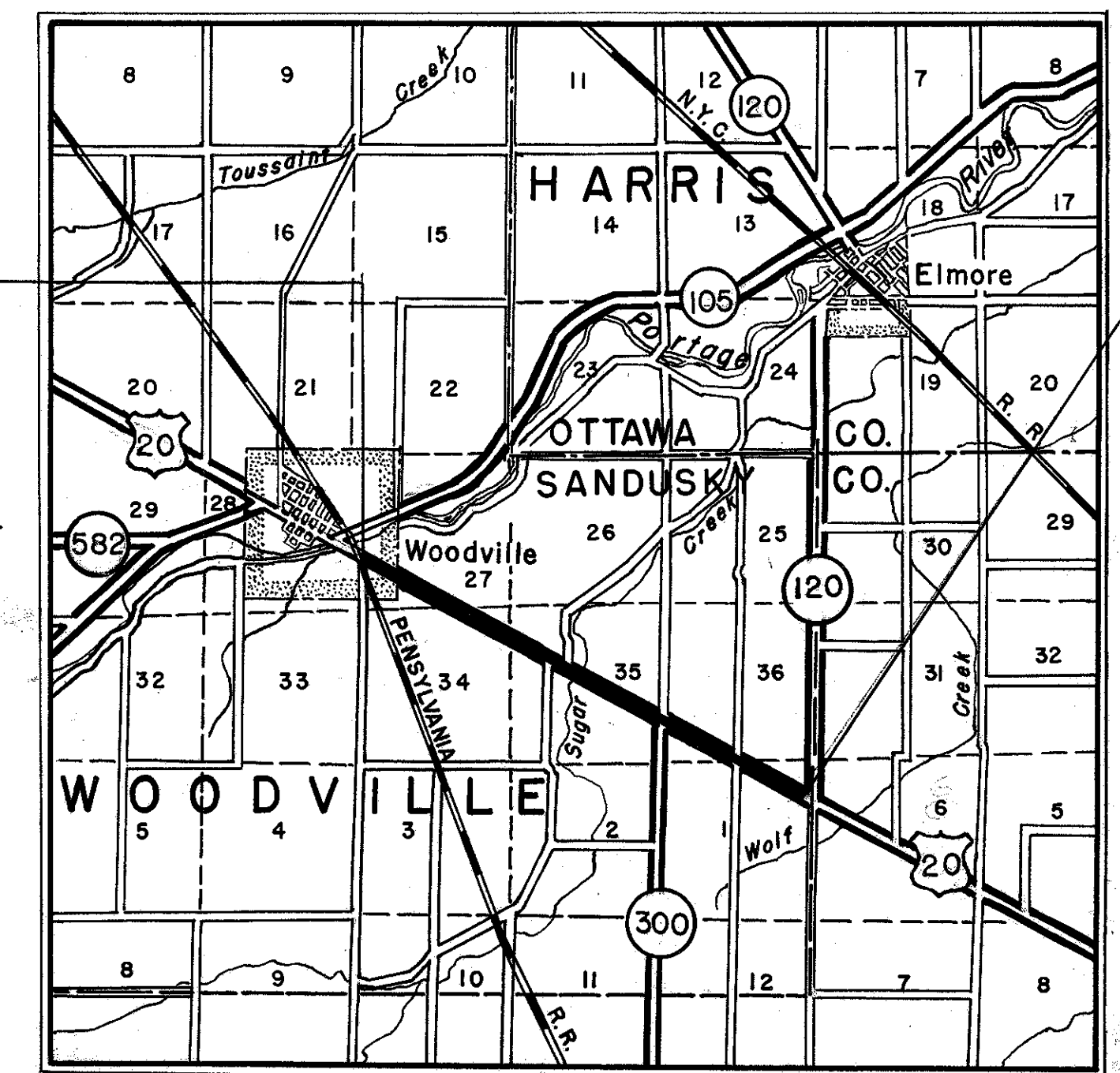

DELIVERY POINT, WOODVILLE AVERAGE HAUL=2 MI.

The Standard Specifications of the State of Ohio, Department of Highways, including changes and Supplemental Specifications listed in the proposal Shall Govern this Project.

The right of way necessary for this improvement will be provided by the State of Ohio.

I hereby approve these plans and declare that the making of this improvement will not require the closing to traffic of the Highway, and that provisions for the maintenance and safety of traffic will be as set forth on the plans and estimates.

INDEX OF SHEETS

TITLE SHEET	1
TYPICAL SECTION	2
GENERAL NOTES	2
PAVING COMPUTATIONS	2
GENERAL SUMMARY	2
PLAN & PROFILE	3

- Approved George W. Fisher
Date: 4-7-49 Division Deputy Director
- Approved _____
Date: _____ Chief Engineer, Bureau of Maintenance
- Approved Richard O. ...
Date: 4-26-49 Chief Engineer, Bureau of Bridges & R.R. Crossings
- Approved Joseph M. ...
Date: 4-27-49 Chief Engineer, Bureau of Location & Design
- Approved ... Solizell
Date: 4-28-49 First Asst. Director & Chief Engineer
- Approved ... Miller
Date: 4-28-49 Director of Highways

LINE DATA

BEGINNING OF PROJECT AND MUNICIPAL SECTION = STA. 179+07.48
 END OF MUNICIPAL SECTION = STA. 194+76.20
 GROSS LENGTH OF MUNICIPAL SECTION = NET LENGTH OF MUNICIPAL SECTION = 1568.72 LIN. FT. = 0.297 Mi.
 BEGINNING OF RURAL SECTION = STA. 194+76.20
 END OF RURAL SECTION AND OF PROJECT = STA. 360+27
 GROSS LENGTH OF RURAL SECTION = NET LENGTH OF RURAL SECTION = 16550.80 LIN. FT. = 3.134 Mi.
 GROSS LENGTH OF PROJECT = NET LENGTH OF PROJECT = 18119.52 LIN. FT. = 3.431 Mi.

LOCATION PLAN

Scale 1"=1 Mile
 PORTION TO BE IMPROVED
 STATE HIGHWAYS
 OTHER ROADS
 DETOURS

CONSTRUCTION BUREAU
JUL 1 1955
GROUND PHOTOLAB

SCALES

PLAN 1"=50'
 PROFILE HORIZONTAL 1"=50'
 PROFILE VERTICAL 1"=5'
 CROSS SECTIONS NONE

SUPPLEMENTAL SPECIFICATIONS		STANDARD	DRAWINGS
T-171.19	Rev. 6-17-48	I-12	3-15-48
		I-1,2,3,4,5	2-20-45
		I-8 CB No. 16	3-1-47

397

FILE NO.	SANDUSKY COUNTY SAN-20-(3.39-3.70)
DATE OF LETTING	_____
CONTRACT NO.	_____

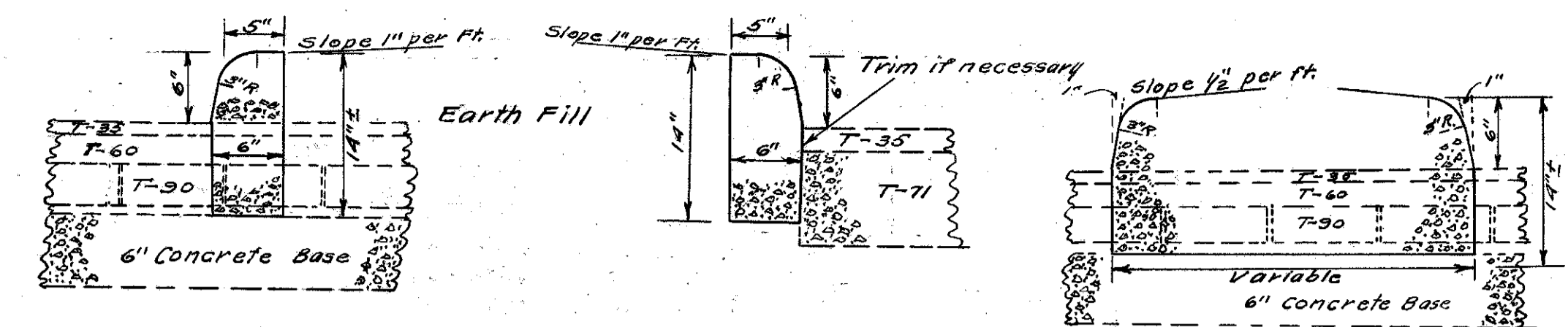
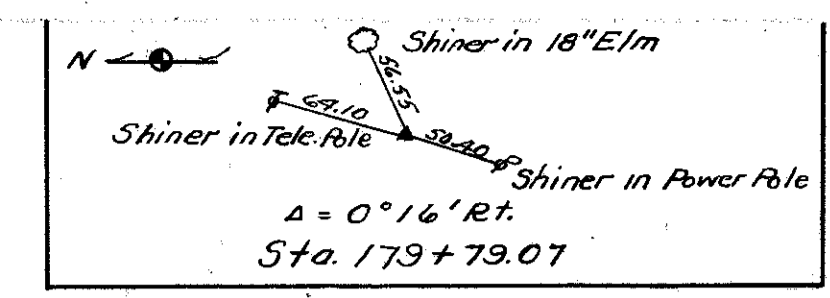

Note: The price bid for the Type 6 Concrete Curb (mod) shall include filling with concrete the space between the curb and edge of brick also to trim if necessary the edge of T-35 and B-35 so that the curb will fit against the edge of existing Concrete Pavt. Resurface Gutter area at bid Price for T-35 and B-35

Begin Project
Sta. 179 + 07.48

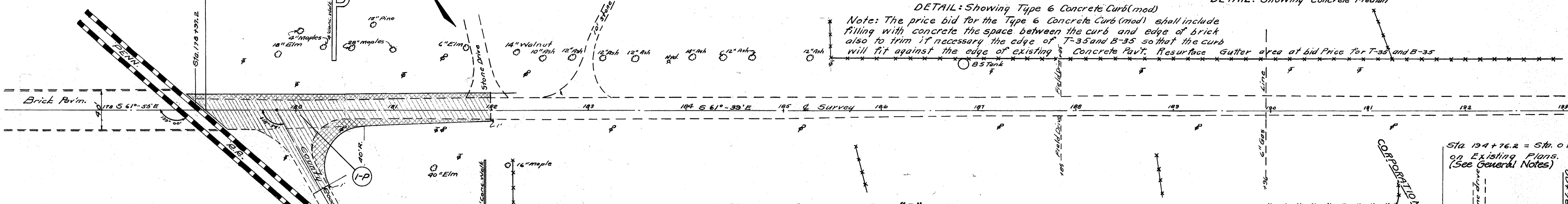

EXTRA PAVEMENT "P"

Ref. No.	E-1 Roadway Excavation Cu. Yds.	B-20 10" Waterbound Macadam Sq. Yds.	T-35 1 1/4" 1/2" Min. Sq. Yds.	T-35 1 1/2" Min. Sq. Yds.	B-35 1 1/4" Leveling Sq. Yds.	B-35 1 1/2" Min. Leveling Sq. Yds.	B-35 3" Leveling Sq. Yds.	E-8 Sealing (only) Lin. Ft.	I-1R Type 6 Curb (mod) Lin. Ft.	I-8 No. 16 C.B. Each	I-3 10" Pipe Roadway Drainage Lin. Ft.	I-21 Con. Median Sq. Yds.	E-8, Rem. of Ex. Surf. Sq. Yds.
1-P	120	360	1340		1840	990	348						
2-P				243				567	510	1	1R	3	97
3-P	70	224		1236				218	567	1	1R	3	97
Totals	70	224	1470					218	567	1	1R	3	97

* 2-P is for Concrete Bridge across Sugar Creek, 70' Span, 30' Roadway.
1-P is Municipal, 2-P & 3-P is Rural.

New Pavement and Resurfacing.
 Existing Pavement to be Resurfaced.

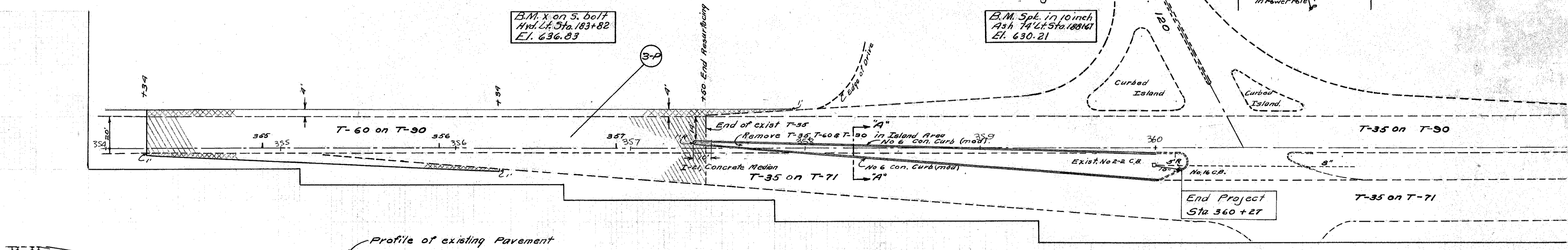
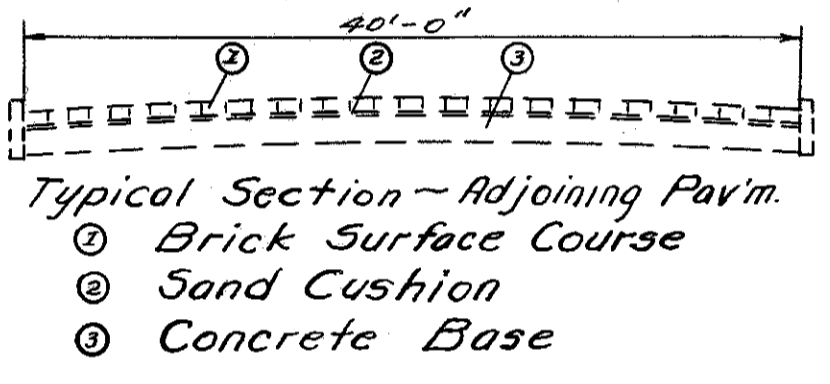

Note: Raise grade at Railroad and side Road approach as directed by Engineer. For extra quantity of B-35, see pavement computations, This B-35 to be laid before adjacent widening is placed.

637.59	637.62	636.02	636.16	636.64	636.75	636.83	636.96	636.94	636.98	636.95	636.94	636.91	637.05	636.88	636.85	636.94
													636.84	636.67	636.45 Corp Line	
													193	194	+76.20	

4-A-57
05-20-1943