

25' EASEMENT
STATE OF OHIO
VOL. 1192,
P. 306
**(1-LA) 0.0891 Acre
OR 265 Page
1422-1427**

32-60-00-0201-00
HD EXPRESS MART, INC
D.V. 223, P. 2908

GRAPHIC SCALE

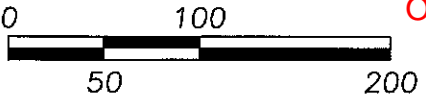

(IN FEET)
SCALE: 1" = 100'

**Access Grant
OR 265 Page
1428-1433**

BASIS OF BEARINGS:
BASIS OF BEARING IS THE CENTERLINE OF RIGHT-OF-WAY
OF U.S. ROUTE 20 BEING NORTH 68°20'09" WEST,
DERIVED FROM VRS OBSERVATIONS, OHIO STATE PLANE
COORDINATE SYSTEM NORTH ZONE (3401), NAD 83 (2011
ADJUSTED).

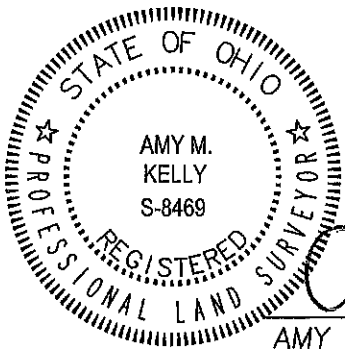

Amy M. Kelly 1/21/2022
AMY M. KELLY, F.S.
OHIO SURVEYOR NO. 8469

**EXHIBIT OF A LIMITED ACCESS
RIGHT-OF-WAY OPENING ALONG U.S. 20
CITY OF CLYDE, COUNTY OF SANDUSKY, STATE OF OHIO**

BRAMHALL
ENGINEERING AND SURVEYING COMPANY
801 MOORE ROAD AVON, OHIO 44011
(440) 934 - 7878 (440) 934 - 7879 FAX

L-1
L=25.00'
S 21°39'51" W

L-2
L=15.64'
N 68°20'09" W

MAGNETIC
NAIL FOUND
& USED

M.N.F.