

O.D.O.T. DISTRICT 2 SURVEY OFFICE (USE ONLY)

PERSONNEL

REFERENCE NO. 31

SHEET 2 OF 6

NOTES SCHNEIDER  
 H.C. MOSSER  
 R.C. BARBOUR  
GEYMAN

DATE 8/21/73  
 WEATHER COOL  
 TEMP. 72°

ROUTE US 20  
 COUNTY SANDUSKY  
 TOWNSHIP SANDUSKY  
 SECTION 29  
 T 5 N R 15 E

DWG BY NIESE PID \_\_\_\_\_

TYPE MONUMENT "X" CUT IN CONC. TROUGH

ON SURFACE - ~~BELOW~~ ON \_\_\_\_\_

OFFSET  $\varnothing$  PAVEMENT \_\_\_\_\_ LT : RT

- TO - EDGE PAVEMENT

STATION: 783+08.18

HORIZ.DATUM: \_\_\_\_\_

GEOID: \_\_\_\_\_

GRID: NORTHING: \_\_\_\_\_

EASTING: \_\_\_\_\_

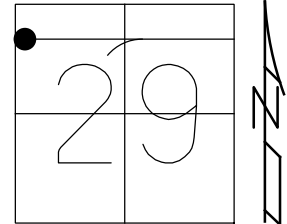

RECORD: P.I.  
 STA 783+08.18  
 BY-PASS  
 FD "X" IN CONC TROUGH  
 1/1968, SCHNEIDER  
 8/21/73, SCHNEIDER

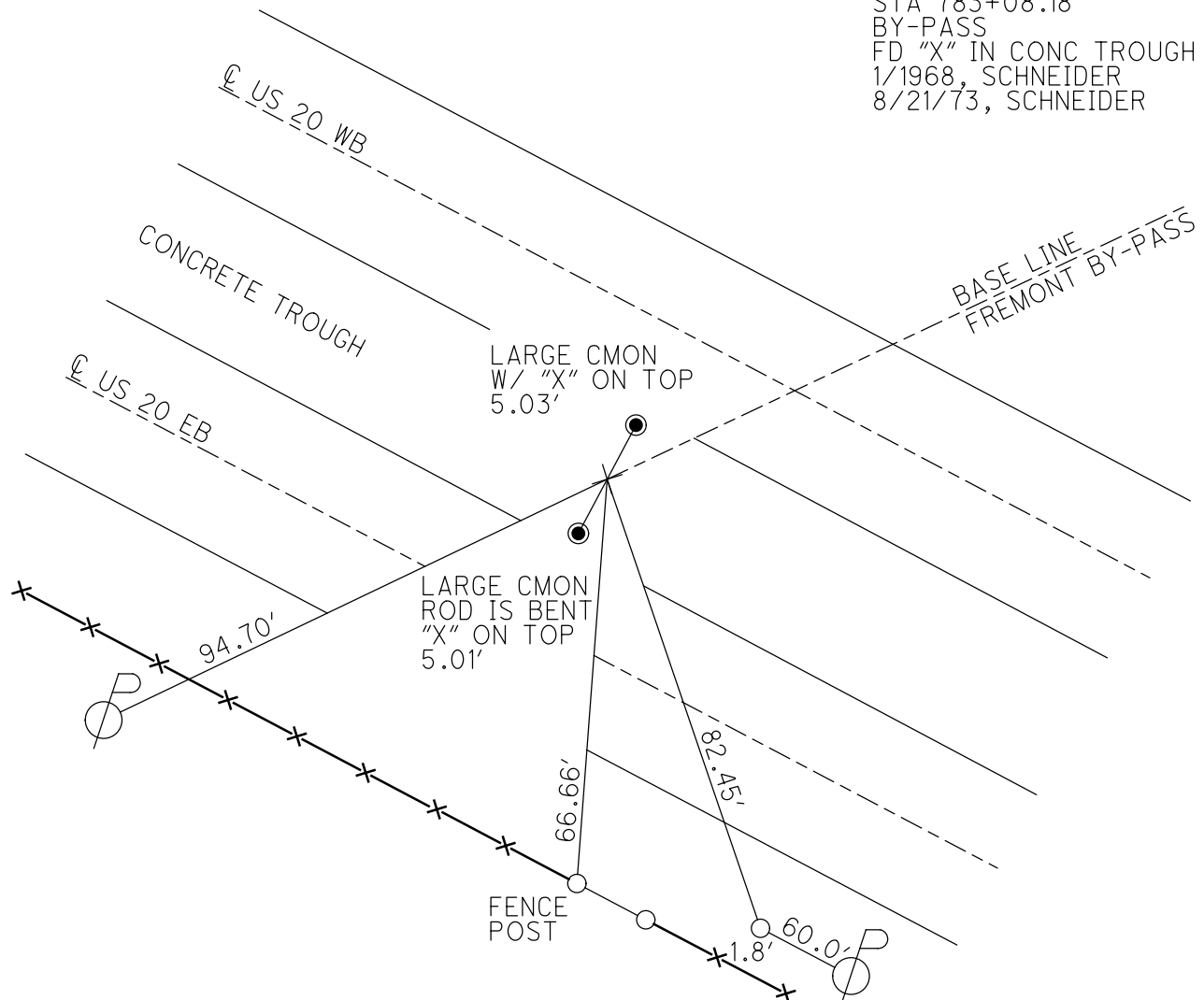

O.D.O.T. DISTRICT 2 SURVEY OFFICE (USE ONLY)

PERSONNEL \_\_\_\_\_ REFERENCE NO. 31 SHEET 3 OF 10  
 NOTES NIESE DATE 5/5/22 ROUTE US 20  
 H.C. NIESE WEATHER SUNNY COUNTY SANDUSKY  
 R.C. AUBLE TEMP. 50° TOWNSHIP SANDUSKY  
 DWG BY ASTON PID 111020 SECTION 29  
 T 5 N R 15 E

TYPE MONUMENT D.N.F.  
 ON SURFACE - BELOW \_\_\_\_\_  
 OFFSET  $\text{C}$  PAVEMENT \_\_\_\_\_ LT : RT  
 \_\_\_\_\_ TO \_\_\_\_\_ EDGE PAVEMENT  
 STATION: 783+10.76

HORZ.DATUM: NAD83 2011 GEOID: NAVD88 2018  
 GRID: NORTHING: 620923.074 EASTING: 1785825.599

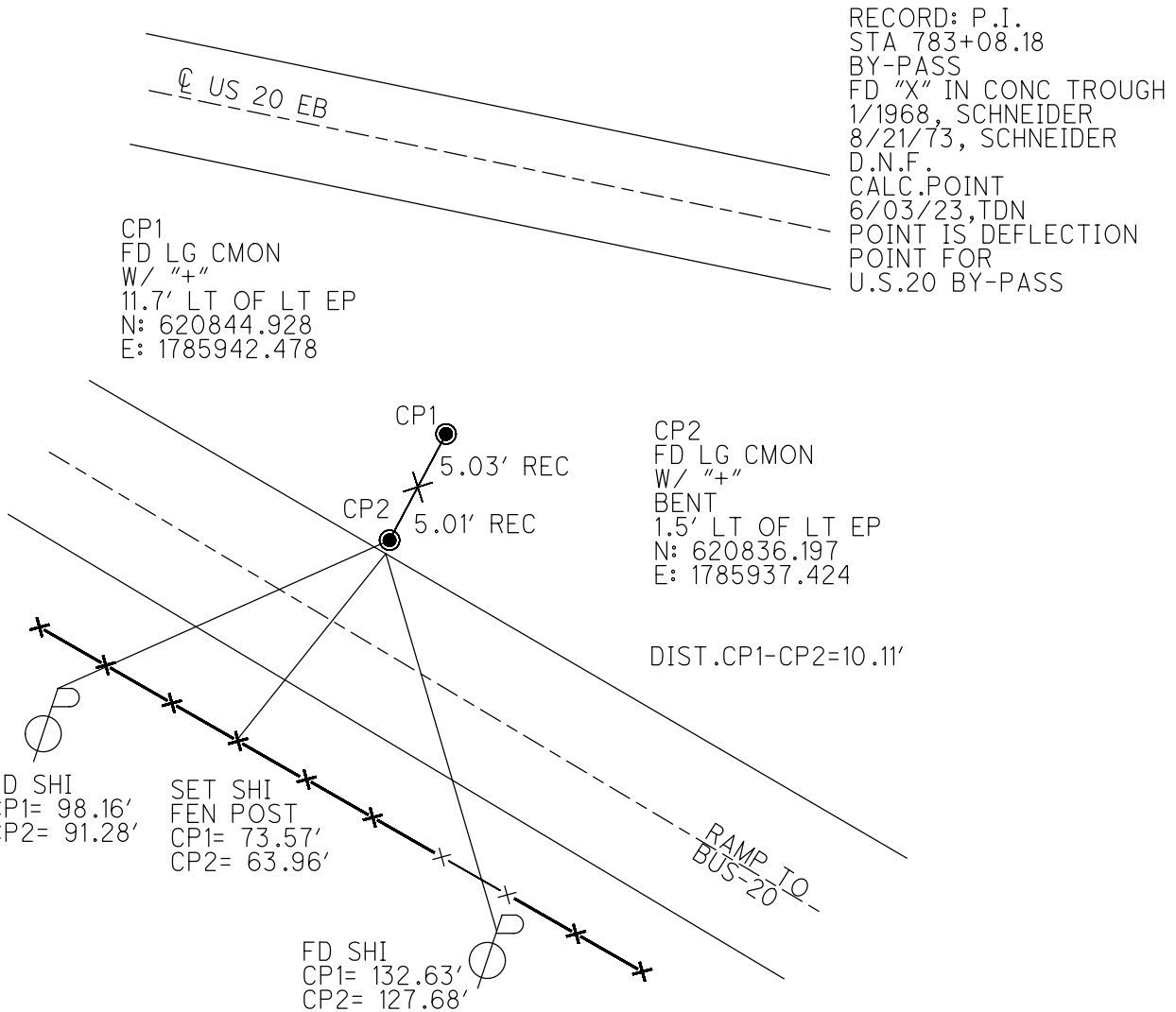
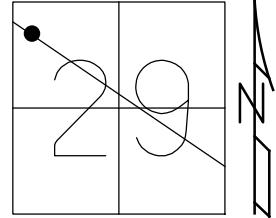

PERSONNEL TITLE PERSONNEL TITLE

Schneider  
Mossler  
Barbour  
Geyman

COUNTY Sandusky  
S. R. 20  
SEC. 29

DATE 8-21-73  
WEATHER cool  
TEMP. 72°

DESCRIPTION Sandusky Twp.

LEFT CENTER LINE RIGHT

JOB NO.

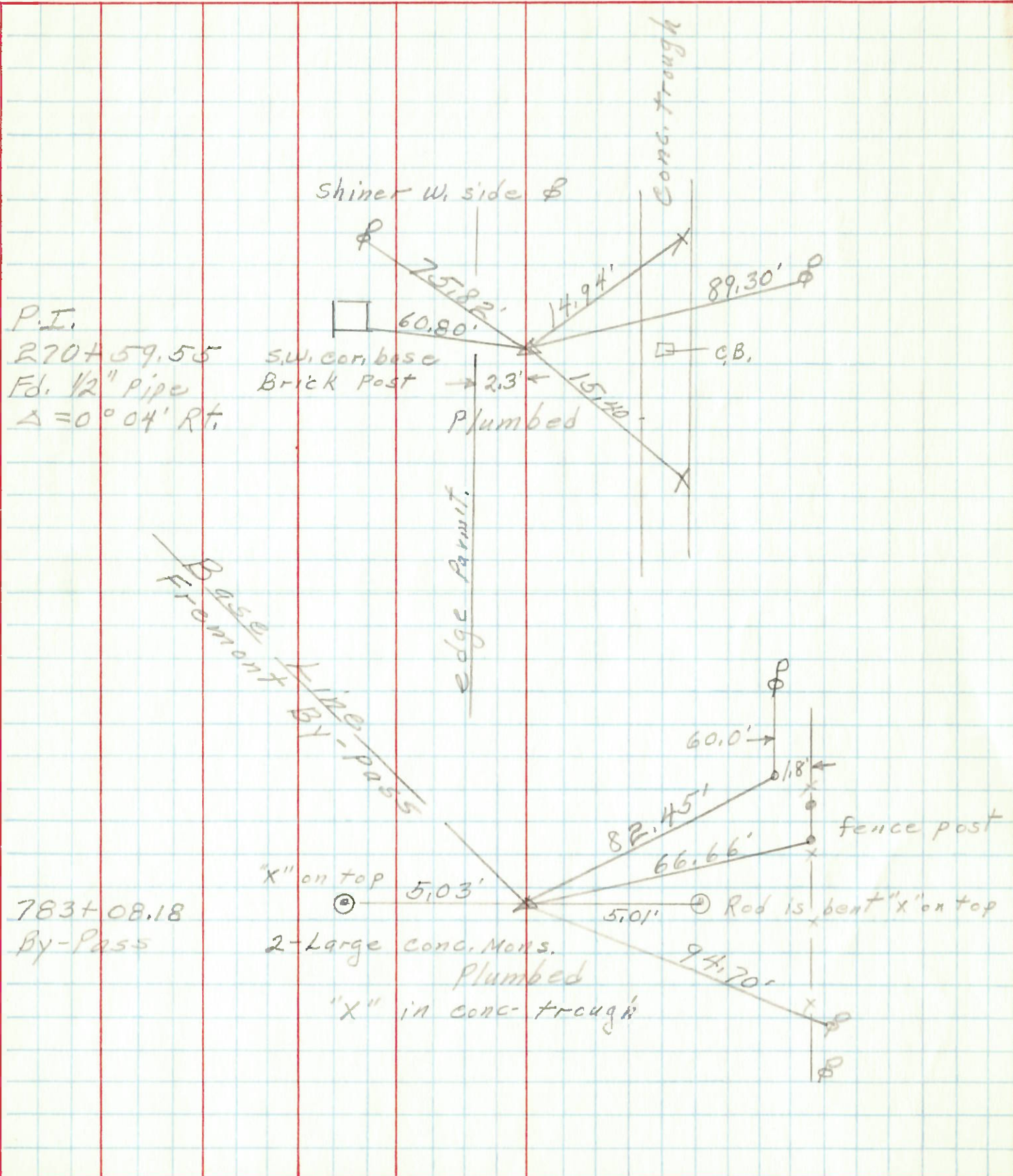

PERSONNEL TITLE PERSONNEL TITLE

COUNTY Sandusky

DATE

S. R. 20

WEATHER

SEC. 35 - Woodville Twp.

TEMP.

DESCRIPTION

LEFT

CENTER LINE

RIGHT

JOB NO.

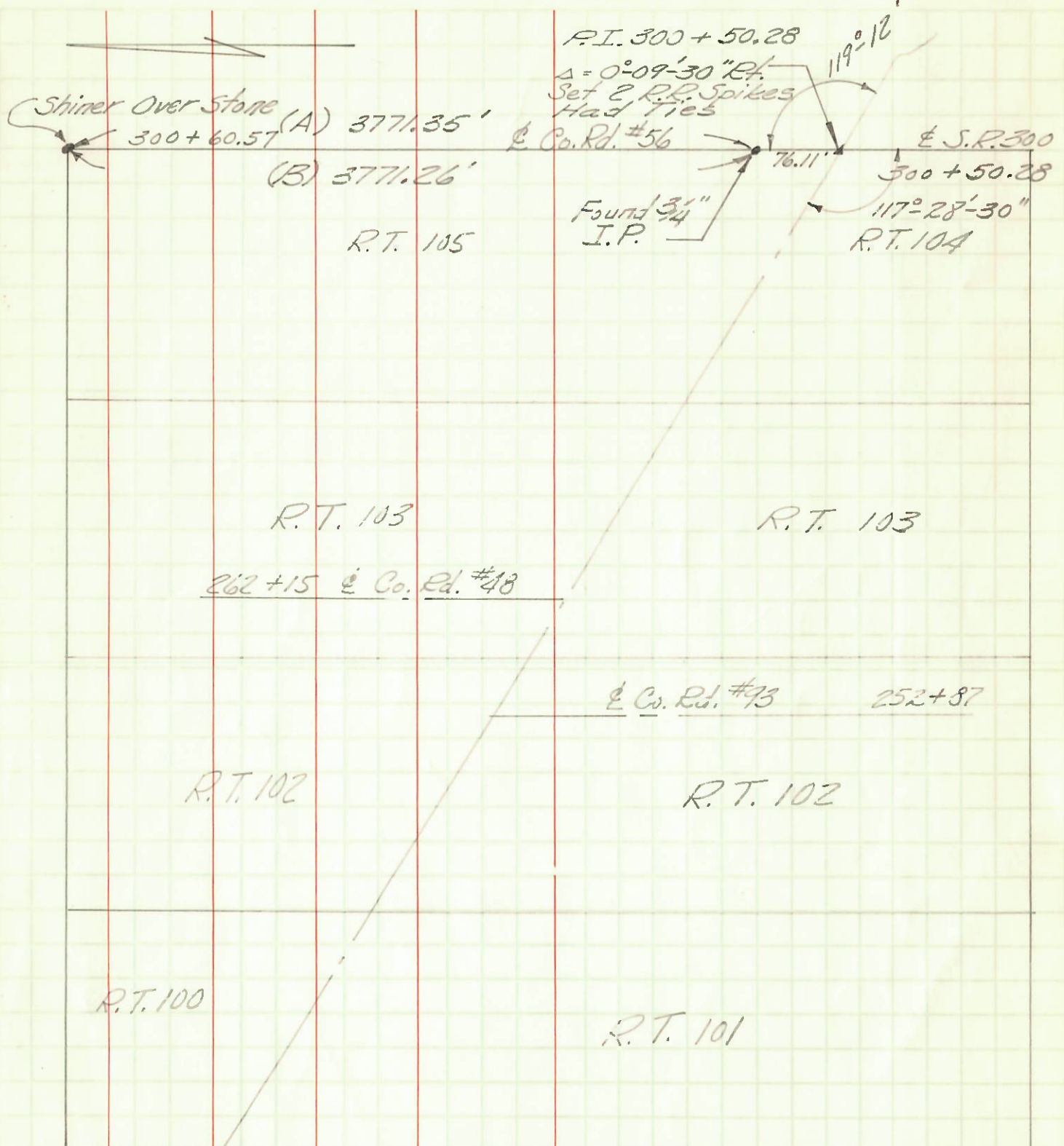

Note: (A) Survey Made By County (1959).  
 (B) " " " State Hwy (11/28/62)



PERSONNEL	TITLE	PERSONNEL	TITLE	COUNTY	DATE
<u>Schneider</u>		<u>Patt</u>		<u>Sandusky</u>	<u>Jan 1968</u>
<u>Mosser</u>				S. R. <u>U.S. #20</u>	WEATHER
<u>Barbour</u>				SEC. <u>Fremont Bypass</u>	TEMP.
<u>Redding</u>					

DESCRIPTION Ties for Control Point LEFT CENTER LINE RIGHT JOB NO.

Relocation S.R. #19

7129

860+74.62 & survey U.S. #20 By-pass  
& S.R. #19 North & South

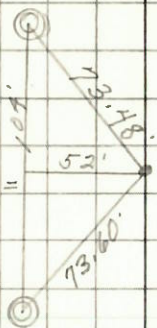

Two large conc. Man with  
1" iron rod in center

7128

& U.S. #20

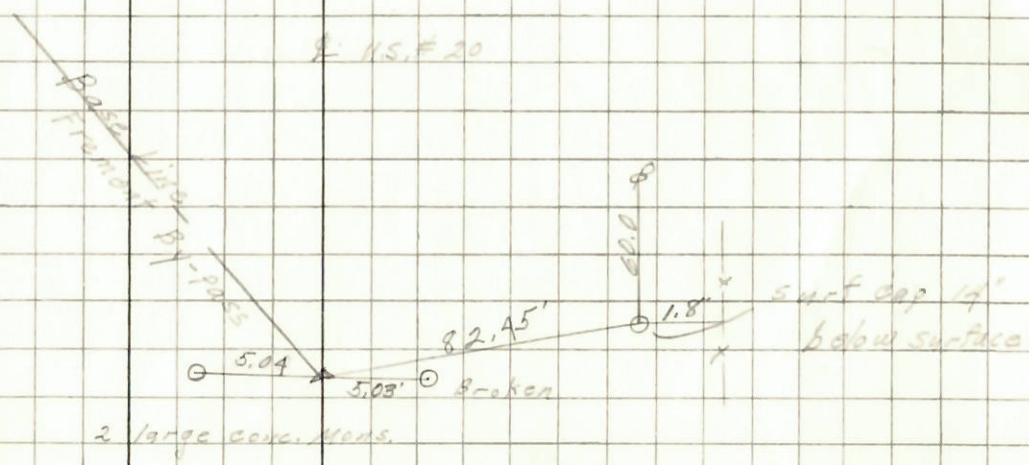

P.I.  
783+05.18  
"X" in conc. trough

7127