

CURVE DATA				
Curve No	Δ	D	R	L
1	2°51'54"		2700.0	67.52' 135.01'
2	37°58'52"		300.0	103.25' 198.87'
3	35°44'32"		500.0	161.21' 311.91'
4	3°26'17"		1916.7	57.53' 115.02'
5	6°26'00"		1336.6	75.12' 150.0'
6	72°31'48"		241.5	177.17' 305.71'
7	4°40'00"		1658.0	67.54' 135.0'
8	4°06'22"		1605.0	57.53' 115.02'
9	140°23'08.5"		250.0	694.13' 612.55'
10	69°38'32"		225.0	156.80' 282.34'

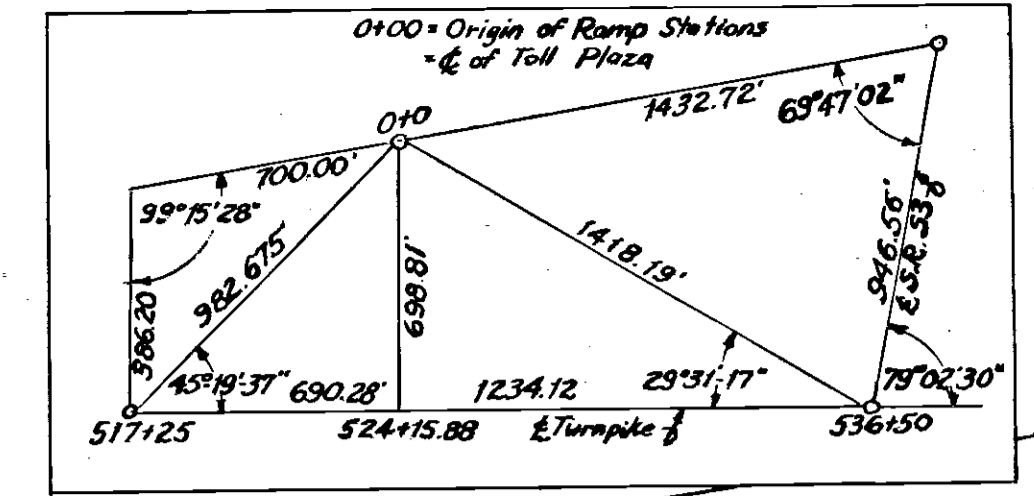

- 12+78 Ramp "A"
Pipe Culvert
11'-18" R.C.C.P. M.G.G.(6)
2 Type "B" Headwalls
- 4+00 Ramp "C"
Type B Inlet
33'-15" R.C.C.P. M.G.G.(6)
Type "A" Headwall
- 5+00 Ramp "C"
Type B Inlet
45'-15" R.C.C.P. M.G.G.(6)
Type "A" Headwall
- 6+00 Ramp "C"
2 Type B Inlets
42'-15" R.C.C.P. M.G.G.(6)
Type "A" Headwall
- 7+00 Ramp "C"
2 Type B Inlets
48'-15" R.C.C.P. M.G.G.(6)
Type "A" Headwall
- 8+75 Ramp "C"
Pipe Culvert
12'-18" R.C.C.P. M.G.G.(6)
2 Type "A" Headwalls
- 5+50 Ramp "D"
Type B Inlet
28'-15" R.C.C.P. M.G.G.(6)
Type "A" Headwall
- 7+00 Ramp "D"
Type B Inlet
Outlet Directly
Into 34" R.C.C.P.
- 7+00 Ramp "D"
Pipe Culvert
72'-24" R.C.C.P. M.G.G.(6)
2 Type "A" Headwalls
- 8+50 Ramp "D"
Type B Inlet
21'-15" R.C.C.P. M.G.G.(6)
Type "A" Headwall
- 9+00 Ramp "C"
2 Type B Inlets
62'-60" 15" R.C.C.P. M.G.G.(6)
2 Pipe Spcs. 26"-15" R.C.C.P. Bends (6)
Type "A" Headwall
- 15+75 Ramp "A"
Type B Inlet
30'-15" R.C.C.P. M.G.G.(6)
Type "A" Headwall
- 10+00 Ramp "D"
Type B Inlet
30'-15" R.C.C.P. M.G.G.(6)
Type "A" Headwall

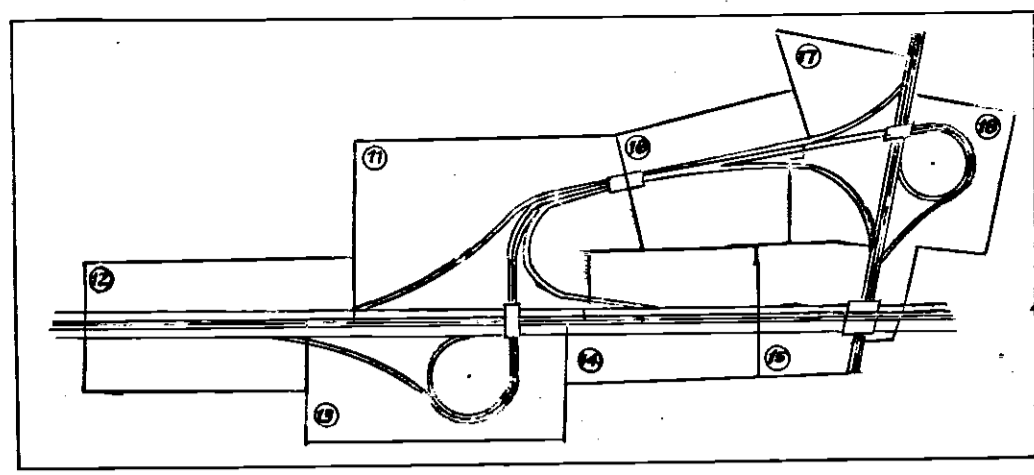
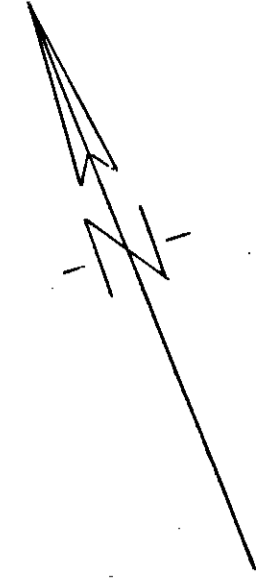
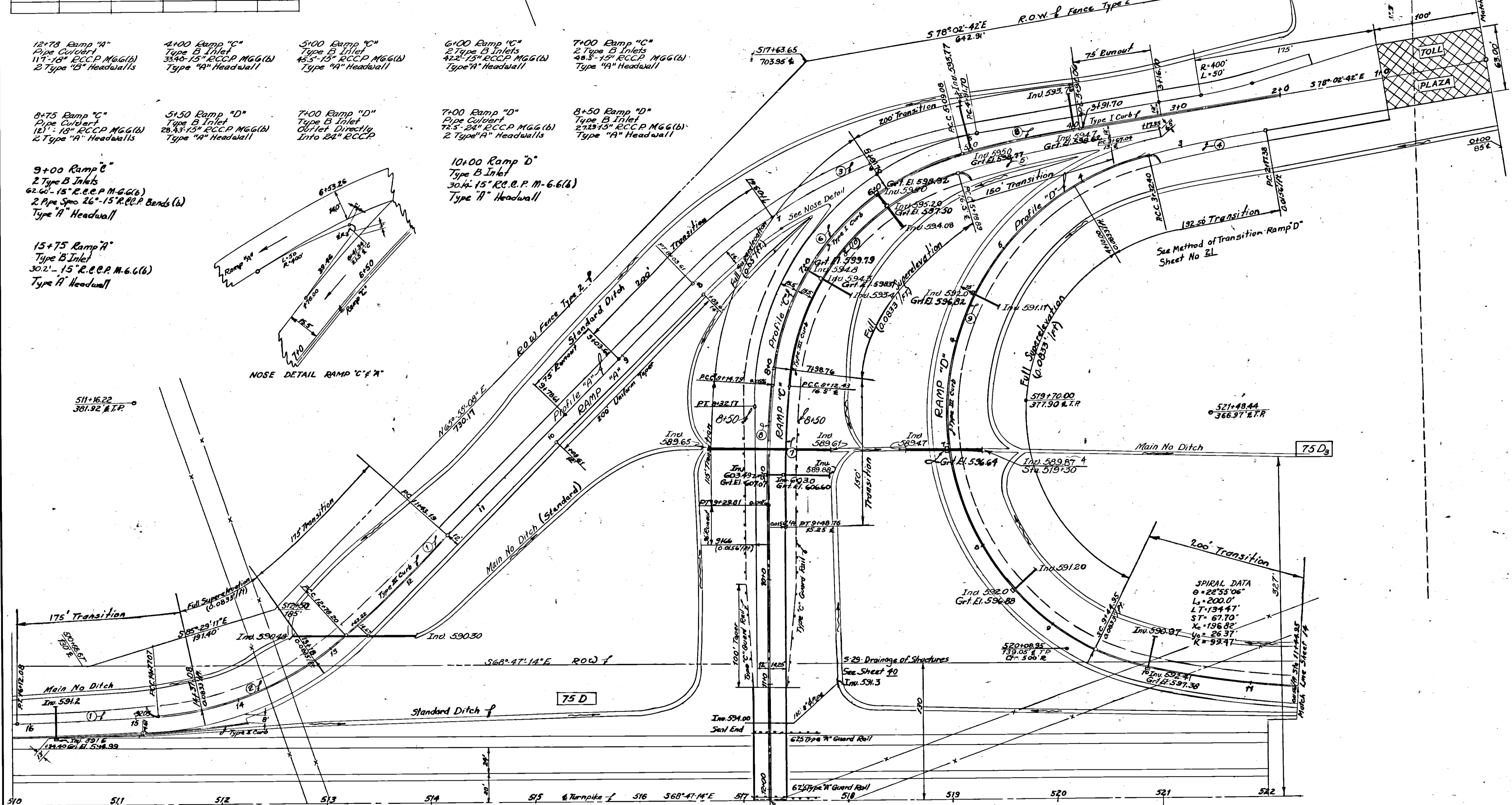
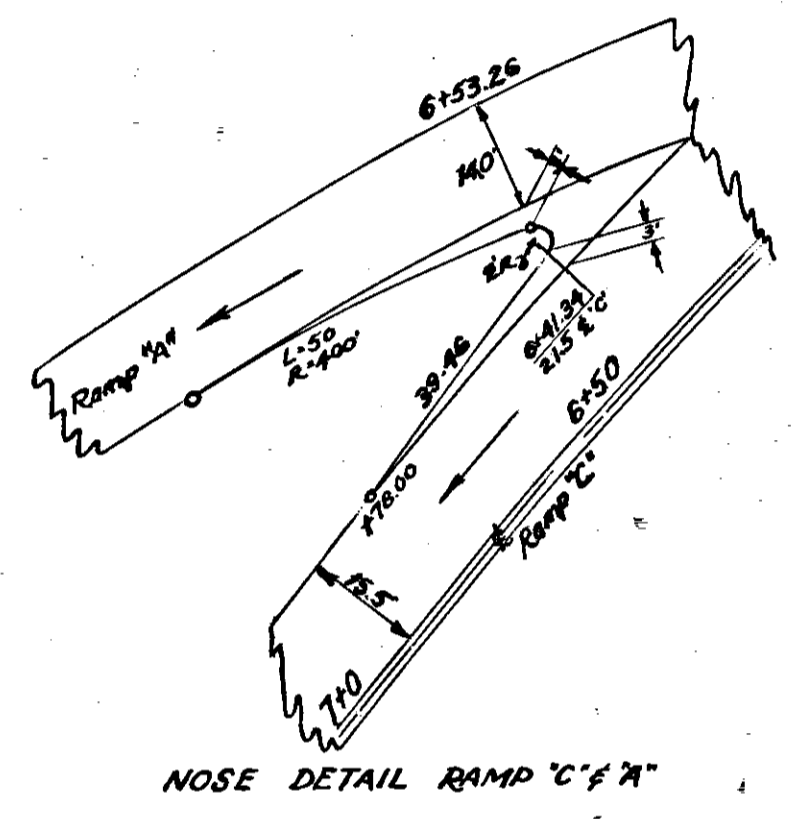

STRUCTURE No. 3
SEE SHEETS No. 40-42

QUANTITIES					
NO.	ITEM	LOCATION & REMARKS	UNITS	ESTIMATED QUANTITY	FINAL QUANTITY
5-1	Earth Excav.		C.Y.	9,502	12,658
1-15	Guard Rail	Type C	L.F.	510	525
1-15	Guard Rail	Type A	L.F.	134	125
1-23	R.O.W. Fence	Type 2	L.F.	174	1614
L-3	Placing Stockpiled Topsoil		S.Y.	9,829	10,829
L-9	Seed & Protect	Type A	S.Y.	9,829	10,829
L-19	Special Seed		S.Y.	55,530	53,203
E-2	Excav. for Street		C.Y.	216	282
S-27	18" R.C.C.P.	M.G.G.(6)	L.F.	237	239.00
S-27	24" R.C.C.P.	M.G.G.(6)	L.F.	74	72.50
I-8	Inlets-Type B		Ea.	13	13
I-2	15" R.C.C.P.	M.G.G.(6)	L.F.	344	348.24
S-4	Conc. for Street	Class "C"	C.Y.	12	20.70
S-4	Conc. for Street	Class "C"	Lbs.	654	12.08
I-12	Type I Curb		L.F.	903	905.50
I-12	Type II Curb		L.F.	225	221.79
I-12	Type III Curb		L.F.	1,764	1,746.96
I-22	Selected Subbase		C.Y.	6,219	6,230
I-33	Bit Mac Surf Coat		S.Y.	5,367	5,272
T-1	8" Bit Mac Surf Coat	10" Thick	S.Y.	3,388	3,528
I-5	Pipe Spcs. 26"-15" R.C.C.P. Bends		Ea.	2	2
E-4	Borrow		C.Y.	34,358	34,532

OHIO TURNPIKE COMMISSION
OHIO TURNPIKE PROJECT NO. 1

INTERCHANGE PLAN
RAMPS "A", "C", & "D"
510+0 TO 522+0

PORTER-URQUHART ASSOCIATED
CONTRACTING ENGINEER
DESIGN SECTION D-14

DESIGNED: D.L.M. CHECKED: M.A.L.Jr. DATE: 2-19-53
DRAWN: J.R.B. IN CHARGE: F.D. SCALE: 1"=50'

CONTRACT NO. C-39 SHEET 11 OF 64

CURVE DATA				
Curve No.	Δ	D	R	L
10	2° 30'	1° 00'	5729.58'	125.02'
				250.00'

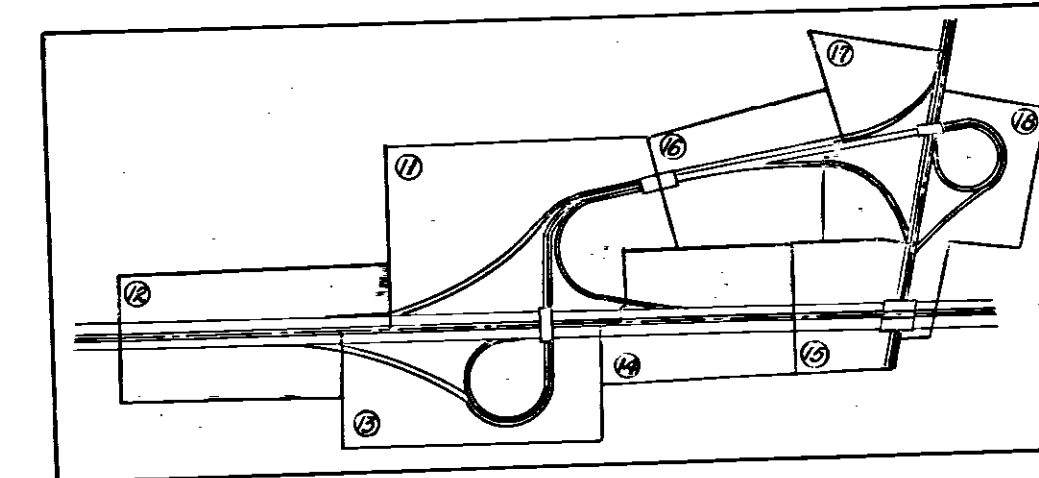

QUANTITIES					
NO.	ITEM	LOCATION & REMARKS	UNIT	ESTIMATED QUANTITY	FINAL QUANTITY
E-1	Bitly Excoo.	Type 2	C.Y.	19166	10679
1-23	R/W Fence		LF	2610	2552
L-3	Place Stocked Topsoil		SY	7922	8560
L-9	Seeding & Protect	Type A	SY	7922	8560
L-19	Special Seeding	Type A	SY	17318	9322
T-4	Pipe Underdrains	Type A	LF	265	265
S-1	Conc for Streets	Class "C"	C.Y.	24	228
S-4	Reinforcing Steel		C.Y.	204	140
E-2	Excav. For Str.		LF	86	7
T-2	15" RCCP	Sec. M.G.G.(B)	LF	4619	4620
T-22	Selected Sub Base		LF	365	36571
T-12	Conc Curb, Type II		SY	6010	5988
T-33	Bit. Mac. Surf. Treat.		SY	3437	3529
T-71	Rund. Conc. Plan 1'	10" Thick	LF	50	887
T-30	12" E.Q.D.T.		LF	115	13
T-30	15" E.Q.D.T.		LF	20	20
T-30	15" Pipe Outlet		LF	20	20
E-4	Borrow		C.Y.	-6970	1,469

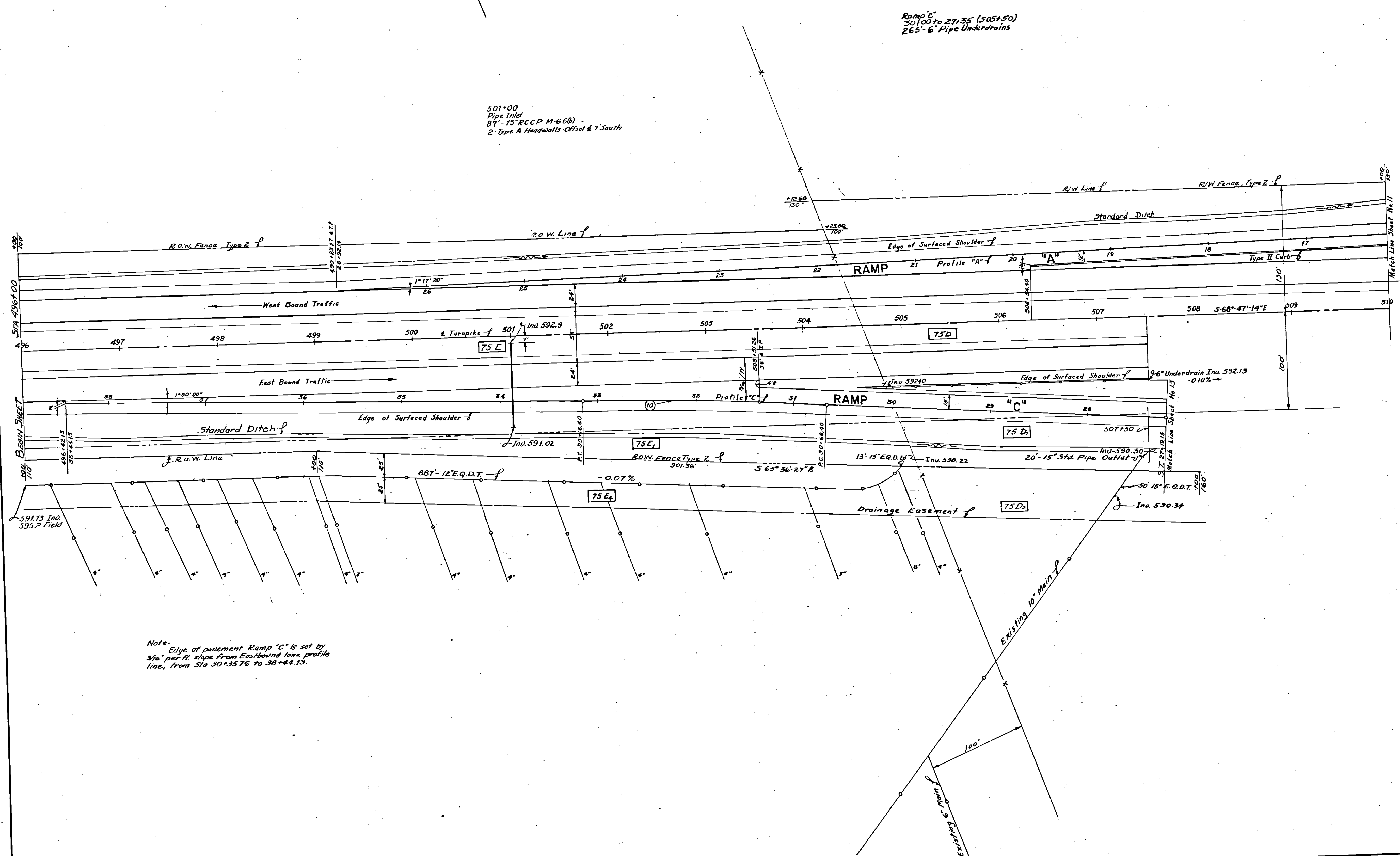

1 As-Built Plans		D.L.M. 1-18-34
NO.	REVISION	BY DATE
OHIO TURNPIKE COMMISSION OHIO TURNPIKE PROJECT NO. 1		
INTERCHANGE PLAN RAMPS "A" & "C" 496+0 TO 510+0		
PORTER-URQUHART ASSOCIATED CONTRACTING ENGINEER DESIGN SECTION D-14		
DESIGNED: D.L.M.	CHECKED: M.A.L.Jr.	DATE: Feb 19, 1955
DRAWN: B.M.H.	IN CHARGE: F.D.	SCALE: 1" = 30'
CONTRACT NO. C-39		SHEET 12 OF 64

CURVE DATA				
Curve No	A	D	R	L
11	4°34'20"		1692.5'	735.00'
12	124°53'15"		200'	435.94'
13	4°49'25"		1188'	50.04'
14	134°04'10"		216.5'	504.60'
15	4°55'50"		1162.41'	50.03'
16	33°00'00"	12°00'00"	471.46'	275.00'

B.M. El. 594.553
R.R. Spike 36" Elm
268' Lt. & Sta. 512+00

21+25 Ramp B
Type B Inlet
23.9'-15" R.C.C.P. M-6.6(b)
Type A Headwall

22+75 Ramp B
Type B Inlet
24.2'-15" R.C.C.P. M-6.6(b)
Type A Headwall

24+25 Ramp B
Type B Inlet
24.2'-15" R.C.C.P. M-6.6(b)
Type A Headwall

16+50 Ramp C
2 Type B Inlets
15.06'-15" R.C.C.P. M-6.6(b)

15+00 Ramp C
Type B Inlet

510+00
Pipe Inlet
68.6'-18" R.C.C.P. M6.6(b)
1 Type A Headwall, Offset 8' & So.
1 Type A Headwall

22+00 Ramp C
33.06'-18" R.C.C.P. M6.6(b)
2 Type A Headwalls

Ramp C
24'-18" Pipe Underdrain
Headwall

20+00 Ramp C
2 Type B Inlets
51.4'-15" R.C.C.P. M6.6(b)
Type A Headwall

19+00 Ramp C
12.65'-21" R.C.C.P. M6.6(b)
2 Type A Headwalls

18+00 Ramp C
2 Type B Inlets
41.7'-15" R.C.C.P. M6.6(b)
Type A Headwall

13+08 Ramp C
Scupper Drainage Only
See Sheet 40

15+00 to 18+00 Ramp C
27.633'-15" R.C.C.P. M-6.6(b)

27+50 Ramp "B"
1 Type B Inlet
52'-15" R.C.C.P. M6.6(b)
Type A Headwall

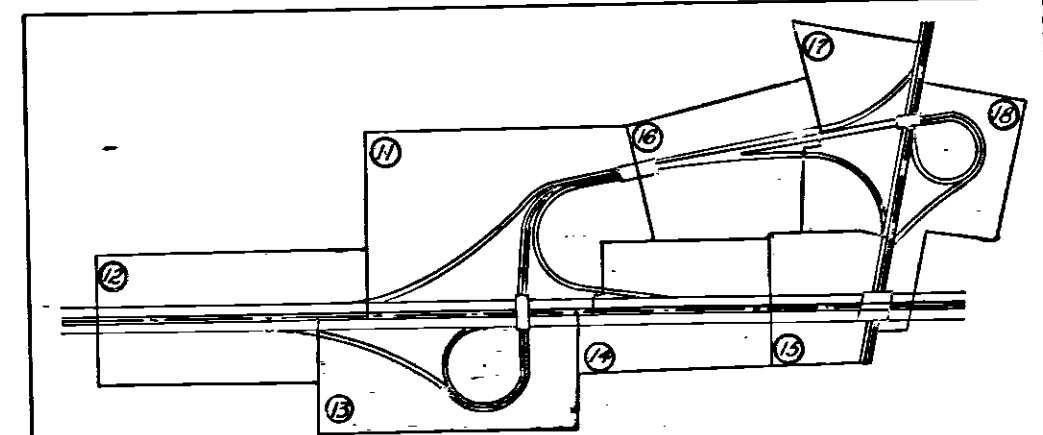

QUANTITIES					
NO.	ITEM	LOCATION & REMARKS	UNIT	ESTIMATED QUANTITY	FINAL QUANTITY
5-1	Edging Excav.		CY	15,697	20,347
5-4	Barrow		CY	18,896	25,037
1-15	Guard Rail, Type C		LF	534	525
1-15	Guard Rail, Type A		LF	134	125
1-23	R.O.W. Fence	Type 2	LF	1,238	1,758
1-3	Place Stocked Top		SY	7,189	8,189
1-9	Seeding & Protect	Type A	SY	7,189	8,189
1-19	Special Seeding		SY	45,162	35,244
2-2	Exc. for Streets		CY	172	33,06
5-21	Sec. M6.6(b)		LF	92	129.43
5-21	Sec. M6.6(b)		LF	230	493.94
1-2	Sec. M6.6(b)		LF	518	68.60
1-2	Sec. M6.6(b)		LF	67	244
1-4	Pipe Underdrain	Type A	LF	245	11
1-8	Inlets, Type B		EA	11	16.50
3-1	Conc. for Struc.	Class "C"	CY	12	1012
3-4	Reinf. Steel		Lbs	675	721.51
1-12	Type I Curb		LF	742	594.30
1-12	Type II Curb		LF	389	1,088.70
1-12	Type III Curb		LF	1,091	4,970
1-22	Selected Subbase		CY	4,969	52.71
1-33	Bit. Mac. Surf. Csg.		SY	5.94	8,781
7-71	Reinf. Concrete Pymt. 10" Thick		SY	8.781	720
1-30	6" Pipe Outlet		LF	20	20

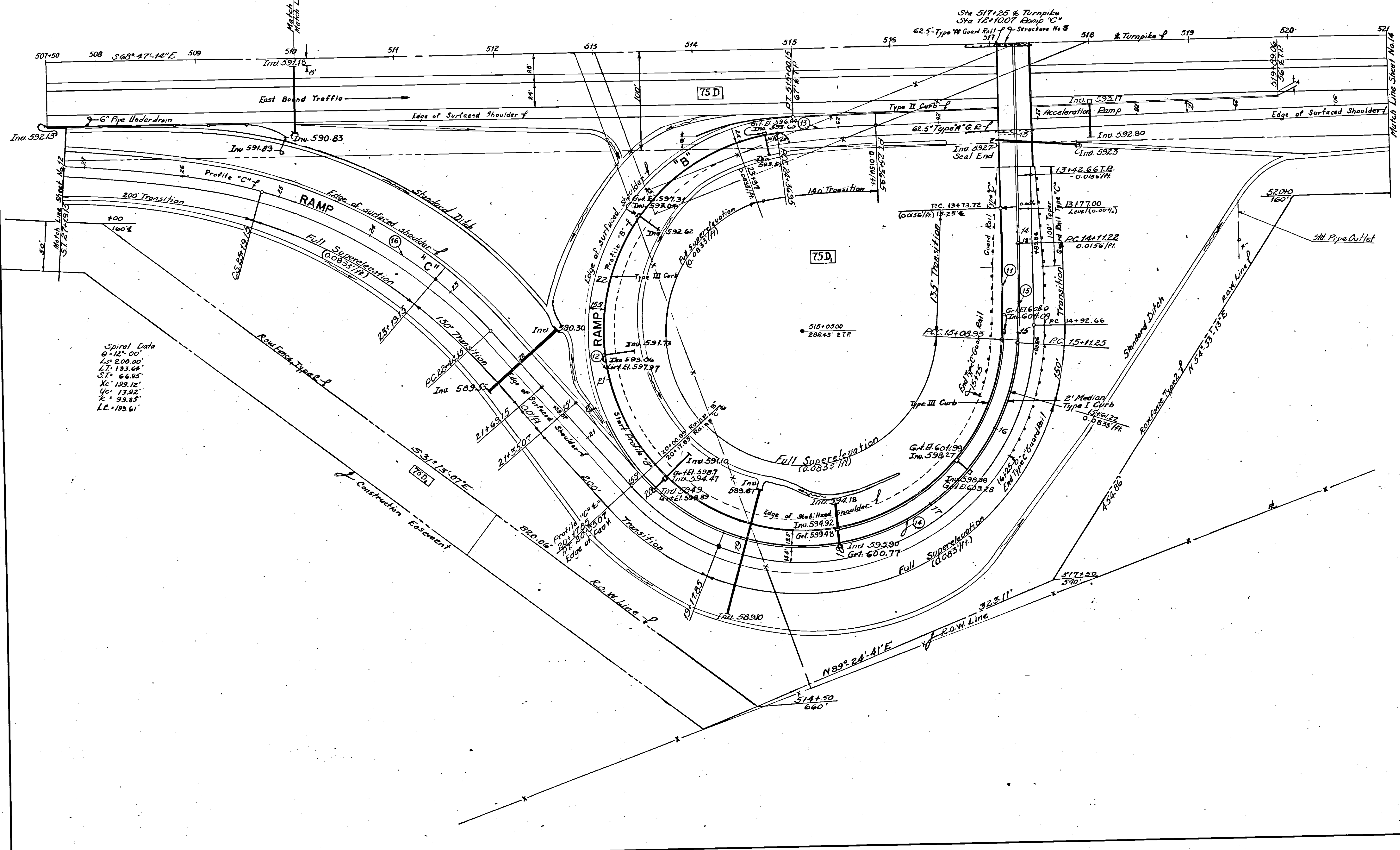

Spiral Data
 0°-12'-00"
 Ls: 200.00'
 Lt: 133.64'
 St: 64.95'
 Xc: 139.12'
 Yc: 13.92'
 X: 99.85'
 L: 193.61'

1 As-Built Plans

NO.	REVISION	BY	DATE
-----	----------	----	------

OHIO TURNPIKE COMMISSION
OHIO TURNPIKE PROJECT NO. 1
INTERCHANGE PLAN
RAMPS "B" & "C"
507+50 TO 521+00

PORTER-URQUHART ASSOCIATED
 CONTRACTING ENGINEER
 DESIGN SECTION D-14

DESIGNED: D.L.M. CHECKED: M.A.L. Jr. DATE: Feb 19, 1953
 DRAWN: B.M.H. IN CHARGE: F.D. SCALE: 1" = 50'

CONTRACT NO. C-39 SHEET 13 OF 64

CURVE DATA				
Curve No	A	D	R	L
17	2°30'00"	1°00'00"	5729.58	125.02'

BM El. 596.721
R.R. Spike - 24' Elm
350' R. & Sta. 522+50

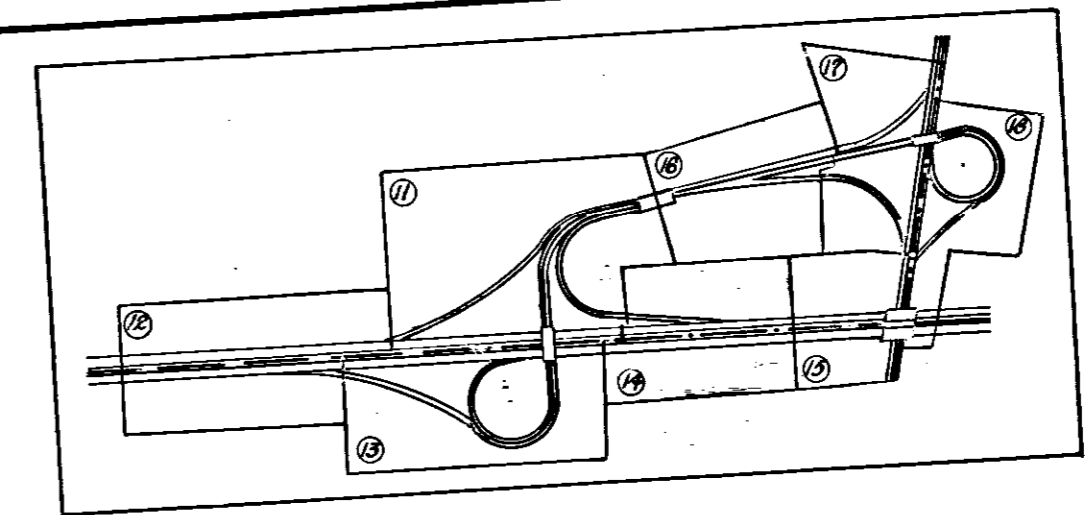
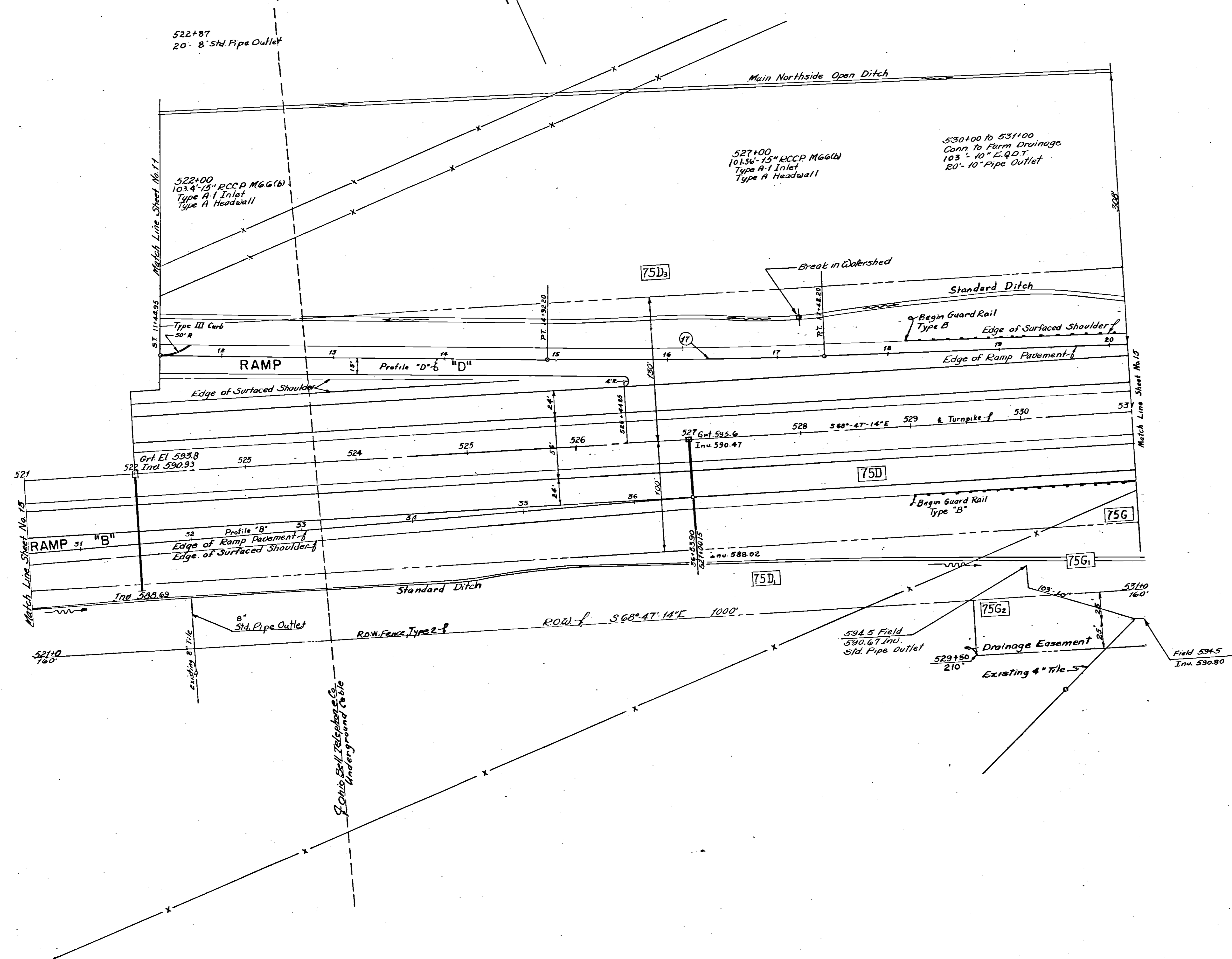

QUANTITIES					
NO.	ITEM	LOCATION & REMARKS	UNIT	ESTIMATED QUANTITY	FINAL QUANTITY
E-1	Edging Excav.		C.Y.	12,220	9,345
I-15	Guard Rail	Type B	L.F.	400	400
I-23	E.O.W. Fence	Type 2	L.F.	1,000	1,000
L-3	Placing Strip	Topsoil	S.Y.	5,616	6,616
L-9	Seed & Protect	Type A	S.Y.	5,616	6,616
L-19	Spec. Seed	M.G.G.(b)	L.F.	206	2,043
I-2	12" E.C.P.	Type A-1	L.F.	130	103
I-8	Inlets		L.F.	20	20
I-30	10" E.Q.D.T.		L.F.	20	28
I-31	10" Pipe Outlet		C.Y.	102	140
S-1	Cone for Street	Class C	Lbs	102	3043
S-4	Edging Steel		L.F.	30	3295
F-12	Type III Curb		C.Y.	5,291	4,410
I-22	Select Subbase		S.Y.	4,410	6,898
I-33	Bit. Mac. Surf. Cos.		S.Y.	6,976	23,583
F-71	Rein. Conc. Pav. 10" Thick		C.Y.	20,136	20
E-4	Borrow		L.F.	0	7
I-36	8" Pipe Outlet		L.F.	0	0
E-2	Excav. for Structures (and)		C.Y.	0	0

1. As-Built Plans

OHIO TURNPIKE COMMISSION
OHIO TURNPIKE PROJECT NO. 1
INTERCHANGE PLAN
RAMPS "B" & "D"
521+0 TO 531+0

PORTER-URQUHART ASSOCIATED
CONTRACTING ENGINEER
DESIGN SECTION D-14

DESIGNED: DLM
DRAWN: BMH

CHECKED: MAL, Jr.
IN CHARGE: F.D.

DATE: Feb. 19, 1953
SCALE: 1" = 50'

CONTRACT NO. C-39 SHEET 14 OF 64

CURVE DATA				
Curve No	Δ	D	R	L
18	6°39'.24"	1107.26'	6763'	135.00'

B.M. E1.593764
R.P. Spike 30' Oak S.H. Yard
Sta. 536+00 - 200' Rt.

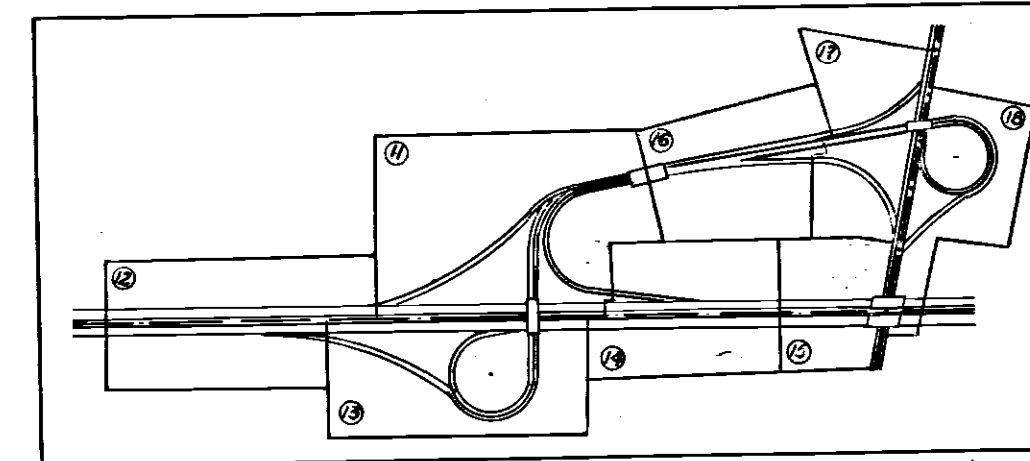

QUANTITIES					
NO.	ITEM	LOCATION & REMARKS	UNIT	ESTIMATED QUANTITY	FINAL QUANTITY
E-7	220' E.C.C.O.		C.Y.	3688	1544
E-4	100' P.O.C.		C.Y.	4587	42634
I-15	Guard Rail Type 'A'		L.F.	675	500
I-18	Guard Rail Type 'B'		L.F.	535	1042
I-23	R.O.W. Fence	Type 2	L.F.	986	
L-3	Place Staked Paving		S.Y.	2450	3450
L-9	Seeding & Protect.	Type A	S.Y.	2450	3450
L-19	Special Seeding		S.Y.	23251	22,076
I-30	10" E.Q.O.T.		L.F.	200	202
I-22	Subgrade Subbase		C.Y.	1182	1255
I-23	Bit. Mac. Surf. Cae.		S.Y.	1844	1812
T-71	Perm. Conc. Pavmt. 10" Thick		S.Y.	2596	3007
I-25	Perm. Barricade		L.F.	20	20
E-8	Remove Exist. Pavt.		S.Y.	1088	1,038
I-12	Type II, Conc. Curb		L.F.	0	7648
I-12	Type III, Conc. Curb		L.F.	0	1466

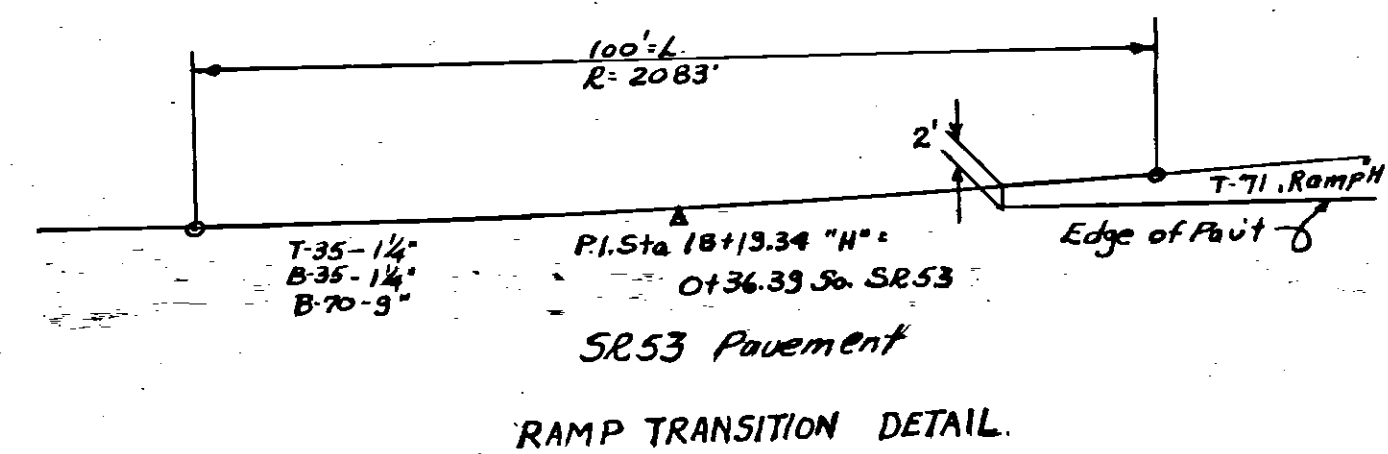
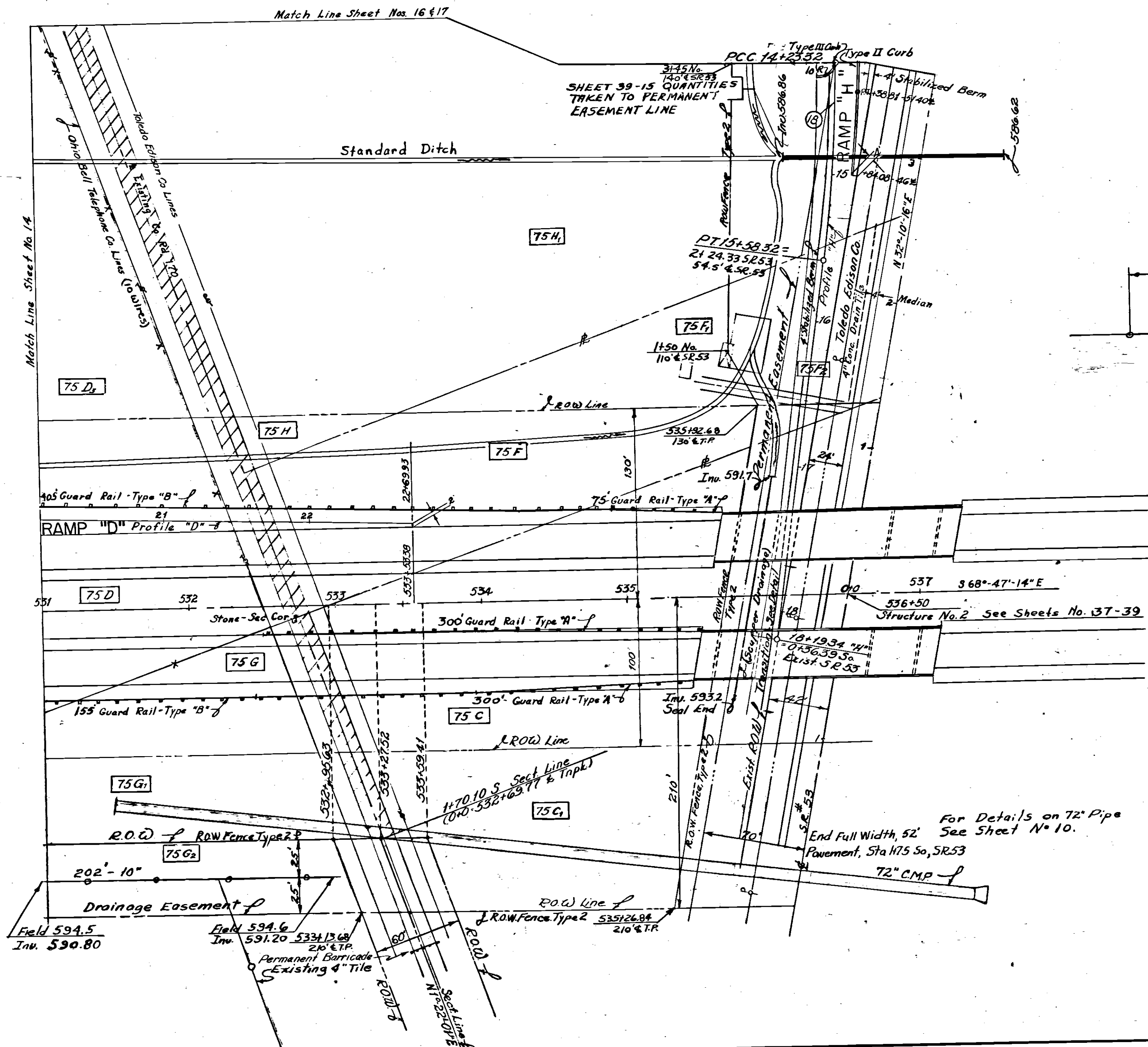

1 As-Built Plans

OHIO TURNPIKE COMMISSION
OHIO TURNPIKE PROJECT NO. 1
INTERCHANGE PLAN
RAMPS "D" & "H"
531+0 TO 537+0

PORTER-URQUHART ASSOCIATED
CONTRACTING ENGINEER
DESIGN SECTION D-14

DESIGNED: D.L.M. CHECKED: M.A.L. DATE: Feb 19 1953
DRAWN: B.M.H. IN CHARGE: F.D. SCALE: 1"=30'

CONTRACT NO. C-39 SHEET 15 OF 64

CURVE DATA					
Curve No.	Δ	D	R	T	L
21	22°56'47"	4°30'00"	1273.24'	254.57'	502.51'
22	5°38'28"	1°00'00"	5729.58'	282.28'	584.11'

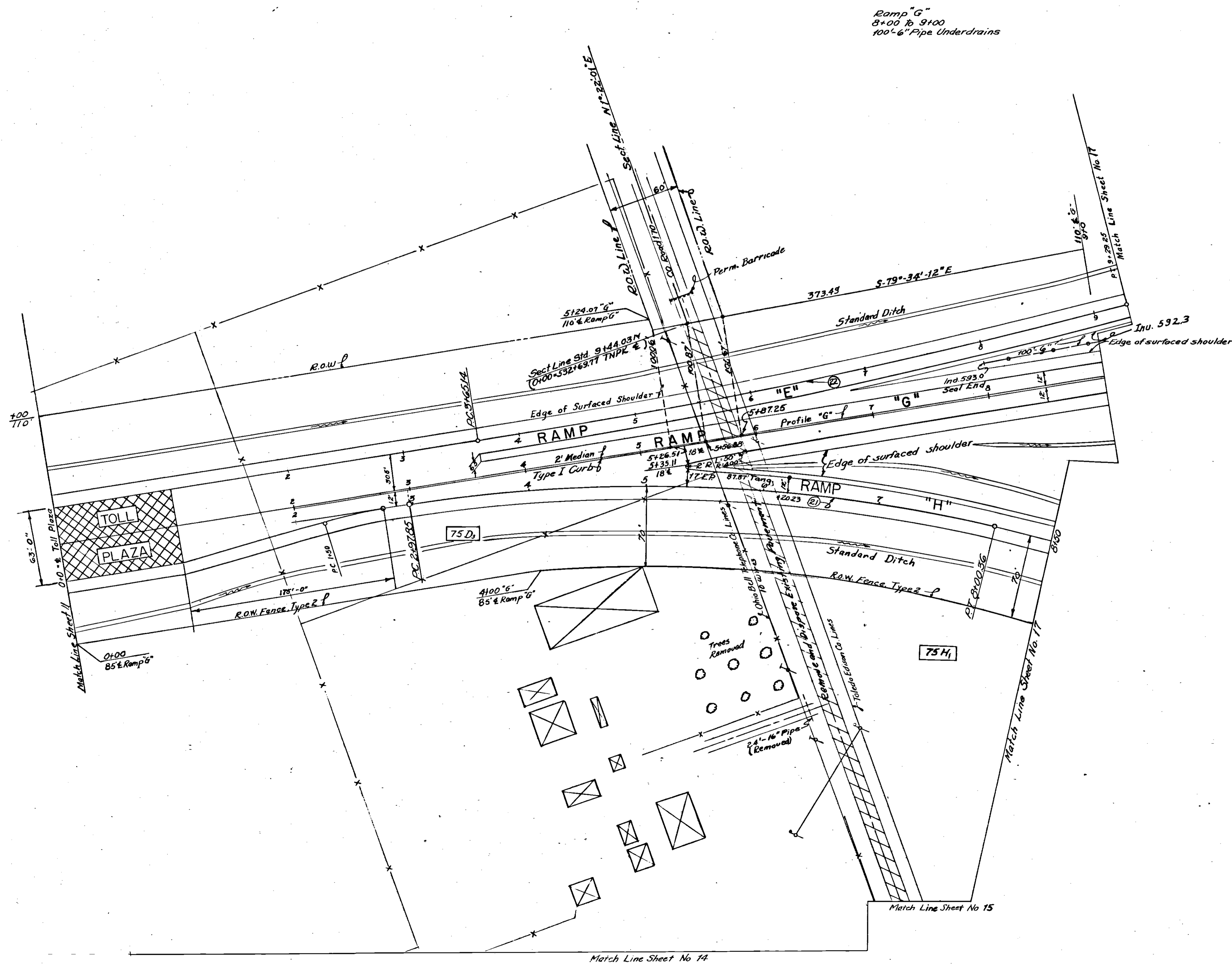
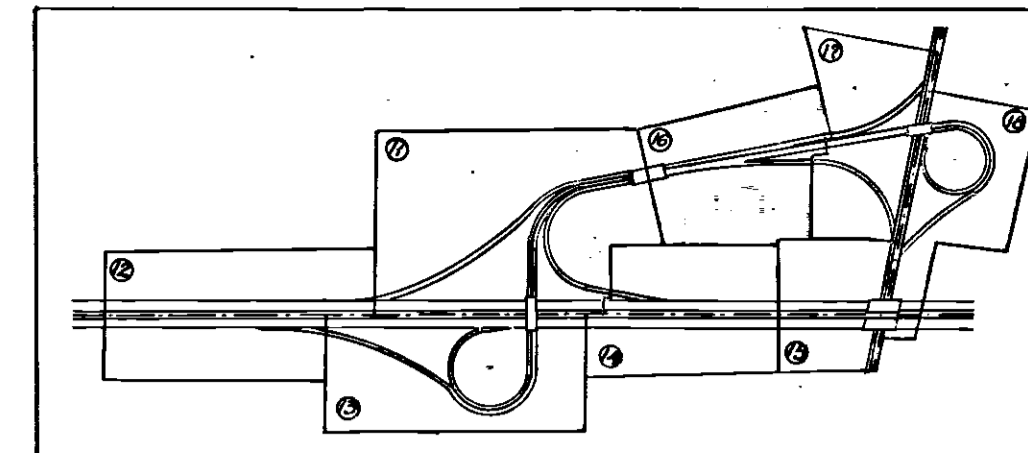

QUANTITIES					
NO.	ITEM	LOCATION & REMARKS	UNIT	ESTIMATED QUANTITY	FINAL QUANTITY
E-1	Edgely Excav.		C.Y.	3,967	3,592
E-2	Barrow		C.Y.	731.8	9,708
E-3	Remove Excav Mat		S.Y.	317	317
E-12	Emw Excav Mat		L.F.	24	24
I-23	E.O.W. Fence	Type 2	L.F.	825	825
I-25	Perm Barricade		L.F.	20	20
L-3	Place Shoulder Top		S.Y.	1,656	2,656
L-9	Spreading & Protecting Type "A"		S.Y.	1,656	2,656
L-19	Special Seeding		S.Y.	38,390	36,263
T-4	6" Pipe Underdrain	Type "A"	L.F.	100	100
I-12	Type 1 Curb		L.F.	700	700
I-22	Special Subbase		C.Y.	2,286	2,270
T-33	Bit. Mac Surf. Lse		S.Y.	3,010	2,814
T-71	Bank Conc. Revt	10" Thick	S.Y.	4,450	4,249

1 As-Built Plans

OHIO TURNPIKE COMMISSION
OHIO TURNPIKE PROJECT NO. 1

INTERCHANGE PLAN
RAMPS "E" "G" & "H"

PORTER-URQUHART ASSOCIATED
CONTRACTING ENGINEER
DESIGN SECTION D-14

DESIGNED: D.L.M. CHECKED: M.A.L. Jr. DATE: Feb. 19 1953
DRAWN: B.M.H. IN CHARGE: F.D. SCALE: 1" = 50'

CONTRACT NO. C-39 SHEET 16 OF 64

CURVE DATA					
Curve No	Δ	D	R	T	L
19	75°00'00"	300'	230.20'	592.70'	
20	2°51'54"	2700.00'	6752'	135.01'	
23	5°33'15"	1032.5'	50.08'	100.09'	
24	50°19'37"	180'	84.56'	158.11'	

Sta 12+50 Ramp "H"
Type B Inlet
Outlet directly into 24" Pipe

Sta 9+25 Ramp "H"
Type B Inlet
2x15" 15" RCCP M.G.G.(b)
Type A Headwall

Sta 11+00 Ramp "H"
Type B Inlet
3x18" 15" RCCP M.G.G.(b)
Type A Headwall

Sta 12+50 Ramp "H"
8x80" 24" RCCP M.G.G.(b)
2 Type A Headwalls

Ramp "G"
9'00" to 11'00" (Ramp "E")
2x6" 6" Pipe Underdrain
Standard Headwall

Sta 13+50 Ramp "G"
19'25" 18" RCCP M.G.G.(b)
2 Type A Headwalls

Sta 12+75 Ramp "E"
Type B Inlet
2x15" 15" RCCP M.G.G.(b)
Type A Headwall

Sta 13+50 Ramp "E"
6x75" 18" RCCP M.G.G.(b)
2 Type A Headwalls

Sta 13+50 Ramp "E"
Type B Inlet
Outlet Directly Into 18" RCCP

Sta 14+25 Ramp "E"
Type B Inlet
13'10" 15" RCCP M.G.G.(b)
Type A Headwall

Sta 15+50 Ramp "E"
A 3x Yds Type A Eirap
At Outlet of Ditch

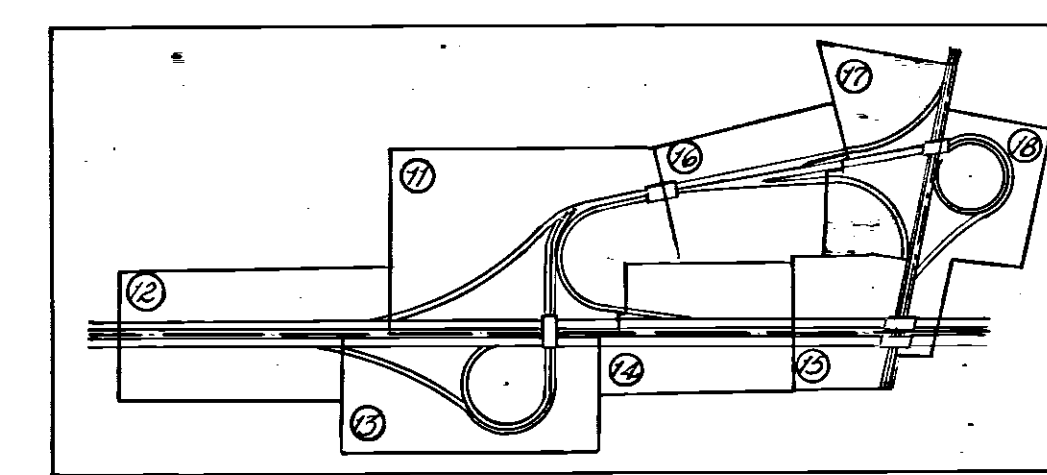

QUANTITIES					
NO.	ITEM	LOCATION & REMARKS	UNIT	ESTIMATED QUANTITY	FINAL QUANTITY
E-1	Edging Excav		C.Y.	8054	8791
E-4	Borrow		C.Y.	3953	13,692
F-5	Guard Rail	Type C	L.F.	460	462.5
F-23	R.O.W. Fence	Type 2	L.F.	480	480
L-3	Placing Stockpiled Topsoil		S.Y.	3413	4,413
L-9	Seed & Protect	Type A	S.Y.	3413	4,413
L-19	Soil Seeding		S.Y.	23,844	24,782
E-2	Exc. For Street		C.Y.	261	275
F-2	15" RCCP	M.G.G.(b)	L.F.	99	99.78
F-4	Pipe Underdrains Type "A"		L.F.	250	246
F-27	18" RCCP	M.G.G.(b)	L.F.	216	215.98
F-27	24" RCCP	M.G.G.(b)	L.F.	84	84.80
F-8	Inlets Type B		EA	5	6
F-10	Eirap Type A	Grouted	S.Y.	5	4
F-12	Conc. Curb	Type I	L.F.	435	436.37
F-12	Conc. Curb	Type II	L.F.	76	78.32
F-12	Conc. Curb	Type III	L.F.	951	960.04
S-1	Conc. For Street	Class C	C.Y.	103	14.22
S-4	Reinf. Steel		LBS	585	875
F-28	Select Subbase		C.Y.	2,060	2,060
F-23	Bit. Mac. Surf. Cse		S.Y.	1,820	1,814
F-71	Reinf. Conc. Pavt. 10" Thick		S.Y.	3,421	3,234

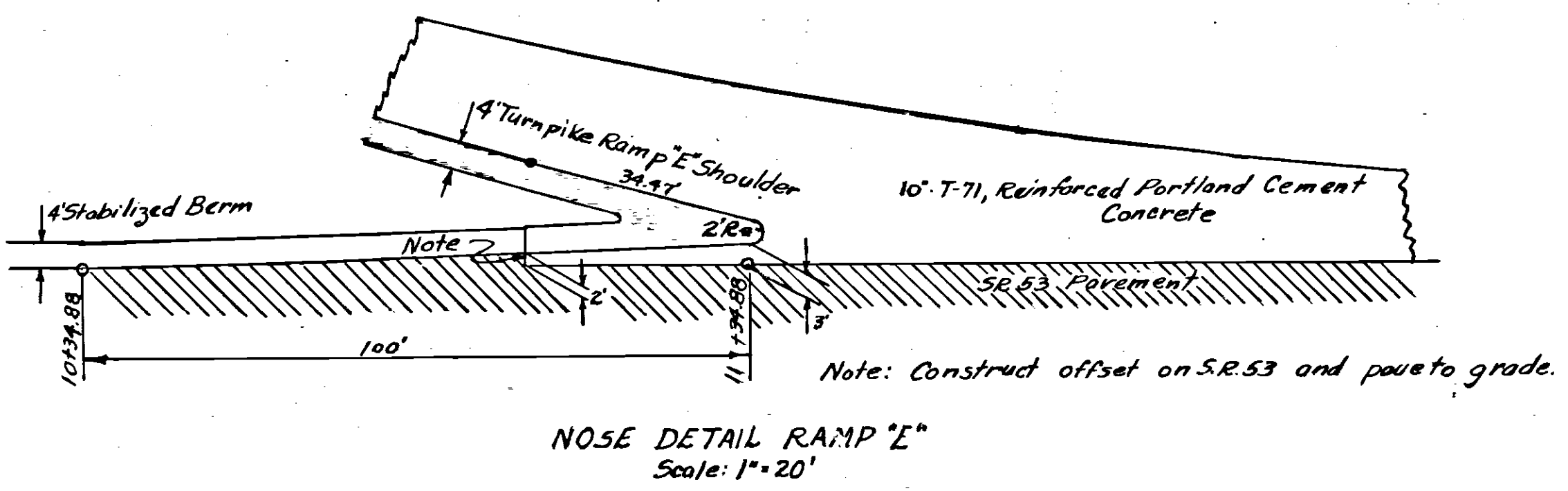
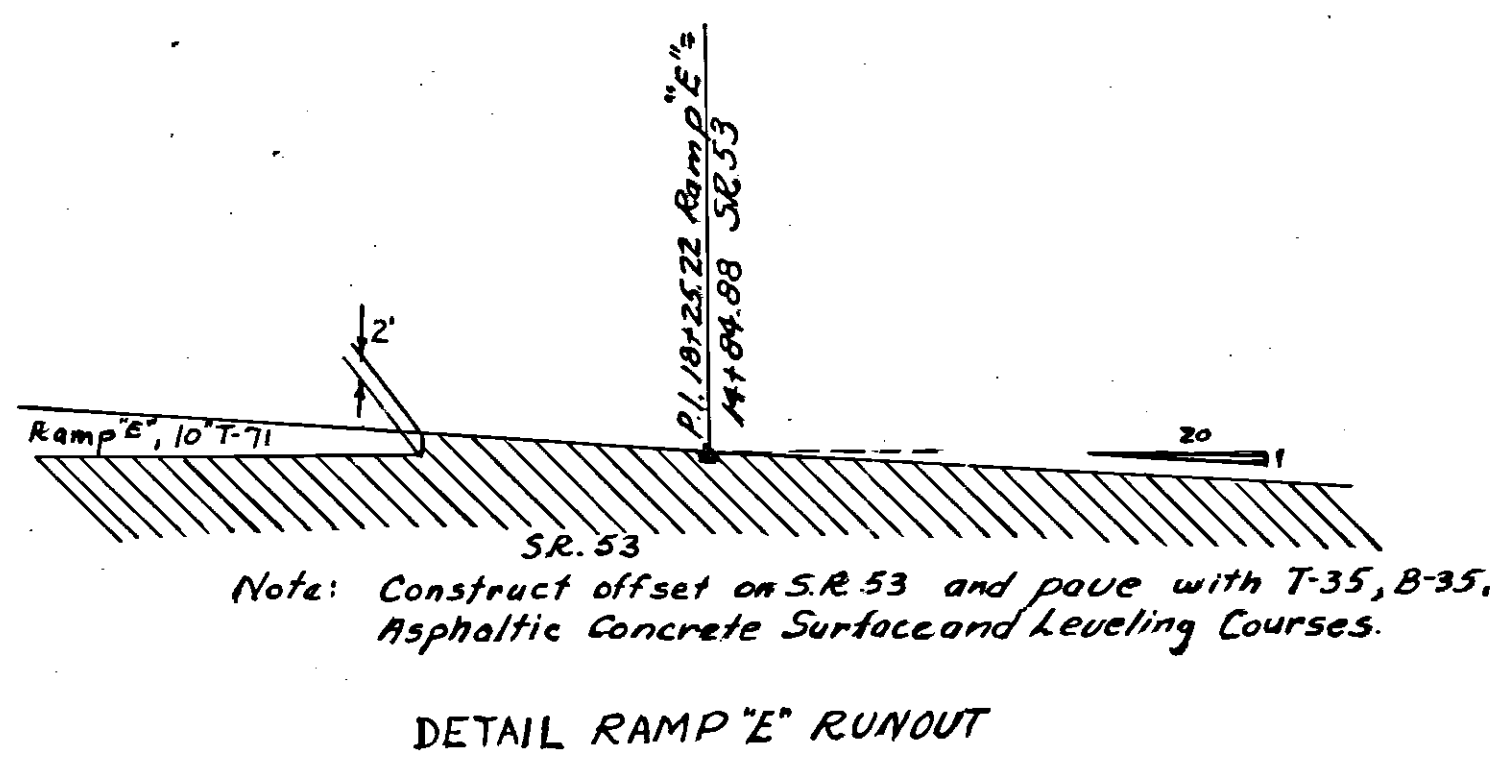
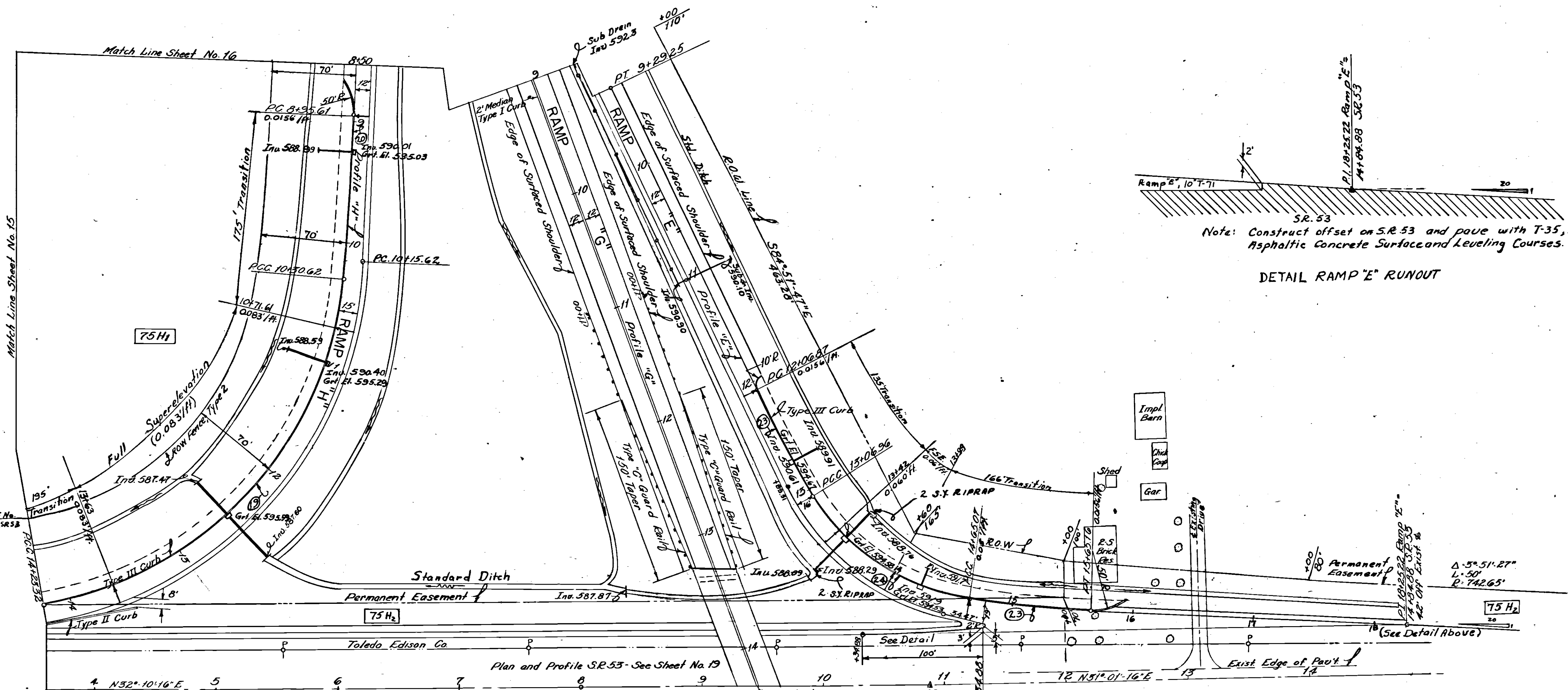

1 As-Built Plans			D.L.M. 1-12-84
NO.	REVISION	BY	DATE
OHIO TURNPIKE COMMISSION OHIO TURNPIKE PROJECT NO. 1			
INTERCHANGE PLAN RAMPS "E" "G" & "H"			
PORTER - UROUHART ASSOCIATED CONTRACTING ENGINEER DESIGN SECTION D-14			
DESIGNED: D.L.M.	CHECKED: M.A.L.	DATE: 5-19-53	
DRAWN: B.M.H.	IN CHARGE: E.D.	SCALE: 1"=50'	
CONTRACT NO. C-39		SHEET 17 OF 64	

CURVE DATA				
Curve No.	A	D	T	L
25	9°19'30.64"	615.10'	5017'	100.11'
26	5°42'13.03"	1004.97'	50.06'	100.04'
27	16°42'30.45"	197.00'		565.64'
28	5°42'46.76"	1003.32'	50.06'	100.04'
29	2°51'56"	2700.00'	67.53'	135.00'
30	50°04'29"	300.82'	140.52'	262.91'
31	8°27'40"	915.00'	67.68'	133.12'
32	111°32'28"	180.00'		350.41'

17+00 Ramp F & G
2 Type B Inlets
16x5'-15" R.C.C.P. M-6.6(b)

18+75 Ramp F & G
2 Type B Inlets
16x5'-15" R.C.C.P. M-6.6(b)

17+00 to 20+50 Ramp F
3x18'-15" R.C.C.P. M-6.6(b)

20+50 Ramp F & G
17.70'-24" R.C.C.P. M-6.6(b)
2 Type A Headwalls

20+50 Ramp F
Type B Inlet
Outlet directly into 24" R.C.C.P.

14+85 Ramp F & G
13x7.5'-18" R.C.C.P. M-6.6(b)
2 Type B Headwalls

20+50 Ramp G
Type B Inlet
Outlet directly into 24" R.C.C.P.

23+00 Ramp G
82.4'-18" R.C.C.P. M-6.6(b)
2 Pipe Specials - 26° Bends M-6.6(b)
2 Type A Headwalls

24+50 Ramp G
Type B Inlet
42.88'-15" R.C.C.P. M-6.6(b)
2 Pipe Specials - 26° Bends M-6.6(b)
Type A Headwalls

23+50 Ramp G
Type B Inlet
50.05'-15" R.C.C.P. M-6.6(b)
2 Pipe Specials - 26° Bends M-6.6(b)
Type A Headwall

22+00 Ramp F
Type B Inlet
42.70'-15" R.C.C.P. M-6.6(b)
2 Pipe Specials - 26° Bends M-6.6(b)
Type A Headwall

23+50 Ramp F
Type B Inlet
37.26'-15" R.C.C.P. M-6.6(b)
Type A Headwall

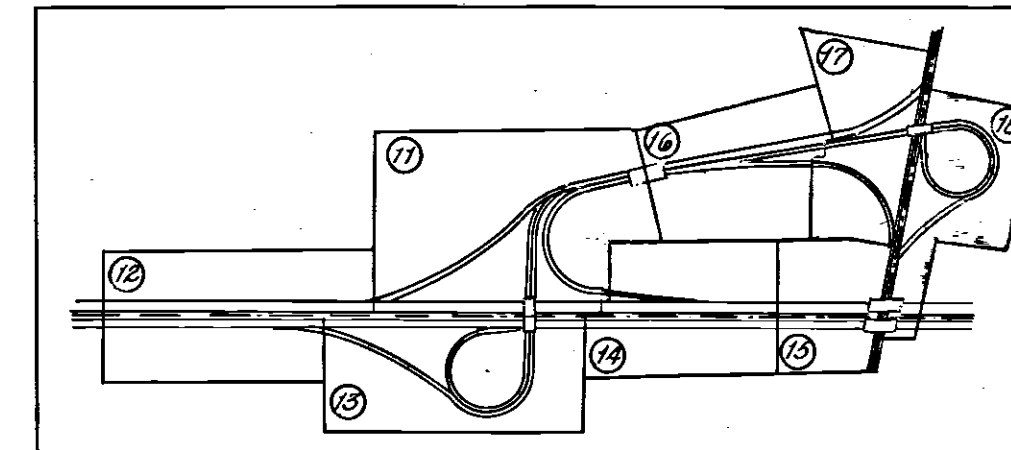

QUANTITIES					
NO.	ITEM	LOCATION & REMARKS	UNIT	ESTIMATED QUANTITY	FINAL QUANTITY
E-1	Excav. Excess		C.Y.	14,176	17,398
E-4	Box Road		C.Y.	23,888	33,814
F-15	Guard Rail	Type "C"	L.F.	1,205	1187.50
L-3	Place Strip Road		S.Y.	3,907	4,565
L-9	Spreading Project Type "A"		S.Y.	3,907	4,565
L-19	Special Sealing		S.Y.	38,394	27,204
F-2	Excav. for Street Inlet		C.Y.	262	241
F-2	15" R.C.C.P.	M-6.6(b)	L.F.	555	521.77
F-10	Prop.	Type "A" Grout	S.Y.	3.5	0
S-27	18" R.C.C.P.	M-6.6(b)	L.F.	215	215.13
S-27	24" R.C.C.P.	M-6.6(b)	L.F.	118	117.70
I-8	Inlets	Type B	EA.	10	10
S-1	Concrete for Street	Class "C"	C.Y.	10	13.12
S-4	Rein. Steel		Lbs.	521	606
F-12	Type I Curb		L.F.	669	706.37
F-12	Type II Curb		L.F.	48	84
F-12	Type III Curb		L.F.	1308	1,425.64
F-5	7.5" Pipe Spec.	26° Bends M-6.6(b)	EA.	6	6
F-5	10" Pipe Spec.	26° Bends M-6.6(b)	EA.	2	2
I-23	Special Sealing		C.Y.	3,040	3,130
F-33	Bit. Mac. Surf. Course		S.Y.	1,154	1,235
F-71	Rein. Conc. Slab	10"	S.Y.	3,847	4,342
I-2	8" S.S. R.C.C.P.	or S.S.V.C.	L.F.	16	0

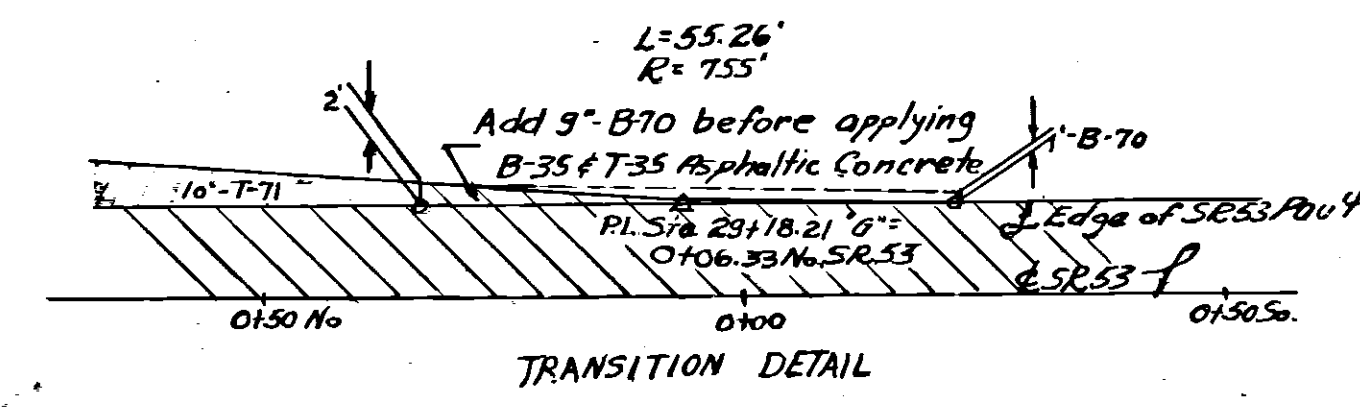
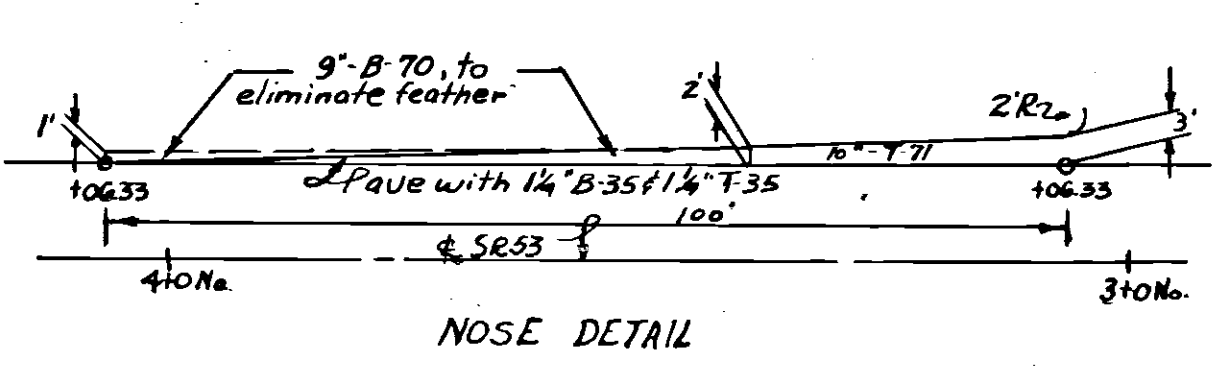
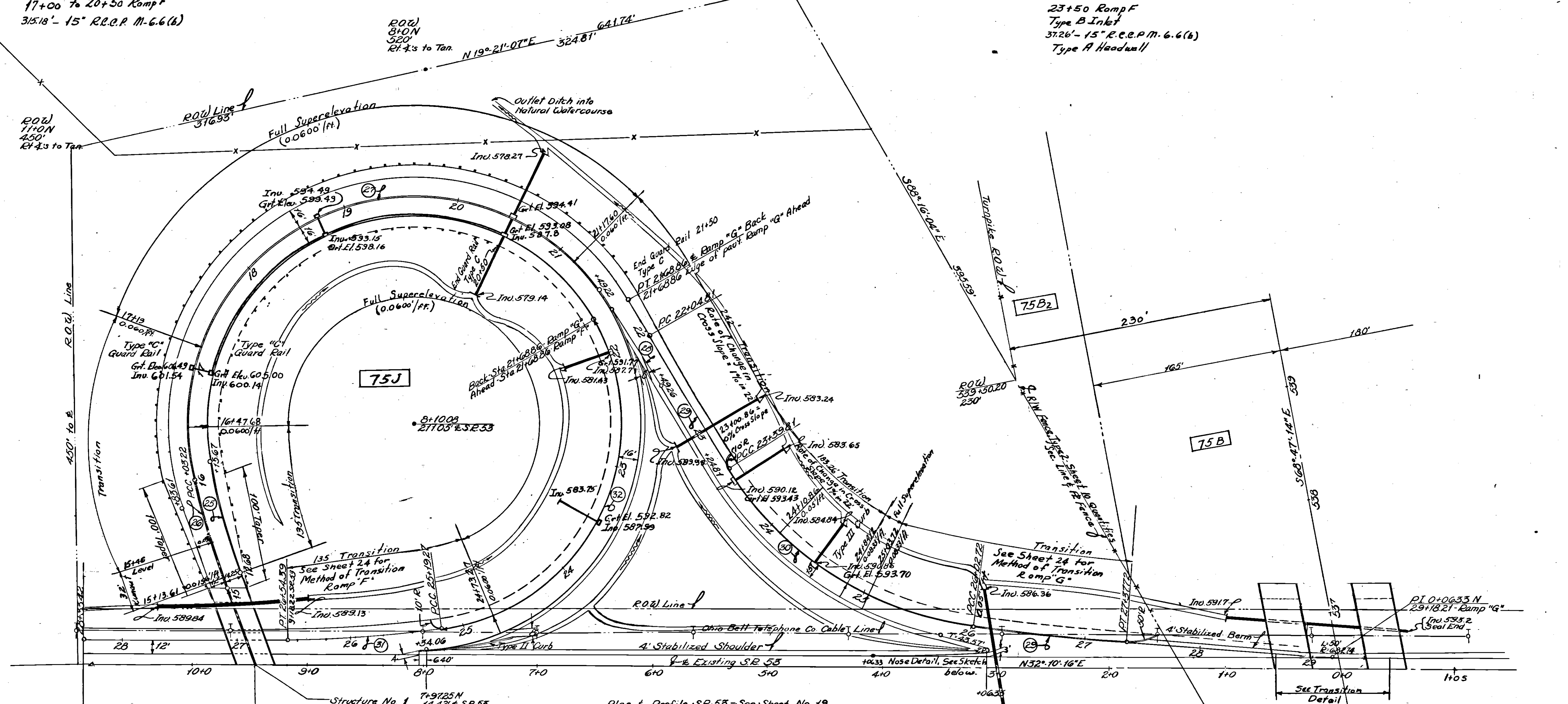

As-Built Plans		D.L.M.	1/18/56
NO.	REVISION	BY	DATE
OHIO TURNPIKE COMMISSION			
OHIO TURNPIKE PROJECT NO. 1			
INTERCHANGE PLAN RAMPS "F" & "G"			
PORTER-URQUHART ASSOCIATED CONTRACTING ENGINEER DESIGN SECTION D-14			
DESIGNED: DLM	CHECKED: MHL	DATE: 5/14/55	
DRAWN: BMH	IN CHARGE: ED	SCALE: 1"=50'	
CONTRACT NO. C-39		SHEET 18 OF 64	

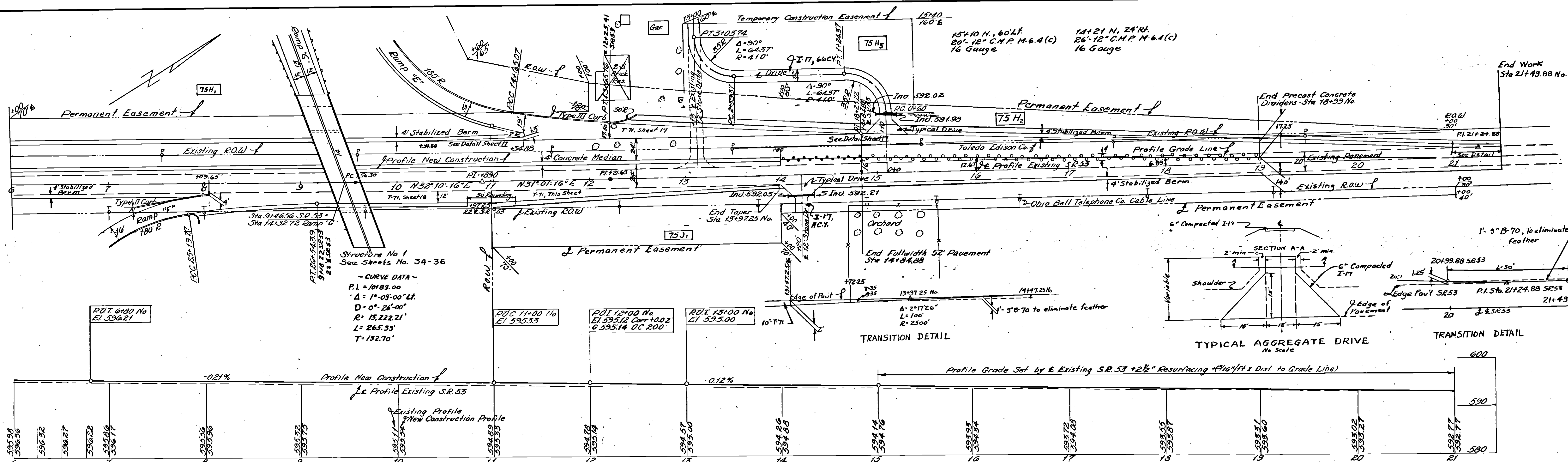

S.R. 53 PLAN AND PROFILE - STA 6+00 TO STA 21+00

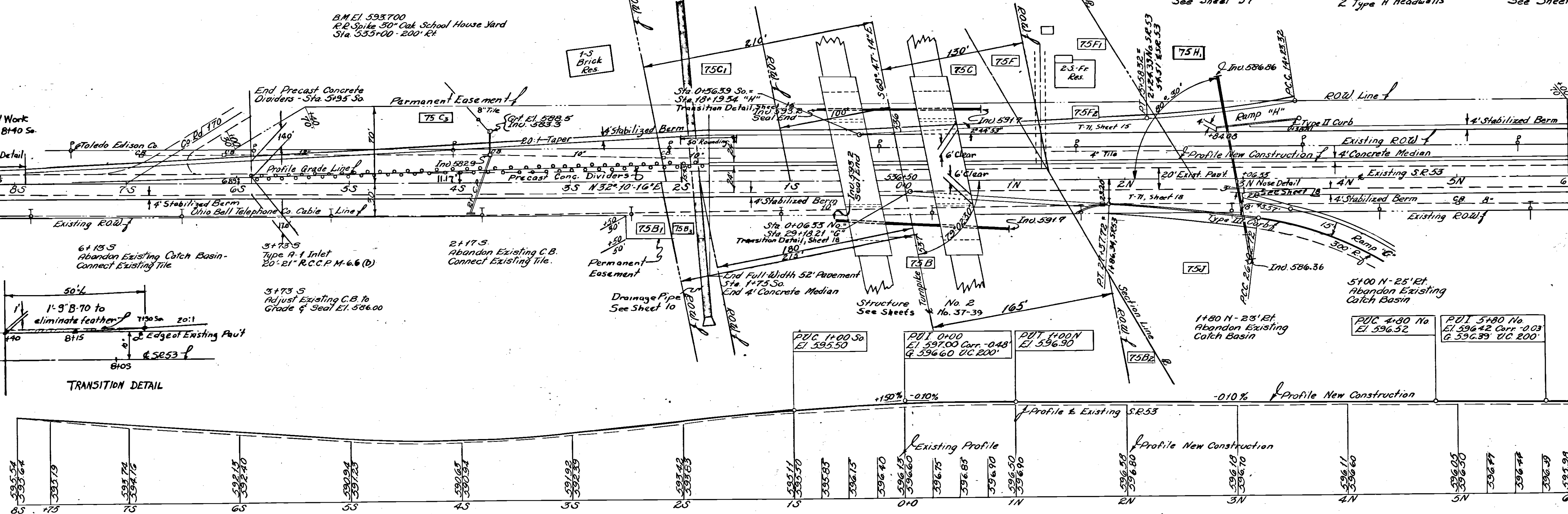

S.R. 53 PLAN AND PROFILE - STA 8+00 TO STA 6+00

QUANTITIES					
NO.	ITEM	LOCATION & REMARKS	UNIT	ESTIMATED QUANTITY	FINAL QUANTITY
E-1	Utility Excav.		C.Y.	11,130	7,316
E-4	Corroad		C.Y.	8,725	701
F-26	Form. Man.		EA.	2	0
L-3	Flating S/Sed Spoil		S.Y.	2,813	2,813
L-9	Seed. & Fertilizer	Type "a"	S.Y.	2,813	2,813
L-19	Spec. Seeding		S.Y.	7,674	4,633
E-2	Excav. for Street Uncl.		C.Y.	373	384
I-1	Pipe for Drive	12" C.M.P. 40#	L.F.	46	46
S-27	21" R.C.C.P.	M-6.6(b)	L.F.	20	20
S-28	42" R.C.C.P.	M-6.6(b)	L.F.	163	163
F-3	Trails	Type "A"	EA.	1	1
I-16	Abandon Ex. C.B.		EA.	4	4
S-1	Conc. Struct.	Class "C"	C.Y.	14.5	13.50
S-4	Reinf. Steel		Lbs.	544	830
I-21	Conc. Median		S.Y.	7.20	700
I-22	Selected Sub-base		C.Y.	4,014	3,935
F-17	Side Approach		C.Y.	77	66
I-18	Stabilized Shoulders	#6 Runout	C.Y.	430	430
F-71	Reinf. Conc. Form. 10"		S.Y.	1,195	1,35.89
B-70	Conc. Base Course 9"		S.Y.	7,850	7,632
S-35	Asph. Conc. Leveling Course		C.Y.	590	589.47
F-35	Asph. Conc. Surface Course "A"		C.Y.	4,68	4,67.30
F-30	Bit. Tack Coat	M-5.3, MC-2	Gal.	1,350	1,305
I-31	Precast Portland Cement Concrete Traffic Dividers		ea.	170	170
I-30	8" E.Q.D.T.		L.F.		12

NO.	REVISION	BY	DATE
1	As-Built Plans		01.11.25.6

OHIO TURNPIKE COMMISSION
OHIO TURNPIKE PROJECT NO. 1

PLAN AND PROFILE
 S. R. 53

PORTER-URQUHART ASSOCIATED
 CONTRACTING ENGINEER
 DESIGN SECTION D-14

DESIGNED: D.L.M. CHECKED: M.A.L. DATE: 5-18-53
 DRAWN: B.M.H. IN CHARGE: E.D. SCALE: 1/320" = 1' = 10"

CONTRACT NO. C-39 SHEET 19 OF 64

Note:
 Where Catch Basin Inlets are abandoned, the existing tile shall be connected through or sealed and the walls shall be removed to a minimum of 3' from the finished sub-grade.