

O.D.O.T. DISTRICT 2 SURVEY OFFICE (USE ONLY)

PERSONNEL \_\_\_\_\_ REFERENCE NO. 18 SHEET 26 OF 30  
NOTES AUBLE DATE 6/3/22 ROUTE SR 53  
H.C. NIESE WEATHER FAIR COUNTY SANDUSKY  
R.C. WHITAKER TEMP. 63° TOWNSHIP SANDUSKY  
DWG BY RHOADES PID 111020 SECTION 30  
T 5 N R 15 E

TYPE MONUMENT MAG/WASHER

ON SURFACE - ~~BELOW~~ ON \_\_\_\_\_

OFFSET  $\odot$  PAVEMENT 0.3' LT : ~~RT~~

11.6' TO LT EDGE PAVEMENT

STATION: 488+22.7

HORZ. DATUM: NAD83 2011

GEOID: NAVD88 2018

GRID: NORTHING: 616900.212

EASTING: 1785830.408

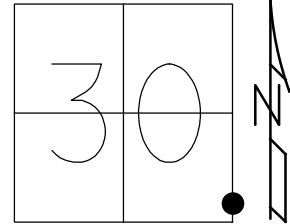

RECORD: T.S.  
SV115  
7/29/10, KPM  
SET MAG/WASHER  
7/19/12  
SET MAG/WASHER  
CKREF18  
10/9/14, DCH  
SET MAG/WASHER  
REF18  
6-2-22, TDN  
FD MAG/WASHER  
1-4-23, TDN

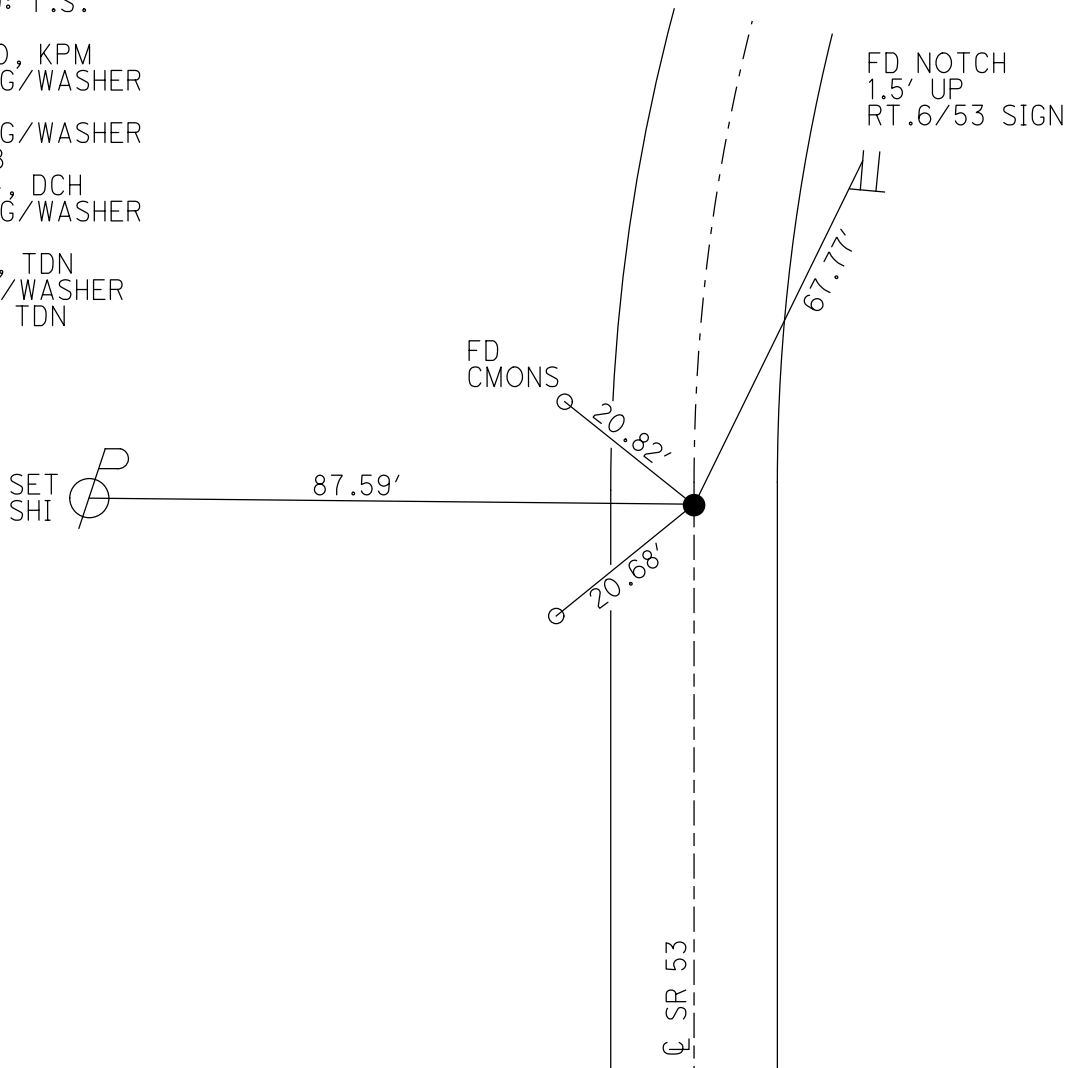

O.D.O.T. DISTRICT 2 SURVEY OFFICE (USE ONLY)

PERSONNEL \_\_\_\_\_ REFERENCE NO. 18 SHEET 22 OF 25  
 NOTES WESTFALL DATE 10/9/14 ROUTE SR 53  
 H.C. HOMAN WEATHER FAIR COUNTY SANDUSKY  
 R.C. WESTFALL TEMP. 54° TOWNSHIP SANDUSKY  
 \_\_\_\_\_ SECTION 31  
 \_\_\_\_\_ T 5 N R 15 E

TYPE MONUMENT MAG/WASHER  
 ON SURFACE - ~~BELOW~~ ON  
 LEFT - ☉ PAV'T - RIGHT ON  
11.6' TO LT EDGE PAVEMENT  
 S.L.M. 488+22.7

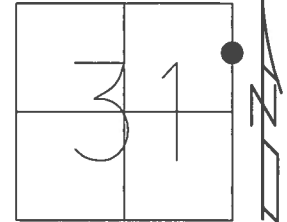

Grid: Northing: 616900.339 Easting: 1785830.334

RECORD: T.S.  
 SET MAG/WASHER  
 7/19/12  
 GPS, SV115  
 7/29/10, KPM  
 SET MAG/WASHER  
 CKREF18  
 10/9/14, DCH

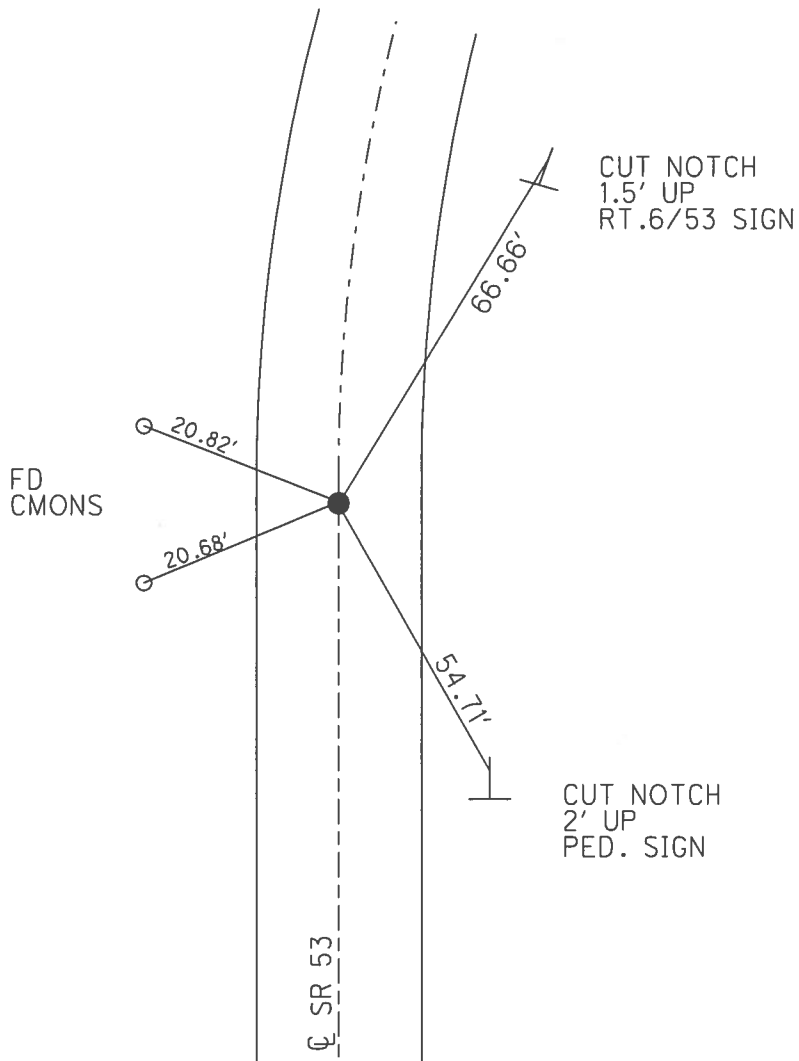

O.D.O.T. DISTRICT 2 SURVEY OFFICE (USE ONLY)

PERSONNEL \_\_\_\_\_ REFERENCE NO. 18 SHEET 22 OF 25  
 NOTES CANTERBURY DATE 7/13/12 ROUTE SR 53  
 H.C. HUSS WEATHER SUNNY COUNTY SANDUSKY  
 R.C. COUTCHER TEMP. 75° TOWNSHIP SANDUSKY  
 \_\_\_\_\_ SECTION 31  
 \_\_\_\_\_ T 5 N R 15 E

TYPE MONUMENT MAG/WASHER  
 ON SURFACE - ~~BELOW~~ ON  
 LEFT - ☉ PAV'T - RIGHT ON  
11.6' TO LT EDGE PAVEMENT  
 S.L.M. 377+13.05

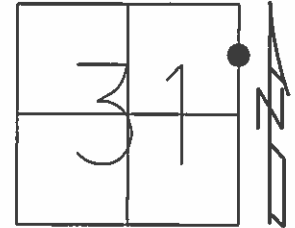

Grid: Northing: 616900.332 Easting: 1785830.387

RECORD: T.S.  
 SET MAG/WASHER  
 7/19/12  
 GPS, SV115  
 7/29/10, KPM

