

O.D.O.T. DISTRICT 2 SURVEY OFFICE (USE ONLY)

PERSONNEL

REFERENCE NO. 25 C

SHEET 8 OF 11

NOTES AUBLE

DATE 12/15/23

ROUTE SR 53

H.C. AUBLE

WEATHER CLOUDY

COUNTY SANDUSKY

R.C. NIESE  
ASTON

TEMP. 28°

TOWNSHIP SANDUSKY

DWG BY RHOADES

PID 95760

SECTION 15

T 5 N R 15 E

TYPE MONUMENT MAG NAIL

ON SURFACE - ~~BELOW~~ ON

OFFSET ℄ PAVEMENT - ~~RT~~ : RT

26.29' TO RT EDGE PAVEMENT

STATION: 539+52.27

HORIZ.DATUM: NAD83 2011

GEOID: NAVD88 2018

GRID: NORTHING: 630118.594

EASTING: 1801149.532

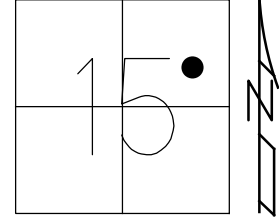

RECORD: P.C.  
SET MAG NAIL  
NW CONSULTANTS  
6/15/17, O.M.  
FD MAG NAIL  
REF107  
8/28/17, JLL  
FD MAG NAIL  
REF25C  
12/15/23, DSA

FD SHI'S  
GR POSTS

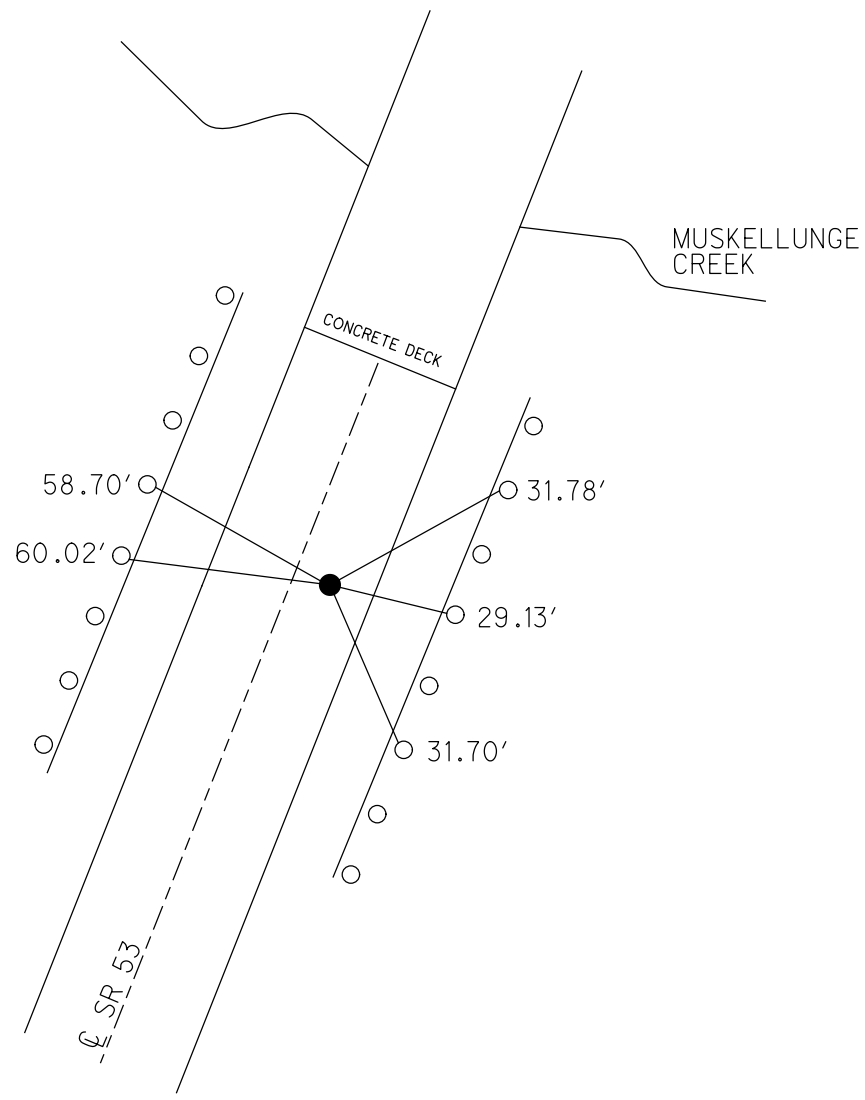

O.D.O.T. DISTRICT 2 SURVEY OFFICE (USE ONLY)

PERSONNEL \_\_\_\_\_ REFERENCE NO. 25 C SHEET 8 OF 11  
 NOTES LEU DATE 8/28/17 ROUTE SR 53  
 H.C. LEU WEATHER FAIR COUNTY SANDUSKY  
 R.C. FARKAS TEMP. 69° TOWNSHIP SANDUSKY  
 DWG BY RHOADES PID 101292 SECTION 15  
 T 5 N R 15 E

TYPE MONUMENT MAG NAIL  
 ON SURFACE - ~~BELOW~~ ON \_\_\_\_\_  
 OFFSET  $\odot$  PAVEMENT - \_\_\_\_\_ ~~LT~~ : RT  
26.29' TO RT EDGE PAVEMENT  
 STATION: 539+52.27

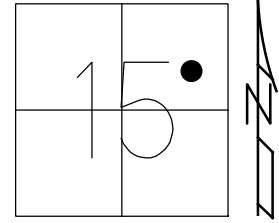

HORIZ.DATUM: NAD83 2011 GEOID: NAVD88 2012A  
 GRID: NORTHING: 530118.629 EASTING: 1801149.563

RECORD: P.C.  
 SET MAG NAIL  
 NW CONSULTANTS  
 6/15/17, O.M.  
 FD MAG NAIL  
 REF107  
 8/28/17, JLL

