

O.D.O.T. DISTRICT 2 SURVEY OFFICE (USE ONLY)

PERSONNEL

REFERENCE NO. 26

SHEET 9 OF 11

NOTES AUBLE

DATE 12/15/23

ROUTE SR 53

H.C. AUBLE

WEATHER CLOUDY

COUNTY SANDUSKY

R.C. NIESE  
ASTON

TEMP. 28°

TOWNSHIP SANDUSKY

DWG BY RHOADES PID 95760

SECTION 15

T 5 N R 15 E

TYPE MONUMENT MAG NAIL

ON SURFACE - ~~BELOW~~ ON

OFFSET  $\text{C}$  PAVEMENT - LT : RT

- TO - EDGE PAVEMENT

STATION: 543+58.06

HORZ.DATUM: NAD83 2011

GEOID: NAVD88 2018

GRID: NORTHING: 630499.339

EASTING: 1801296.928

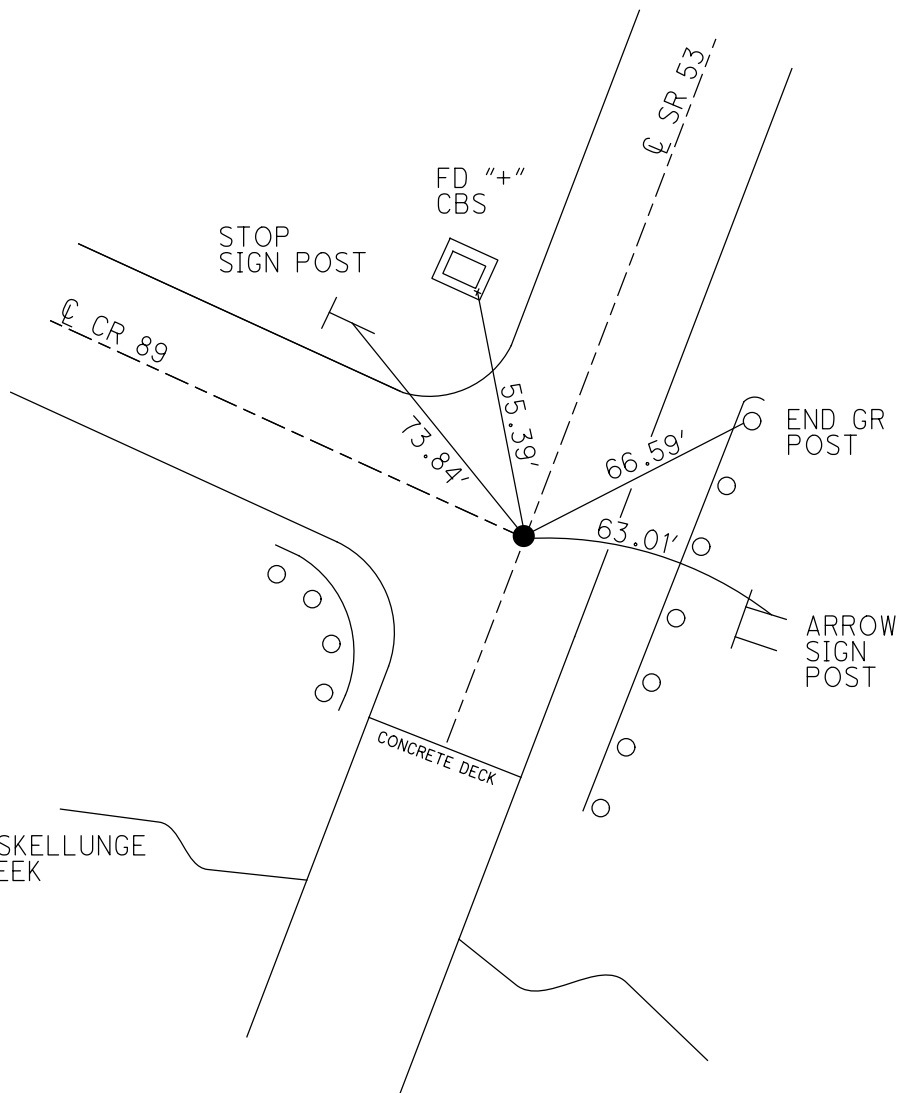
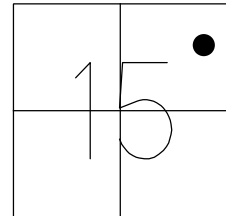

RECORD: P.I.  
SET MAG NAIL  
NW CONSULTANTS  
6/15/17, O.M.  
FD MAG NAIL  
REF108  
8/28/17, JLL  
FD MAG NAIL  
REF26  
12/15/23, DSA

O.D.O.T. DISTRICT 2 SURVEY OFFICE (USE ONLY)

PERSONNEL \_\_\_\_\_ REFERENCE NO. 26 SHEET 9 OF 11  
 NOTES LEU DATE 8/28/17 ROUTE SR 53  
 H.C. LEU WEATHER FAIR COUNTY SANDUSKY  
 R.C. FARKAS TEMP. 69° TOWNSHIP SANDUSKY  
 DWG BY RHOADES PID 101292 SECTION 15  
 T 5 N R 15 E

TYPE MONUMENT MAG NAIL  
 ON SURFACE - ~~BELOW~~ ON  
 OFFSET 0 PAVEMENT - LT : RT  
- TO - EDGE PAVEMENT  
 STATION: 543+58.06

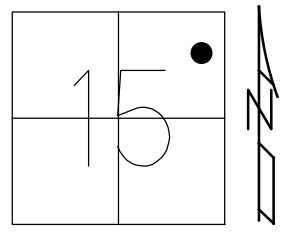

HORZ.DATUM: NAD83 2011 GEOID: NAVD88 2012A  
 GRID: NORTHING: 630499.358 EASTING: 1801296.985

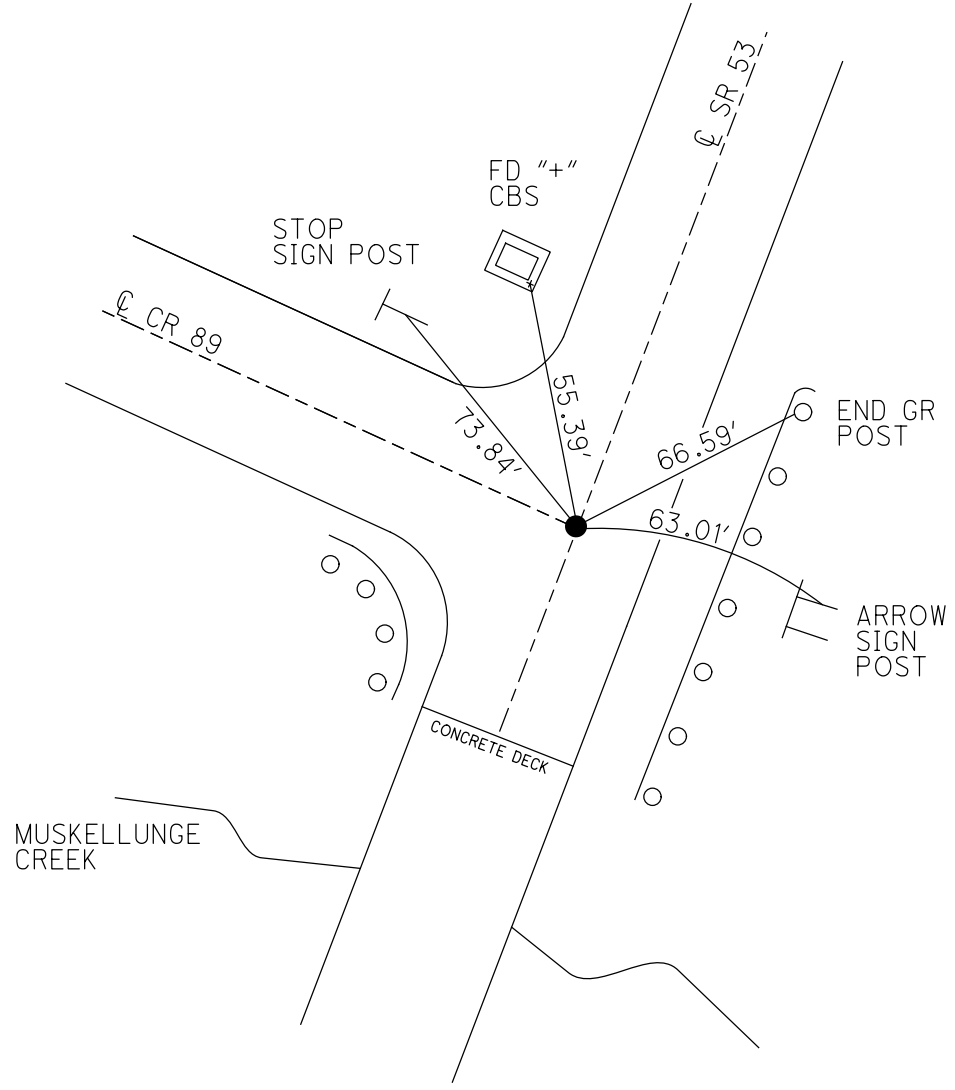

RECORD: P.I.  
 SET MAG NAIL  
 NW CONSULTANTS  
 6/15/17, O.M.  
 FD MAG NAIL  
 REF108  
 8/28/17, JLL