

O.D.O.T. DISTRICT 2 SURVEY OFFICE (USE ONLY)

PERSONNEL

REFERENCE NO. 12

SHEET 4 OF 8

NOTES HOFFMAN

DATE 4/26/91

ROUTE SR 105

H.C. BARNHISEL

WEATHER OVERCAST

COUNTY SANDUSKY

R.C. BARBOUR

TEMP. 60°

TOWNSHIP WOODVILLE

GEYMAN

SECTION 28

DWG BY NIESE PID _____

T 6 N R 13 E

TYPE MONUMENT NAIL/SHINER

ON SURFACE - ~~BELOW~~ ON

OFFSET C PAVEMENT 2.1' LT : ~~RT~~

8.8' TO LT EDGE PAVEMENT

STATION: 158+28.5

HORZ.DATUM: _____

GEOID: _____

GRID: NORTHING: _____

EASTING: _____

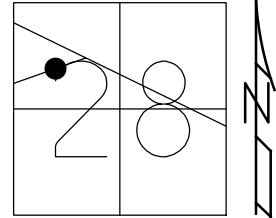

RECORD:
FD NAIL/SHINER
4/26/91, MB
SET P.K./WASHER
12/9/91, CH

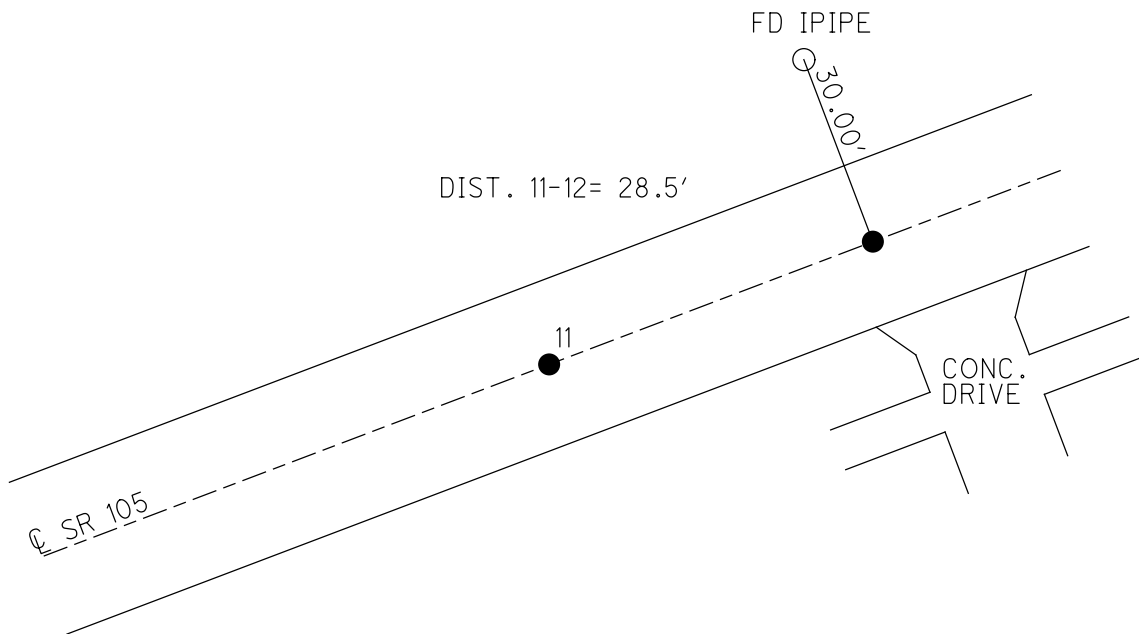

O.D.O.T. DISTRICT 2 SURVEY OFFICE

PERSONNEL

REFERENCE NO. _____

SHEET _____ OF _____

NOTES HEFFMAN

H.C. BARNHISEL

R.C. BARBEUR

GEYMAN

DATE 4-26-91

WEATHER OVERCAST

TEMP. 60°

ROUTE SR 105

COUNTY SANDUSKY

TOWNSHIP WOODVILLE

SECTION 28

T6 N R 13 E

TYPE MONUMENT NAIL 1/2" DIA

ON SURFACE - BELOW YES

LEFT - PAV'T. - RIGHT 2.1

8.8' TO LT EDGE PAVEMENT

S.L.M. 158+00.00

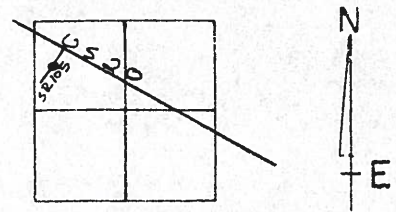

NOTE: THE SURVEY ON SR 105 ESTABLISHED BY USING SEVERAL PROPERTY CORNER MARKERS FOUND AT THE P.T. SOUTH ± SLM OF 151+97.3

