

#5024

For any Questions Please Contact ODOT District 2 Real estate at 419-353-8131

STATE OF OHIO  
 DEPARTMENT OF HIGHWAYS  
 SAN-300-(2.73-332)  
 SANDUSKY COUNTY  
 VILLAGE OF GIBSONBURG

FED. RD. DIVISION	STATE	PROJECT	TYPE FUNDS
2	OHIO		1950

SANDUSKY COUNTY  
 SAN - 300-(2.73 - 332)

**CONVENTIONAL**  
 COUNTY LINE  
 TOWNSHIP LINE  
 SECTION LINE  
 CORPORATION LINE  
 FENCE LINE  
 CENTER LINE  
 POLE LINE  
 RAILROAD

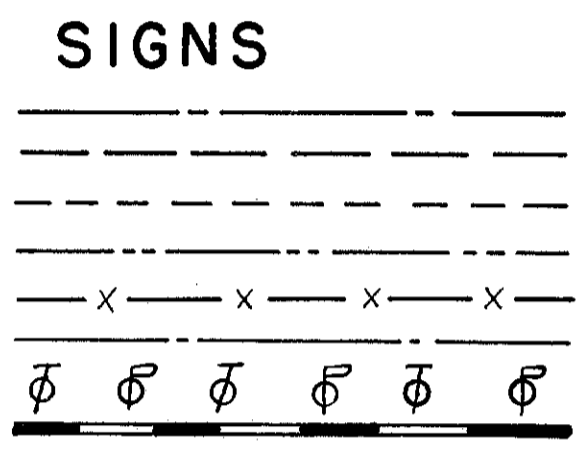

**INDEX OF SHEETS**

TITLE SHEET	1
TYPICAL SECTIONS	2
GENERAL SUMMARY	3
GENERAL NOTES	3
PAVEMENT COMPUTATIONS	3
PLAN & PROFILE	4-6

**LINE DATA**  
 BEGIN PROJECT STA. 143+84  
 END PROJECT STA. 184+90  
 GROSS LENGTH = 4,106 lin. ft.  
 DEDUCT FOR R.R's 39.21 + 7.60 = 46.81 lin. ft.  
 DEDUCT FOR INTERSECTION (SR 600) 45 lin. ft.  
 TOTAL DEDUCTIONS = 91.81 lin. ft.  
 NET LENGTH = 4,106 - 91.81 = 4,014.19 lin. ft. or 0.760 mi.

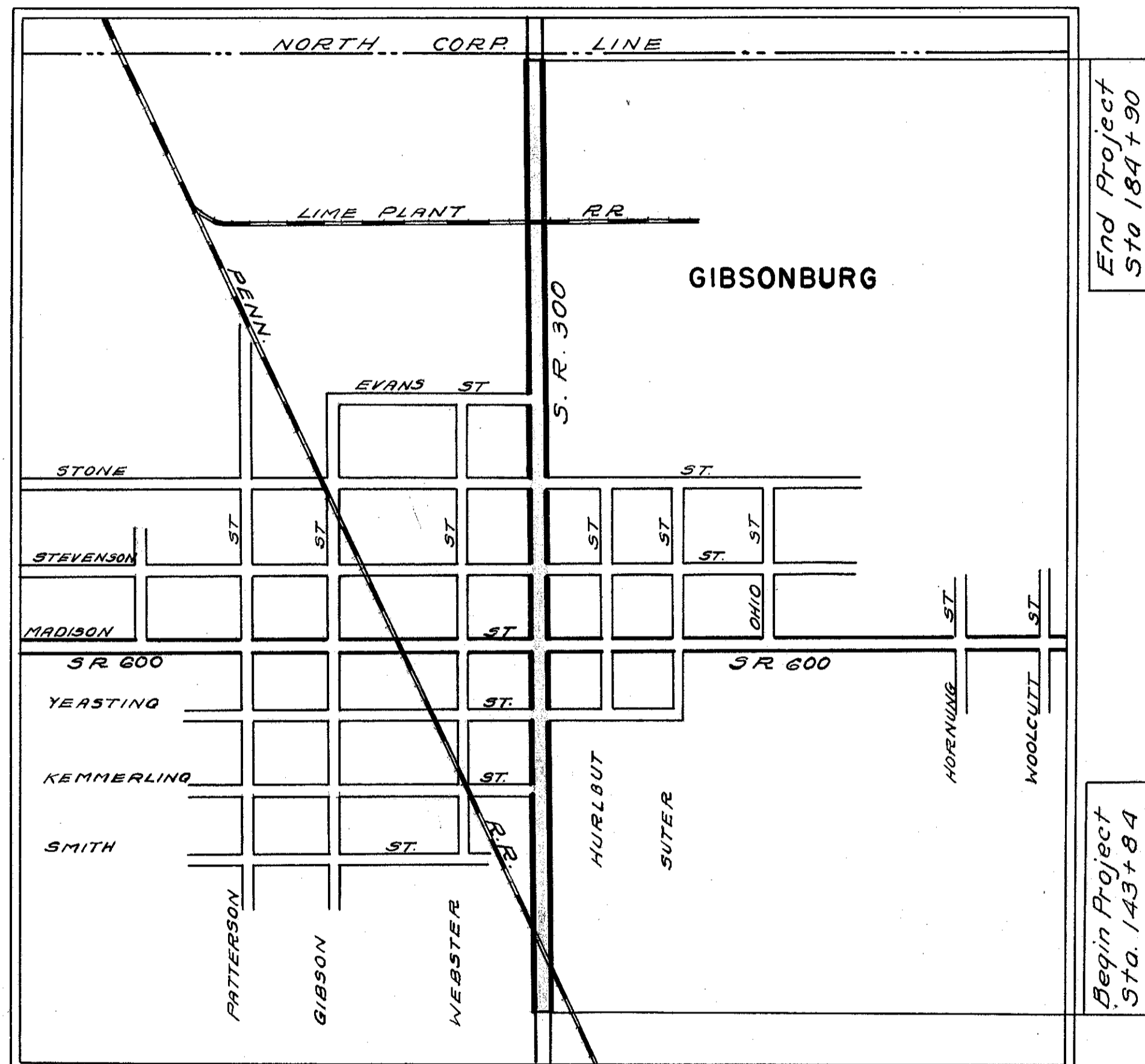

DELIVERY POINT - GIBSONBURG AVERAGE HAUL = 1/4 mile

**LOCATION PLAN**  
 Scale 1" = 500'

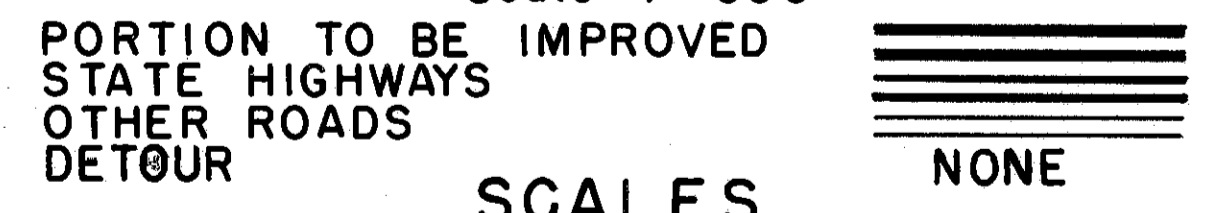

**SCALES**  
 PLAN 1" = 50'  
 PROFILE HORIZONTAL 1" = 50'  
 PROFILE VERTICAL 1" = 5'

The Standard Specifications of the State of Ohio, Department of Highways, including changes and Supplemental Specifications listed in the proposal shall govern this Project.

The Right of way necessary for this improvement will be provided by the State of Ohio.

I hereby approve these plans and declare that the making of this improvement will not require the closing to traffic of the Highway, and that provisions for the maintenance and safety of traffic will be as set forth on the plans and estimates.

Approved George H. Fisher  
 Date: 5-5-50 Division Deputy Director.

Approved \_\_\_\_\_  
 Date: \_\_\_\_\_ Chief Engineer, Bureau of Maintenance.

Approved Richard Orth  
 Date: 5-22-50 Chief Engineer, Bureau of Bridges & R.R. Crossings.

Approved H.L. Robinson  
 Date: \_\_\_\_\_ Chief Engineer, Bureau of Location & Design.

Approved V.J. Schaeffer  
 Date: 5-24-50 First Asst. Director & Chief Engineer.

Approved Waller  
 Date: 5-24-50 Director of Highways.

SUPPLEMENTAL SPECIFICATIONS		STANDARD DRAWINGS	
31	6-13-49	I-12	3-15-48

CONSTRUCTION BUREAU  
 JUL 13 1955  
 GROUND PHOTOLAB

FILE NO	SANDUSKY COUNTY
SEC	San-300-(2.73-332)
DATE OF LETTING	
CONTRACT NO	



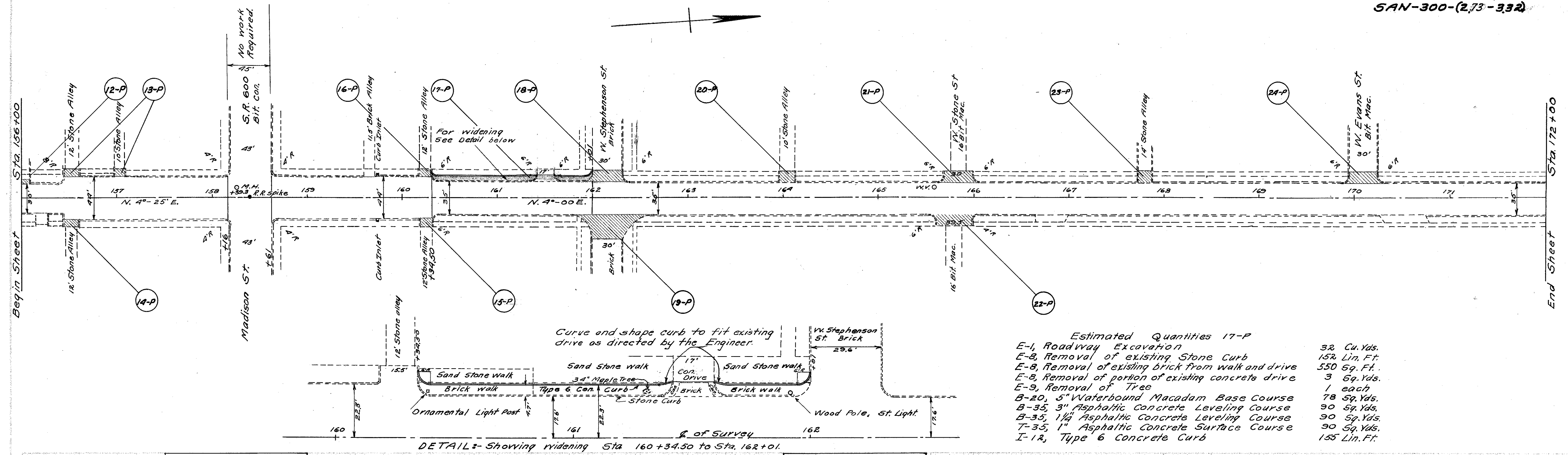

Estimated Quantities 17-P

E-1, Roadway Excavation	32 Cu. Yds.
E-2, Removal of existing Stone Curb	152 Lin. Ft.
E-3, Removal of existing brick from walk and drive	550 Sq. Ft.
E-4, Removal of portion of existing concrete drive	3 Sq. Yds.
E-5, Removal of Tree	1 each
B-20, 5" Waterbound Macadam Base Course	78 Sq. Yds.
B-35, 3" Asphaltic Concrete Leveling Course	90 Sq. Yds.
B-35, 1 1/4" Asphaltic Concrete Leveling Course	90 Sq. Yds.
T-35, 1" Asphaltic Concrete Surface Course	90 Sq. Yds.
I-12, Type 6 Concrete Curb	155 Lin. Ft.

DETAIL - Showing widening Sta 160+34.50 to Sta. 162+01.

B.M. 3 - Top W. nut in Light Standard S.E. Cor. Main & Madison. El. 686.97

B.M. 2 - R.R. spike in Power Pole S.W. cor Main & Stone St. El. 686.91

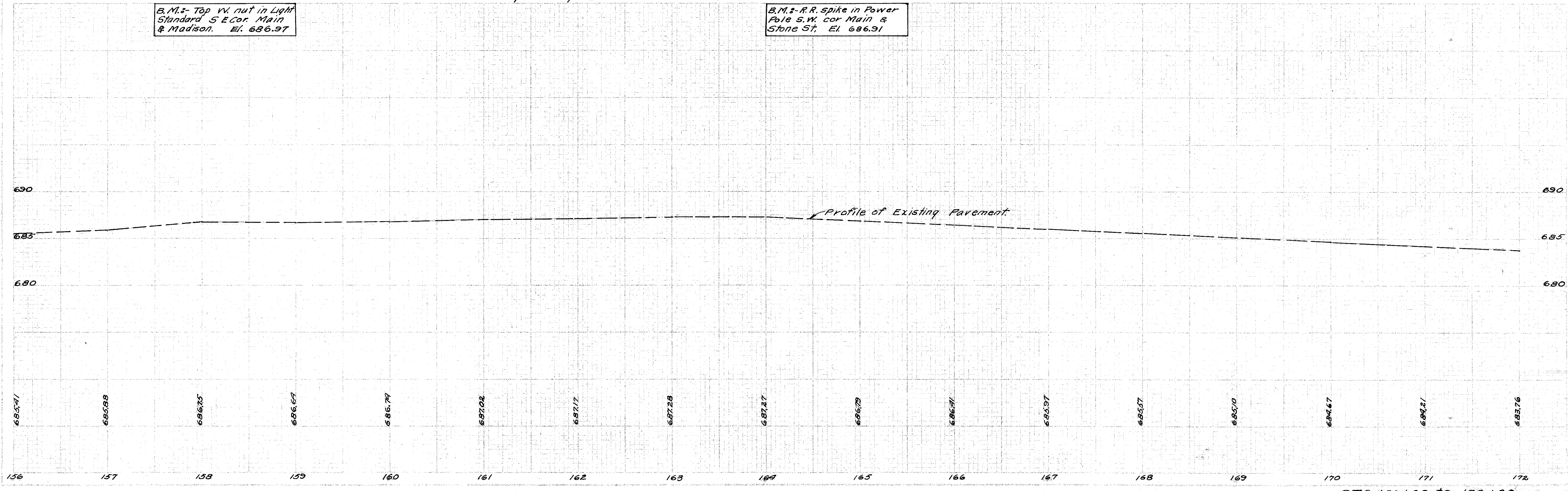

STA. 156+00 TO 172+00

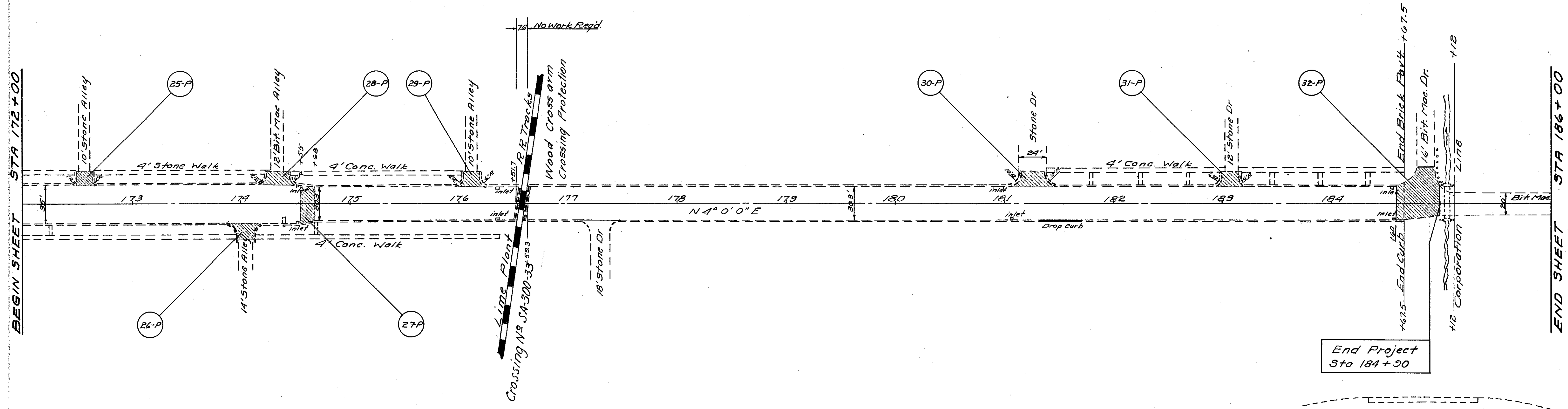
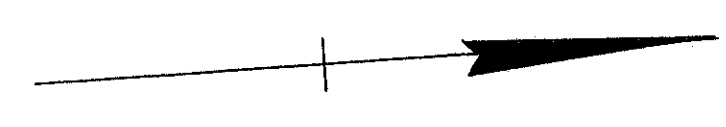

End Project  
Sta 184+50

Typical Section of adjoining Pavement  
20 Ft. Bituminous Macadam.

BM. R.R. Spk. in P.P.  
Sta 174+19 Lt. El. 683.48

BM. S.E. Bolt + Fire Hyd.  
Sta 180+99 Lt. El. 683.05

BM. R.R. Spike in P.P.  
Sta 184+59 Lt. El. 679.49

