

O.D.O.T. DISTRICT 2 SURVEY OFFICE (USE ONLY)

PERSONNEL

REFERENCE NO. 5 A

SHEET 7 OF 22

NOTES RHOADES

DATE 4/16/13

ROUTE SR 300

H.C. CODER

WEATHER RAIN

COUNTY SANDUSKY

R.C. RHOADES

TEMP. 51°

TOWNSHIP MADISON

SECTION 23

T 5 N R 13 E

TYPE MONUMENT FD P.K./WASHER

~~ON SURFACE~~ - BELOW 2.5"

~~LEFT - C PAV'T - RIGHT~~ ON

10.2 TO LT EDGE PAVEMENT

S.L.M. 115+41

Grid: Northing: 622603.748 Easting: 1743290.752

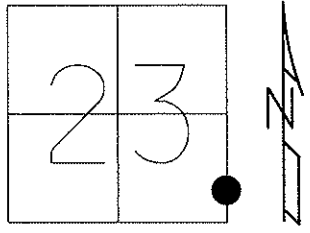

SET NAIL/SHI  
9/16/94 M.C.

FD P.K./WASHER  
2/3/09, 5/10/00, RESUF.  
10/7/10 KPM

GPS & TIED  
3/2/11 KPM

SET MAG/WASHER  
GPS, FINREFA5  
6/4/13, SDC

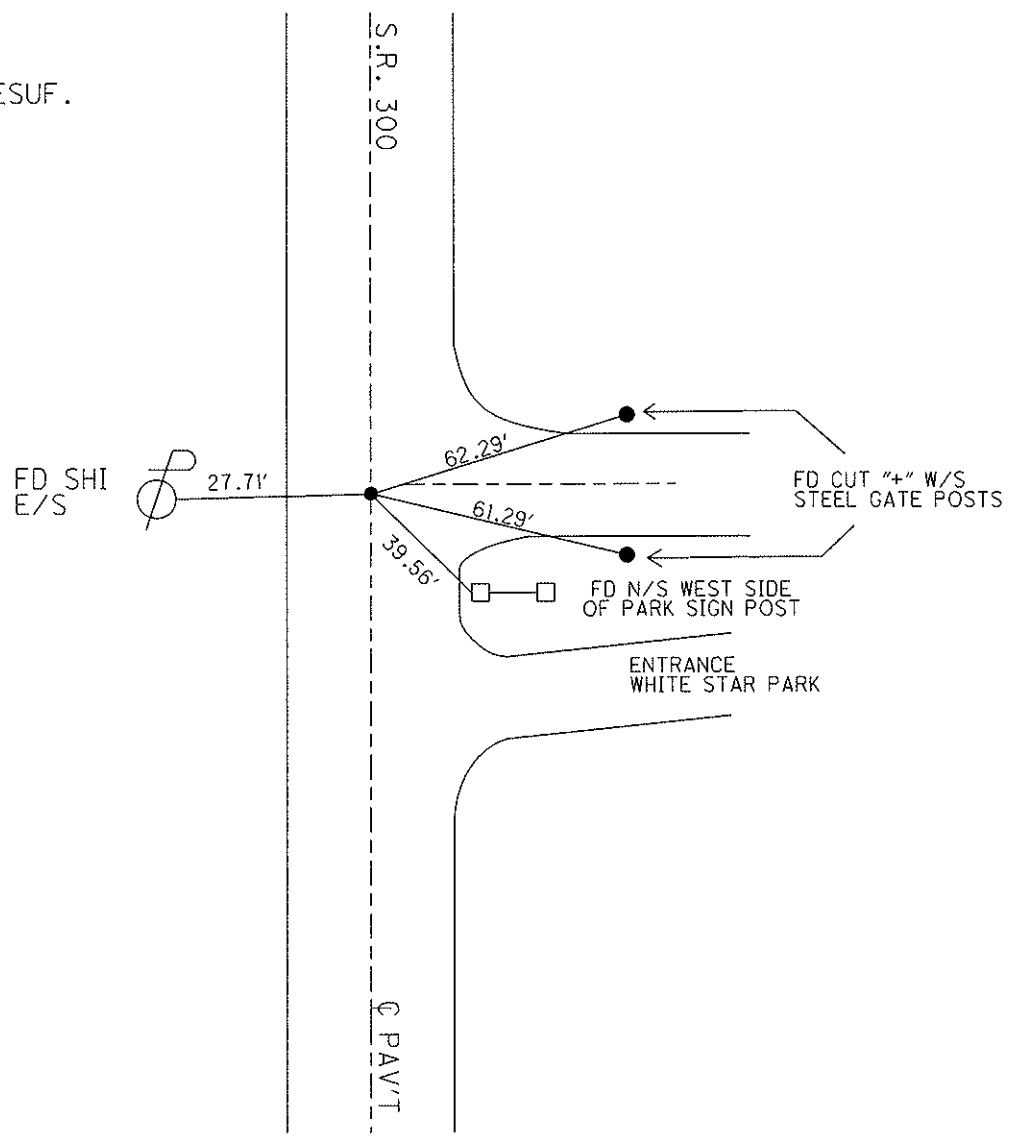

O.D.O.T. DISTRICT 2 SURVEY OFFICE

PERSONNEL

REFERENCE NO. 5-A

SHEET 6 OF 17

NOTES MOSER

DATE 10/7/10

ROUTE SR 300

H.C. GOLDBERG

WEATHER CLOUDY

COUNTY SANDUSKY

R.C. HARBAUGH

TEMP. 75°

TOWNSHIP MADISON

SECTION 23

T 5 N R 13 E

TYPE MONUMENT FD P.K./WASHER

ON SURFACE - ~~BELOW~~ ON

LEFT - C PAV'T - RIGHT ON

10.2 TO LT EDGE PAVEMENT

S.L.M. 115+41

Grid: Northing: \_\_\_\_\_ Easting: \_\_\_\_\_

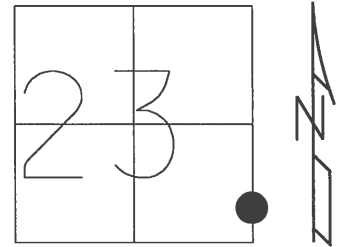

SET NAIL/SHI  
9/16/94 M.C.

FD P.K./WASHER  
2/3/09, 5/10/00, RESUF.  
10/7/10 KPM

