

O.D.O.T. DISTRICT 2 SURVEY OFFICE (USE ONLY)

PERSONNEL

REFERENCE NO. 8 AC

SHEET 13 OF 22

NOTES NIESE

DATE 4/22/21

ROUTE SR 300

H.C. AUBLE

WEATHER SUNNY

COUNTY SANDUSKY

R.C. NIESE

TEMP. 37°

TOWNSHIP MADISON

SECTION 14

DWG BY NIESE

PID CHIP SEAL

T 5 N R 13 E

TYPE MONUMENT MAG/WASHER

ON SURFACE - ~~BELOW~~ ON

OFFSET Q PAVEMENT ON LT : RT

11.5' TO LT EDGE PAVEMENT

STATION: 189+91.50

HORZ.DATUM: NAD83(2011)

GEOID: 2018

GRID: NORTHING: 630010.329

EASTING: 1743582.075

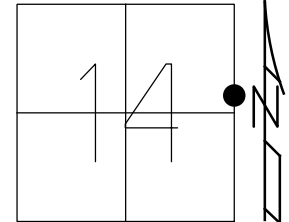

RECORD:
 SET P.K./WASHER
 9/16/94, M.C.
 FD P.K./WASHER
 2/2/09
 5/10/00
 5/19/10, KPM
 3/2/11, KPM
 FD P.K. NAIL
 4/16/13, SDC
 SET MAG/WASHER
 6/4/13, SDC
 FD MAG/WASHER
 REFAC8
 4/22/21, DSA
 10/6/21, JFO

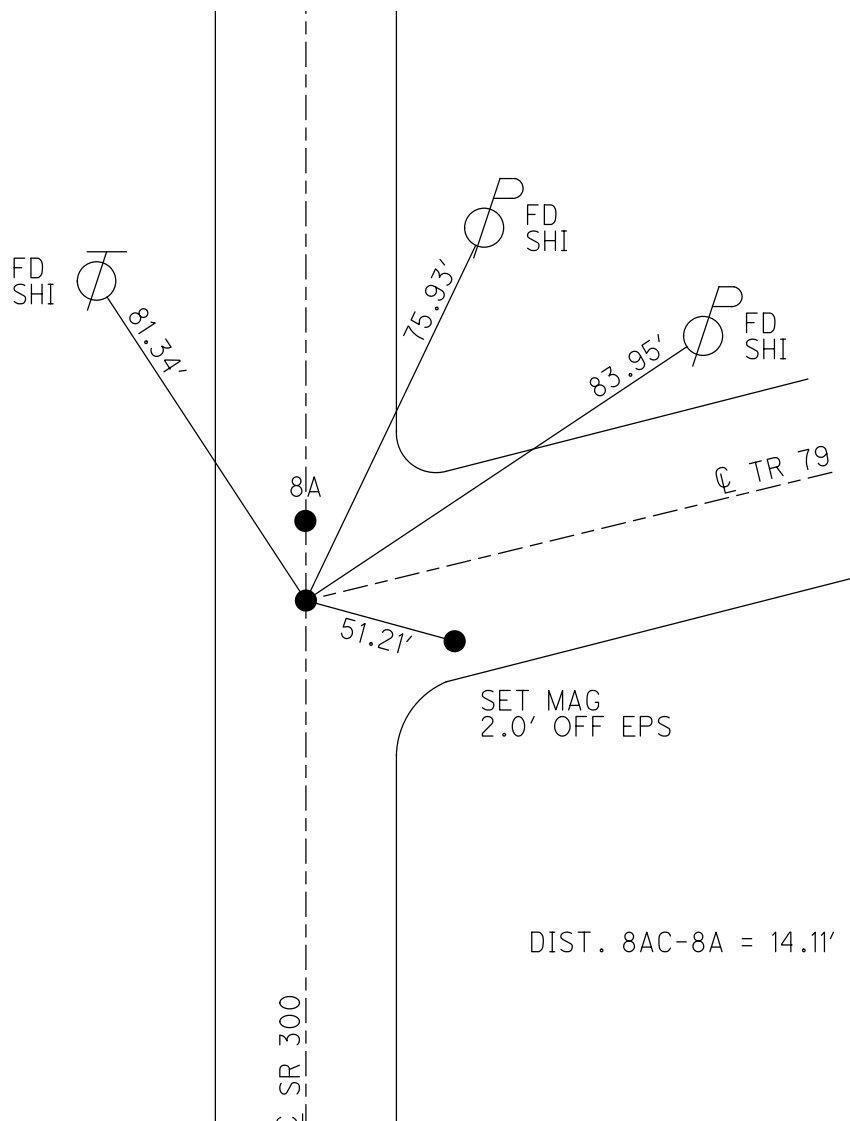

O.D.O.T. DISTRICT 2 SURVEY OFFICE (USE ONLY)

PERSONNEL _____ REFERENCE NO. 8 AC SHEET 13 OF 22
 NOTES RHOADES DATE 4/16/13 ROUTE SR 300
 H.C. CODER WEATHER CLOUDY COUNTY SANDUSKY
 R.C. RHOADES TEMP. 56° TOWNSHIP MADISON
 _____ SECTION 14
 _____ T 5 N R 13 E

TYPE MONUMENT FD P.K.NAIL
 ON SURFACE - ~~BELOW~~ ON
 LEFT - C PAV'T - ~~RIGHT~~ ON
11.5' TO LT. EDGE PAVEMENT
 S.L.M. 189+91.5'

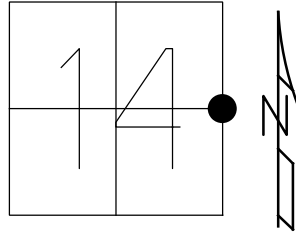

GRID: NORTHING: 630010.247 EASTING: 1743581.985

SET P.K./WASHER
 9/16/94 M.C.

FD P.K./WASHER
 2/2/09, 5/10/00, RESRF.
 5/19/10 KPM

GPS & TIED
 3-2-11, KPM

SET MAG/WASHER
 GPS, FINREF8
 6/4/13, SDC

