

O.D.O.T. DISTRICT 2 SURVEY OFFICE (USE ONLY)

PERSONNEL _____ REFERENCE NO. 5 A SHEET 20 OF 33
 NOTES LEU DATE 09-23-2014 ROUTE SR 412
 H.C. HOMAN WEATHER SUNNY COUNTY SANDUSKY
 R.C. LEU TEMP. 72° TOWNSHIP RILEY
 _____ SECTION 28
 _____ T 5 N R 16 E

TYPE MONUMENT MONBOX, 1" I. PIN
 ON SURFACE - ~~BELOW~~ ON _____
 LEFT - ☉ PAV'T - RIGHT 6'
3.5' TO LT. EDGE PAVEMENT
 S.L.M. 141+13.82

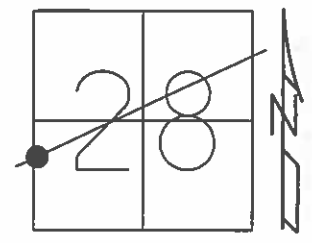

Grid: Northing: 618707.753 Easting: 1822612.448

RECORD: 10-11-1984
 105+33.70 (S.H. 281 SEC. T, BR.)
 (1932) SET PK & WASHER ATOP
 BOAT SPIKE 7.0± LT. ☉ PAVEMENT

SET P.K./WASHER
 8/2/93, JLR

FD MONBOX
 REF15
 12/6/12, SDC

FD MONBOX
 W/ 3/4" IPIN
 NEWREFA5
 6/30/15, DCH

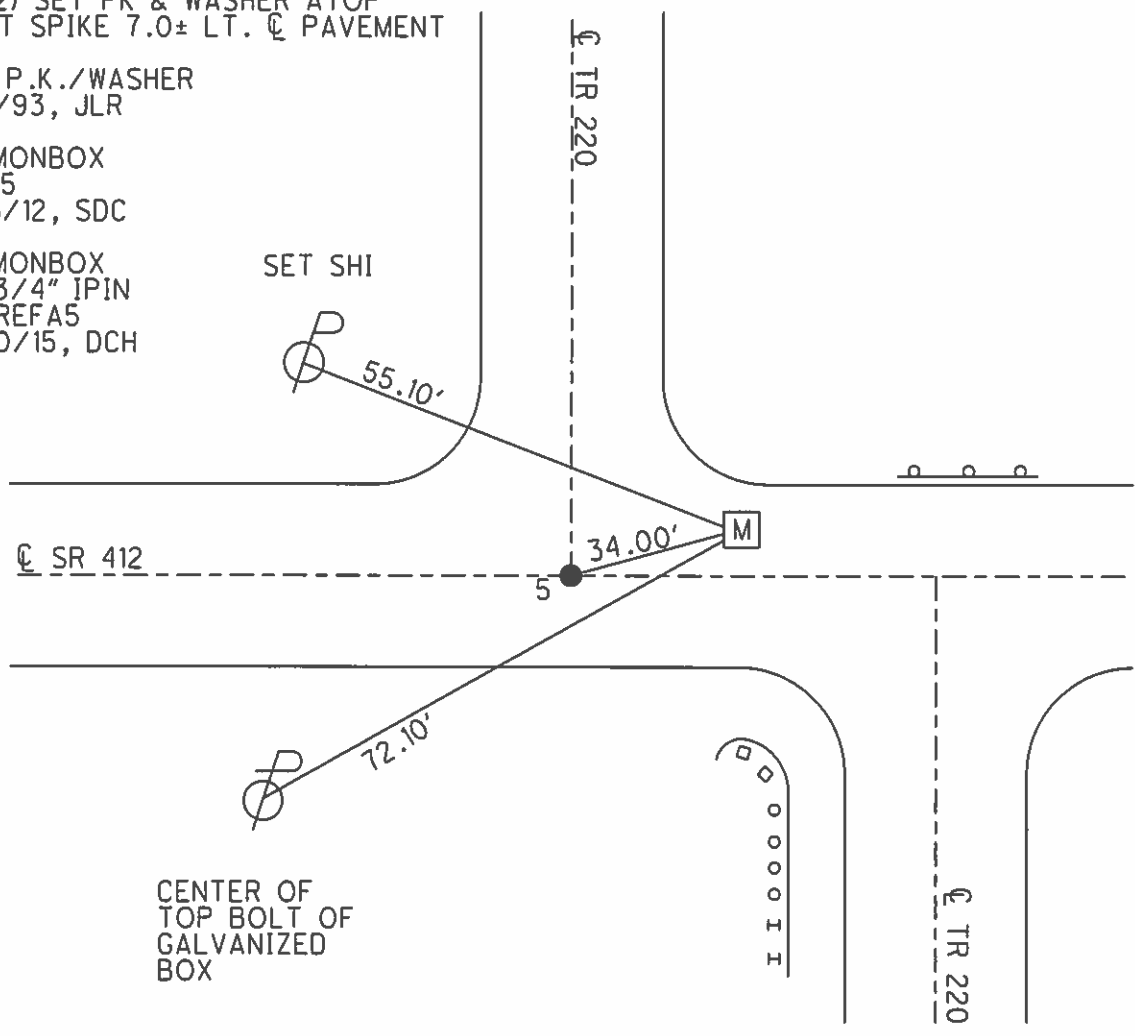

O.D.O.T. DISTRICT 2 SURVEY OFFICE

PERSONNEL

REFERENCE NO. 5-A

SHEET 14 OF 21

NOTES CHENEY

H.C. RIPPLE

R.C. BARBOUR

GEYMAN

DATE 4-28-93

WEATHER PART SUNNY

TEMP. 55°

ROUTE SR#412

COUNTY SANDUSKY

TOWNSHIP RILEY

SECTION 28

T. 5 N. R. 16 E.

TYPE MONUMENT Fd. P.K. & WASHER
 ON SURFACE - ~~BELOW~~ ON
 LEFT - & PAV'T. - ~~RIGHT~~ 6.5'
3.5' TO LT. EDGE PAVEMENT
 S.L.M. 140+23

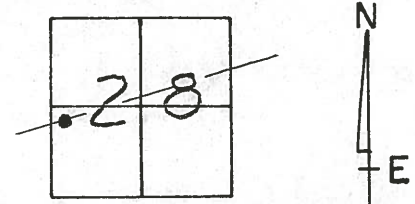

Record: 10-11-84
105+33.70 (S.H. 281 Sec. T, BR.)
(1932) Set P.K. & Washer ATop
Boat Spike 7.0'± LT. & Pavement

Note: Set P.K. & Washer
8-2-93 JLR.

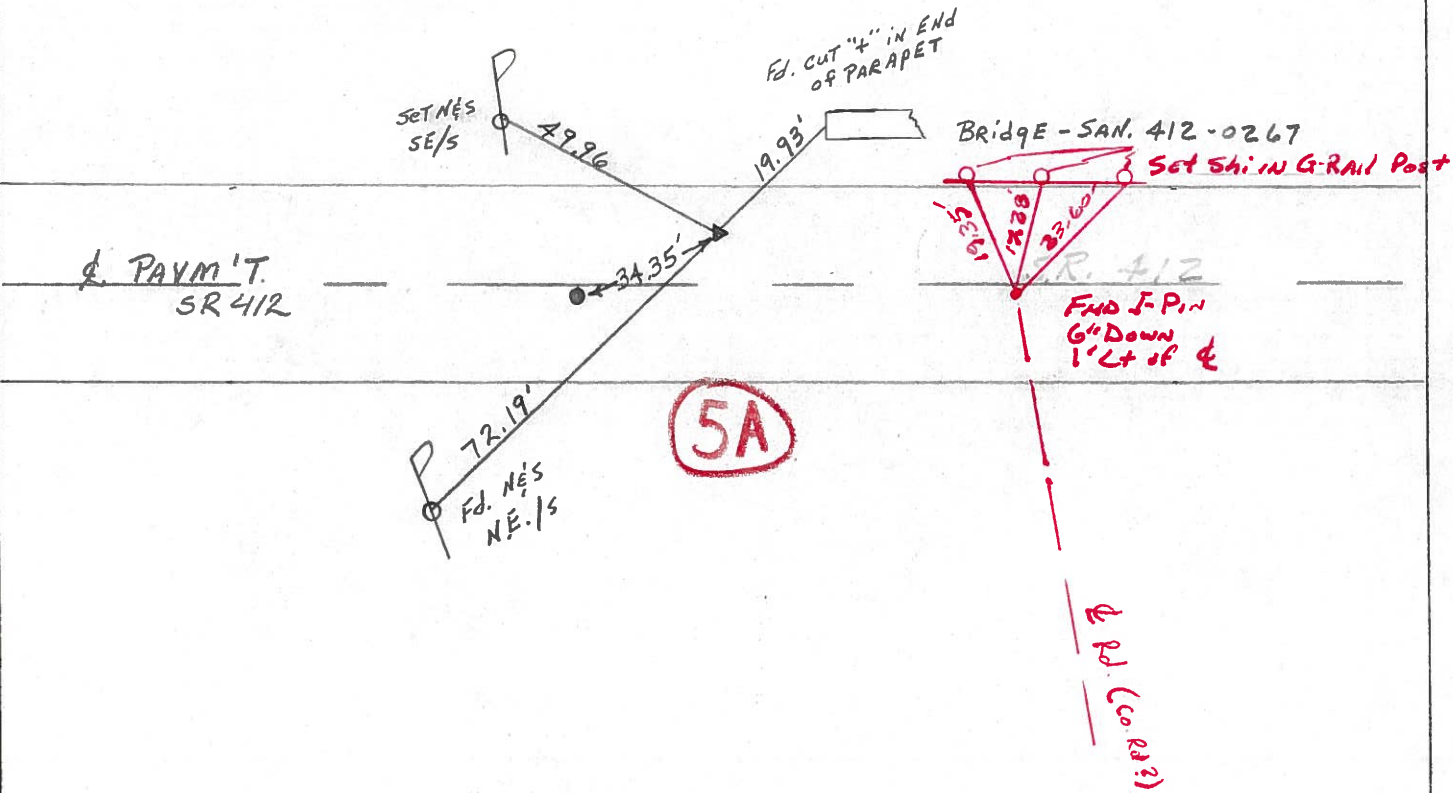

Preventive Maintenance
 Microsurfaced 2000
 Existing Point Uncovered
 Date 7-24-2000

ODOT DISTRICT 2 SURVEY OFFICE

SHEET 11 OF

County Sandusky S.R. #412

Date 10/11/84

Township Riley

Weather sunny

Section 28

Temp. 60°

T5N, R16E

Personnel Cronin

Ripple

Geyman

Barbour

5A

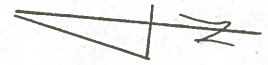
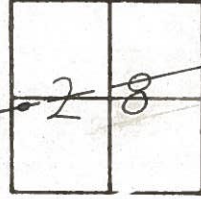

105+33.70 (S.H. 281 Sec. T1
Br.) (1932) Set PK&W washer
atop boat spike 7.0 ± Lt.
& Pavement

cut in end of
parapet

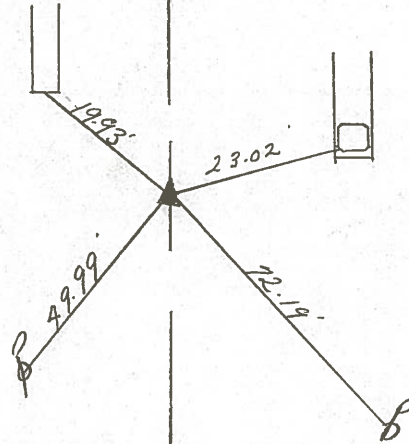

Bridge - San. 412-02.67

S.R. #412

