

O.D.O.T. DISTRICT 2 SURVEY OFFICE (USE ONLY)

PERSONNEL _____

REFERENCE NO. 12

SHEET 4 OF 32

NOTES AUBLE

DATE 5/1/18

ROUTE SR 412

H.C. LEU

WEATHER SUNNY, BREEZY

COUNTY SANDUSKY

R.C. AUBLE

TEMP. 71°

TOWNSHIP RILEY

DWG BY NIESE

PID 95765

SECTION 25

T 5 N R 16 E

TYPE MONUMENT P.K./WASHER

ON SURFACE - ~~BELOW~~ ON

OFFSET ☉ PAVEMENT ON LT : RT

8.8' TO RT EDGE PAVEMENT

STATION: 326+64.86

HORIZ.DATUM: NAD83(2011)

GEOID: 2012A

GRID: NORTHING: 620913.557

EASTING: 1841134.299

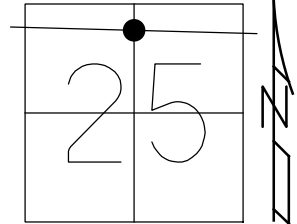

RECORD: P.I.
 STA.26+72.65
 FD P.K./WASHER
 ATOP P.K./WASHER
 ATOP BOAT SPIKE/WASHER
 SEC.#1-FIELD BOOK#53
 SET P.K./WASHER
 8-31-01, SAH
 FD P.K./WASHER
 UNDER BRIDGE
 REF12
 6/23/15, DCH
 SET PAINT MARK
 REF12
 8-21-19, JFO

FD '+' CUT
 6TH COLUMN
 FR/WEST
 TURNPIKE BR.

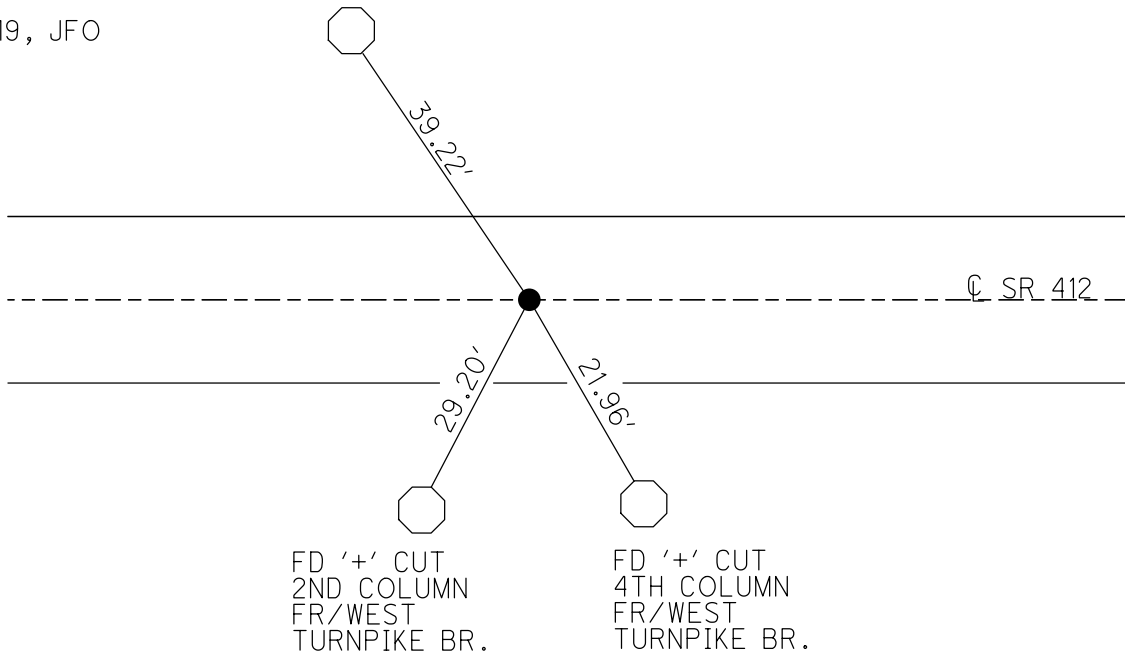

O.D.O.T. DISTRICT 2 SURVEY OFFICE (USE ONLY)

PERSONNEL _____ REFERENCE NO. 12 SHEET 4 OF 34
 NOTES LEU DATE 06-23-2015 ROUTE SR 412
 H.C. LEU WEATHER CLOUDY COUNTY SANDUSKY
 R.C. HOMAN TEMP. 80°F TOWNSHIP RILEY
 _____ SECTION 25
 _____ T 5 N R 16 E

TYPE MONUMENT PK & WASHER, UNDER BRIDGE

ON SURFACE - ~~BELOW~~ ON _____

~~LEFT~~ - ☐ PAV'T - ~~RIGHT~~ ON _____

8.8' TO RT. EDGE PAVEMENT

S.L.M. 327+08

Grid: Northing: _____ Easting: _____

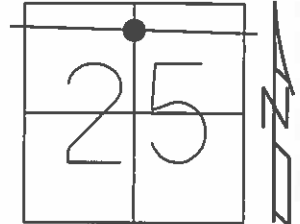

REC:
 P.I.
 26+72.65
 PK & WASHER ATOP SAME
 ATOP BOAT SPIKE & WASHER
 SEC. #1-FIELD BOOK # 53

SET PK & WASHER
 08-31-2001 S.R.H.

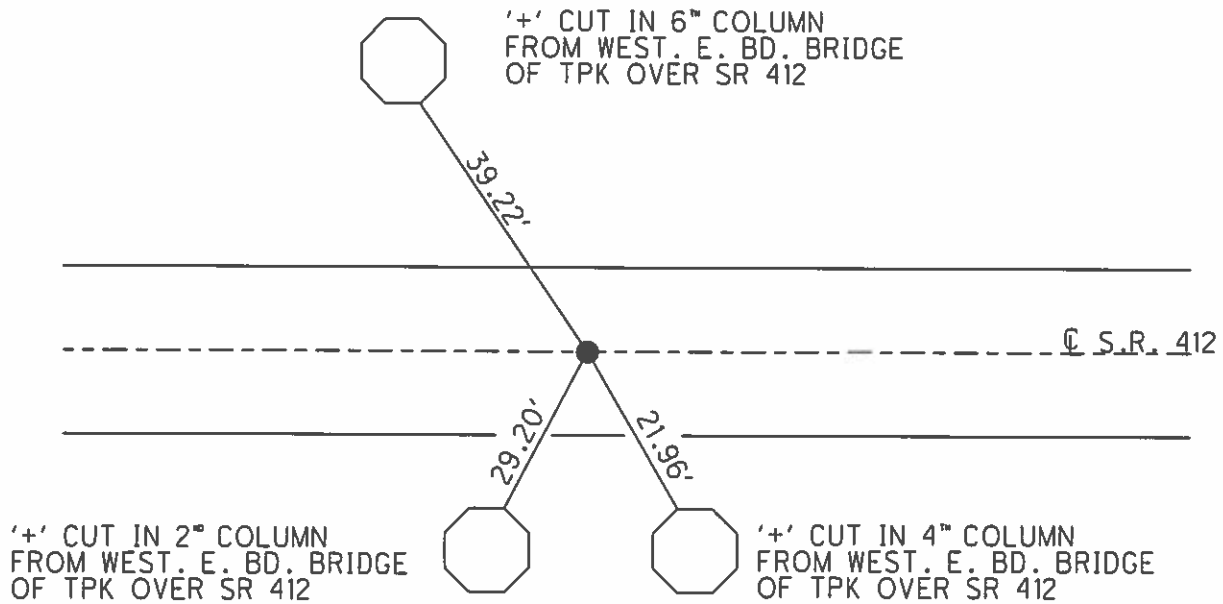

O.D.O.T. DISTRICT 2 SURVEY OFFICE

PERSONNEL

REFERENCE NO. 12

SHEET 4 OF 11

NOTES TED ROUSOS

H.C. VAN DUSEN

R.C. ADAM B.

DATE 7-05-01

WEATHER SUNNY

TEMP. +75° F

ROUTE 412

COUNTY SANDUSKY

TOWNSHIP RILEY

SECTION 25

T5 N R 16 E

TYPE MONUMENT PK/WASHER

ON SURFACE - BELOW YES

~~LEFT~~ & PAV'T. - RIGHT YES

8.8 TORT. EDGE PAVEMENT

S.L.M. 327+08

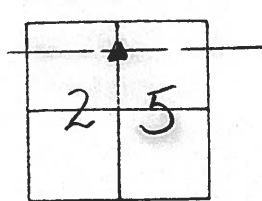

REC'
P.I.
26+72.65
PK & WASHER ATOP. SAME
ATOP BOAT SPIKE & WASHER
SEC. # 1 - FIELD BO'OK # 53

SET PK & WASHER
8-31-01
S.R.H.



+ CUT IN 5th Column
FROM WEST-E. RD. BRIDGE
OF TPK OVER SR 412

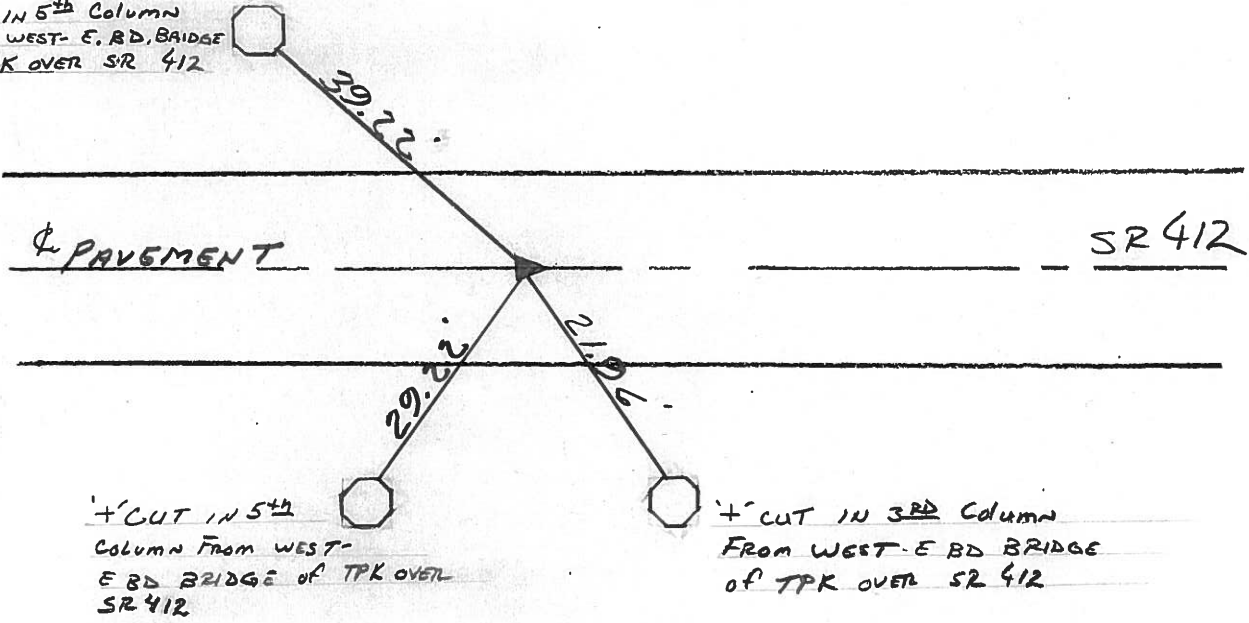

+ CUT IN 5th
Column FROM WEST-
E RD BRIDGE OF TPK OVER
SR 412

+ CUT IN 3rd Column
FROM WEST-E RD BRIDGE
OF TPK OVER SR 412

O.D.O.T. DISTRICT 2 SURVEY OFFICE

5

PERSONNEL _____

REFERENCE NO. 12

SHEET _____ OF _____

NOTES CRONIN (DRAW)

DRAWN 3/08/89

H.C. RIPPLE

DATE 11/01/89

ROUTE #412

R.C. BARBOUR

WEATHER SUNNY

COUNTY SANDUSKY

GEYMAN

TEMP. 50°

TOWNSHIP RILEY

SECTION 25

T 5 N R 16 E

TYPE MONUMENT P.K. & WASHER

ON SURFACE - BELOW _____

LEFT - PAV'T. - RIGHT _____

TO _____ EDGE PAVEMENT

S.L.M. 26+72.65t

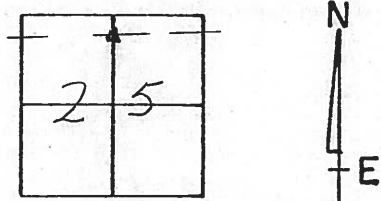

P.I.

26+72.65

P.K. & WASHER ATOP SAME

ATOP BOAT SPIKE & WASHER

SEC. #1 - FIELD BOOK #53

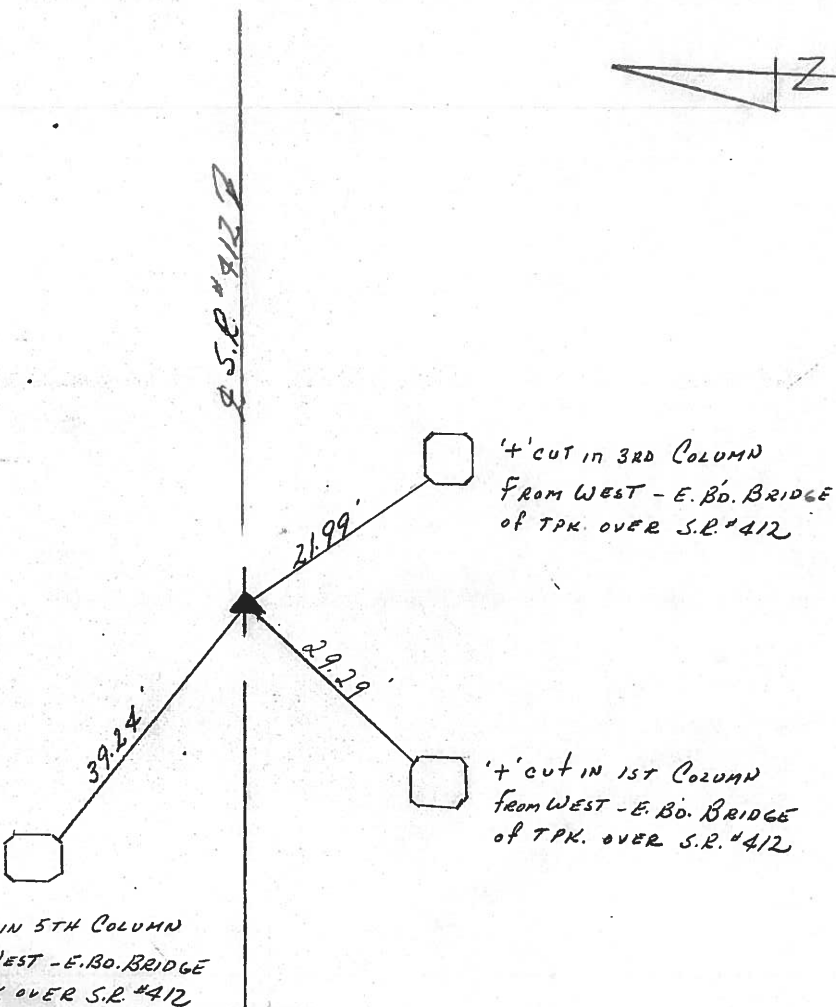

County SANDUSKY S.R. 412

Date 7/13/81

Township RILEY

Weather OVERCAST-HUMID

Section # 25

Temp. 80°

T5N, R16E

Personnel CRONIN
RIPPLE
GEYMAN
MOSSER
BARBOUR

#12

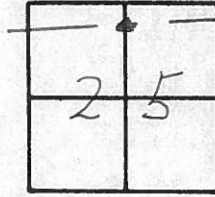

P.I
26+ 72.65
Reset P.K. Nail & washer
at top bolt spike & washer
Sec #1 Field Book # 53

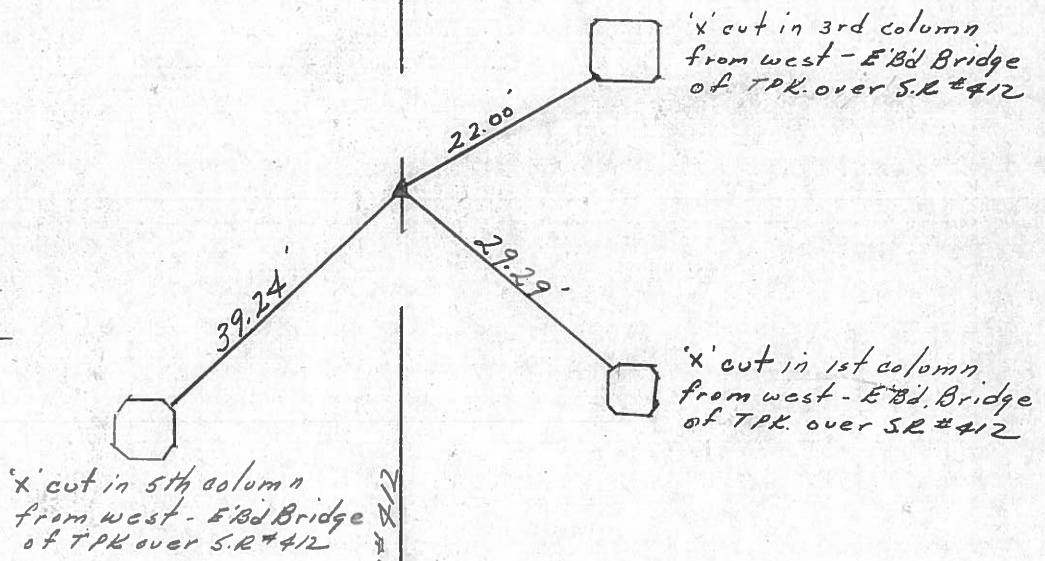

PERSONNEL TITLE PERSONNEL TITLE

Cronin

Schneider

COUNTY Sandusky

Tied 2/4/75

DATE Drawn-2/3/75

Ash

Mosser

S. R. # 412

WEATHER overcast

Rippe

Barbour-S.L.

SEC. #1 - Field Bk #53

TEMP. 30°

Geyman-S.L.

DESCRIPTION Ties for Control Points

JOB NO.

LEFT

CENTER LINE

RIGHT

Riley Township

sec. 25



12



12

x cut in 3rd column from West-Eastbound bridge over Turnpike

P.I.

26+72.65

Set small spike using Field Bk. information & State of Ohio L/W markers

x cut in 5th column from West-Eastbound bridge over Turnpike

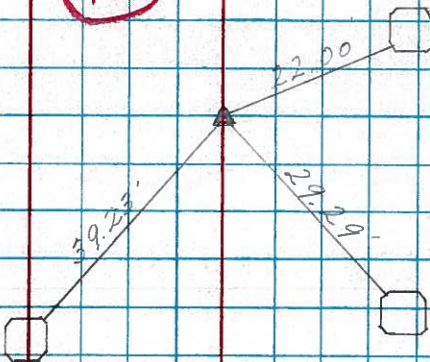

x cut in 1st column from west-Eastbound bridge over Turnpike

S.S.R. # 412

P.I.

13+35 ±

1/4 mi. East of S.R. # 510

Set iron pipe 6" below surface.

Set iron pipe at top of the surface

State of Ohio conc. L/W marker

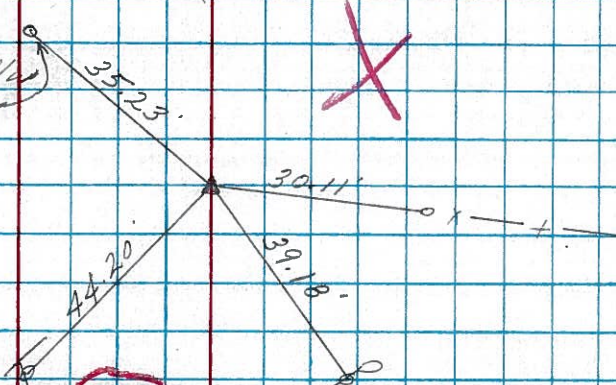

11A

sec. 25