

O.D.O.T. DISTRICT 2 SURVEY OFFICE (USE ONLY)

PERSONNEL _____ REFERENCE NO. 26 A SHEET 22 OF 34
 NOTES HOMAN DATE 06-25-2015 ROUTE SR 412
 H.C. HOMAN WEATHER CLOUDY COUNTY SANDUSKY
 R.C. LEU TEMP. 69°F TOWNSHIP TOWNSEND
 _____ SECTION 23
 _____ T 5 N R 17 E

TYPE MONUMENT MAG & WASHER
 ON SURFACE - ~~BELOW~~ ON _____
~~LEFT~~ - CL PAV'T - ~~RIGHT~~ ON _____
9.8' TO RT EDGE PAVEMENT
 S.L.M. 599+57

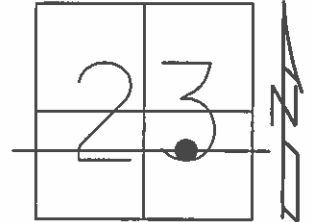

Grid: Northing: 623639.340 Easting: 1868083.362

REC: 09-09-1982
 P.O.T. 0.6 MI. E. OF CR# 302
 POINT WAS SET BY SPLITTING
 PAV'T. NOTHING ELSE AVAILABLE.
 RR SPK. 0.1'± BELOW SURFACE.

RESET MAG & WASHER
 06-03-2003 M.D.B.

UNCOVERED MAG & WASHER
 09-17-2015 D.C.H.

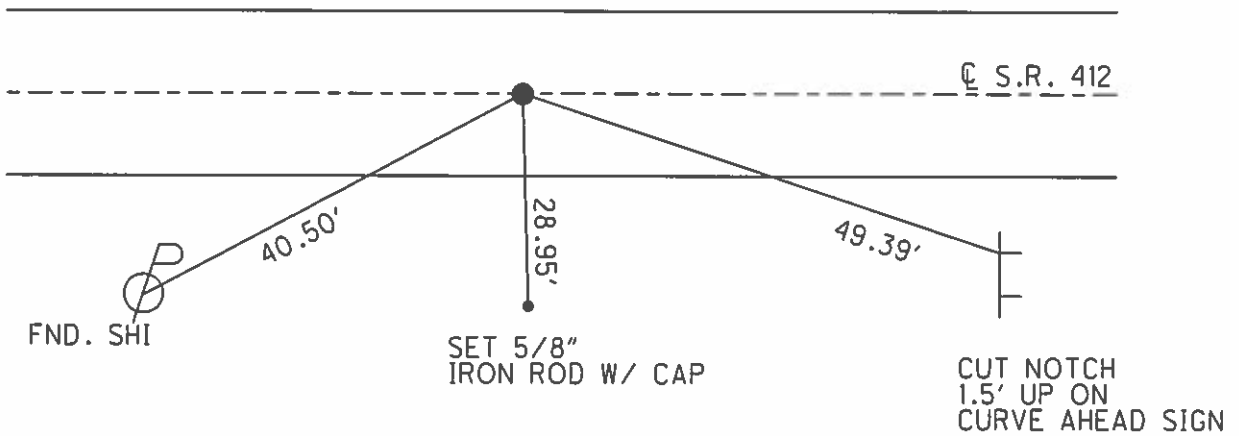

O.D.O.T. DISTRICT 2 SURVEY OFFICE

PERSONNEL

REFERENCE NO. 26-A

SHEET 7 OF 16

NOTES Barnhisel

DATE 4-10-03

ROUTE S.R. 412

H.C. Canterberry

WEATHER Cloudy

COUNTY SANDUSKY

R.C. Brumbaugh

TEMP. +35°

TOWNSHIP TOWNSEND

SECTION 23

T 5 N R 17 E

TYPE MONUMENT P.K. Mag & Washer

ON SURFACE ~~-BELOW~~ on surface

~~LEFT~~ - Q PAV'T ~~-RIGHT~~ on Q

9.8 TO RT EDGE PAVEMENT

S.L.M. 599+57

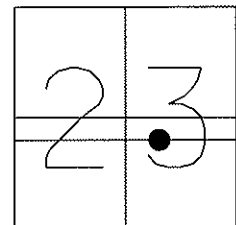

Record: 09-09-1982
 P.O.T. 0.6 Mi. E. of CR# 302
 Point ~~was~~ set ~~by~~ splitting
 pav't. Nothing else available.
 RR Spk. 0.1' +/- below surface.

RESET MAG & WASHER
 06/03/03
 MDB

