

O.D.O.T. DISTRICT 2 SURVEY OFFICE (USE ONLY)

PERSONNEL

REFERENCE NO. 13 C

SHEET 26 OF 33

NOTES RHOADES

DATE 2/27/18

ROUTE SR 590

H.C. O'DONNELL

WEATHER SUNNY

COUNTY SANDUSKY

R.C. SEAMAN

TEMP. 42°

TOWNSHIP WASHINGTON

DWG BY MILLER PID 101240

SECTION 34

T 5 N R 14 E

TYPE MONUMENT MAG/WASHER

ON SURFACE - ~~BELOW~~ ON

OFFSET CL PAVEMENT 11.1' ~~LT~~ : RT

0.6' TO RT EDGE PAVEMENT

STATION: 353+21

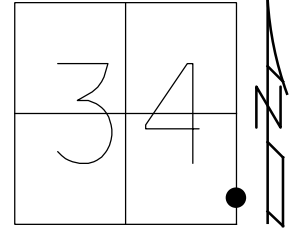

HORZ.DATUM: NAD83-2011

GEOID: NAVD88-2012A

GRID: NORTHING: 611623.630

EASTING: 1769732.983

FD NOTCH
1.5' UP
SIGN

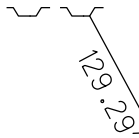

SR 590

RECORD: P.I.
FD P.K./WASHER
ATOP P.K./WASHER
ATOP R.R.SPIKE
SET P.K./WASHER
10/07/96, MB
FD P.K./WASHER
7/19/10
SET MAG/WASHER
10/28/10, MC
FD MAG/WASHER
REFC13
2-27-18, 4-23-18
10-4-18, JFO

SET BARN
SPIKE
5.88'

FD NOTCH
1.5' UP
SIGN



O.D.O.T. DISTRICT 2 SURVEY OFFICE (USE ONLY)

PERSONNEL _____ REFERENCE NO. 13 C SHEET 25 OF 33
 NOTES CANTERBURY DATE 11/01/10 ROUTE SR 590
 H.C. HUSS WEATHER SUNNY COUNTY SANDUSKY
 R.C. FINGER TEMP. +39° TOWNSHIP WASHINGTON
 _____ SECTION 34
 _____ T 5 N R 14 E

TYPE MONUMENT _____ PK/WASHER _____
 ON SURFACE - ~~BELOW~~ _____ ON _____
~~LEFT - C PAV'T~~ - RIGHT 11.1'
0.6' TO RT EDGE PAVEMENT
 S.L.M. _____ 353+21

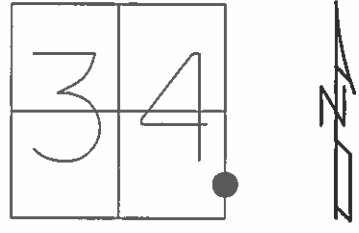

GRID: NORTHING: 611623.673 EASTING: 1769732.882

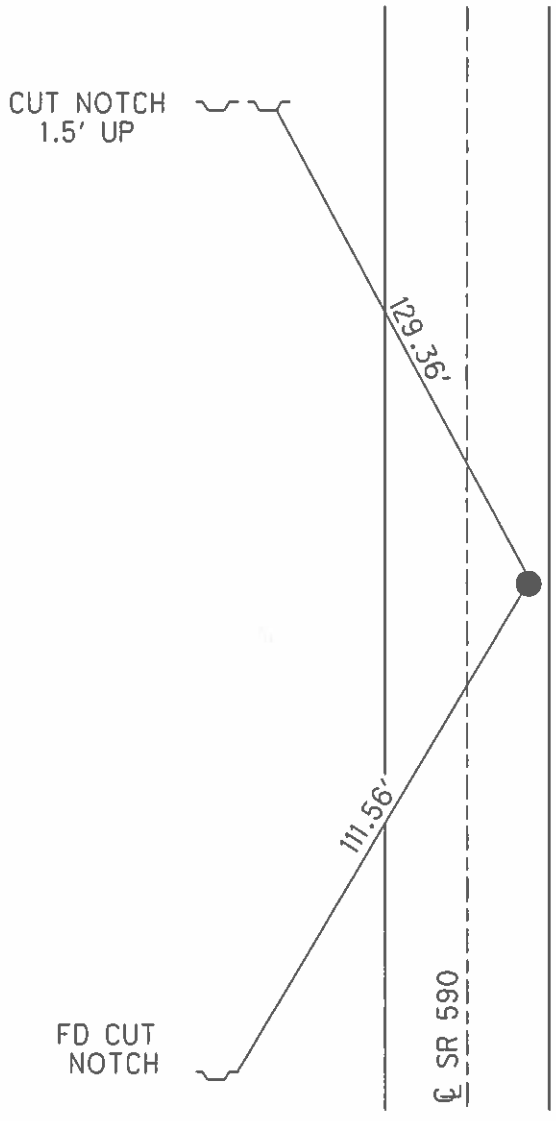

RECORD: PI
 PK/WASHER ATOP PK/WASHER
 ATOP RR SPK
 SET PK/WASHER 10/07/96 MB
 SET MAG/WASHER 10/28/10 EF

O.D.O.T. DISTRICT 2 SURVEY OFFICE

PERSONNEL _____

REFERENCE NO. _____

SHEET 2 OF 10

NOTES CORDES

H.C. ROUSOS

R.C. HANES

BARNHISEL

DATE 8-7-96

WEATHER SUNNY

TEMP. + 82°F

ROUTE 590

COUNTY SANDUSKY

TOWNSHIP WASHINGTON

SECTION 34

T. 5 N. R. 14 E

TYPE MONUMENT PK & WASHER

~~SURFACE~~ SURFACE - BELOW 1.5"

~~PAV'T.~~ PAV'T. - RIGHT 11.1"

0.6' TO RT. EDGE PAVEMENT

S.L.M. 353 + 21

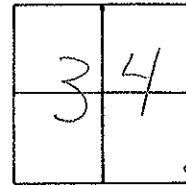

RECORD: P.I.
PK & WASHER ATOP SAME
ATOP RR SPIKE

SET PK & WASHER
10-7-96
BYC

"STOP AHEAD"
SIGN

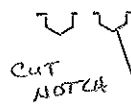

129.31

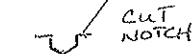

"JCT"
6

111.56

S.R. 590

Q. PAV'T.

O.D.O.T. DISTRICT 2 SURVEY OFFICE

PERSONNEL

REFERENCE NO. _____

SHEET _____ OF _____

NOTES Cronin
H.C. Ripple
R.C. Geyman
Barbour

DATE 8/19/86
WEATHER sunny
TEMP. 83°

ROUTE #590
COUNTY Sandusky
TOWNSHIP Washington
SECTION 34
T 5 N R 14 E

TYPE MONUMENT P.K. & washer
ON SURFACE - BELOW on surface
LEFT - & PAV'T. - RIGHT 11' ± Pt. & P.V.T.
TO _____ EDGE PAVEMENT
S.L.M. _____

13L

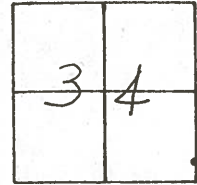

P.I.
Sta.
P.K. & washer atop same
atop R.R. spike

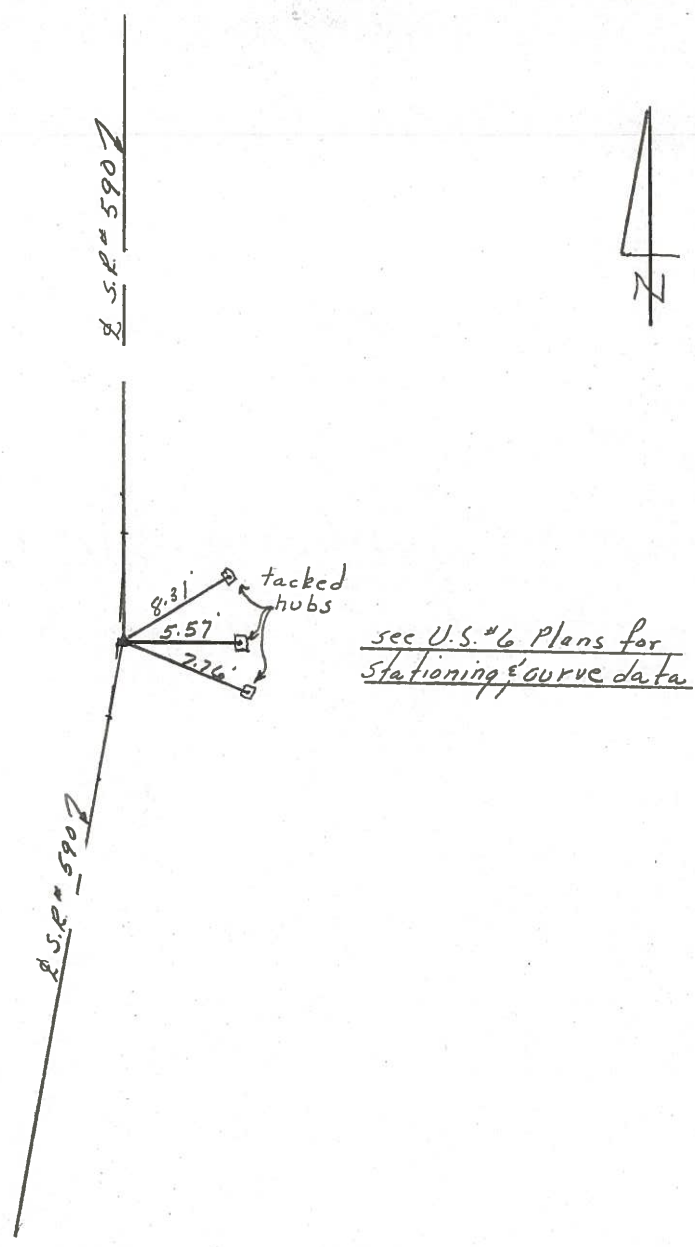

see U.S. #6 Plans for
stationing & curve data

O.D.O.T. DISTRICT 2 SURVEY OFFICE

④

PERSONNEL

REFERENCE NO. _____

SHEET _____ OF _____

NOTES Cronin

H.C. Ripple

R.C. Geyman

Barbour

DATE 8/19/86

WEATHER sunny

TEMP. 83°

ROUTE #590

COUNTY Sandusky

TOWNSHIP Washington

SECTION 34

T 5 N R 14 E

TYPE MONUMENT nail & shiner

ON SURFACE - BELOW Below

LEFT- & PAV'T. - RIGHT _____

TO _____ EDGE PAVEMENT

S.L.M. 6.833 I

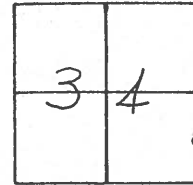

360+78

All ties missing. Will have
to run line in & measure.
Point is probably from a
private survey as distance
between Sta. at C.R. #51 & Sta
@ this point is 1322.20 i

PERSONNEL	TITLE	PERSONNEL	TITLE
COUNTY		Sandusky	
DATE		7-30-71	
S. R.		590	
WEATHER		Rain	
SEC.		34 & 35	
TEMP.		72°	
DESCRIPTION			JOB NO.
Between U.S. #6 & Napoleon Rd.			
LEFT	CENTER LINE	RIGHT	

