

O.D.O.T. DISTRICT 2 SURVEY OFFICE

PERSONNEL	REFERENCE NO. <u>36</u>	SHEET <u>39</u> OF <u>48</u>
NOTES <u>MOSER</u>	DATE <u>10/14/10</u>	ROUTE <u>SR 600</u>
H.C. <u>DOMALSKI</u>	WEATHER <u>SUNNY</u>	COUNTY <u>SANDUSKY</u>
R.C. <u>HARBAUGH</u>	TEMP. <u>60°</u>	TOWNSHIP <u>WASHINGTON</u>
		SECTION <u>16</u>
		T <u>5</u> N R <u>14</u> E

TYPE MONUMENT LG. CONC. MON. W/IRON PIN
 ON SURFACE - ~~BELOW~~ ON _____
 LEFT - C PAV'T - ~~RIGHT~~ 47.8'
 _____ TO _____ EDGE PAVEMENT
 S.L.M. 485+89
 Grid: Northing: 630742.316 Easting: 1763666.242

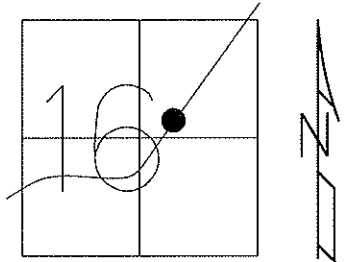

RECORD: P.I 500+02.75
 LARGE CONC. MON. ON LT
 R/W LINE. $\Delta=30^\circ-08'$ RT

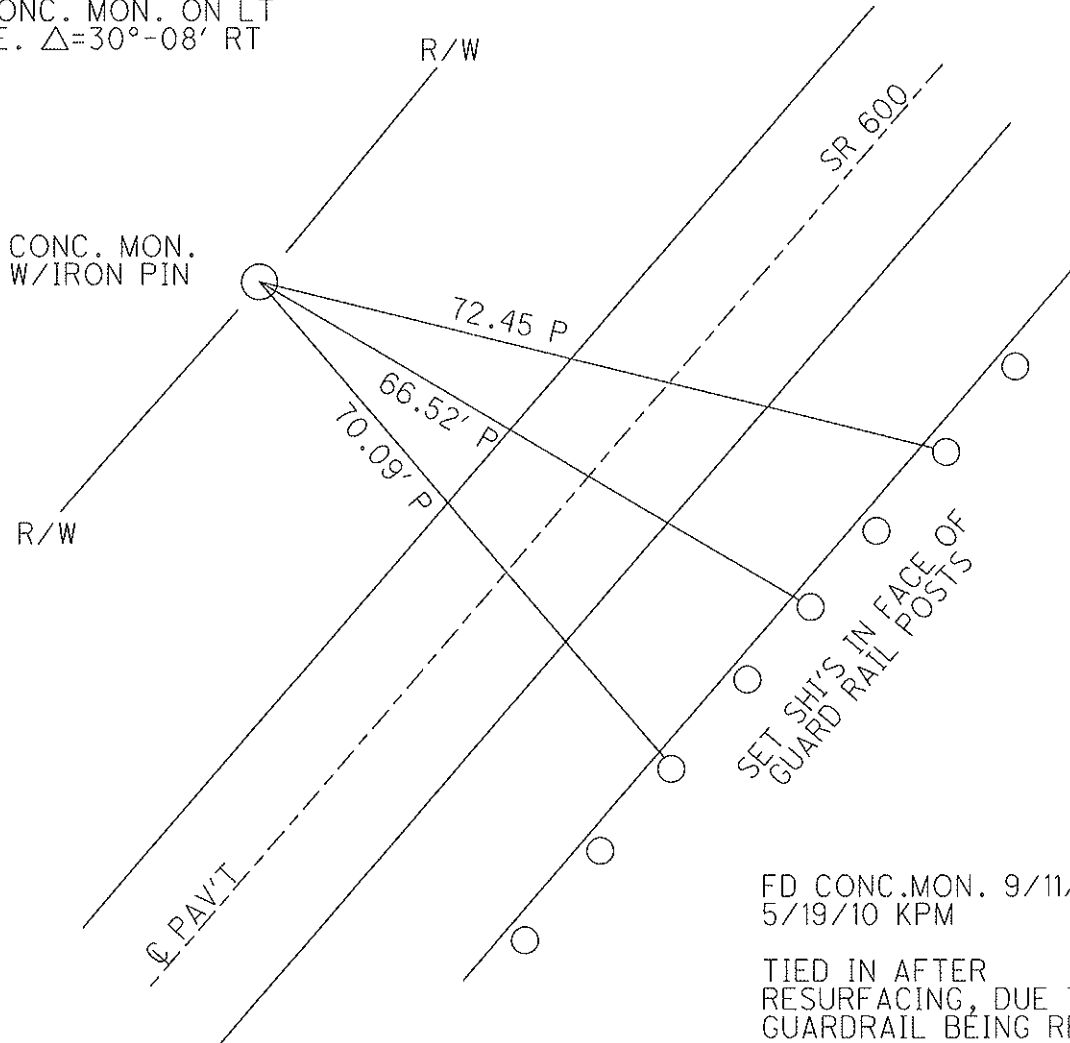

FD CONC. MON. 9/11/08,
 5/19/10 KPM

TIED IN AFTER
 RESURFACING, DUE TO
 GUARDRAIL BEING REPLACED
 5/19/10 KPM

GPS, TIED FIN2042
 10/15/10, KPM

O.D.O.T. DISTRICT 2 SURVEY OFFICE

PERSONNEL

REFERENCE NO. 36

SHEET OF

NOTES BARNHISEL

H.C. VAN DUSEN

R.C. CORDES

DATE 4-21-93

WEATHER SUNNY

TEMP. +45°

ROUTE 600

COUNTY SANDUSKY

TOWNSHIP WASHINGTON

SECTION 16

T. 5 N R. 14 E

TYPE MONUMENT Lg CONC. MON. w/IRON PIN

ON SURFACE - ~~BELOW~~ yes

LEFT- & PAV'T. - ~~RIGHT~~ 47.8

- TO - EDGE PAVEMENT

S.L.M. 485+89

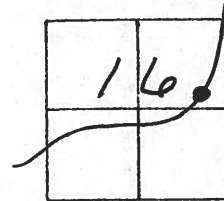

RECORD: P.I.

500+02.75

LARGE CONC. MON. ON LT
R/W LINE

Δ = 30°-08' RT

