

#6216

FOR ANY QUESTIONS PLEASE CONTACT ODOT DISTRICT 2 REAL ESTATE AT 419-353-8131

FED. RD. DIVISION	STATE	PROJECT	FISCAL YEAR
2	OHIO		1948

1/6

SENECA COUNTY  
SEN. 12-(11.71-11.95-12.08-12.15)

STATE OF OHIO  
DEPARTMENT OF HIGHWAYS  
SEN. 12-(11.71-11.95-12.08-12.15)  
SENECA COUNTY

VILLAGE OF BETTSVILLE

CONVENTIONAL

- COUNTY LINE
- TOWNSHIP LINE
- SECTION LINE
- CORPORATION LINE
- FENCE LINE
- CENTER LINE
- POLE LINE
- RAILROAD
- GUARD RAIL

SIGNS

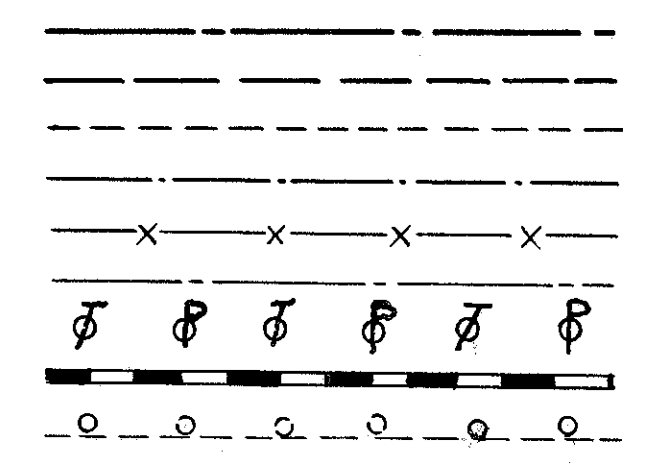

INDEX OF SHEETS

TITLE SHEET	1
TYPICAL SECTION	2
TABLE, GENERAL NOTES, PAVEMENT COMPUTATIONS, & GENERAL SUMMARY	3
PLAN & PROFILE SHEETS	4-6

LINE DATA

BEGIN PROJECT STA. 618+28.8  
 END PROJECT STA. 662+13  
 GROSS LENGTH - 4384.2 LIN.FT.  
 DEDUCT FOR R.R. CROSSING:  
 STA. 630+77 TO STA. 631+24 - 47.0 LIN.FT.  
 NET LENGTH OF PROJECT - 4337.2 LIN.FT.  
 OR 0.821 MILES

BEGIN PROJECT  
STA. 618+28.8



END PROJECT  
STA. 662+13

LOCATION PLAN

Scale 1" = 800'  
 PORTION TO BE IMPROVED (thick line)  
 STATE HIGHWAYS (double line)  
 OTHER ROADS (single line)  
 DETOURS (dashed line)  
 NONE (no line)

SCALES

PLAN 1" = 50'  
 PROFILE HORIZONTAL 1" = 50'  
 PROFILE VERTICAL 1" = 5'  
 CROSS SECTIONS NONE

The Standard Specifications of the State of Ohio, Department of Highways, including changes and Supplemental Specifications listed in the proposal, Shall Govern this Project.

The right of way necessary for this improvement will be provided by the State of Ohio.

I hereby approve these plans and declare that the making of this improvement will not require the closing to traffic of the highway and that traffic will be maintained as shown on the plans and estimates.

Approved W. B. Robinson  
 Date: 10/27/48 Division Deputy Director

Approved \_\_\_\_\_  
 Date: \_\_\_\_\_ Chief Engineer, Bureau of Maintenance

Approved G. Blaque  
 Date: 11-12-48 Chief Engineer, Bureau of Bridges & R.R. Crossings

Approved George J. Thornyer  
 Date: 11-16-48 Chief Engineer, Bureau of Location & Design

Approved Frank M. Williams  
 Date: 11-16-48 First Asst. Director & Chief Engineer

Approved Earl L. Reeb  
 Date: 11-16-48 Director of Highways

CONSTRUCTION BUREAU  
 JUL 14 1955  
 GROUND PHOTO LAB

SUPPLEMENTAL SPECIFICATIONS		STANDARD	DRAWINGS
M-205.1	3-19-46		

FILE NO. SENeca CO. SEN. 12-(11.71, 11.95, 12.08, 12.15)  
 DATE OF LETTING \_\_\_\_\_  
 CONTRACT NO. \_\_\_\_\_

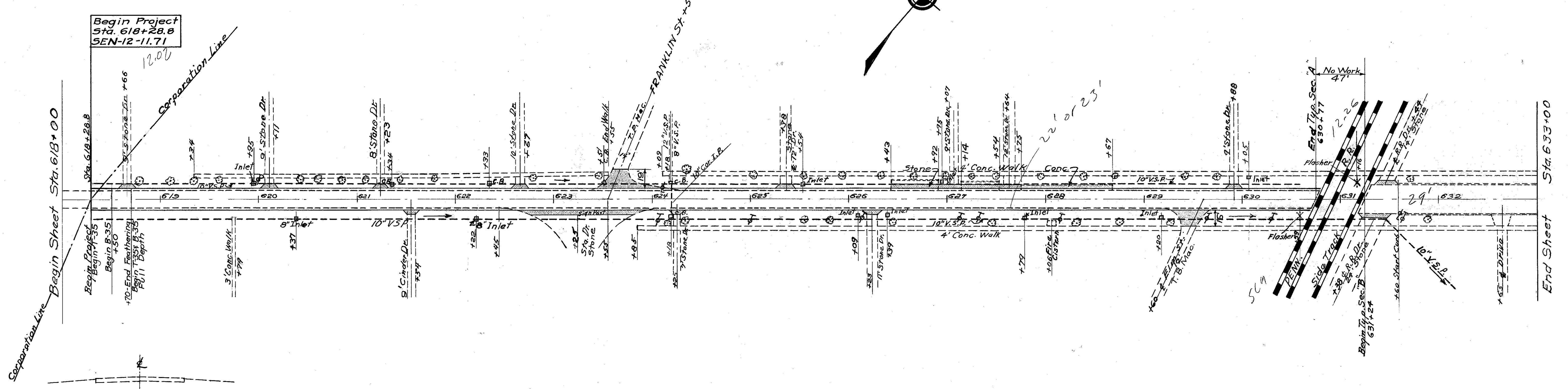

TYPICAL SECTION  
ADJOINING PAVEMENT  
18' T. B. Macadam

B.M. No 1 - S.E. Cor. 1<sup>st</sup> Conc. Step  
Sta. 623+06 - 50' Left  
Elev. 704.40

B.M. No 2 - S.E. Cor. 1<sup>st</sup> Conc. Step  
to House  
Sta 629+62 - 32' Left  
Elev. 705.77

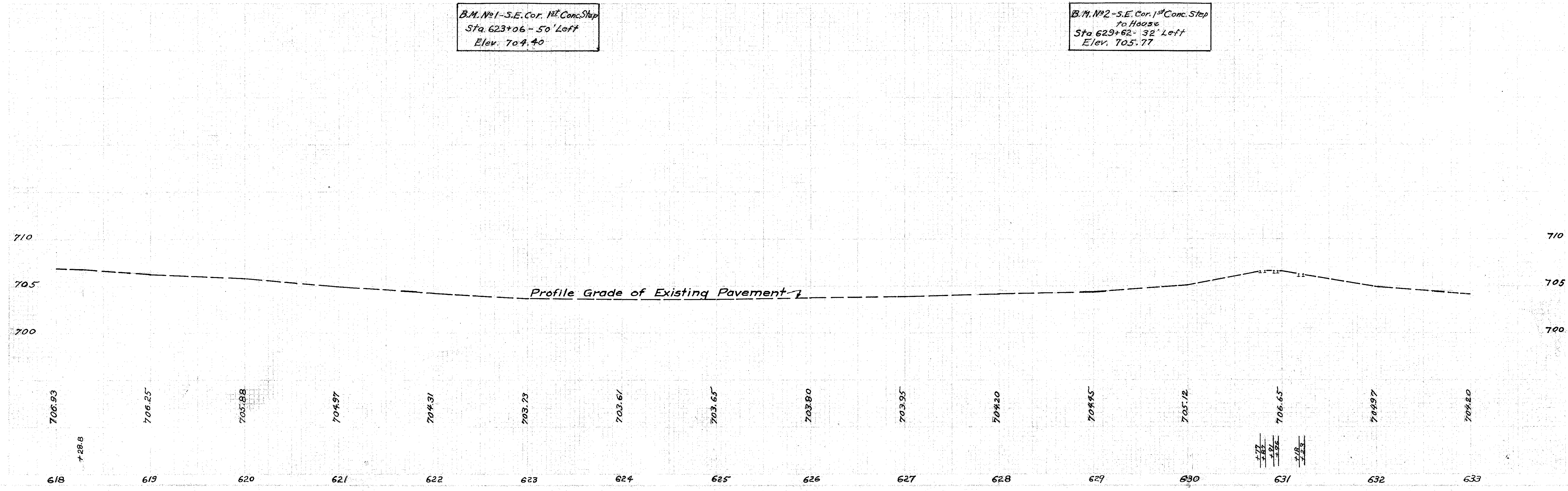

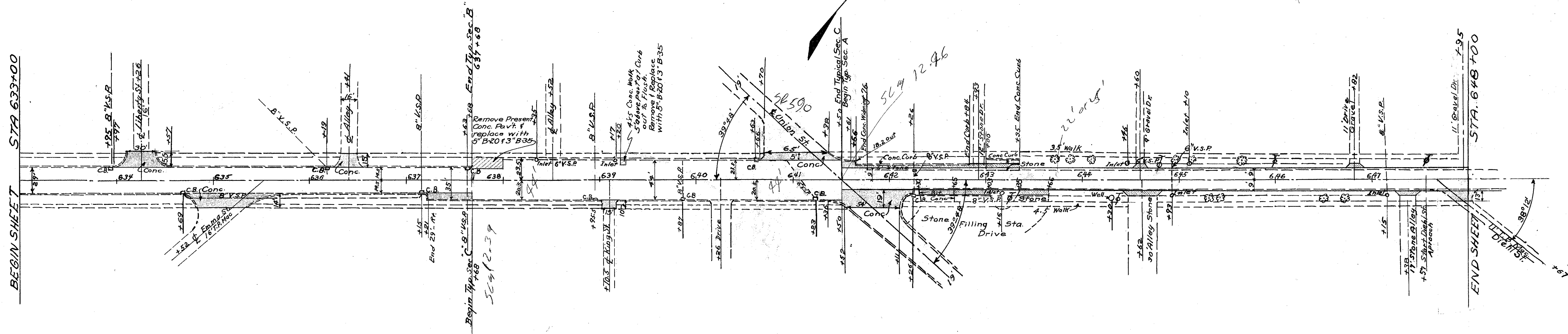

B.M. No 3 - S.E. Cor. 1<sup>st</sup> Conc. Step to Brick House.  
Sta. 636+09 - 40' Left  
Elev. 704.91

B.M. No 4 - S.E. Cor. - 1<sup>st</sup> Conc. Step to Dr. Huber's Office  
Sta. 640+43 - Left  
Elev. 702.56

B.M. No 5 - S.E. Cor. - 1<sup>st</sup> Step to House  
Sta. 643+68 - 44' Left  
Elev. 701.56

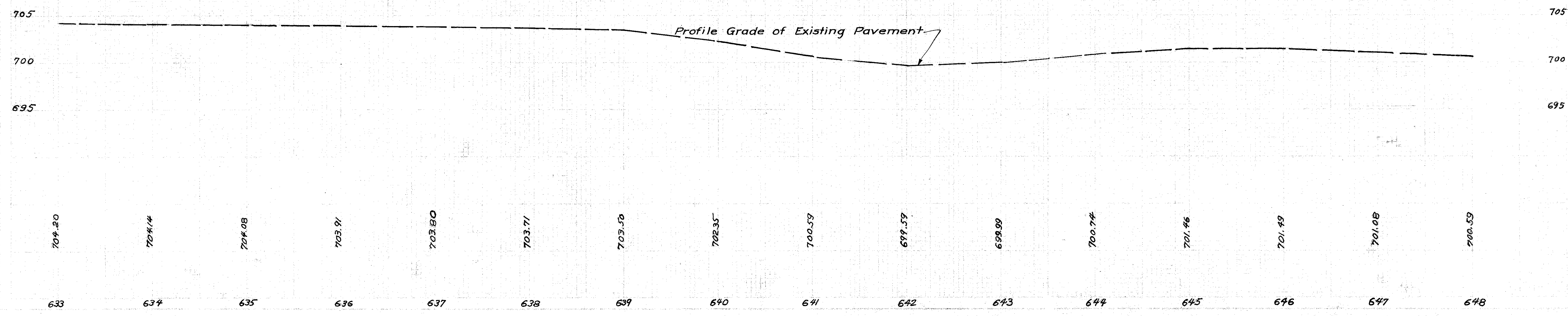



DATA ON EXISTING BRIDGE  
Bridge No. SE-12-125  
Type: Concrete Girder on Conc. Abuts.  
Width between Curbs: 19'-4"  
Span: 2 @ 58'-8"  
Built: 1924.  
Loading: H-15  
Condition: Good.  
Work Required: Resurface.

DATA ON EXISTING BRIDGE  
Bridge No. SE-12-125 A.  
Type: Conc. Slab on Conc. Abuts.  
Width between Curbs: 23'-6"  
Span: 20'-0"  
Built: 1924.  
Loading: H-15.  
Condition: Fair  
Work Required: Resurface full width.

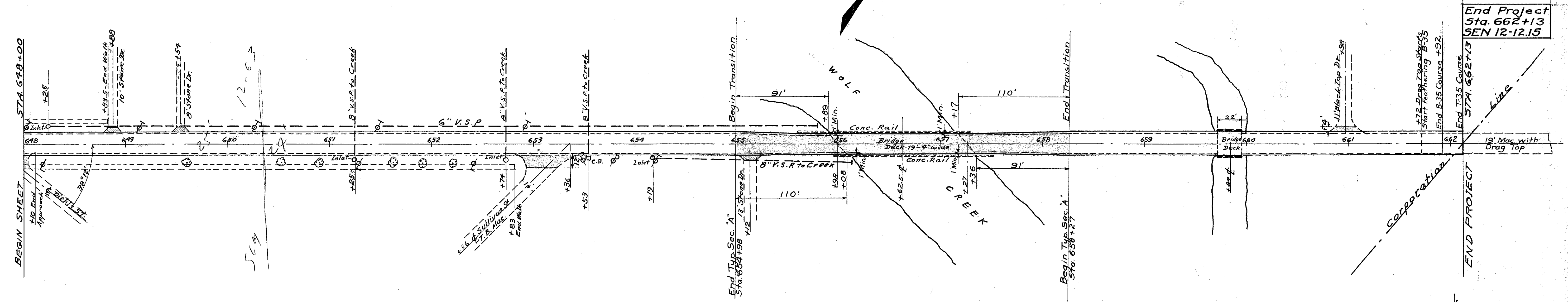

TYPICAL SECTION  
ADJOINING PAVEMENT  
19' Macadam with  
Drag Top.

B.M. N#6-N. End. 1st Conc. Step to Church  
Sta. - 649+69 - 24' Left  
Elev. 700.44

B.M. N#7-Top Coping S. End N. Br. Rail  
Sta. - 655+61 - Left.  
Elev. 693.79

B.M. N#8-X in N.E. Cor. Conc. Walk.  
Sta. - 662+00 - 20' Left.  
Elev. 693.08

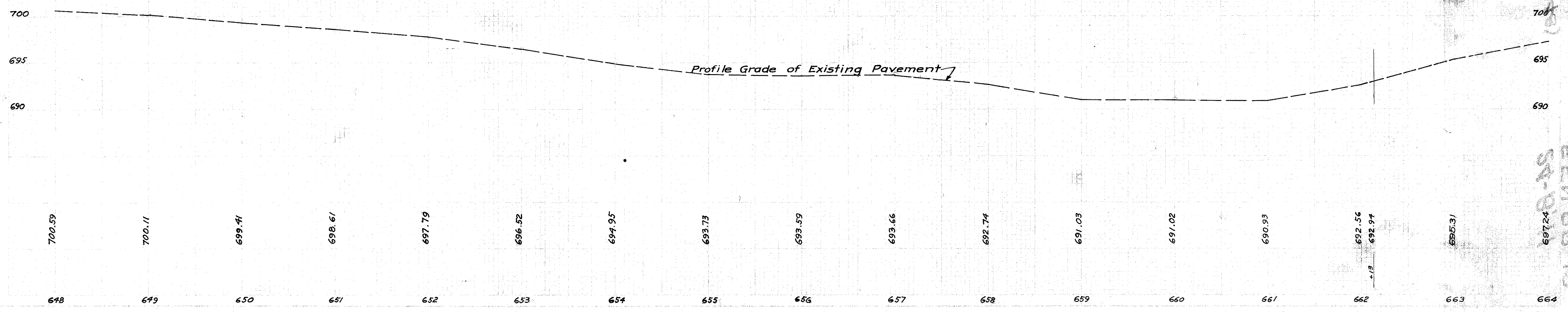

Vertical text on the right margin: 'DISTRICT 2 REAL ESTATE', '1948 6', 'SEN-12-15', '697.24', '698.15'.