

O.D.O.T. DISTRICT 2 SURVEY OFFICE (USE ONLY)

PERSONNEL _____ REFERENCE NO. 34 SHEET 35 OF 70

NOTES CANTERBURY DATE 08-20-99 ROUTE SR 12
H.C. ROUSOS WEATHER FAIR COUNTY SENECA
R.C. BARNHISEL TEMP. 85° TOWNSHIP JACKSON
SECTION 24
T 3 N R 13 E

TYPE MONUMENT _____
ON SURFACE - BELOW _____
LEFT - Q PAV'T - RIGHT _____
_____ TO _____ EDGE PAVEMENT
S.L.M. _____
GRID: NORTHING: _____ EASTING: _____

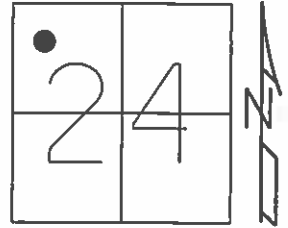

C.S. RECORD:
356+76.72
PK ATOP MINE SPIKE
08-20-99 DNF
05-25-12 DNF

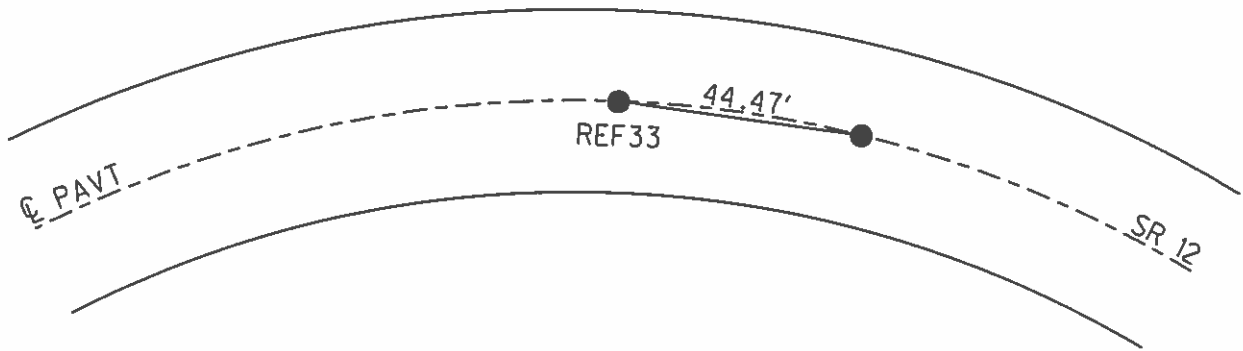

O.D.O.T. DISTRICT 2 SURVEY OFFICE

PERSONNEL _____ REFERENCE NO. 34 SHEET 27 OF 52
NOTES Canterbury ROUTE 12
H.C. Rousos DATE 8-20-99 COUNTY Seneca
R.C. Barnhisel WEATHER Fair TOWNSHIP Jackson
TEMP. +85° F SECTION 24
T 3 N R 13 E

TYPE MONUMENT _____
ON SURFACE - BELOW _____
LEFT - & PAW'T. - RIGHT _____
TO _____ EDGE PAVEMENT
S.L.M. _____

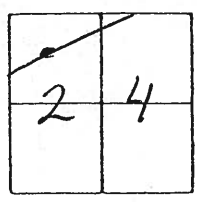

C.S. Record:
356 + 76.72
PK atop mine
Spike

DNF

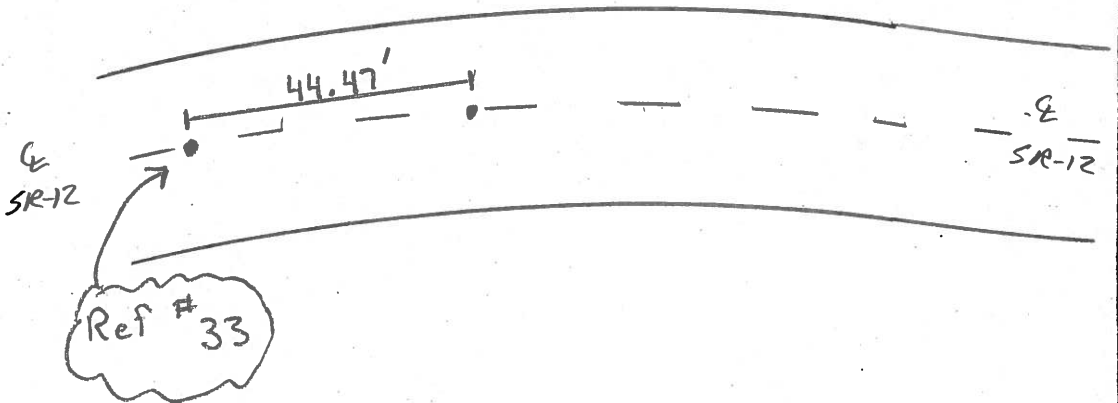

O.D.O.T. DISTRICT 2 SURVEY OFFICE

PERSONNEL

NOTES Cronin
H.C. Rippe
R.C. Barbour
Geyman

REFERENCE NO. 34
Drawn 2/01/90
DATE 1/31/90
WEATHER sunny
TEMP. 40°

SHEET 28 OF _____

ROUTE #12
COUNTY Seneca
TOWNSHIP Jackson
SECTION 24
T3 NR 13 E

TYPE MONUMENT P.K.
ON SURFACE - BELOW 1/2"
LEFT - CL PAV'T. - RIGHT _____
_____ TO _____ EDGE PAVEMENT
S.L.M. _____

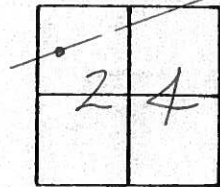

C.S.
356 + 76.72
P.K. at top mine
spike

PERSONNEL	TITLE	PERSONNEL	TITLE
COUNTY <u>Seneca</u> DATE <u>11-6-72</u>			
S. R. <u>12</u> WEATHER <u>Fair</u>			
SEC. <u>24 Jackson Twp.</u> TEMP. <u>50°</u>			
DESCRIPTION <u>Fostoria to Sandusky Co. Line</u>			JOB NO. _____

