

STATE OF OHIO
DEPARTMENT OF TRANSPORTATION

FED. RD. DIVISION	STATE	PROJECT	1
5	OHIO	STATE	17

SEN - 18 - 9.96

QUANTITIES	
CALC BY G.C.W.	DATE 4-20-72
CKD BY G.W.W.	DATE 7-12-72

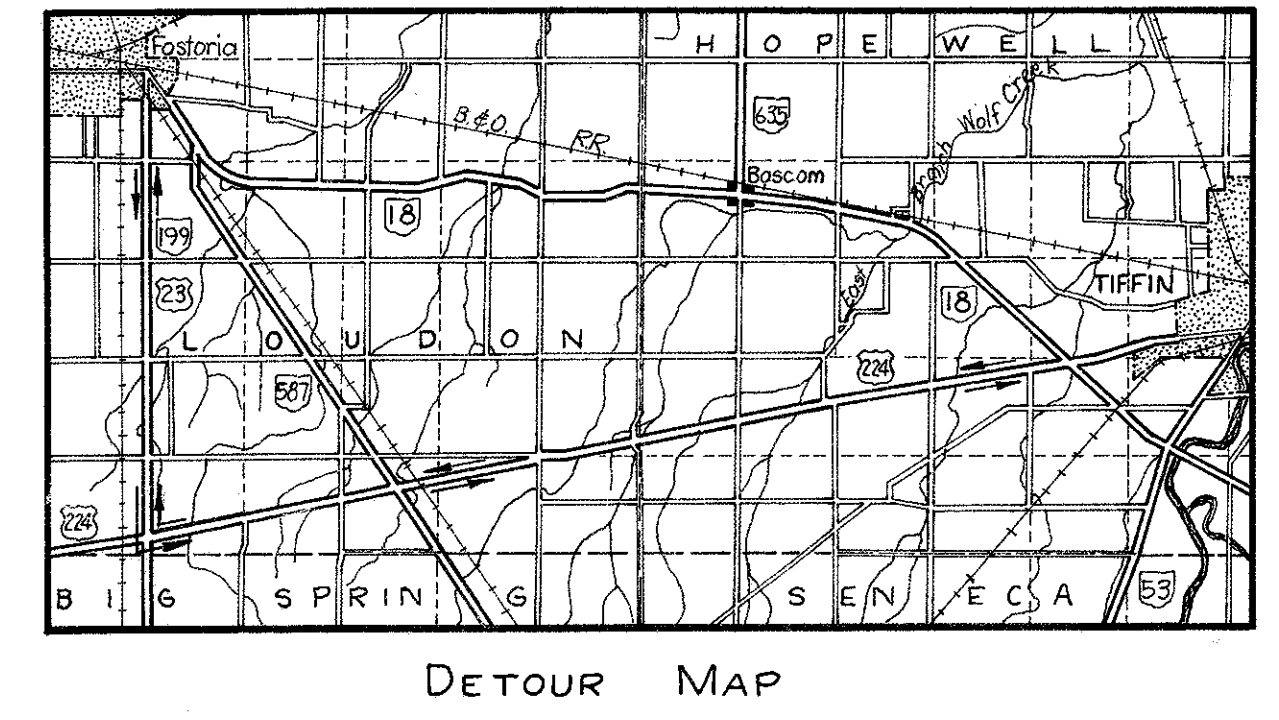

RECEIVED
JUL 3 1972
DISTRICT 2
JUL 9 1972

SEN - 18 - 9.96

HOPEWELL TOWNSHIP
SENECA COUNTY

CONVENTIONAL SIGNS

- County Line _____
- Township Line _____
- Section Line _____
- Corporation Line _____ or _____
- Fence Line (existing) - x - x (proposed) - x - x
- Center Line _____
- Trees (to be removed) (to be removed)
- Utility Poles: Telephone ϕ , Power ϕ , Light ϕ
- Existing Right of Way _____
- Property Line (in existing fence) - x - x
- Railroad _____
- Guardrail (existing) - o - o (proposed) - o - o

INDEX OF SHEETS

- Title Sheet _____ 1
- Schematic Plan and Design Designation _____ 2
- Typical Sections _____ 3
- General Notes _____ 4
- Subsummaries _____ 4-5
- General Summary _____ 5
- Plan and Profile and Right of Way _____ 6
- Cross-Sections _____ 7-11
- Structures over 20 Foot Span _____ 12-16, 16A, 17

- BEGIN WORK
STA. 525+00
- BEGIN PROJECT
STA. 526+00
- END PROJECT
STA. 528+50
- END WORK
STA. 529+50

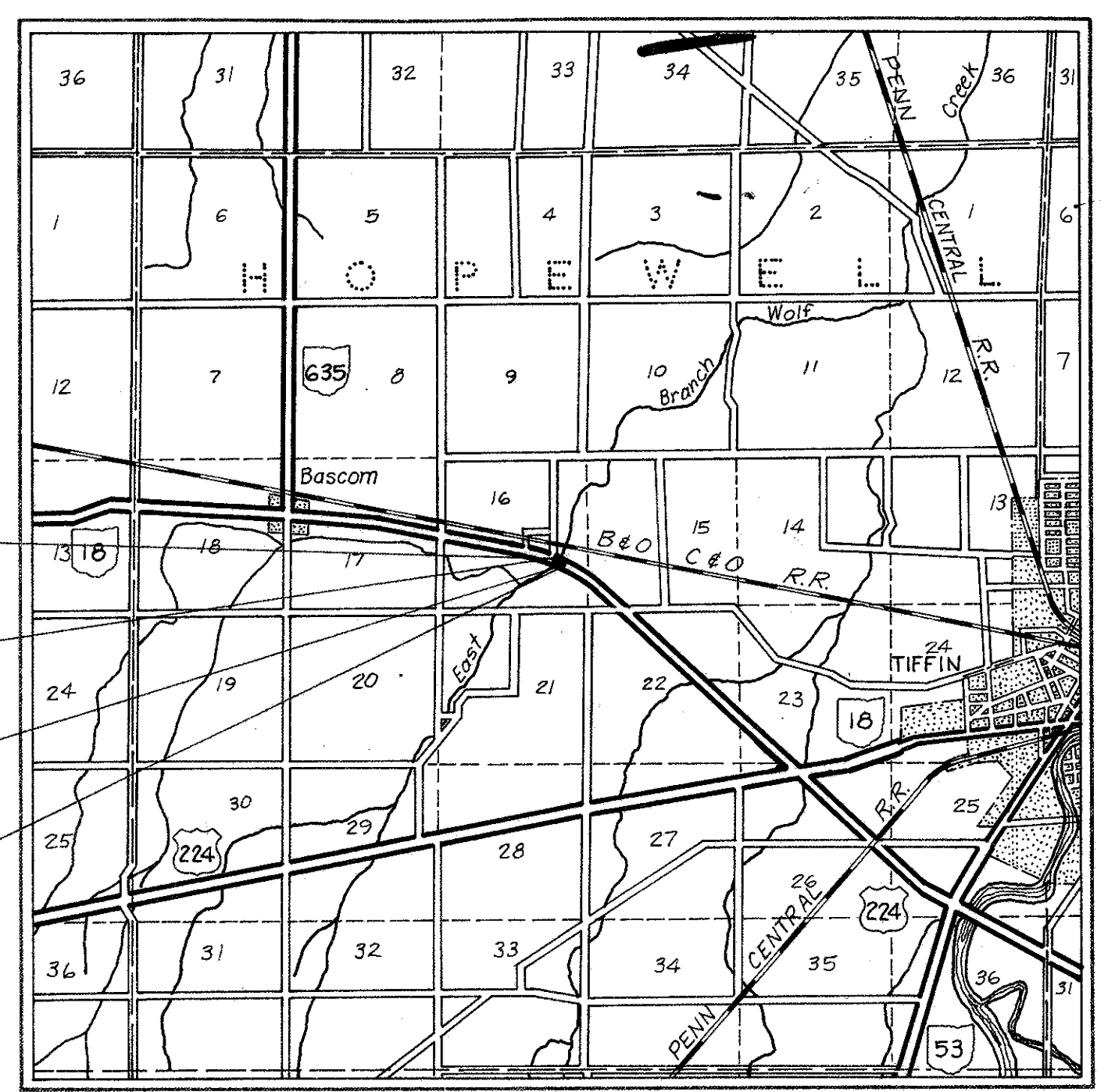

LOCATION MAP

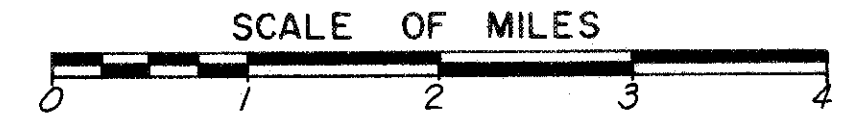

LINE DATA

~ PROJECT ~

BEGIN PROJECT - STA. 526+00
END PROJECT - STA. 528+50
NET LENGTH OF PROJECT = 25000 LIN. FT. OR 0.047 MI.

~ WORK ~

BEGIN WORK - STA. 525+00
END WORK - STA. 529+50
NET LENGTH OF WORK = 45000 LIN. FT. OR 0.085 MI.

- Portion to be improved _____
- State Roads _____
- Other Roads _____
- Detour Shown Thus _____

SCALES

- Plan _____
- Profile: Horizontal _____
- Profile: Vertical _____

SUPPLEMENTAL PRINTS OF STANDARD CONSTRUCTION DRAWINGS	
BP-5	8-11-75
GR-2A	1-1-71
GR-2B	11-9-71
GR-3	11-9-71
GR-4	11-9-71
MC-3	6-1-73
HW-4	1-1-70
L-1	6-1-73
MC-4	6-13-69
CS-1-71	1-1-71
DBR-1-71	1-1-71
AS-1-72	6-30-72

1975 SPECIFICATIONS

The standard specifications of the State of Ohio, Department of Transportation including changes and supplemental specifications listed in the proposal shall govern this improvement.

The right of way for this improvement will be provided by the State of Ohio.

I hereby approve these plans and declare that the making of this improvement will require the closing to traffic of the highway and that detours will be provided as indicated on the plans.

Approved _____
Date 10-17-72 District Deputy Director of Transportation

Approved _____
Date 11-16-73 Engineer, Bureau of Bridges

Approved _____
Date 11-8-73 Engineer, Bureau of Roadway Design

Approved _____
Date 12-06-73 Assistant Deputy Director for Highway Design

Approved _____
Date 12/6/73 Assistant Deputy Director for Real Estate

Approved _____
Date 12-6-73 Assistant Deputy Director for Program Development

Approved _____
Date _____ Chief Engineer, Design

Approved _____
Date 12-6-73 Deputy Director, Division of Highways

Approved _____
Date 12-7-73 Assistant Director, Department of Transportation

Approved _____
Date 12/10/73 Director, Department of Transportation

Approved _____
Date 3-19-76 Assistant Director, Department of Transportation

Approved _____
Date 3-19-76 Director, Department of Transportation

DIVISION ENGINEER

Plan Prepared By:
Department of Transportation
District No. 2

Project: SEN - 18 - 9.96
Date of Letting: 19 _____, Contract No. _____

Rev 34576

DATA ON EXISTING STRUCTURE
 BR. No. SEN-18-0998 STA. 527+32.82
 TYPE: Conc. Slab with Conc. Gravity Abutments & Conc. Piers
 SPANS: 23'-5", 28'-1", 23'-5"
 ROADWAY WIDTH: 28'-8" w/ Curbs
 ALIGNMENT: 1°-30' R.C.
 SKEW: 30° R.F.
 WEARING SURFACE: 3/4" Mono Conc. + 3" Bit. W.S.
 APPROACH SLABS: 15'-0" Long
 CONDITION: Poor
 DRAINAGE AREA: 29.6 Sq. Mi.

DATA ON PROPOSED STRUCTURE
 BR. No. SEN-18-0998 STA. 527+19.95
 TYPE: Continuous Reinforced Concrete Slab with Capped Pile Substructure
 SPANS: 28'-35'-28"
 ROADWAY: 44'-0" w/ Guardrail
 SKEW: 30° R.F.
 WEARING SURFACE: 2 1/4" Asphalt Concrete @ Survey Co. Rd. 48
 APPROACH SLABS: 25'-0" Long
 ALIGNMENT: 1°-30' Curve Right

DATA ON EXISTING CURVE
 P.I. = Sta. 529+13.12
 P.C. = Sta. 518+20.84
 P.T. = Sta. 539+48.62
 Δ = 31°-55'
 D = 1°-30'
 R = 3819.72'
 T = 1092.28'
 L = 2127.78'
 E = 153.1'

PROJ. NO.	STATE	PROJECT	6 17
2	OHIO		

SEN-18-996

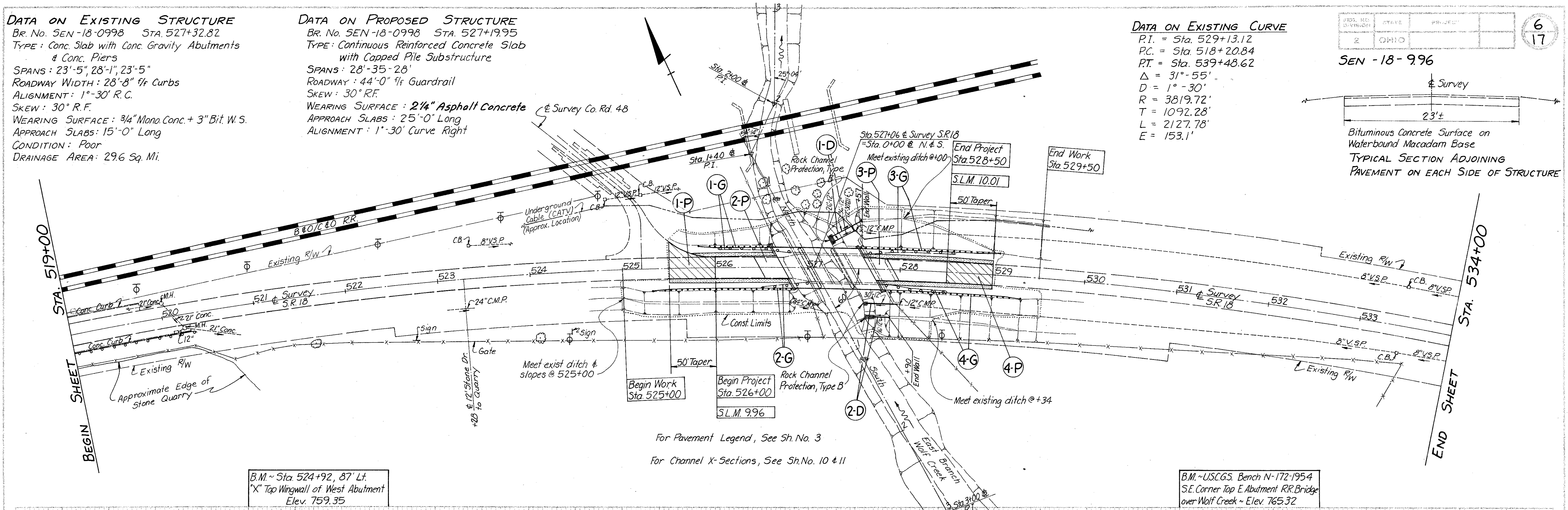
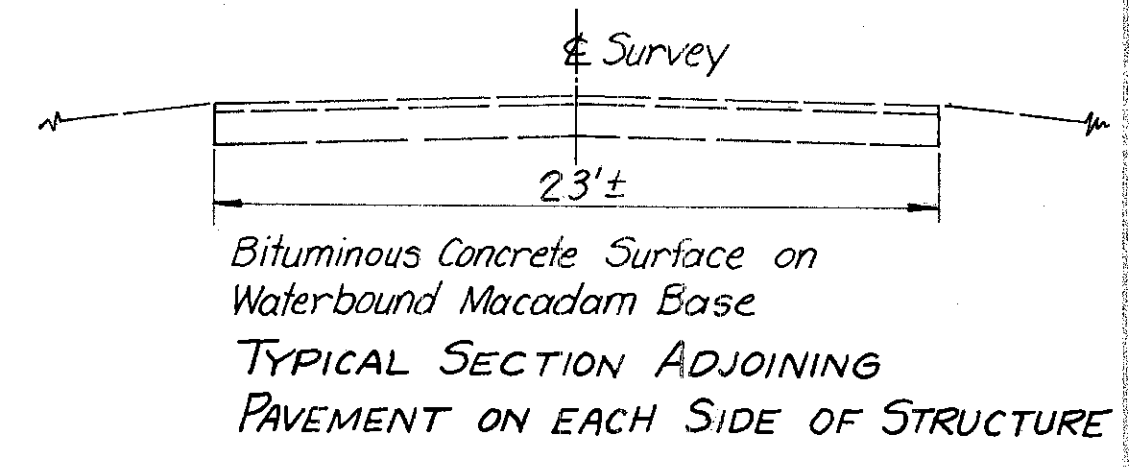

For Pavement Legend, See Sh. No. 3
 For Channel X-Sections, See Sh. No. 10 & 11

B.M. ~ Sta. 524+92, 87' Lt.
 "X" Top Wingwall of West Abutment
 Elev. 759.35

B.M. ~ USCGS Bench N-172-1954
 S.E. Corner Top E. Abutment RR Bridge
 over Wolf Creek ~ Elev. 765.32

Proposed Elevations	Rt. Edge
759.96	759.24
760.06	759.34
760.16	759.44
760.26	759.54
760.36	759.64
760.46	759.74
760.56	759.84
760.66	759.94
760.76	760.04
760.86	760.14
760.96	760.24

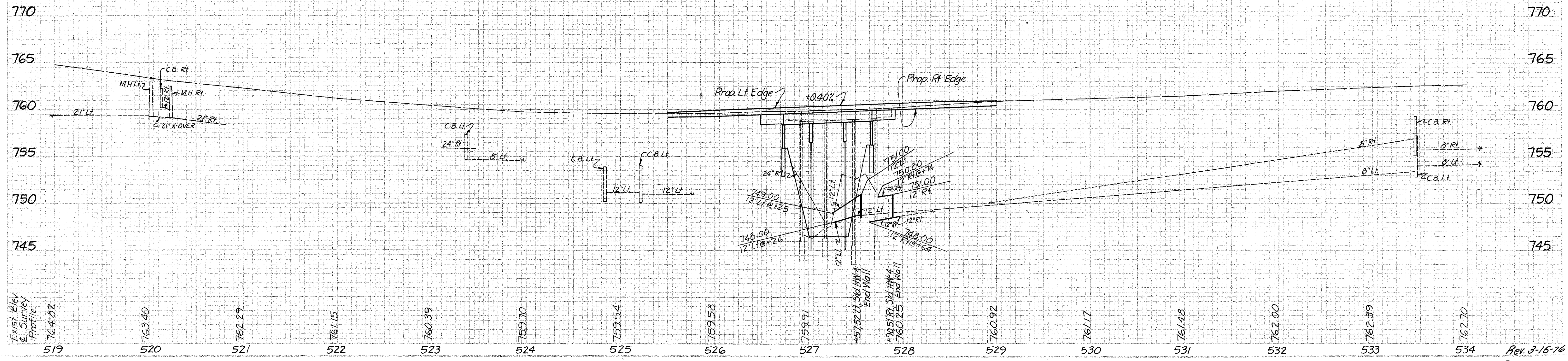

STA. 519+00 TO STA. 534+00