

O.D.O.T. DISTRICT 2 SURVEY OFFICE (USE ONLY)

PERSONNEL

REFERENCE NO. 18 A

SHEET 18 OF 48

NOTES CRONIN DATE 1/19/90
H.C. RIPPLE WEATHER CLEAR
R.C. BARBOUR TEMP. 29°
GEYMAN

ROUTE SR 18
COUNTY SENECA
TOWNSHIP LOUDON
SECTION 13

DWG BY NIESE PID NO PID

T 2 N R 13 E

TYPE MONUMENT CALPT

ON SURFACE - BELOW -

OFFSET \odot PAVEMENT 70.0' ~~RT~~ : RT

- TO - EDGE PAVEMENT

STATION: 314+72.85

HORIZ.DATUM: - GEOID: -

GRID: NORTHING: - EASTING: -

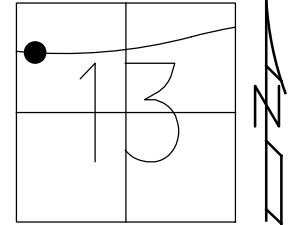

RECORD: P.I.
STA 314+72.85
 $\Delta=19^{\circ}55'00''$ LT
D=1°18'00"
R=4407.46'
L=1532.05'
T=773.78'
E=67.42'
1/2/59, CRONIN
CALCULATED POINT
WAS NEVER SET
AFTER 1958 CONSTRUCTION

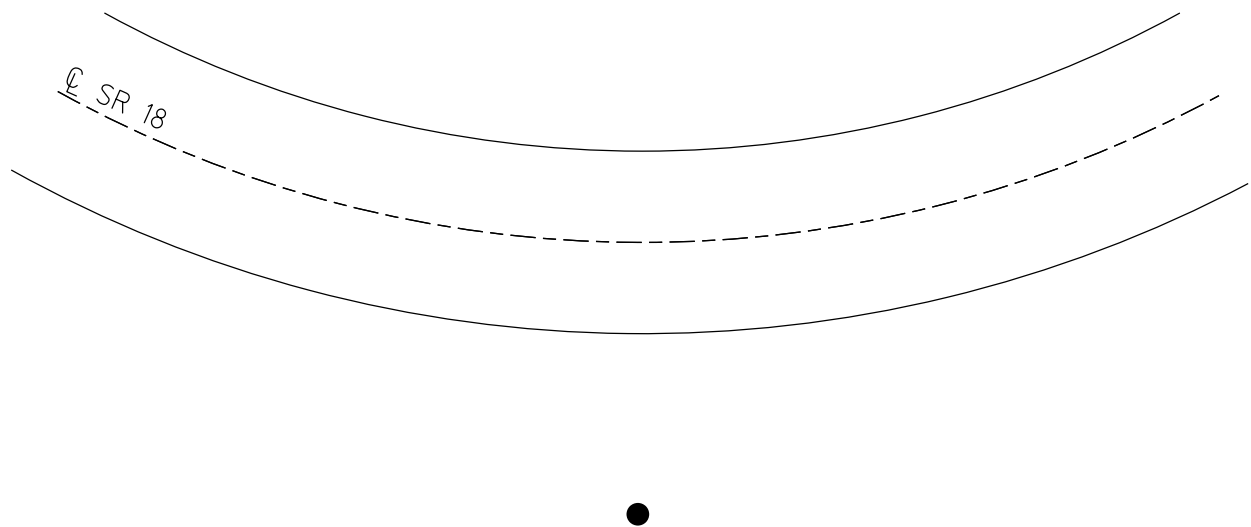

O.D.O.T. DISTRICT 2 SURVEY OFFICE

PERSONNEL

NOTES CROWN
H.C. RIPPLE
R.C. SARBOUR
GEYMAN

REFERENCE NO. _____
DRAWN 1/19/90
DATE _____
WEATHER _____
TEMP. _____

SHEET 23 OF _____

ROUTE #18
COUNTY SENECA
TOWNSHIP LODGEPOLE
SECTION 13
T. 2 N. R. 13 E.

TYPE MONUMENT NOTHING
ON SURFACE - BELOW _____
LEFT - \odot PAV'T. - RIGHT 70'±
TO _____ EDGE PAVEMENT
S.L.M. _____

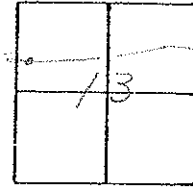

P.T. SURVEY
 $\delta = 19^{\circ} 55' 00''$ Lf.
314472.85

PERSONNEL TITLE PERSONNEL TITLE

Hsh
Crosier
Leemaster
Lahr
John K.

COUNTY Seneca DATE Jan. 2, '59
S. R. #18 Fosterie-Buscom Rd WEATHER Clear
SEC. Sen-18 (1.79-8.60) TEMP. 40°

DESCRIPTION Control Point Ties - Survey + Const. JOB NO.

LEFT CENTER LINE Survey RIGHT

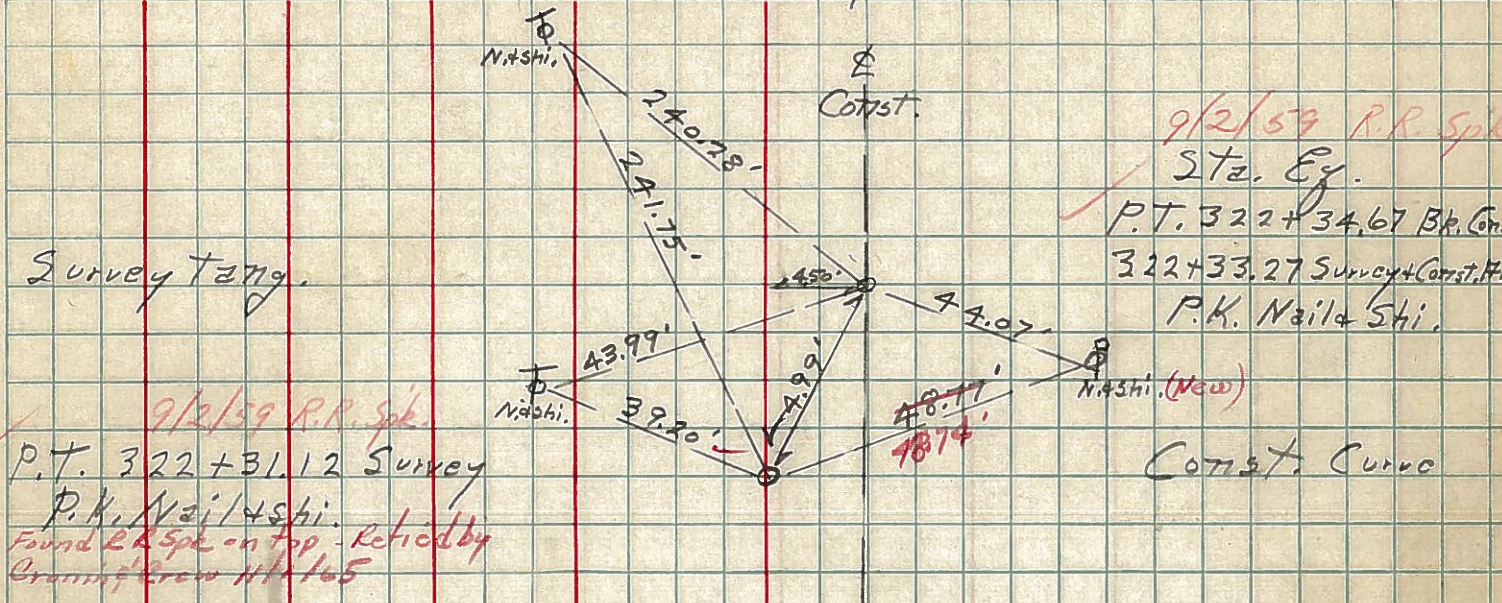

P.I. OFF R/W NOT EST.

P.I. 70110 Survey + Const.

P.I. OFF R/W NOT EST.

