

O.D.O.T. DISTRICT 2 SURVEY OFFICE (USE ONLY)

PERSONNEL _____ REFERENCE NO. 98 A SHEET 4 OF 18

NOTES RHOADES DATE 6/30/15 ROUTE SR 18
 H.C. O'DONNELL WEATHER CLEAR COUNTY SENECA
 R.C. RHOADES TEMP. 73° TOWNSHIP THOMPSON
 _____ SECTION 17
 _____ T 3 N R 17 E

TYPE MONUMENT MAG/WASHER
 ON SURFACE - ~~BELOW~~ ON
 LEFT - ☉ PAV'T - ~~RIGHT~~ 2.0'
9.7' TO LT EDGE PAVEMENT
 S.L.M. 1659+21.58

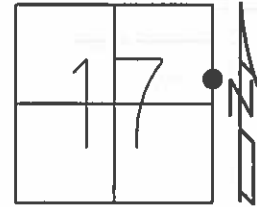

Grid: Northing: 566740.042 Easting: 1853557.817

RECORD:
 UNKNOWN ORIGIN
 FD NAIL
 7/11/85, MB
 SET P.K./WASHER
 9/27/85, SWH
 FD P.K./WASHER
 8/1/02, MB
 SET MAG/WASHER
 WITH TIES
 GPS, NEWREFA98
 6/30/15, JFO

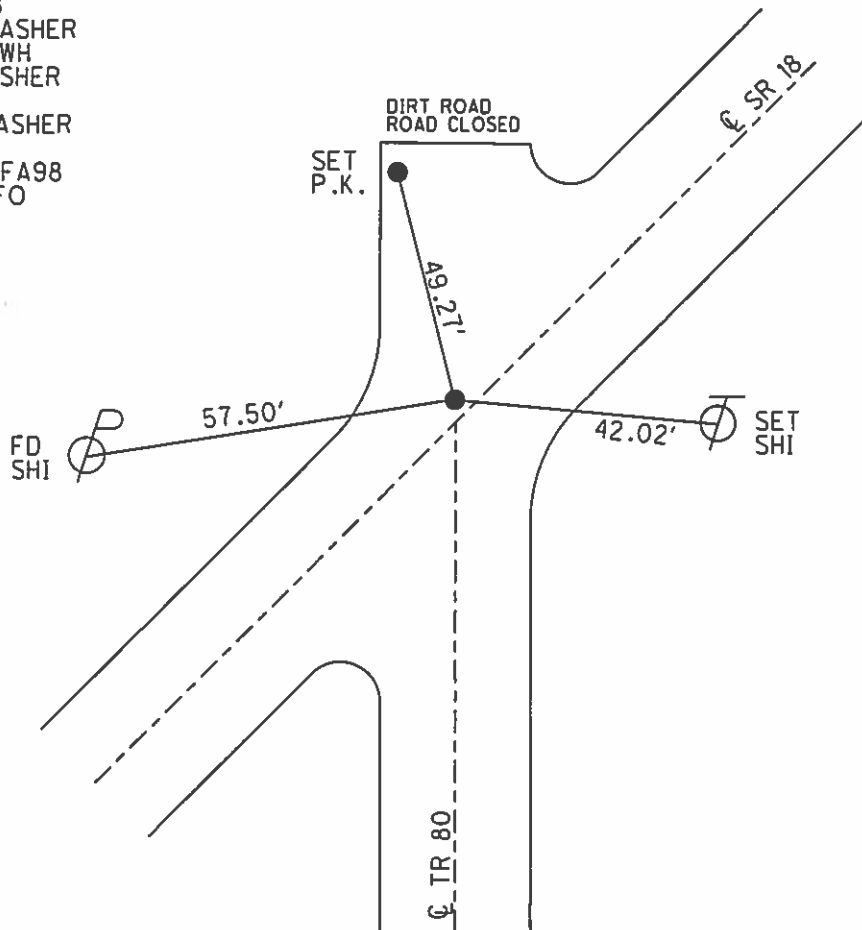

O.D.O.T. DISTRICT 2 SURVEY OFFICE

PERSONNEL _____ REFERENCE NO. 98-A SHEET _____ OF _____

NOTES Hoffman DATE 7-11-85 ROUTE SR 18
 H.C. LOSHKES WEATHER CLEAR COUNTY SENECA
 R.C. BARNHISEL TEMP. 65° TOWNSHIP THOMPSON
 SECTION 17
 T. 3 N. R. 17 E.

TYPE MONUMENT Nail - ORIGINAL UNKNOWN -
 ON SURFACE - ~~BELOW~~ yes SET PK/WASHER 9-27-85 SWH
 LEFT- & PAV'T. = RIGHT 2.0
9.7 TO LT EDGE PAVEMENT
 S.L.M. 1661 + 46

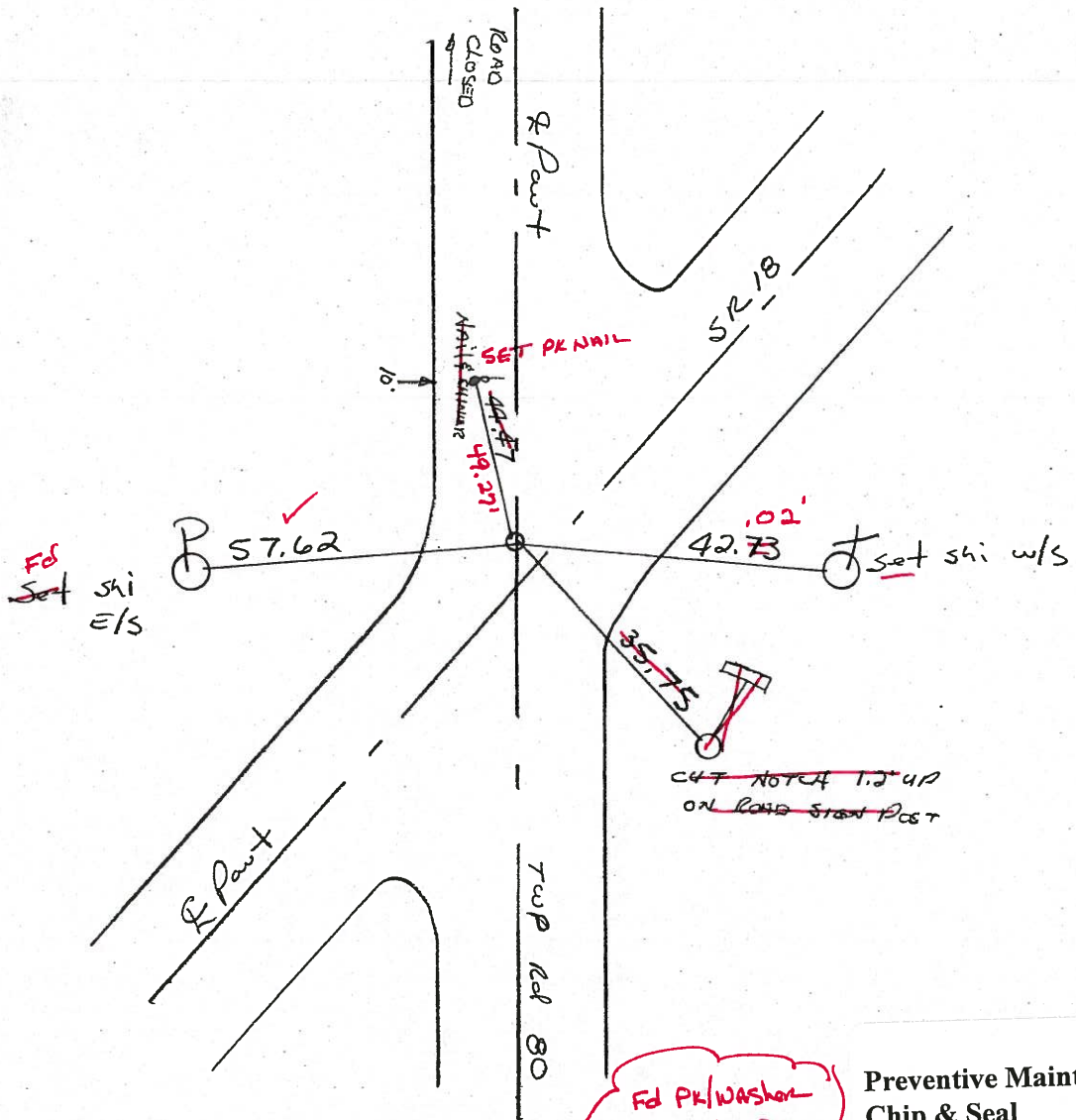
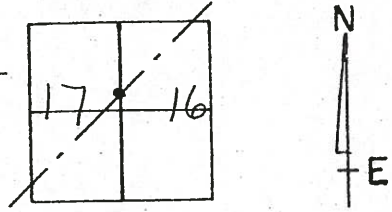

Fd PK/Washer
 8-1-02
 MB

Preventive Maintenance
 Chip & Seal 2002
 Existing Point Uncovered
 Date 12-06-02

O.D.O.T. DISTRICT 2 SURVEY OFFICE

PERSONNEL

REFERENCE NO. 98-A

SHEET OF

NOTES Hoffman

H.C. LOSHKICE

R.C. BARNHISEL

DATE 7-11-85

WEATHER CLEAR

TEMP. 65°

ROUTE SR 18

COUNTY SENECA

TOWNSHIP THOMPSON

SECTION 17

T. 3 N R. 17 E

TYPE MONUMENT Nail - ORIGINAL UNKNOWN -

ON SURFACE - BELOW yes

LEFT - Q PAV'T. - RIGHT 2.0

9.7 TO LT EDGE PAVEMENT

S.L.M. 1661 + 40

Set P.K./WASHER
9-27-85 SWH

