

O.D.O.T. DISTRICT 2 SURVEY OFFICE (USE ONLY)

PERSONNEL \_\_\_\_\_ REFERENCE NO. 25 B SHEET 7 OF 17  
 NOTES O'DONNELL DATE 5/12/21 ROUTE US 23  
 H.C. AUBLE WEATHER SUNNY COUNTY SENECA  
 R.C. NIESE TEMP. 50° TOWNSHIP LOUDON  
 SECTION 30  
 DWG BY RHOADES PID 85264 T 2 N R 13 E

TYPE MONUMENT MAG NAIL  
 ON SURFACE - ~~BELOW~~ ON  
 OFFSET ☉ PAVEMENT 2.0' LT : RT  
- TO - EDGE PAVEMENT  
 STATION: 422+06 7.99

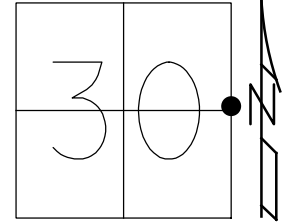

HORIZ.DATUM: NAD83 2011 GEOID: 2012A  
 GRID: NORTHING: 523959.615 EASTING: 1720085.117

RECORD:  
 FD MAG NAIL  
 10/25/06, DCH  
 FD MAG NAIL  
 REFB25  
 10/26/18, JMR  
 8/16/19, 5/12/21, JFO  
 SET MAG/WASHER  
 12/13/21, DSA

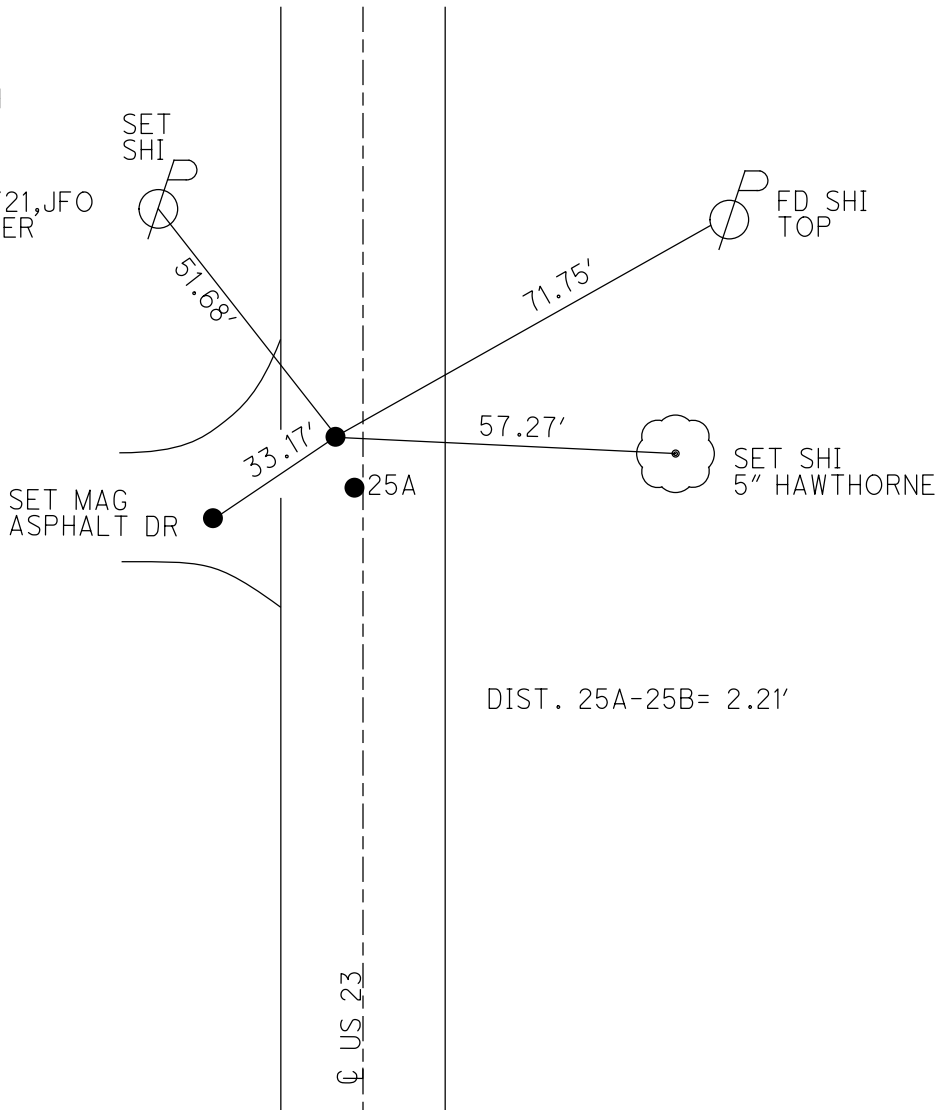

O.D.O.T. DISTRICT 2 SURVEY OFFICE (USE ONLY)

PERSONNEL

REFERENCE NO. 25 B

SHEET 7 OF 12

NOTES HOMAN

DATE 10/25/06

ROUTE US 23

H.C. HOMAN

WEATHER CLOUDY

COUNTY SENECA

R.C. CORDES

TEMP. 40°

TOWNSHIP LOUDON

SECTION 30

DWG BY NASON

PID PT-SEN19

T 2 N R 13 E

TYPE MONUMENT MAG NAIL

ON SURFACE - ~~BELOW~~ ON

OFFSET CL PAVEMENT 2.0' LT : ~~RT~~

- TO - EDGE PAVEMENT

STATION: 422+06 7.99

HORZ. DATUM: NAD83 2011

GEOID: 2012A

GRID: NORTHING: 523959.615

EASTING: 1720085.117

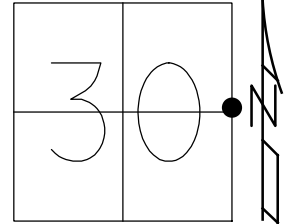

RECORD:  
 FD MAG NAIL  
 10/25/06, DCH  
 FD MAG NAIL  
 REFB25  
 10/26/18, JMR  
 8/16/19, JFO

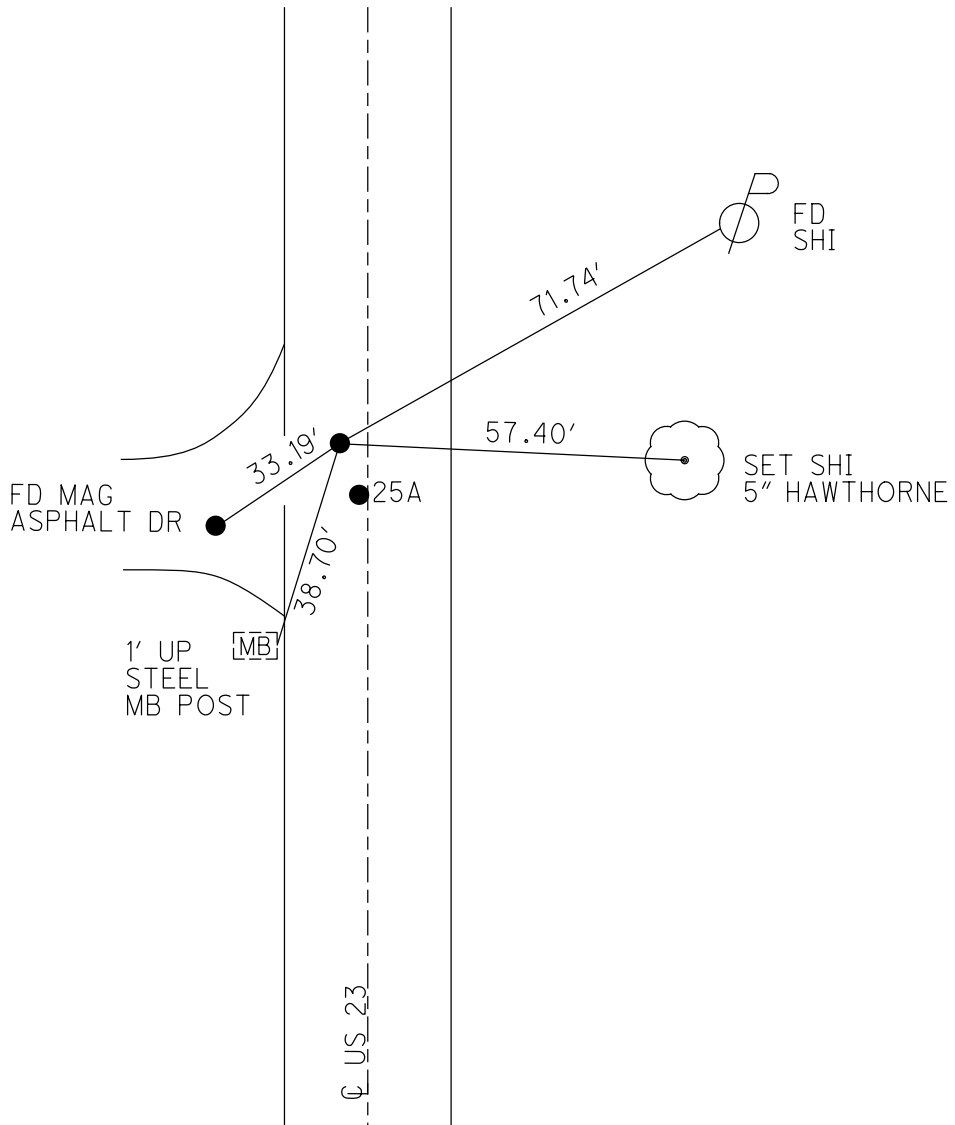

O.D.O.T. DISTRICT 2 SURVEY OFFICE (USE ONLY)

PERSONNEL	REFERENCE NO.	25 B	SHEET	3	OF	8
NOTES	HOMAN	DATE	10-25-2006	ROUTE	US 23	
H.C.	HOMAN	WEATHER	CLOUDY	COUNTY	SENECA	
R.C.	CORDES	TEMP.	40' F	TOWNSHIP	LOUDON	
				SECTION	30	
				T. 2 N	R. 13 E	

TYPE MONUMENT                      MAG NAIL                       
 ON SURFACE - ~~BELOW~~                      ON                       
 LEFT -                      PAV'T - ~~RIGHT~~                      2.0'  
                     TO                      EDGE PAVEMENT  
 S.L.M.                       
 GRID: NORTHING:                      EASTING:                     

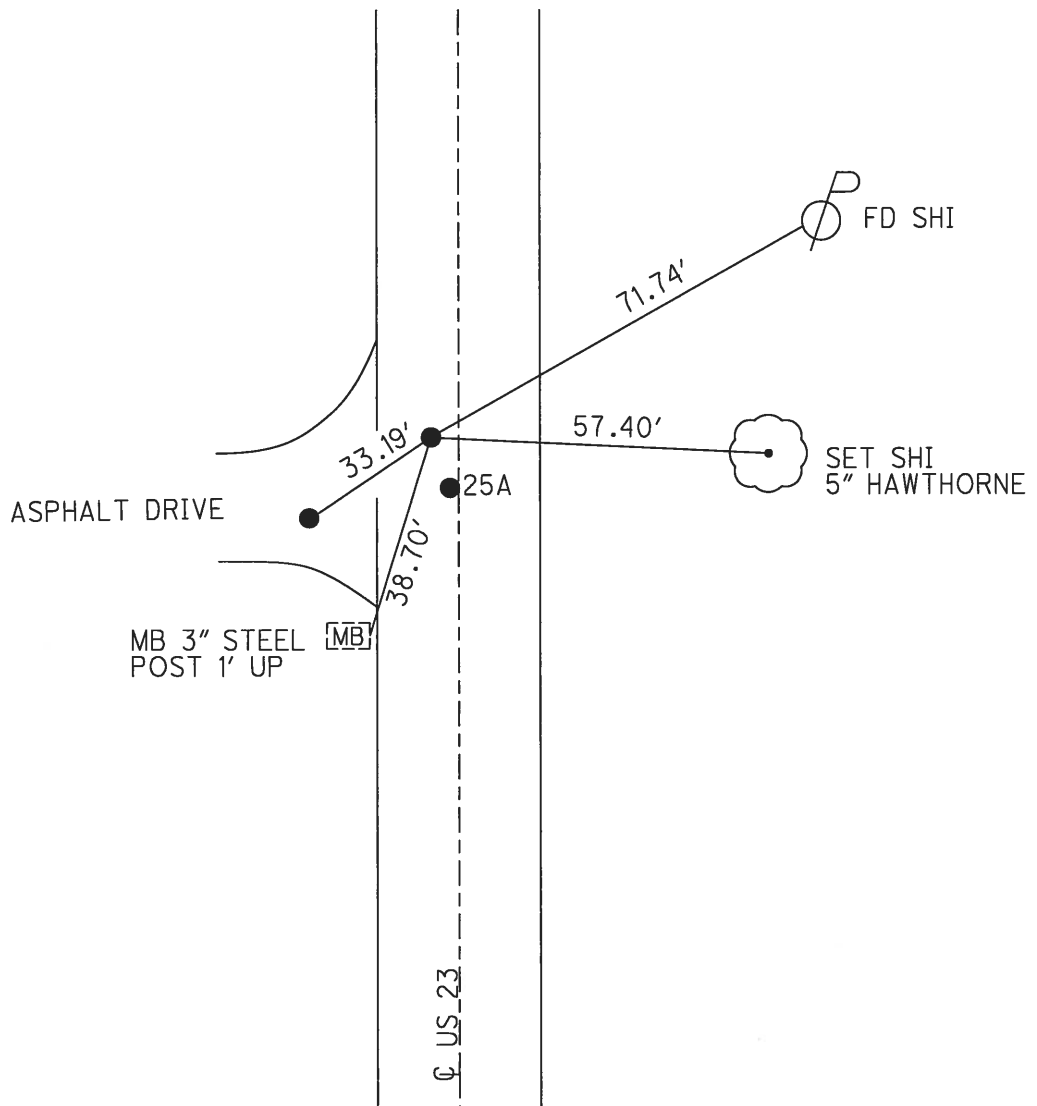
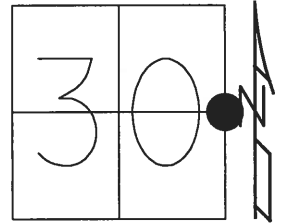

# O.D.O.T. DISTRICT 2 SURVEY OFFICE

PERSONNEL \_\_\_\_\_ REFERENCE NO. 25 SHEET \_\_\_\_\_ OF \_\_\_\_\_  
 NOTES LOETRKE Homan 10-25-06  
 H.G. Hoffman Homan DATE 7-21-89 ROUTE U.S. 23  
 R.G. BARNHISEL Cordes WEATHER Hot - Humid Cloud COUNTY SENECA  
 TOWNSHIP LODON  
 SECTION 30

A = Lg. RR spike B = Mag Nail

TYPE MONUMENT Sm. R.R. Spike ~~Set P.K. / washer~~  
 ON SURFACE - BELOW ~~46~~ A = 11" B = 11-9-89 SWIN  
 LEFT - PAV'T. - RIGHT ~~0.4~~ Lt A = 0.4' Lt B = 2.0' Lt  
~~#1 TO~~ EDGE PAVEMENT  
 S.L.M. 422+02

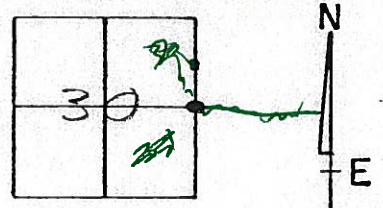

REC: P.I. Sta 423+38.99  
 A = 0'-05' Lt

